



# 11051 INSTALLATION INSTRUCTIONS



Safety glasses should be worn at all times while installing this product.

YEARS: 2010-CURRENT

MAKE: HONDA

MODEL: INSIGHT



STYLE: 5 DOOR

**WARNING: NEVER EXCEED YOUR VEHICLE MANUFACTURER'S RECOMMENDED TOWING CAPACITY**

**WEIGHT CARRYING:**  
TRAILER WEIGHT: 2,000 LBS.  
TONGUE WEIGHT: 200 LBS.

**INSTALLATION TIME: 45 MIN.**  
*THE INSTALL TIME LISTED IS FOR PROFESSIONAL INSTALLERS. IF YOU ARE HESITANT TO UNDERTAKE THIS TASK ON YOUR OWN, CONTACT AN AUTHORIZED CURT INSTALLER FOR ADDITIONAL ASSISTANCE.*





### INSTALLATION REQUIRES:

 <b>FLAT SCREW DRIVER</b>	 <b>PHILLIPS SCREW DRIVER</b>	 <b>10mm 11/16"</b> <b>SOCKET</b>
 <b>12"</b> <b>SOCKET EXTENSION</b>	 <b>RATCHET</b>	 <b>TORQUE WRENCH</b>
 <b>ROTARY TOOL</b>	 <b>SAFETY GLASSES</b>	

**INSTALLATION TIPS:**

- BEFORE YOU BEGIN INSTALLATION, READ ALL INSTRUCTIONS THOROUGHLY.
- TO EASE INSTALLATION, 2 PEOPLE MAY BE REQUIRED.
- USING PROPER TOOLS WILL GREATLY IMPROVE THE QUALITY OF THE INSTALL AND REDUCE THE TIME REQUIRED.

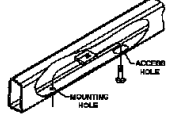
### LEVEL OF DIFFICULTY: MODERATE

EASY	MODERATE	CHALLENGING
 PART REMOVAL	REMOVE SPLASH SHIELDS	
 TRIM	TRIMMING SPLASH SHIELDS	
	NO DRILL	
	FISHWIRE HARDWARE	
	LOWER EXHAUST TO EASE INSTALLATION	

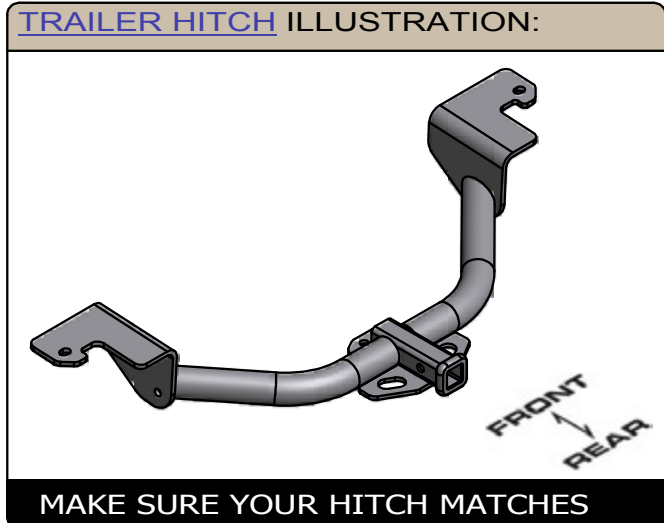

**PERIODICALLY CHECK THIS RECEIVER HITCH TO ENSURE ALL FASTENERS ARE TIGHT AND ALL STRUCTURAL COMPONENTS ARE SOUND**  
CURT Manufacturing LLC. warrants this product to be free of defects in material and/or workmanship at the time of retail purchase by the original purchaser. If the product is found to be defective, Curt Manufacturing LLC. may repair or replace the product at their option, when the product is returned, prepaid, with proof of purchase. Alteration to, misuse of, or improper installation of this product voids the warranty. Curt Manufacturing LLC.'s liability is limited to repair or replacement of products found to be defective, and specifically excludes liability for incidental or consequential loss or damage.

## INSTALLATION WALKTHROUGH:

Parts List			
ITEM	QTY	PART NUMBER	DESCRIPTION
1	2	7/16-14 x 2 1/2	CARRIAGE BOLT
2	2	CM-SP2	.250 x .88 x 2.25" SQUARE HOLE SPACER
3	4	7/16-14	HEX FLANGE NUT
4	1	7_16 - 14 x 1.75" x 1.00" C-C	U-BOLT
5	2	7_16 FISHWIRE	7/16" FISHWIRE
6	1	CM-11051-SP	.375" SPACER

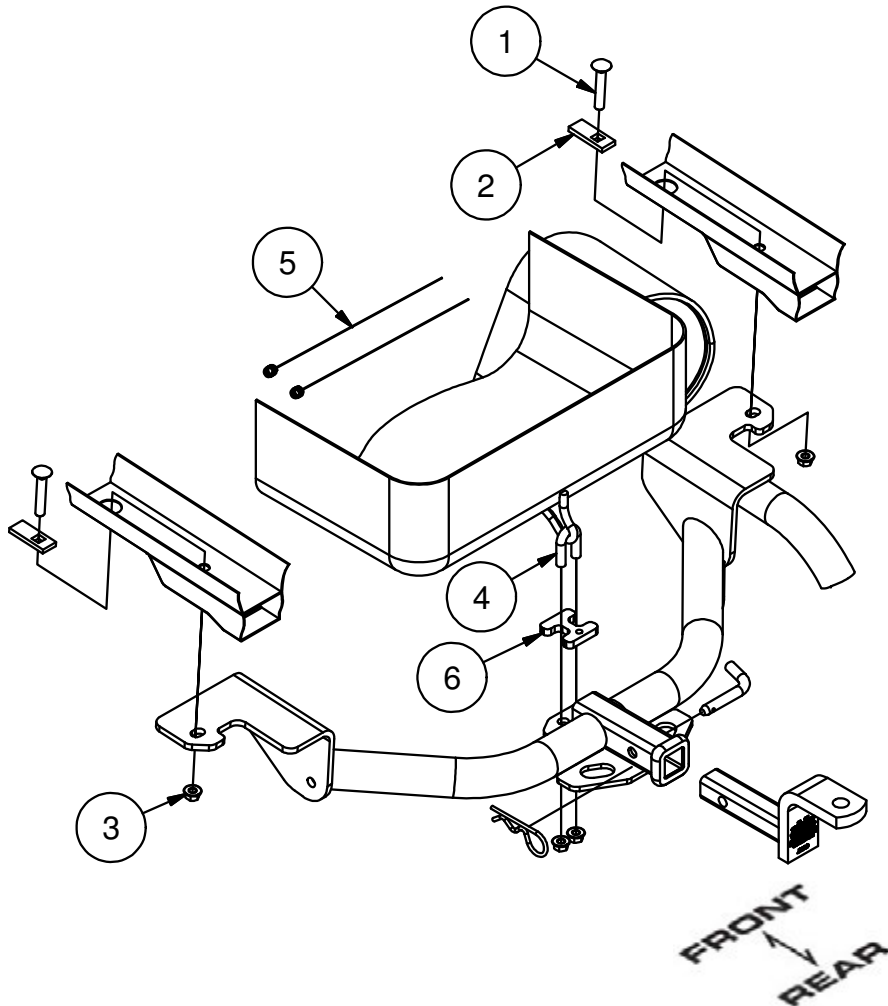

1) Lower the exhaust by removing the (2) rubber isolators from the hangers.

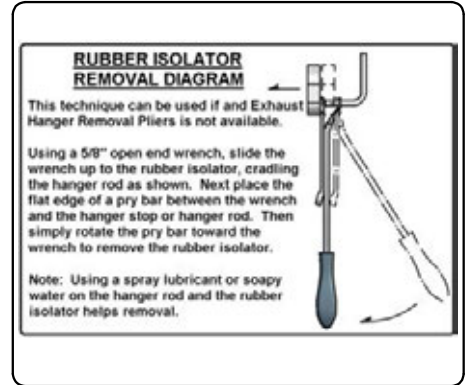

2) Remove the (2) bolts retaining the evaporative emissions conister and allow it to hang.



## INSTALLATION WALKTHROUGH:

3) Remove the splash shields located in the rear wheel wells by removing the (3) screw and (3) push fasteners securing them.



4) Fishwire a 7/16-14 x 2-1/2" carriage bolt and CM-SP2 spacer through the access holes in the frame rails and into the rearmost holes in the frame rails as shown. Also, hang the U-bolt through the tow loop at this time.



5) Raise the hitch into position and secure it to the tow loop using the U-bolt and (2) 7/16" hex flange nuts through the chain plate as shown. Take care not to push the fishwired carriage bolts back into the frame rails.



NOTE: On some models the supplies spacer may be required to level the hitch.



## INSTALLATION WALKTHROUGH:

6) Position the side plates against the frame rails over the 7/16" carriage bolts and secure using 7/16" hex flange nuts. Torque all 7/16" hardware to 70 ft-lbs.



7) Raise the exhaust back into position and reinstall the rubber isolators.



8) Trim the splash shields and reinstall.

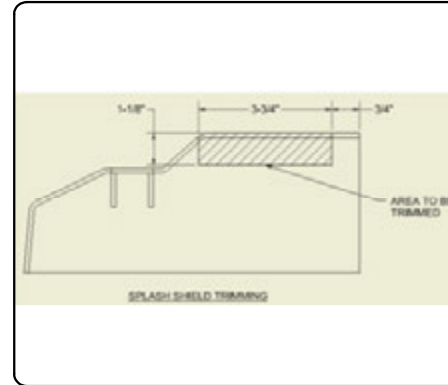

9) Reinstall the evaporative emissions canister. Install is now complete.



## TOWING SAFETY INFORMATION

### Gross Trailer Weight / GTW

The Gross Trailer Weight is the weight of the trailer & cargo. Measure this by putting the fully loaded trailer on a vehicle scale.

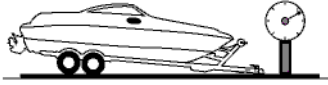

### Tongue Weight / TW

The downward force that is exerted on the hitch ball by the coupler. The tongue weight will vary depending on where the load is positioned in relationship to the trailer axle(s). To measure the tongue weight, use either a commercial scale or a bathroom scale with the coupler at towing height. When using a bathroom scale with heavier tongue weights, use the method shown and multiply the scale reading by 3.

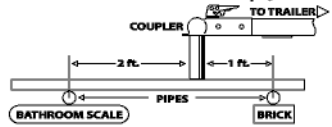

### Weight Carrying / WC

The total weight of both the trailer and the cargo inside. Never exceed the weight capacity of your trailer hitch.

### Weight Distribution / WD

Used to balance the weight of the cargo between the front and rear wheels throughout the trailer, allowing for better steering, braking, and level riding.



### Sway Control

A device used to reduce the lateral movements of the trailer that are caused by the wind. This works in conjunction with a weight distribution hitch. Do not use this on a class 1 or 2 hitch, or with surge brakes.

### How Much Can You Safely Tow?

TONGUE WEIGHT (lb)	1000	2000	3000	4000	5000	6000	7000	8000	10,000	12,000
Tongue weight should be about 10 to 15 percent of the gross trailer weight.										
TRAILER TYPE	<div style="display: flex; justify-content: space-between;"> <div style="width: 20%;">CLASS 1</div> <div style="width: 20%;">CLASS 2</div> <div style="width: 20%;">CLASS 3</div> <div style="width: 20%;">CLASS 4</div> <div style="width: 20%;">CLASS 5</div> </div>									
Camper	11'	12'	13'	14'	15'	16'				
lbs.	1100	1200	1300	1400	1500	1600				
Vacation	18'	16'	18'	20'	22'	24'	26'	28'	30'	32'
lbs.	2100	2400	2700	3000	3300	3600	3900	4200	4500	4800
Vacation	18'	16'	18'	20'	22'	24'	26'	28'	30'	32'
lbs.	2800	3200	3600	4000	4400	4800	5200	5600	6000	6400
5th Wheel										

**Refer to owner's manual for towing capabilities and limitations.**

### Ball Mount

The ball mount is placed inside the opening of the receiver hitch which is mounted to the vehicle. Make sure a hitch pin and clip is properly securing the ball mount to the receiver hitch before you begin towing.

- A: Rise. B: Drop. C: Hole Size. D: Length.

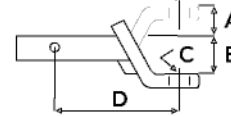

### Trailer Ball

The connection from the hitch to the trailer. There are many factors that determine the correct hitch ball:

- Number one is the hitch ball's gross trailer weight rating.
- The mounting platform must be at least 3/8" thick.
- The hole diameter must not be more than 1/16" larger than the threaded shank.
- Every time you tow, check the nut and lock washer to make sure they are fastened securely.
- A: Ball Dia. B: Shank Length. C: Shank Dia. D: Shank Rise.

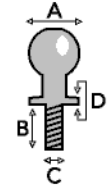

### Coupler

The component that is placed over the trailer ball to connect the vehicle to the trailer. Be sure that the coupler size matches the size of the hitch ball and that the coupler handle is securely fastened. To determine what size hitch ball you need for your application you will need to know the size of coupler that is on the trailer. Be sure your coupler is properly adjusted to the ball you are using.

NOTE: For added security the use of safety devices such as Coupler Safety Pins and Locks is strongly recommended.

### Safety Chains

Safety chains are a requirement and should be crossed under the tongue of the trailer so that the tongue will not drop to the road if it becomes separated from the hitch. Always leave enough slack so you can turn. Never allow the safety chains to drag on the ground and never attach the chains to the bumper.

Trailer Classification: Safety Chain Breaking Force - Minimum

Class 1: 2,000 lbs. (8.9 kN)

Class 2: 3,500 lbs. (15.6 kN)

Class 3: 5,000 lbs. (22.2 kN)

The strength rating of each length of safety chain or its equivalent and its attachments shall be equal to or exceed in minimum breaking force the GVWR (Gross Vehicle Weight Rating) of the trailer.

### Electrical

Trailer lights, Electric Brakes, Break-away systems - Every time you tow, be sure to check that all components are working properly.

Wiring identification by color:

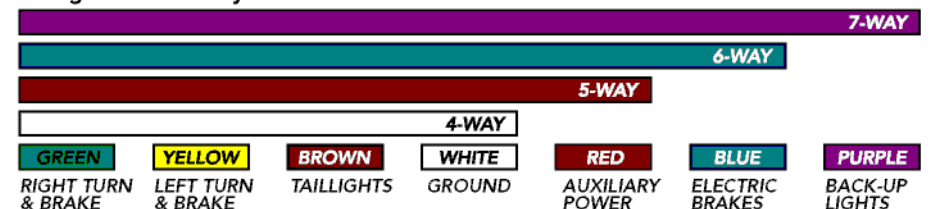

CURT DISCLAIMER: WIRING COLOR SHOWN WORK IN CONJUNCTION WITH CURT MANUFACTURING PRODUCTS.

11051

# HONDA INSIGHT

GROSS LOAD CAPACITY WHEN USED AS A WEIGHT CARRYING HITCH: 2,000 LBS. TRAILER WEIGHT & 200 LBS. TONGUE WEIGHT.

**\*\*\*DO NOT EXCEED VEHICLE MANUFACTURER'S RECOMMENDED TOWING CAPACITY.\*\*\***

**WARNING: ALL NON-TRAILER LOADS APPLIED TO THIS PRODUCT MUST BE SUPPORTED BY AUXILIARY STABILIZING STRAPS.**

**\*\* FAILURE TO PROPERLY SUPPORT NON-TRAILER LOADS WILL VOID PRODUCT WARRANTY\*\***

Parts List			
ITEM	QTY	PART NUMBER	DESCRIPTION
1	2	7/16-14 x 2 1/2	CARRIAGE BOLT
2	2	CM-SP2	.250 x .88 x 2.25" SQUARE HOLE SPACER
3	4	7/16-14	HEX FLANGE NUT
4	1	7_16 - 14 x 1.75" x 1.00" C-C	U-BOLT
5	2	7_16 FISHWIRE	7/16" FISHWIRE
6	1	CM-11051-SP	.375" SPACER

### TOOLS REQUIRED

FLAT SCREWDRIVER
PHILLIPS SCREWDRIVER
10mm AND 11/16" SOCKETS
12" EXTENSION
RATCHET
TORQUE WRENCH
ROTARY CUTTING TOOL

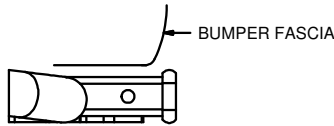

INSTALLED HITCH POSITION

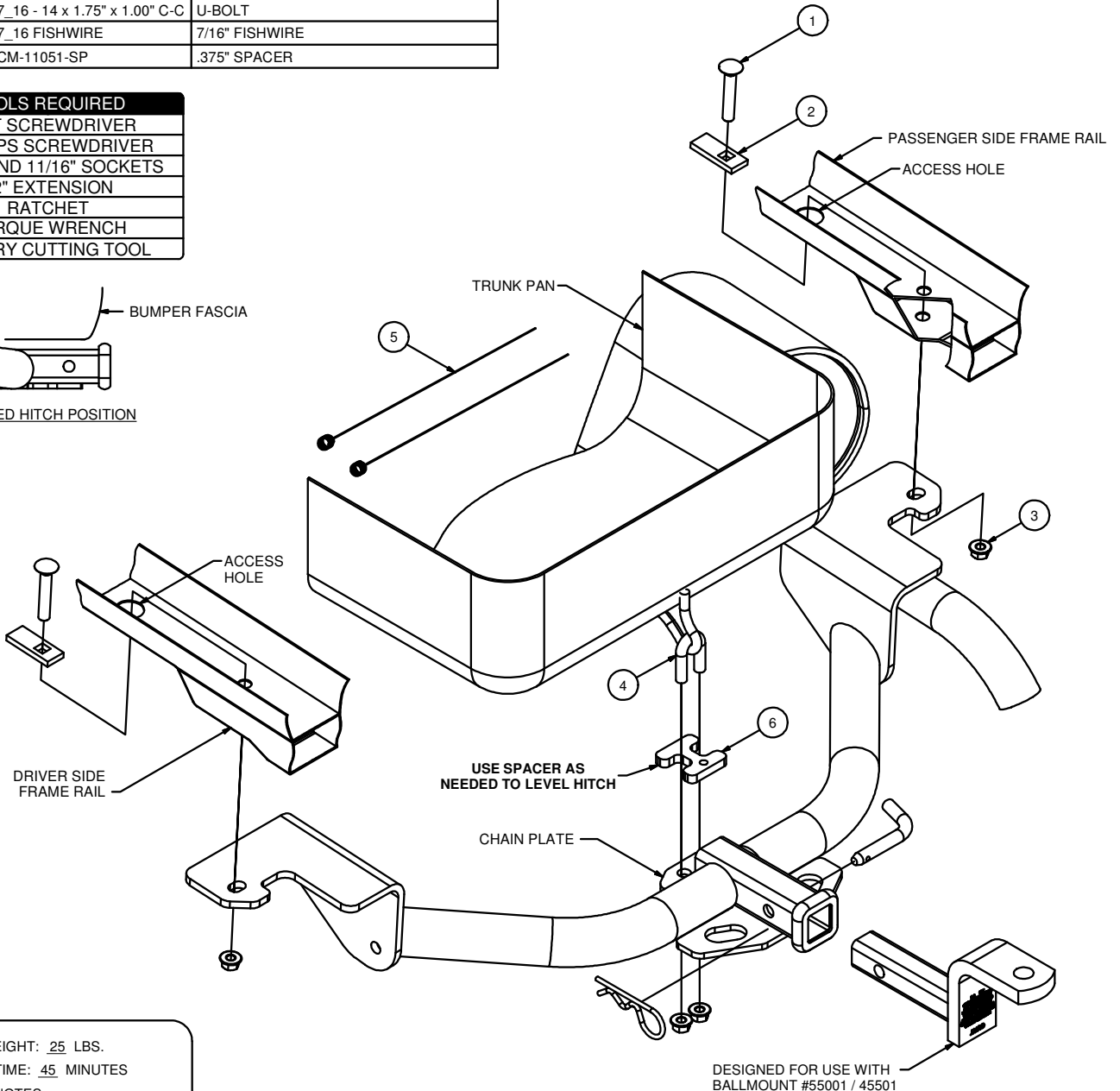

- HITCH WEIGHT: 25 LBS.  
 INSTALL TIME: 45 MINUTES  
 INSTALL NOTES:  
 - NO DRILLING REQUIRED  
 - LOWER EXHAUST  
 - FISHWIRE HARDWARE  
 - TRIM SPLASH SHIELDS

**PERIODICALLY CHECK THIS RECEIVER HITCH TO ENSURE THAT ALL FASTENERS ARE TIGHT AND THAT ALL STRUCTURAL COMPONENTS ARE SOUND.**

Curt Manufacturing Inc., warrants this product to be free of defects in material and/or workmanship at the time of retail purchase by the original purchaser. If the product is found to be defective, Curt Manufacturing Inc., may repair or replace the product, at their option, when the product is returned, prepaid, with proof of purchase. Alteration to, misuse of, or improper installation of this product voids the warranty. Curt Manufacturing Inc.'s liability is limited to repair or replacement of products found to be defective, and specifically excludes liability for incidental or consequential loss or damage.

**11051****HONDA INSIGHT**

10/1/2012

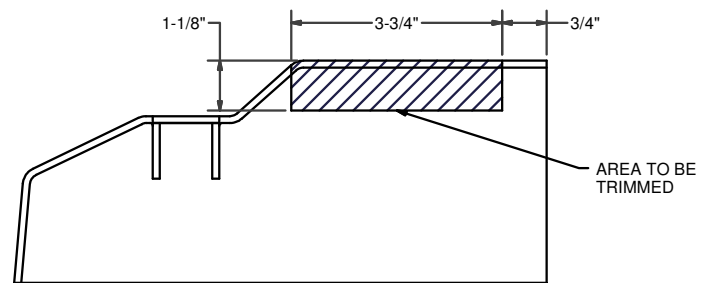
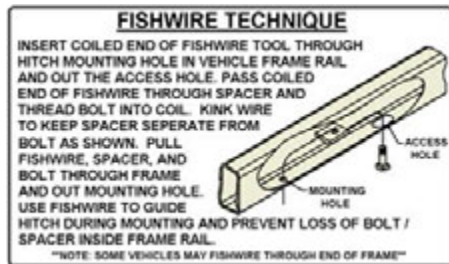
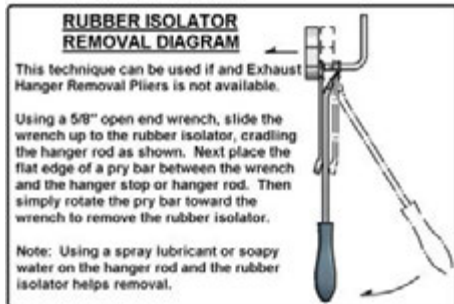
**\*\*\*DO NOT EXCEED VEHICLE MANUFACTURER'S RECOMMENDED TOWING CAPACITY.\*\*\*****WARNING: ALL NON-TRAILER LOADS APPLIED TO THIS PRODUCT MUST BE SUPPORTED BY AUXILIARY STABILIZING STRAPS.****\*\* FAILURE TO PROPERLY SUPPORT NON-TRAILER LOADS WILL VOID PRODUCT WARRANTY\*\***

SPLASH SHIELD TRIMMING

**INSTALLATIONS STEPS:**

1. Lower the exhaust by removing the (2) rubber isolators from the hangers. (See Rubber Isolator Removal.)
2. Remove the (2) bolts retaining the evaporative emissions canister and allow it to hang. (See photo above.)
3. Remove the splash shields located in the rear wheel wells by removing the (3) screws and (3) push fasteners securing them.
4. Fishwire a 7/16-14 x 2-1/2" carriage bolt and CM-SP2 spacer through the access holes in the frame rails and into the rearmost holes in the frame rails as shown. (See Fishwire Technique.)

Also, hang the U-bolt through the tow loop at this time.

5. Raise the hitch into position and secure it to the tow loop using the u-bolt and (2) 7/16" hex flange nuts through the chain plate as shown. Take care not to push the fishwired carriage bolts back into the frame rails.

NOTE: On some models the supplied spacer may be required to level the hitch.

6. Position the side plates against the frame rails over the 7/16" carriage bolts and secure using 7/16" hex flange nuts as shown.
7. Torque all 7/16" hardware to 70 ft-lbs.
8. Raise the exhaust back into position and reinstall the rubber isolators.
9. Trim the splash shields and reinstall. (See Splash Shield Trimming.)
10. Reinstall the evaporative emissions canister.

**PERIODICALLY CHECK THIS RECEIVER HITCH TO ENSURE THAT ALL FASTENERS ARE TIGHT AND THAT ALL STRUCTURAL COMPONENTS ARE SOUND.**

Curt Manufacturing Inc., warrants this product to be free of defects in material and/or workmanship at the time of retail purchase by the original purchaser. If the product is found to be defective, Curt Manufacturing Inc., may repair or replace the product, at their option, when the product is returned, prepaid, with proof of purchase. Alteration to, misuse of, or improper installation of this product voids the warranty. Curt Manufacturing Inc.'s liability is limited to repair or replacement of products found to be defective, and specifically excludes liability for incidental or consequential loss or damage.