

INSTALLATION MANUAL

60638

Level of Difficulty

Easy

Weight Capacity

Gross trailer weight (GTW)	38,000 lbs.
Vertical load	9,500 lbs.

Parts List

Item	Qty	Description
1	2	Safety chain anchor
2	2	Pin, 12mm
3	2	Lynch pin, 5mm
4	1	Gooseneck ball, 2-5/16"

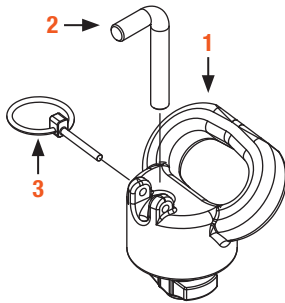

Tools Required

None

Maintenance

When the ball and anchors are not in use, remove them from the truck bed and store in the included case or a dry, clean area.

Keep the gooseneck ball, safety chain anchor pins and towing system lubricated regularly. Use silicone spray or equivalent to prevent wear and rust.

Place the puck system anchor hole covers (supplied by the truck manufacturer) into the puck system holes when the anchors are removed to keep dirt and debris out.

Place a rubber cover into the gooseneck receiver when the ball is removed to keep dirt and debris out.

Failure to maintain the towing system could result in poor performance and / or failure.

WARNING

Never exceed the vehicle manufacturer's recommended towing capacity.

Vehicle performance (braking, handling, acceleration, turning radius) can be drastically affected by a trailer. Allow additional time and space for stopping, changing lanes, passing and turning.

Product Photo



CAUTION

Severe bumps can damage the towing system. Avoid or drive slowly over rough terrain.

Do not tow more than one trailer at a time. This may cause loss of control.

NOTICE

Before you begin installation, read all instructions thoroughly.

Anchor Installation

Insert both safety chain anchors (#1) into the rear-most truck bed puck system mounts.

Note: Always install in the rear-most mounts.

Once inserted, rotate the anchors 90° toward the center of the truck.

Insert a 12mm pin (#2) into the top of each safety chain anchor and secure using the provided 5mm lynch pins (#3).

Note: The 12mm pins and 5mm lynch pins must be fully inserted and engaged.

When the safety chain anchors are not in use, remove them from the truck bed mounts and store in a dry, clean area.

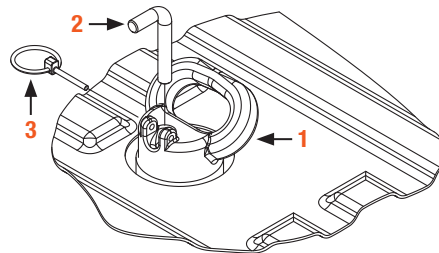
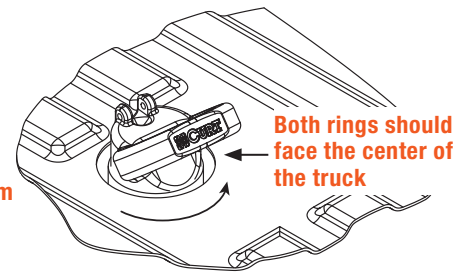
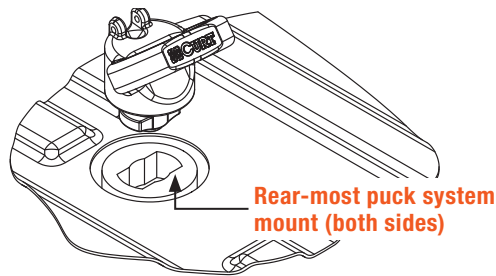

Ball Installation

To install the gooseneck ball, lift the handle on top of the ball from its seat and rotate 90°.

Insert the gooseneck ball into the truck bed puck system receiver tube. Rotate the lift handle to the locked position and flip it down into its seat.

If the lift handle does not freely rotate into the locked position, rotate the ball while applying light pressure to the side of the lift handle. When the lift handle rotates into the locked position, flip it down into the seated position.

When the gooseneck ball is not in use, remove it from the receiver tube and store in a case or a dry, clean area.

Place a rubber cover into the gooseneck receiver when the ball is removed to keep dirt and debris out.

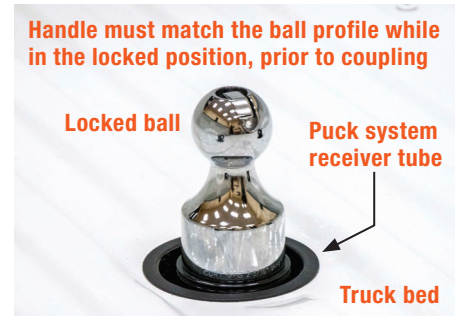
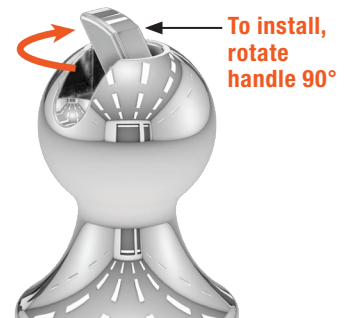
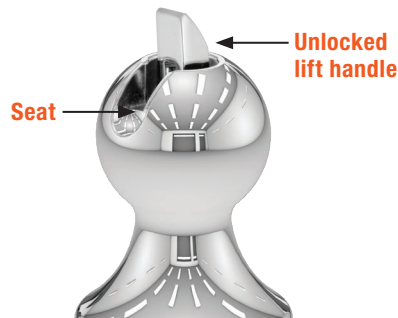

Properly Installed System

Always install both safety chain loops in the rear-most puck system mounts.

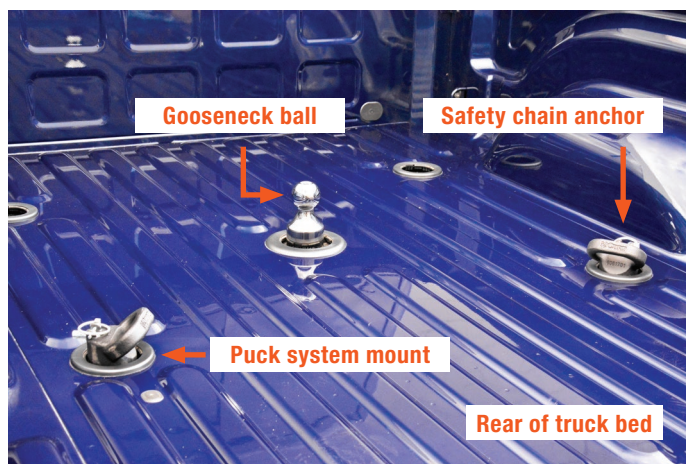

TOWING TIPS

Towing Tips

Driving a tow vehicle	<p>Verify adequate turning clearance between the truck cab / box corners and trailer(s).</p> <p>Verify the trailer safety chain length. Too much slack in the chain may prevent maintaining control in the event of separation. Leave only enough slack to allow full turning without interference.</p>
Check your equipment	<p>Periodically check the condition of all towing equipment. Ensure all fasteners are tight and that all structural components are sound. Do not tow a trailer with worn or damaged parts.</p> <p>Check truck box clearance. There should be a minimum clearance of 6" between the bottom of the trailer's overhang and the top of the box sides.</p> <p>Verify all anchors are properly installed, secured with lynch pins, and the trailer attachments to the safety chain anchors are secure (cannot be shaken free during towing).</p> <p>Attach trailer securely to safety chain anchors.</p> <p>Ensure the safety chains and hooks are rated to the load capacity of the trailer.</p>
Trailer loading	<p>Proper trailer loading is very important.</p> <p>Heavy items should be placed close to the floor near the trailer axle center line. The load should be balanced side to side and firmly secured in the trailer to prevent shifting. Tongue weight should be 10-15% of the gross trailer weight for most trailers. Too low of a tongue weight often produces tendency to sway.</p> <p>Never load the trailer heavier behind the trailer axle(s).</p>
Towing vehicle and trailer manufacturer's recommendations	<p>Review the owner's manual for your towing vehicle and trailer for specific recommendations, capacities and requirements.</p>
Trailer lights, turn signals and electric brakes	<p>Verify trailer lights, electric brakes and breakaway switches are working properly.</p>
Tire inflation	<p>Unless specified by the towing vehicle or trailer manufacturer, tires should be inflated to their maximum recommended pressure.</p>