

# INSTALLATION INSTRUCTIONS

**⚠ WARNING: DO NOT EXCEED PRODUCT RATING OR TOW VEHICLE LAMP LOAD RATING, WHICHEVER IS LOWER**

## APPLICATIONS

Make	Model
Jeep	Cherokee

## WIRING LOCATION GUIDE

### SUVs, MINI & FULL-SIZED VANS (S)

Representative vehicle shown below

S1 - Behind driver side taillight housing

S2 - Behind passenger side taillight housing

## CUSTOM WIRING HARNESS

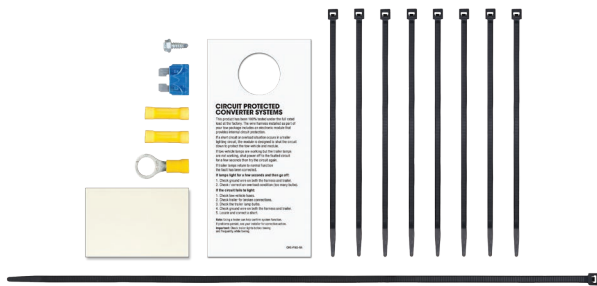

## NOTICE

All steps must be followed to ensure the wiring harness will function properly. Once installed, test for proper function by using a test light or connecting a properly wired trailer.

## TOOLS NEEDED

- |                   |               |
|-------------------|---------------|
| Ratchet           | Wire stripper |
| Ratchet extension | Wire crimper  |
| 1/4" socket       | Cutting tool  |
| T-27 Torx bit     | Fish wire     |

## ⚠ WARNING

The battery connection must be fuse-protected, 15-amp max. Exceeding the product rating can cause loss of warranty, overheating and potential fire. Do not exceed product rating or tow vehicle lamp load rating, whichever is lower.

Signal Circuits - 5.0 amps per side

Tail / Running Circuits - 7.5 amps total

# INSTALLATION / SAFETY INSTRUCTIONS

## Step 1

Open the vehicle hatch (A).

## Step 2

Starting on the driver side, locate and remove the two fasteners securing the taillight in place (B).

## Step 3

Remove the taillight by gently pulling outward (C). Take care not to break the alignment tabs on the back.

## Step 4

Locate the vehicle taillight wiring harness connectors. The connectors will be similar to those on the custom wiring harness (D). Separate the connectors from the taillight housing taking care not to damage the locking tabs. Set the taillight aside.

## Step 5

From underneath the vehicle, route the custom wiring harness end with yellow wire along the rear bumper and up behind the fender to the opening underneath the removed taillight (E).

## Step 6

Insert the custom wiring harness end with yellow wire between the separated connectors (F). Make sure the connectors are fully inserted with locking tabs in place. Reinstall the taillight.

## Step 7

Locate a suitable grounding point near the connector such as an existing screw with nut in the vehicle frame or drill a 3/32" pilot hole for the provided screw. The area should be free of rust, dirt and paint. Secure the white ground wire using the ring terminal and provided screw.

 **WARNING:** Check for miscellaneous items that may be hidden behind or under any surface before drilling to avoid damage and / or personal injury.

## Step 8

Route the custom wiring harness end with the green wire to the passenger side along the rear bumper. Repeat steps 2 - 6 on the passenger side using the custom wiring harness end with the green wire.

## Step 9

Locate a flat clean surface that is out of the path of spray and debris from the rear wheels and road. Adhere the black converter box using the provided double-sided tape and cable ties. Failure to mount the box in a protected area can cause loss of warranty, product failure, overheating and potential fire.

## Step 10

Route the black power wire from the vehicle battery as shown on the included CME-PCL15-INS sheet.

## Step 11

Route the 4-flat to the center of the vehicle. Secure the 4-flat to the center of the vehicle in a convenient, out of the way location or the rear hitch. Use the provided cable ties to secure any loose wires.

## Step 12

Reinstall all items removed during install. Install the provided 4-flat dust cover to help prevent corrosion.

