

# INSTALLATION INSTRUCTIONS

**⚠ WARNING: DO NOT EXCEED PRODUCT RATING OR TOW VEHICLE LAMP LOAD RATING, WHICHEVER IS LOWER**

## APPLICATIONS

Make	Model
Volkswagen	Golf GTI

## WIRING LOCATION GUIDE

### PASSENGER CARS (P)

Representative vehicle shown below

P3 - Behind driver side taillight housing, inside of trunk

P4 - Behind passenger side taillight housing, inside of trunk

## CUSTOM WIRING HARNESS

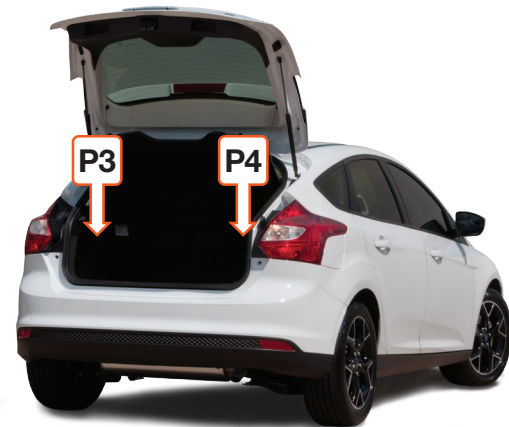
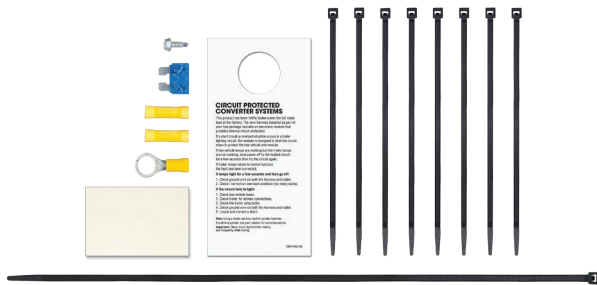
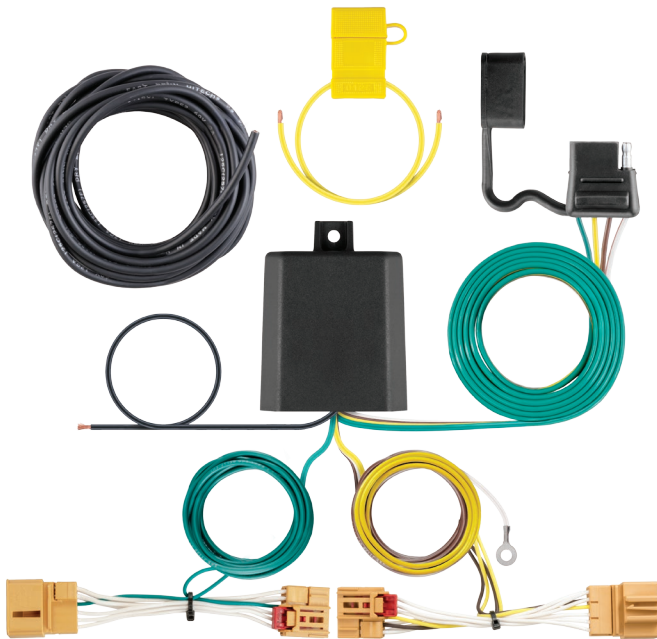

## NOTICE

All steps must be followed to ensure the wiring harness will function properly. Once installed, test for proper function by using a test light or connecting a properly wired trailer.

## TOOLS NEEDED

- |                   |                         |
|-------------------|-------------------------|
| Ratchet           | Panel trim removal tool |
| Ratchet extension | Wire stripper           |
| T-20 Torx bit     | Wire crimper            |
| T-27 Torx bit     | Cutting tool            |

## ⚠ WARNING

The battery connection must be fuse-protected, 15-amp max. Exceeding the product rating can cause loss of warranty, overheating and potential fire. Do not exceed product rating or tow vehicle lamp load rating, whichever is lower.

Signal Circuits - 5.0 amps per side

Tail / Running Circuits - 7.5 amps total

# INSTALLATION / SAFETY INSTRUCTIONS

## Step 1

Open the trunk. Remove all trunk floor coverings (A,B).

## Step 2

Remove the fasteners securing the rear scuff panel. Remove the scuff panel by pulling out on the bottom and then up. Take care not to damage the alignment tabs on the back (C).

## Step 3

Starting on the driver side, remove the fasteners from the interior side trim panel (D,E).

## Step 4

Pull outward on the side trim panel to locate the push fasteners behind the panel (F). Remove the push fasteners from the side felt liner. Pull back on the felt liner to locate the vehicle taillight wiring harness connectors. The connectors will be similar to those on the custom wiring harness. Separate the connectors from the taillight housing taking care not to damage the locking tabs. (G).

## Step 5

Insert the custom wiring harness end with yellow wire between the separated connectors. Make sure the connectors are fully inserted with locking tabs in place.

## Step 6

Locate a suitable grounding point near the connector such as an existing screw with nut in the vehicle frame or drill a 3/32" pilot hole for the provided screw. The area should be free of rust, dirt and paint. Secure the white ground wire using the ring terminal and provided screw.

 **WARNING:** Check for miscellaneous items that may be hidden behind or under any surface before drilling to avoid damage and / or personal injury.

## Step 7

Route the custom wiring harness end with the green wire down behind the interior side felt liner and out to the passenger side behind the removed scuff panel. Repeat steps 3-5 on the passenger side using the harness end with the green wire.

## Step 8

Locate a flat spot inside the vehicle, near the taillight. Adhere the black converter box using the provided double-sided tape.

## Step 9

Route the black power wire from the vehicle battery as shown on the included CME-PCL15-INS sheet.

## Step 10

When in use, route the 4-flat to the center of the vehicle and out of the trunk. When not in use, roll up and store in a convenient, out of the way location inside the trunk. Secure any loose wires with the provided cable ties.

## Step 11

Reinstall all items removed during install. Install the provided 4-flat dust cover to help prevent corrosion.

