

INSTALLATION INSTRUCTIONS

⚠ WARNING: DO NOT EXCEED PRODUCT RATING OR TOW VEHICLE LAMP LOAD RATING, WHICHEVER IS LOWER

APPLICATIONS

Make	Model
Honda	Civic sedan

CUSTOM WIRING HARNESS

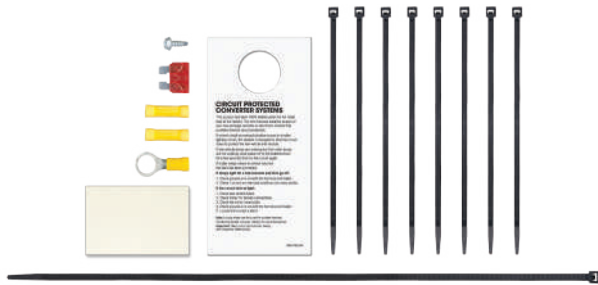
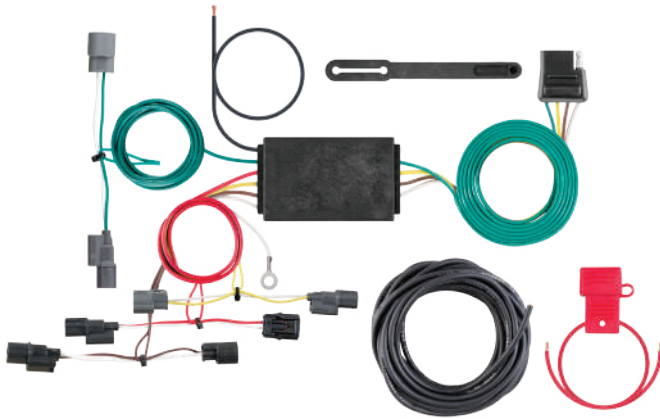

WIRING LOCATION GUIDE

PASSENGER CARS (P)

Representative vehicle shown below

P3 - Behind driver side taillight housing, inside of trunk

P4 - Behind passenger side taillight housing, inside of trunk



NOTICE

All steps must be followed to ensure the wiring harness will function properly. Once installed, test for proper function by using a test light or connecting a properly wired trailer.

TOOLS NEEDED

Ratchet	Panel trim removal tool
Ratchet extension	Wire stripper
8mm socket	Wire crimper
Flat blade screwdriver	Cutting tool

⚠ WARNING

The battery connection must be fuse-protected, 10-amp max. Exceeding the product rating can cause loss of warranty, overheating and potential fire. Do not exceed product rating or tow vehicle lamp load rating, whichever is lower.

Signal Circuits - 3.0 amps per side

Tail / Running Circuits - 6.0 amps total

Check vehicle owner's manual or contact the vehicle manufacturer for more information.

INSTALLATION / SAFETY INSTRUCTIONS

Step 1

Open the vehicle trunk. Remove all floor coverings and storage trays (A,B).

Step 2

Remove the scuff panel by pulling straight up. Take care not to damage the alignment tabs on the back (C).

Step 3

Starting on the driver side, remove the push fasteners securing the side felt liner (D).

Step 4

On the outside of the vehicle on the driver side, locate the taillight. Remove the taillight by removing the two 8mm fasteners securing the taillight in place. Remove the taillight by gently pulling rearward, taking care not to damage the alignment tabs on the back of the taillight (E).

Step 5

Behind the removed taillight locate the vehicle taillight wiring harness connectors. The connectors will be similar to those on the custom wiring harness. Separate the connectors from the taillight housing taking care not to damage the locking tabs. Set taillight aside for later installation (F).

Step 6

Locate the grommet behind the taillight where the vehicle taillight wiring passes though from inside the cabin to the taillight (G,H). Remove the grommet and cut a slit large enough to route the custom wiring harness though (I).

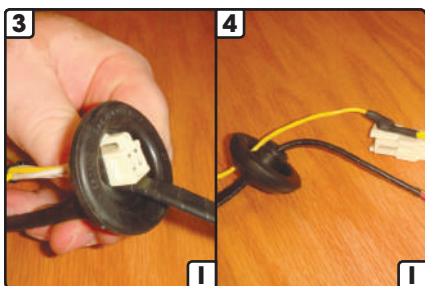
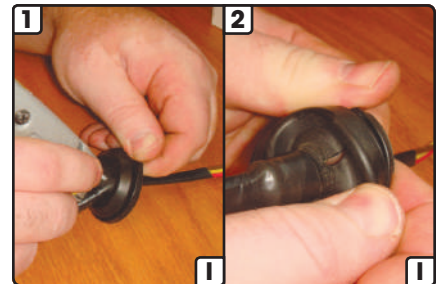
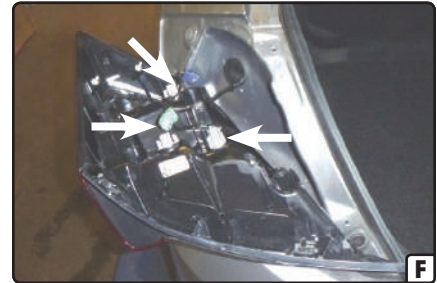

INSTALLATION / SAFETY INSTRUCTIONS

Step 7

Route the custom wiring harness end with the yellow wire out through the grommet opening and through the slit in the grommet. Insert the custom wiring harness end with the yellow wire between the separated connectors. Make sure the connectors are fully inserted with locking tabs in place (J).

Step 8

Reseat the grommet. Use the provided sealant to seal the cut in the grommet and around all the wires. Reinstall the taillight

Step 9

Locate a suitable grounding point near the connector such as an existing screw with nut in the vehicle frame or drill a 3/32" pilot hole for the provided screw. The area should be free of rust, dirt and paint. Secure the white ground wire using the ring terminal and provided screw.

 **WARNING:** Check for miscellaneous items that may be hidden behind or under any surface before drilling to avoid damage and / or personal injury.



Step 10

Route the custom wiring harness end with the green wire down behind the interior side panel and out to the passenger side behind the removed scuff panel. Repeat steps 3-8 on the passenger side using the harness end with the green wire.

Step 11

Locate a flat spot inside the vehicle, near the taillight. Adhere the black converter box using the provided double-sided tape.

Step 12

Route the black power wire from the vehicle battery as shown on the included CME-PCL-INS sheet.

Step 13

When in use, route the 4-flat to the center of the vehicle. When not in use, roll up and store in a convenient, out of the way location. Secure any loose wires with the provided cable ties.

Step 14

Reinstall all items removed during install. Install the provided 4-flat dust cover to help prevent corrosion.