

INSTALLATION INSTRUCTIONS

⚠ WARNING: DO NOT EXCEED PRODUCT RATING OR TOW VEHICLE LAMP LOAD RATING, WHICHEVER IS LOWER

APPLICATIONS

Make	Model
Buick	Encore

CUSTOM WIRING HARNESS

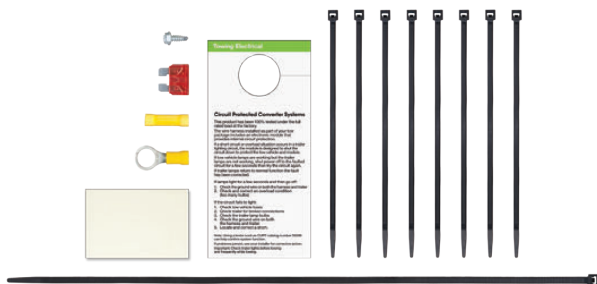
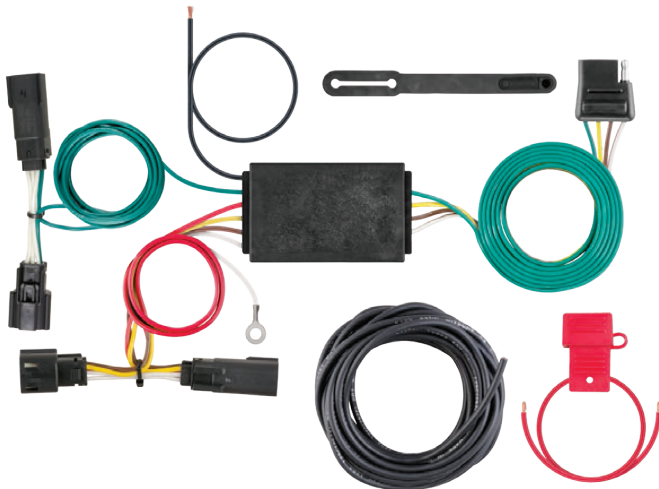

WIRING LOCATION GUIDE

SUVs, MINI & FULL-SIZED VANS (S)

Representative vehicle shown below

S3 - Behind driver side rear access panel

S4 - Behind passenger side rear access panel



NOTICE

All steps must be followed to ensure the wiring harness will function properly. Once installed, test for proper function by using a test light or connecting a properly wired trailer.

TOOLS NEEDED

10mm socket

Ratchet

Socket extension

Panel trim removal tool

Flat blade screwdriver

Wire stripper

Crimping tool

T-45 Torx bit

Side cutter

⚠ WARNING

The battery connection must be fuse protected, 10 amp max. Exceeding the product rating can cause loss of warranty, overheating and potential fire. Do not exceed product rating or tow vehicle lamp load rating, whichever is lower.

Signal Circuits - 3.0 amps per side

Tail / Running Circuits - 6.0 amps total

Check vehicle owner's manual or contact the vehicle manufacturer for more information.

INSTALLATION / SAFETY INSTRUCTIONS

Step 1

Open the vehicle tailgate. Remove all trunk floor coverings (A).

Step 2

Using a 10mm socket, remove the two cargo tie downs securing the rear scuff panel (B). Remove the scuff panel by pulling straight up. Take care not to damage the alignment tabs on the back (C).

Step 3

Using a T-45 Torx bit and extension, remove the fasteners securing the storage trays in place. Remove storage trays (D).

Step 4

Starting on the driver side and using a 10mm socket, remove the cargo tie down securing the side trim panel in place.

Step 5

Using a trim panel removal tool, pull back on the side trim panel. Take care not to damage the push fasteners on the back.

Locate the vehicle taillight wiring harness connectors (E). The connectors will be similar to those on the custom wiring harness. Separate the connectors from the taillight housing taking care not to damage the locking tabs (F).

Step 6

Insert the custom wiring harness end with yellow wire between the separated connectors. Make sure the connectors are fully inserted with locking tabs in place.

Step 7

Locate a suitable grounding point near the connector such as an existing screw with nut in the vehicle frame or drill a 3/32" pilot hole for the provided screw. The area should be free of rust, dirt and paint. Secure the white ground wire using the ring terminal and provided screw.

 **WARNING:** Check for miscellaneous items that may be hidden behind or under any surface before drilling to avoid damage and / or personal injury.

Step 8

Route the custom wiring harness end with the green wire to the passenger side behind the removed scuff panel. Repeat steps 4-6 on the passenger side using the harness end with the green wire.

Step 9

Locate a flat spot inside the vehicle, near the taillight. Adhere the black converter box using the provided double-sided tape.

Step 10

Route the black power wire from the vehicle battery as shown on the included CME-PCL-INS sheet.

Step 11

When in use, route the 4-flat to the center of the vehicle. When not in use, roll up and store in a convenient, out of the way location. Secure any loose wires with the provided cable ties.

Step 12

Reinstall all items removed during install. Install the provided 4-flat dust cover to help prevent corrosion.

