

# INSTALLATION INSTRUCTIONS

**⚠ WARNING: DO NOT EXCEED PRODUCT RATING OR TOW VEHICLE LAMP LOAD RATING, WHICHEVER IS LOWER**

## APPLICATIONS

Make	Model
Dodge	Durango



## CUSTOM WIRING HARNESS

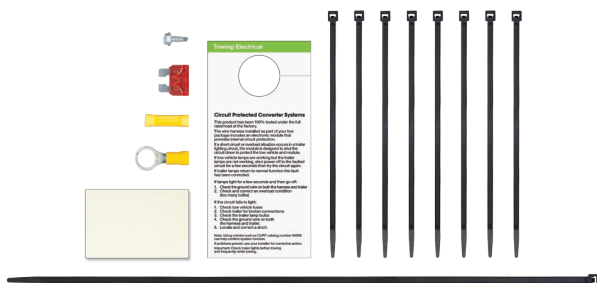

## WIRING LOCATION GUIDE

### SUVS, MINI & FULL-SIZED VANS (S)

Representative vehicle shown below

S1 - Behind driver side taillight housing

S2 - Behind passenger side taillight housing



## NOTICE

All steps must be followed to ensure the wiring harness will function properly. Once installed, test for proper function by using a test light or connecting a properly wired trailer.

## TOOLS NEEDED

Panel trim removal tool

## ⚠ WARNING

The battery connection must be fuse protected, 10 amp max. Exceeding the product rating can cause loss of warranty, overheating and potential fire. Do not exceed product rating or tow vehicle lamp load rating, whichever is lower.

Signal Circuits - 3.0 amps per side

Tail / Running Circuits - 6.0 amps total

# INSTALLATION / SAFETY INSTRUCTIONS

## Step 1

Locate vehicle battery on the driver side under the hood and disconnect the negative battery terminal.

## Step 2

Open the vehicle tailgate. Remove the two clips holding each taillight assembly in place (A,B). Remove both taillights by carefully prying rearward, taking care not to damage the alignment tabs.

## Step 3

Starting on the passenger side, locate the vehicle taillight wiring harness connectors. The connectors will be similar to those on the custom wiring harness (C). Separate the connectors from the taillight housing taking care not to damage the locking tabs (D).

## Step 4

Insert the custom wiring harness end with green wire between the separated connectors. Make sure the connectors are fully inserted with locking tabs in place.

## Step 5

Route the custom wiring harness end with the yellow and brown wires behind the taillight and down through the opening behind the vehicle bumper.

## Step 6

Locate a suitable grounding point near the connector such as an existing screw with nut in the vehicle frame or drill a 3/32" pilot hole for the provided screw. The area should be free of rust, dirt and paint. Secure the white ground wire using the ring terminal and provided screw.

 **WARNING:** Check for miscellaneous items that may be hidden behind or under any surface before drilling to avoid damage and / or personal injury.

## Step 6

Route the custom wiring harness end with the yellow wire down through the opening under the taillight, over to the passenger side under the backside of the bumper and up through the opening under the passenger side taillight (F). Repeat step 4 on the passenger side using the harness end with the green wire.

## Step 7

Locate a flat spot inside the vehicle, near the taillight. Adhere the black converter box using the provided double-sided tape (E).

## Step 8

Route the black power wire from the vehicle battery as shown on the included CME-PCL-INS sheet.

## Step 9

When in use, route the 4-flat to the center of the vehicle. When not in use, roll up and store in a convenient, out of the way location. Secure any loose wires with the provided cable ties.

## Step 10

Reinstall all items removed during install and reconnect negative battery terminal. Install the provided 4-flat dust cover to help prevent corrosion.

