

INSTALLATION INSTRUCTIONS

⚠ WARNING: DO NOT EXCEED PRODUCT RATING OR TOW VEHICLE LAMP LOAD RATING, WHICHEVER IS LOWER

APPLICATIONS

Make	Model
Dodge	Nitro
Jeep	Liberty



CUSTOM WIRING HARNESS

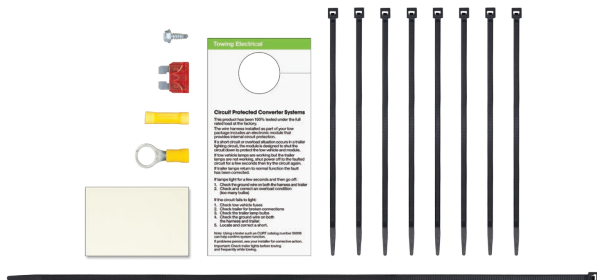

WIRING LOCATION GUIDE

SUVs, MINI & FULL-SIZED VANS (S)

Representative vehicle shown below

S1 - Behind driver side taillight housing

S2 - Behind passenger side taillight housing



NOTICE

All steps must be followed to ensure the wiring harness will function properly. Once installed, test for proper function by using a test light or connecting a properly wired trailer.

TOOLS NEEDED

10mm socket

Phillips screwdriver

Ratchet

Flat blade screwdriver

T-15 Torx bit

⚠ WARNING

The battery connection must be fuse protected, 10 amp max. Exceeding the product rating can cause loss of warranty, overheating and potential fire. Do not exceed product rating or tow vehicle lamp load rating, whichever is lower.

Signal Circuits - 3.0 amps per side

Tail / Running Circuits - 6.0 amps total

INSTALLATION / SAFETY INSTRUCTIONS

Step 1

Locate vehicle battery on the driver side under the hood and disconnect the negative battery terminal.

Step 2

Open the vehicle tailgate. Remove the two bolts holding each taillight assembly in place (A). Remove both taillights taking care not to damage the alignment tabs.

Step 3

Starting on the driver side, locate the vehicle taillight wiring harness connectors. The connectors will be similar to those on the custom wiring harness. Separate the connectors from the taillight housing taking care not to damage the locking tabs (B).

Step 4

Insert the custom wiring harness end with yellow wire between the separated connectors. Make sure the connectors are fully inserted with locking tabs in place.

Step 5

Locate a suitable grounding point near the connector such as an existing screw with nut in the vehicle frame or drill a 3/32" pilot hole for the provided screw. The area should be free of rust, dirt and paint. Secure the white ground wire using the ring terminal and provided screw.

 **WARNING:** Check for miscellaneous items that may be hidden behind or under any surface before drilling to avoid damage and / or personal injury.

Step 6

Route the custom wiring harness end with the green wire down through the opening under the taillight, over to the passenger side along the backside of the bumper and up through the opening under the passenger side taillight (C). Repeat step 4 on the passenger side using the harness end with the green wire.

Step 7

Locate a flat clean surface that is out of the path of spray and debris from the rear wheels and road. Adhere the black converter box using the provided double-sided tape. Failure to mount the box in a protected area can cause loss of warranty, product failure, overheating and potential fire.

Step 8

Route the black power wire from the vehicle battery as shown on the included CME-PCL-INS sheet.

Step 9

When in use, route the 4-flat to the center of the vehicle. When not in use, roll up and store in a convenient, out of the way location. Secure any loose wires with the provided cable ties.

Step 10

Reinstall all items removed during install and reconnect negative battery terminal. Install the provided 4-flat dust cover to help prevent corrosion.

