

15316**99 - 03 FORD F-250 / F-350 SUPER DUTY WITH 10" STEP BUMPER
(FITS ONLY WITH 16" SPARE)****8/20/2012**

GROSS LOAD CAPACITY WHEN USED AS A WEIGHT CARRYING HITCH: 16,000 LBS. TRAILER WEIGHT & 2,400 LBS. TONGUE WEIGHT.
 GROSS LOAD CAPACITY WHEN USED AS A WEIGHT DISTRIBUTION HITCH: 17,000 LBS. TRAILER WEIGHT & 2,400 LBS. TONGUE WEIGHT

*****DO NOT EXCEED VEHICLE MANUFACTURER'S RECOMMENDED TOWING CAPACITY.*****

Parts List			
ITEM	QTY	PART NUMBER	DESCRIPTION
1	2	9/16-12 x 1 3/4, GR8	CARRIAGE BOLT
2	2	CM-SP73	.250 x 1.25 x 2.00" 9/16" SQUARE HOLE SPACER
3	2	9_16-12, GR8	HEX FLANGE NUT
4	6	1/2-13 x 1 3/4, GR8	CARRIAGE BOLT
5	8	1/2-13 x 1 1/4, GR8	CARRIAGE BOLT
6	6	CM-SP1	.250 x 1.50 x 2.00" SQUARE HOLE SPACER
7	14	HFN 1213, GR8	HEX FLANGE NUT

TOOLS REQUIRED
7/8" & 3/4" SOCKETS
12" EXTENSION
RATCHET
TORQUE WRENCH
LOCKING PLIERS / C-CLAMPS

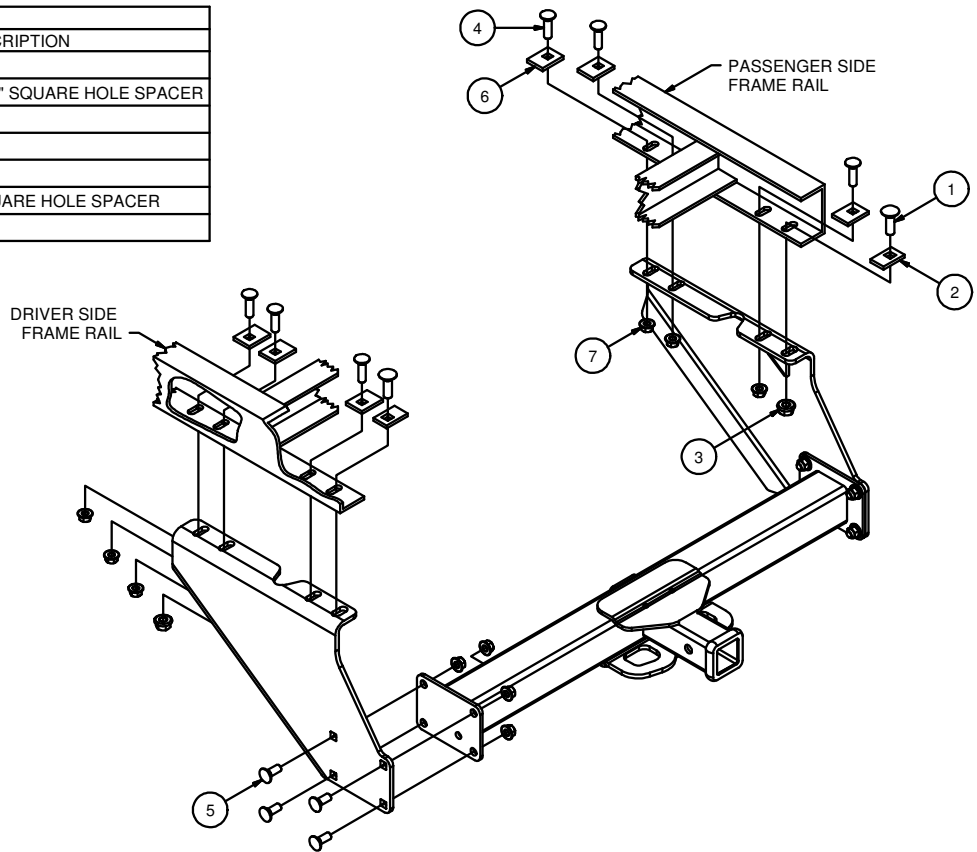

HITCH WEIGHT: 76 LBS.

INSTALL TIME

PROFESSIONAL: 30 MINUTES

NOVICE (DIY): 60 MINUTES

INSTALL NOTES:

- NO DRILLING REQUIRED

INSTALLATION STEPS

- Remove the spare tire to allow room to position the hitch.
- Determine which installation method will work best for your application (a or b):
 - Attaching the side plates to receiver tube assembly prior to installation:
Secure the receiver tube assembly to the driver and passenger side plates using 1/2" x 1 1/4" carriage bolts and hex flange nuts as shown. **NOTE:** Be sure the side plates are mounted with the flanges positioned inward.
 - Attaching the side plates to the frame prior to installation:
Align the frame rivets with the reliefs in the side plates. Loosely attach the side plates to the frame, as shown above. **NOTE:** Be sure 9/16" hardware is in vehicles rear most mounting locations and the side plates are mounted with the flanges positioned inward.
- Align the hitch under the vehicle so that the frame rivets align with the reliefs in the side plates. Use locking pliers or c-clamps to hold the hitch in place.
 - Raise the receiver tube assembly into position secure it to the driver and passenger side plates with 1/2" x 1 1/4" carriage bolts and hex flange nuts, as shown above.
- Loosely attach the side plates to the frame, as shown above. **NOTE:** Be sure 9/16" hardware is in vehicles rear most mounting locations.
 - Center hitch on vehicle and tighten frame hardware.
- Torque all 1/2" hardware to 110 ft-lbs and all 9/16" hardware to 150 ft-lbs.
- Reinstall the spare tire. **NOTE:** While raising the spare tire back into position, push the tire forward slightly and let it rest on the front of the receiver tube assembly.

PERIODICALLY CHECK THIS RECEIVER HITCH TO ENSURE THAT ALL FASTENERS ARE TIGHT AND THAT ALL STRUCTURAL COMPONENTS ARE SOUND.

