



# 13411 INSTALLATION INSTRUCTIONS

Safety glasses should be worn at all times while installing this product.

YEARS: 2012-2018

MAKE: MERCEDES BENZ

MODEL: ML350, GLE350, GLE43 AMG

STYLE: CROSSOVER

**WARNING: NEVER EXCEED YOUR VEHICLE MANUFACTURER'S RECOMMENDED TOWING CAPACITY**

**WEIGHT CARRYING:**  
TRAILER WEIGHT: 7,000 LBS.  
TONGUE WEIGHT: 700 LBS.

**WEIGHT DISTRIBUTION:**  
TRAILER WEIGHT: 7,000 LBS.  
TONGUE WEIGHT: 700 LBS.

**PRO INSTALL TIME: 40 MIN.**  
**NOVICE INSTALL TIME: 80 MIN.**  
*IF YOU ARE HESITANT TO UNDERTAKE THIS TASK ON YOUR OWN, CONTACT AN AUTHORIZED CURT INSTALLER FOR ADDITIONAL ASSISTANCE.*

**INSTALLATION**  
1. BEFORE YOU BEGIN INSTALLATION, READ ALL INSTRUCTIONS THOROUGHLY.  
2. TO EASE INSTALLATION, 2 PEOPLE MAY BE REQUIRED.  
3. USING PROPER TOOLS WILL GREATLY IMPROVE THE QUALITY OF THE INSTALL AND REDUCE THE TIME REQUIRED.



**INSTALLATION REQUIRES:**

|                                     |                     |                       |
|-------------------------------------|---------------------|-----------------------|
| RATCHET                             | TORQUE WRENCH       | BOXED END WRENCH 3/4" |
| E10 TORXBIT SOCKET                  | AVIATION SHEARS     | MARKER                |
| 10mm<br>13mm<br>16mm<br>3/4" SOCKET | 6" SOCKET EXTENSION | SAFETY GLASSES        |
|                                     |                     |                       |

**LEVEL OF DIFFICULTY: MODERATE**

| EASY | MODERATE                   | CHALLENGING |
|------|----------------------------|-------------|
|      | - NO DRILLING REQUIRED     |             |
|      | - TRIM HEAT SHIELD         |             |
|      | - REMOVE 3 BUMPER BRACKETS |             |
|      |                            |             |
|      |                            |             |

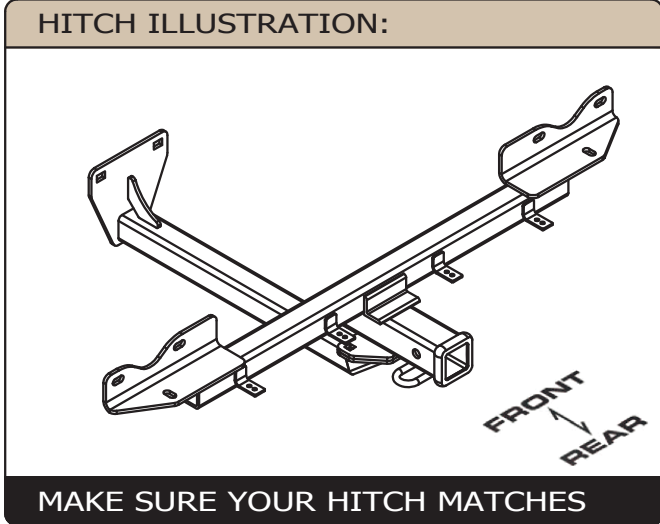

**PERIODICALLY CHECK THIS RECEIVER HITCH TO ENSURE ALL FASTENERS ARE TIGHT AND ALL STRUCTURAL COMPONENTS ARE SOUND**  
CURT Manufacturing LLC. warrants this product to be free of defects in material and/or workmanship at the time of retail purchase by the original purchaser. If the product is found to be defective, CURT Manufacturing LLC. may repair or replace the product at their option, when the product is returned, prepaid, with proof of purchase. Alteration to, misuse of, or improper installation of this product voids the warranty. CURT Manufacturing LLC.'s liability is limited to repair or replacement of products found to be defective, and specifically excludes liability for incidental or consequential loss or damage.

# INSTALLATION WALKTHROUGH:

| Parts List |     |             |  |
|------------|-----|-------------|--|
| ITEM       | QTY | PART NUMBER | DESCRIPTION                            |
| 1          | 1   | 13411-MBWA  | WELDMENT ASSEMBLY                      |
| 2          | 1   | 13411-TBC   | TAIL BRACKET CLAMP                     |
| 3          | 1   | 13411-TBWA  | TAIL BRACKET WELDING ASSEMBLY          |
| 4          | 2   | 10-10290    | BOLT, CAR, 1/2-13 UNC, 3, GRD8, YZ     |
| 5          | 2   | 10-10278    | BOLT, CAR, 1/2-13 UNC, 1-1/4, GRD8, YZ |
| 6          | 4   | 20-00062    | NUT, FLANGE, 1/2-13, GRD8              |

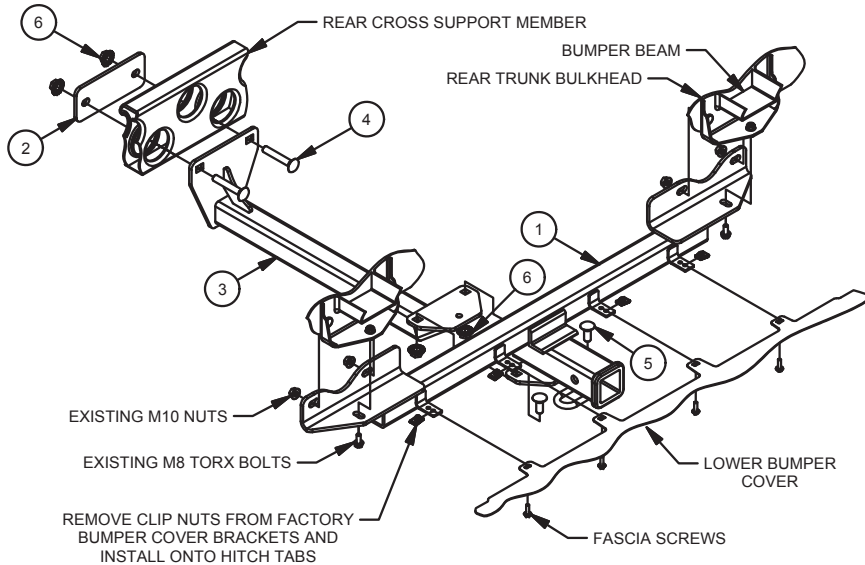

**HEAT SHIELD TRIM DIAGRAM (BOTH SIDES)  
(FOR REFERENCE ONLY)**

FRONT  
↓  
REAR

1. Remove (4) screws with a 10mm socket holding the lower bumper fascia to (3) brackets on the rear bulkhead. Remove the (3) brackets using a 10mm socket, outer brackets have (2) metal nuts and inner bracket has (1) plastic nut. Return brackets to vehicle owner.
2. Remove the (2) external Torx screws with a E10 Torx bit from the exhaust heat shield.

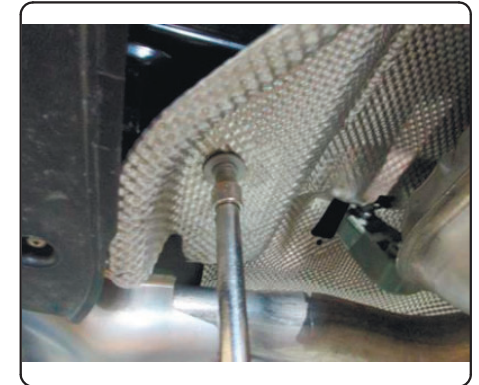

3. Trim the heat shield as needed and bend the center of the heat shield as needed to clear hitch. A reference diagram is shown to the left.
4. Remove (4) M10 nuts from the lower bumper beam studs using a 13mm socket. Trim caulking around the lower bumper studs as needed.





## INSTALLATION WALKTHROUGH:

5. Raise the main weldment (13411-MBWA) into position over the studs and loosely reinstall the (4) M10 nuts and (2) M8 screws removed in steps 4 and 2 respectively.



6. Place the Tail Bracket clamp plate (13411-TBC) between the rear differential and the cross member as shown below. Raise the Tail Bracket Weldment (13411-TBWA) into position between the Main Body Weldment and the vehicle cross member. Loosely install the 1/2" fasteners as shown on page 2.



7. Torque Fasteners in the following order:  
M8 fasteners to 25 lb-ft.  
M10 fasteners to 38 lb-ft.  
1/2" fasteners to 110 lb-ft.

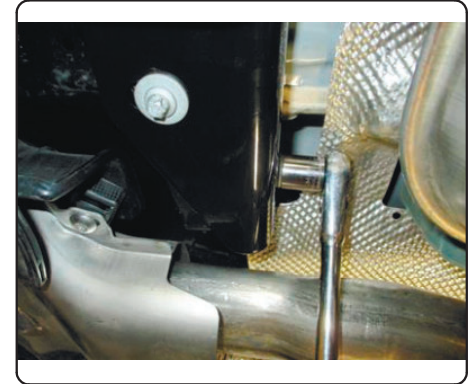
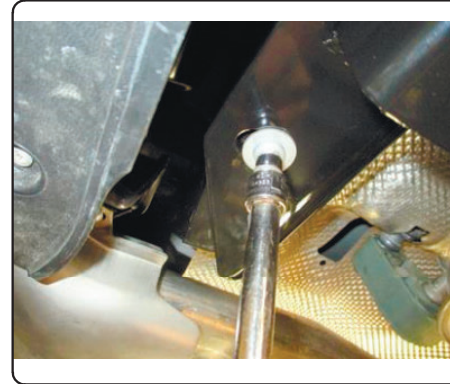

8. Remove the clip nuts from the (3) bumper brackets removed in step 1 and install onto the tabs on the Main Body Weldment. Align the clips with the lower bumper fascia tabs and reinstall the (4) screws removed in step 1.

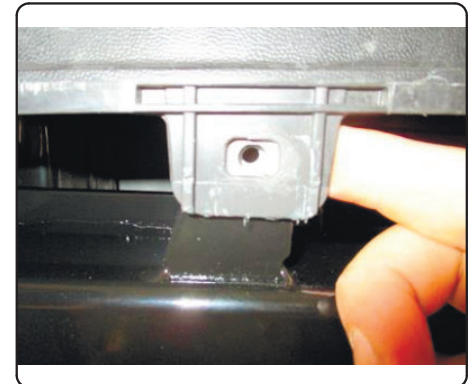

## TOWING SAFETY INFORMATION

### Gross Trailer Weight / GTW

The Gross Trailer Weight is the weight of the trailer & cargo. Measure this by putting the fully loaded trailer on a vehicle scale.

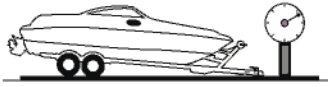

### Tongue Weight / TW

The downward force that is exerted on the hitch ball by the coupler. The tongue weight will vary depending on where the load is positioned in relationship to the trailer axle(s). To measure the tongue weight, use either a commercial scale or a bathroom scale with the coupler at towing height. When using a bathroom scale with heavier tongue weights, use the method shown and multiply the scale reading by 3.

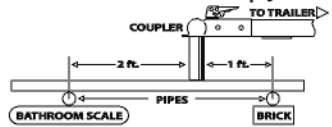

### Weight Carrying / WC

The total weight of both the trailer and the cargo inside. Never exceed the weight capacity of your trailer hitch.

### Weight Distribution / WD

Used to balance the weight of the cargo between the front and rear wheels throughout the trailer, allowing for better steering, braking, and level riding.



### Sway Control

A device used to reduce the lateral movements of the trailer that are caused by the wind. This works in conjunction with a weight distribution hitch. Do not use this on a class 1 or 2 hitch, or with surge brakes.

### How Much Can You Safely Tow?

| TONGUE WEIGHT (lb)  | 1000 | 2000 | 3000 | 4000 | 5000 | 6000 | 7000 | 8000 | 10,000 | 12,000 |
|---|------|------|------|------|------|------|------|------|--------|--------|
| Tongue weight should be about 10 to 15 percent of the gross trailer weight. |      |      |      |      |      |      |      |      |        |        |
| CLASS 1   |      |      |      |      |      |      |      |      |        |        |
| CLASS 2   |      |      |      |      |      |      |      |      |        |        |
| CLASS 3   |      |      |      |      |      |      |      |      |        |        |
| CLASS 4   |      |      |      |      |      |      |      |      |        |        |
| CLASS 5   |      |      |      |      |      |      |      |      |        |        |
| <b>Trailer Type</b>   |      |      |      |      |      |      |      |      |        |        |
| <b>Camper</b>   | 11'  | 12'  | 13'  | 14'  | 15'  | 16'  |      |      |        |        |
| lbs.  | 1100 | 1200 | 1300 | 1400 | 1500 | 1600 |      |      |        |        |
| <b>Vacation</b>   | 14'  | 16'  | 18'  | 20'  | 22'  | 24'  | 26'  | 28'  | 30'    | 32'    |
| lbs.  | 2100 | 2400 | 2700 | 3000 | 3300 | 3600 | 3900 | 4200 | 4500   | 4800   |
| <b>Vacation</b>   | 14'  | 16'  | 18'  | 20'  | 22'  | 24'  | 26'  | 28'  | 30'    | 32'    |
| lbs.  | 2800 | 3200 | 3600 | 4000 | 4400 | 4800 | 5200 | 5600 | 6000   | 6400   |
| <b>5th Wheel</b>  |      |      |      |      |      |      |      |      |        |        |

*Refer to owner's manual for towing capabilities and limitations.*

### Ball Mount

The ball mount is placed inside the opening of the receiver hitch which is mounted to the vehicle. Make sure a hitch pin and clip is properly securing the ball mount to the receiver hitch before you begin towing.

- A: Rise. B: Drop. C: Hole Size. D: Length.

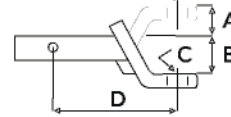

### Trailer Ball

The connection from the hitch to the trailer. There are many factors that determine the correct hitch ball:

- Number one is the hitch ball's gross trailer weight rating.
- The mounting platform must be at least 3/8" thick.
- The hole diameter must not be more than 1/16" larger than the threaded shank.
- Every time you tow, check the nut and lock washer to make sure they are fastened securely.
- A: Ball Dia. B: Shank Length. C: Shank Dia. D: Shank Rise.

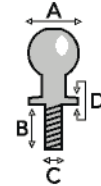

### Coupler

The component that is placed over the trailer ball to connect the vehicle to the trailer. Be sure that the coupler size matches the size of the hitch ball and that the coupler handle is securely fastened. To determine what size hitch ball you need for your application you will need to know the size of coupler that is on the trailer. Be sure your coupler is properly adjusted to the ball you are using.

NOTE: For added security the use of safety devices such as Coupler Safety Pins and Locks is strongly recommended.

### Safety Chains

Safety chains are a requirement and should be crossed under the tongue of the trailer so that the tongue will not drop to the road if it becomes separated from the hitch. Always leave enough slack so you can turn. Never allow the safety chains to drag on the ground and never attach the chains to the bumper.

Trailer Classification: Safety Chain Breaking Force - Minimum

Class 1: 2,000 lbs. (8.9 kN)

Class 2: 3,500 lbs. (15.6 kN)

Class 3: 5,000 lbs. (22.2 kN)

The strength rating of each length of safety chain or its equivalent and its attachments shall be equal to or exceed in minimum breaking force the GVWR (Gross Vehicle Weight Rating) of the trailer.

### Electrical

Trailer lights, Electric Brakes, Break-away systems - Every time you tow, be sure to check that all components are working properly.

Wiring identification by color:

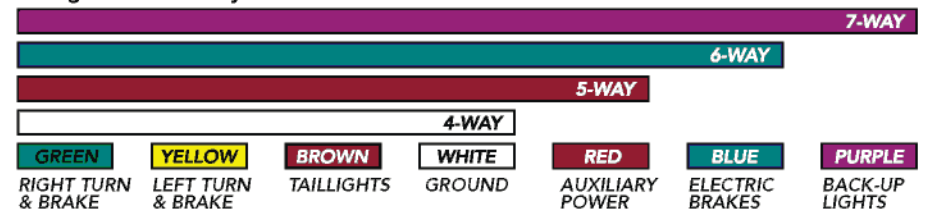

CURT DISCLAIMER: WIRING COLOR SHOWN WORK IN CONJUNCTION WITH CURT MANUFACTURING PRODUCTS.

13411

## MERCEDES BENZ ML350, GLE350, GLE43 AMG

7/3/2019

GROSS LOAD CAPACITY WHEN USED AS A WEIGHT CARRYING HITCH: 7,000 LBS. TRAILER WEIGHT & 700 LBS. TONGUE WEIGHT.  
 GROSS LOAD CAPACITY WHEN USED AS A WEIGHT DISTRIBUTION HITCH: 7,000 LBS. TRAILER WEIGHT & 700 LBS. TONGUE WEIGHT



**WARNING: \*\*\* DO NOT EXCEED VEHICLE MANUFACTURER'S RECOMMENDED TOWING CAPACITY. \*\*\***



| Parts List |     |             |  |
|------------|-----|-------------|--|
| ITEM       | QTY | PART NUMBER | DESCRIPTION                            |
| 1          | 1   | 13411-MBWA  | WELDMENT ASSEMBLY                      |
| 2          | 1   | 13411-TBC   | TAIL BRACKET CLAMP                     |
| 3          | 1   | 13411-TBWA  | TAIL BRACKET WELDING ASSEMBLY          |
| 4          | 2   | 10-10290    | BOLT, CAR, 1/2-13 UNC, 3, GRD8, YZ     |
| 5          | 2   | 10-10278    | BOLT, CAR, 1/2-13 UNC, 1-1/4, GRD8, YZ |
| 6          | 4   | 20-00062    | NUT, FLANGE, 1/2-13, GRD8              |

| TOOLS REQUIRED                 |
|--------------------------------|
| RATCHET                        |
| TORQUE WRENCH                  |
| 10mm, 13mm, 16mm, 3/4" SOCKETS |
| AVIATOR SHEARS                 |
| E10 EXTERNAL TORX BIT          |
| 3/4" BOXED END WRENCH          |
| 6" SOCKET EXTENSION            |
| MARKER                         |
| SAFETY GLASSES                 |

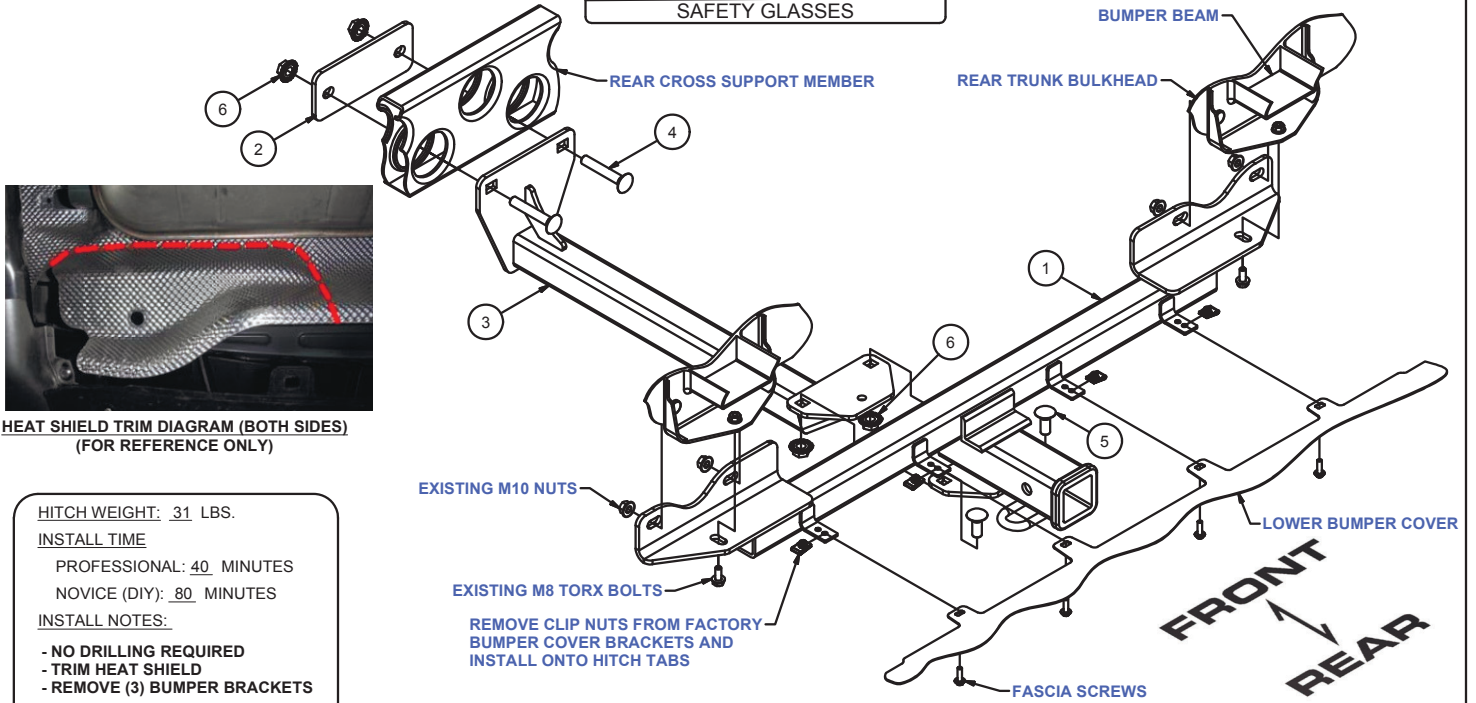

HEAT SHIELD TRIM DIAGRAM (BOTH SIDES)  
(FOR REFERENCE ONLY)

HITCH WEIGHT: 31 LBS.

INSTALL TIME

PROFESSIONAL: 40 MINUTES

NOVICE (DIY): 80 MINUTES

INSTALL NOTES:

- NO DRILLING REQUIRED
- TRIM HEAT SHIELD
- REMOVE (3) BUMPER BRACKETS

REMOVE CLIP NUTS FROM FACTORY  
BUMPER COVER BRACKETS AND  
INSTALL ONTO HITCH TABS

## INSTALLATION STEPS

- Remove (4) screws with a 10mm socket holding the lower bumper fascia to (3) brackets on the rear bulkhead. Remove the (3) brackets using a 10mm socket, outer brackets have (2) metal nuts and inner bracket has (1) plastic nut. Return brackets to vehicle owner.
- Remove the (2) external Torx screws with a E10 Torx bit from the exhaust heat shield.
- Trim the heat shield as needed and bend the center of the heat shield as needed to clear hitch. A reference diagram is shown above.
- Remove (4) M10 nuts from the lower bumper beam studs using a 13mm socket. Trim caulking around the lower bumper studs as needed.
- Raise the main weldment (13411-MBWA) into position over the studs and loosely reinstall the (4) M10 nuts and (2) M8 screws removed in steps 4 and 2 respectively.
- Place the Tail Bracket clamp plate (13411-TBC) between the rear differential and the cross member as shown above. Raise the Tail Bracket Weldment (13411-TBWA) into position between the Main Body Weldment and the vehicle cross member. Loosely install the 1/2" fasteners as shown above.
- Torque Fasteners in the following order:
  - M8 fasteners to 25 lb-ft.
  - M10 fasteners to 38 lb-ft.
  - 1/2" fasteners to 110 lb-ft.
- Remove the clip nuts from the (3) bumper brackets removed in step 1 and install onto the tabs on the Main Body Weldment. Align the clips with the lower bumper fascia tabs and reinstall the (4) screws removed in step 1.

**PERIODICALLY CHECK THIS RECEIVER HITCH TO ENSURE THAT ALL FASTENERS ARE TIGHT AND THAT ALL STRUCTURAL COMPONENTS ARE SOUND.**