



11563 INSTALLATION INSTRUCTIONS



Safety glasses should be worn at all times while installing this product.

YEARS: 2019-PRESENT

MAKE: NISSAN

MODEL: KICKS

STYLE: CUV



WARNING: NEVER EXCEED YOUR VEHICLE MANUFACTURER'S RECOMMENDED TOWING CAPACITY

WEIGHT CARRYING:

TRAILER WEIGHT: 2,000 LBS.
TONGUE WEIGHT: 200 LBS.

WARNING:

ALL NON-TRAILER (WHEEL-LESS) LOADS APPLIED TO THIS PRODUCT MUST BE SUPPORTED BY 18050 STABILIZING STRAPS.

PRO INSTALL TIME: **45 MIN.**
NOVICE INSTALL TIME: **90 MIN.**

INSTALLATION TIPS:

1. BEFORE YOU BEGIN INSTALLATION, READ ALL INSTRUCTIONS THOROUGHLY.
2. TO EASE INSTALLATION, 2 PEOPLE MAY BE REQUIRED.
3. USING PROPER TOOLS WILL GREATLY IMPROVE THE QUALITY OF THE INSTALL AND REDUCE THE TIME REQUIRED.

LEVEL OF DIFFICULTY: **MODERATE**

EASY / **MODERATE** / **CHALLENGING**



NO DRILL



TEMPORARILY REMOVE PARTS

VEHICLE PHOTO:







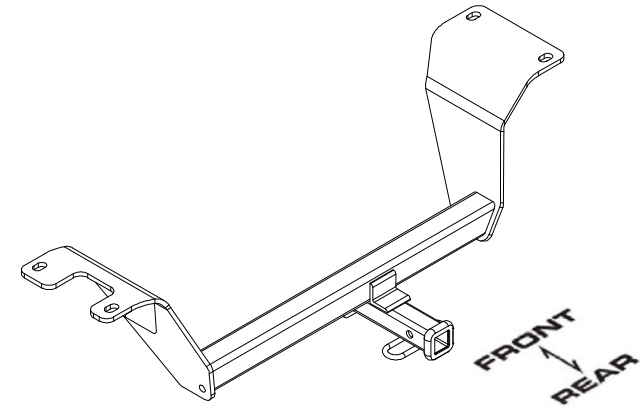

REPRESENTATIVE PHOTO

HITCH ILLUSTRATION:

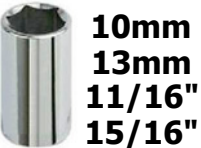

MAKE SURE YOUR HITCH MATCHES

INSTALLATION REQUIRES:

 RATCHET	 TORQUE WRENCH	 8" SOCKET EXTENSION
 SOCKETS	 PRY BAR	 AVIATION SHEARS
 DIE GRINDER	 SAFETY GLASSES	

CURT are proud to offer a high quality product at the industries most competitive pricing!

PERIODICALLY CHECK THIS RECEIVER HITCH TO ENSURE ALL FASTENERS ARE TIGHT AND ALL STRUCTURAL COMPONENTS ARE SOUND

CURT Manufacturing LLC. warrants this product to be free of defects in material and/or workmanship at the time of retail purchase by the original purchaser. If the product is found to be defective, CURT Manufacturing LLC. may repair or replace the product at their option, when the product is returned, prepaid, with proof of purchase. Alteration to, misuse of, or improper installation of this product voids the warranty. CURT Manufacturing LLC.'s liability is limited to repair or replacement of products found to be defective, and specifically excludes liability for incidental or consequential loss or damage.

INSTALLATION WALKTHROUGH:

Parts List			
ITEM	QTY	PART NUMBER	DESCRIPTION
1	4	7_16 FISHWIRE	7/16" FISHWIRE
2	4	CM-SP2	.250 x .88 x 2.25" SQUARE HOLE SPACER
3	4	7/16-14 x 1 1/4	CARRIAGE BOLT
4	4	7/16-14	HEX FLANGE NUT

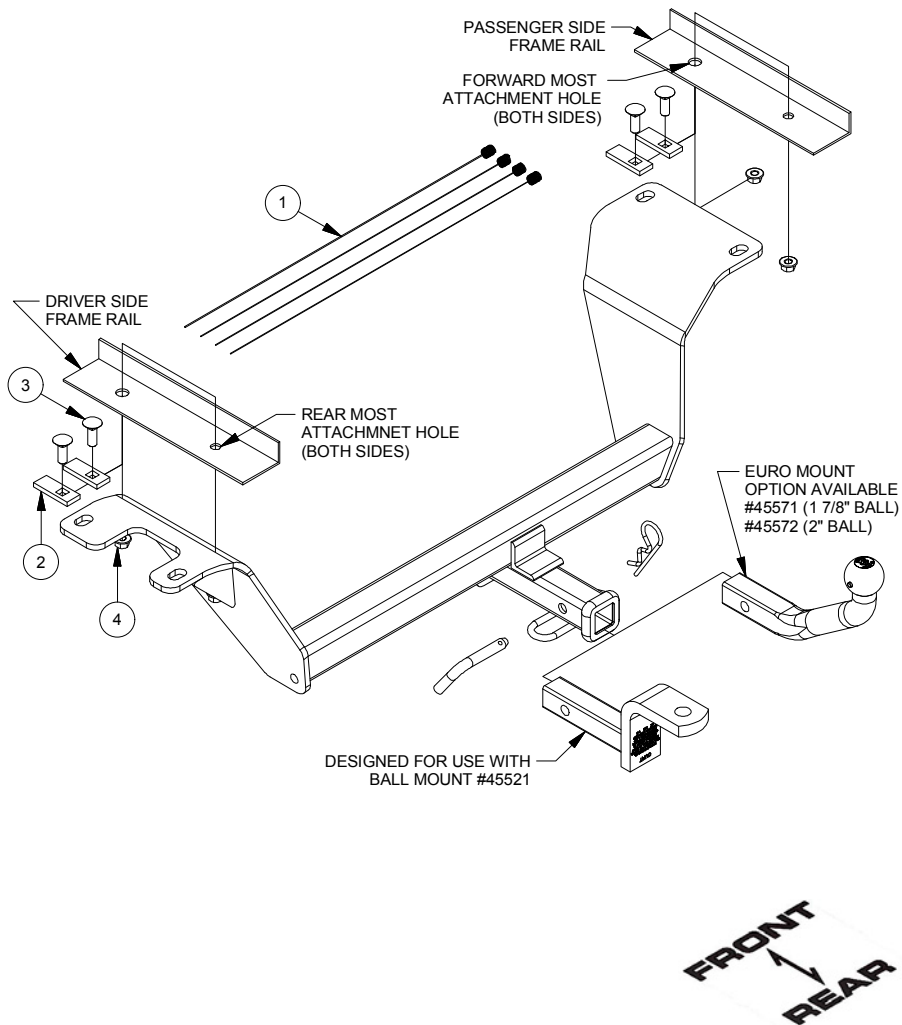

1. Locate on driver side frame rail and temporarily remove emissions canister by removing (1) fastener using 10mm socket.

NOTE: If present remove frame rail plug, to access rear mounting point on driver side.

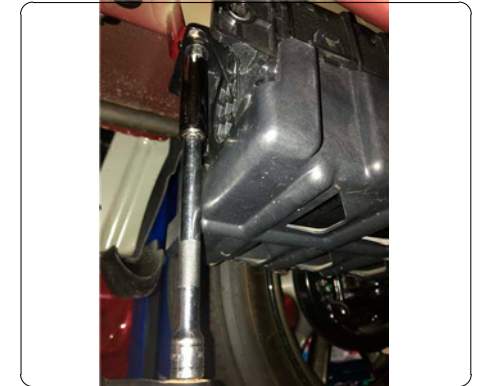

2. On passenger side lower exhaust by removing (2) exhaust isolators, using isolator removal diagram, to expose heat shield. Remove (4) speed nuts to lower heatshield from frame rail.

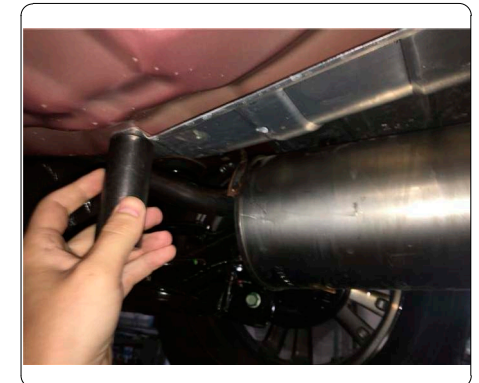
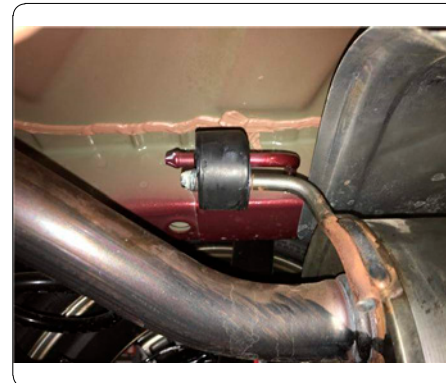

INSTALLATION WALKTHROUGH:

3. Trim heat shield as shown in the heat shield diagram.
NOTE: All dimensions are approximate, confirm fit prior to trimming



4. Enlarge forward most attachment hole on both sides using a die grinder. Use hole enlargement diagram as a reference.

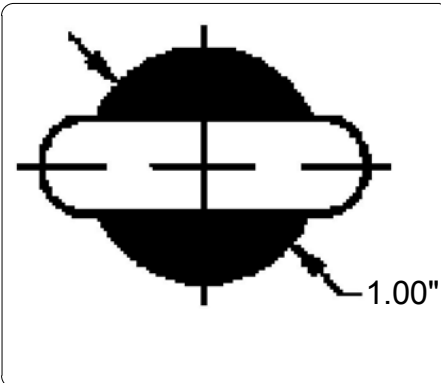
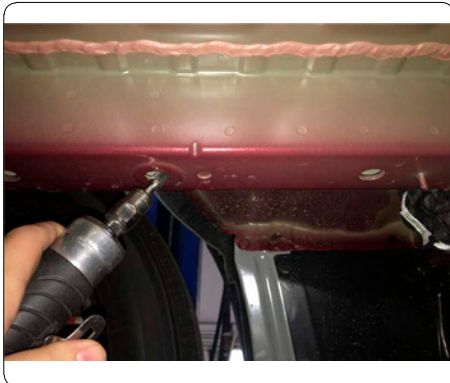

5. Fishwire (1) carriage bolt and (1) CM-SP2 spacer through enlarged hole and out rearmost hole, on each side, as shown in the Fishwire Technique Diagram.

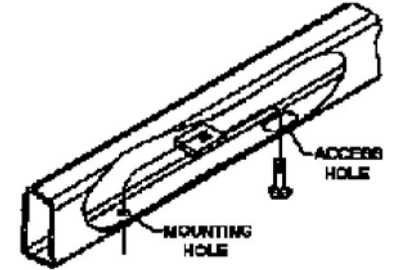
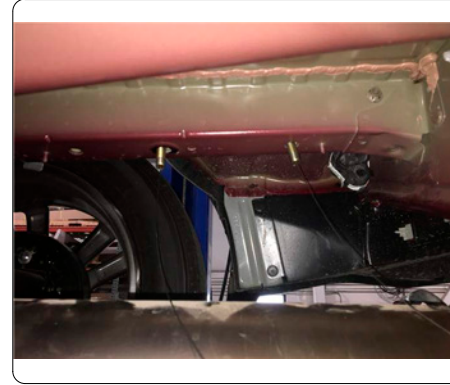

6. Reverse fishwire (1) carriage bolt and (1) CM-SP2 spacer through enlarged hole, on each side, as shown in the Reverse Fishwire Diagram.

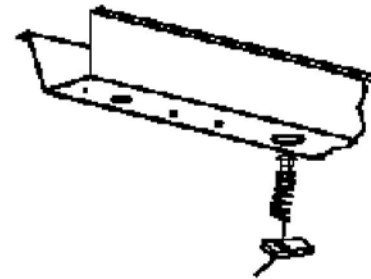

INSTALLATION WALKTHROUGH:

7. Reinstall trimmed heatshield and raise hitch into position.



8. Torque all 7/16 hardware to 59 ft-lbs. Reinstall emissions canister, raise exhaust into position.

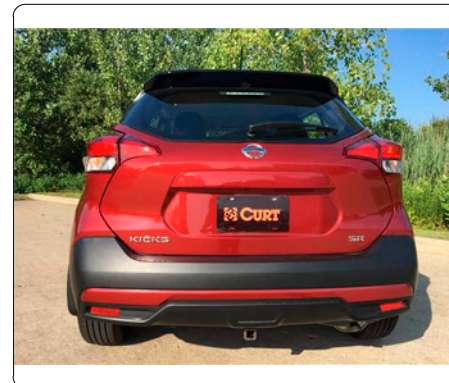
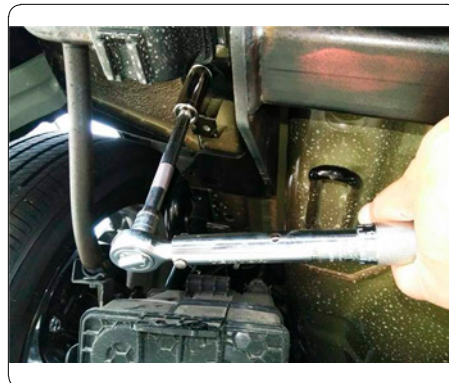

TOWING SAFETY INFORMATION

Gross Trailer Weight / GTW

The Gross Trailer Weight is the weight of the trailer & cargo. Measure this by putting the fully loaded trailer on a vehicle scale.



Tongue Weight / TW

The downward force that is exerted on the hitch ball by the coupler. The tongue weight will vary depending on where the load is positioned in relationship to the trailer axle(s). To measure the tongue weight, use either a commercial scale or a bathroom scale with the coupler at towing height. When using a bathroom scale with heavier tongue weights, use the method shown and multiply the scale reading by 3.

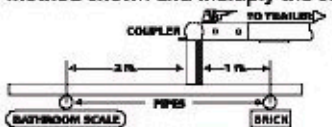

Weight Carrying / WC

The total weight of both the trailer and the cargo inside. Never exceed the weight capacity of your trailer hitch.

Weight Distribution / WD

Used to balance the weight of the cargo between the front and rear wheels throughout the trailer, allowing for better steering, braking, and level riding.



Sway Control

A device used to reduce the lateral movements of the trailer that are caused by the wind. This works in conjunction with a weight distribution hitch. Do not use this on a class 1 or 2 hitch, or with surge brakes.

How Much Can You Safely Tow?

TONGUE WEIGHT (lb)	1000	2000	3000	4000	5000	6000	7000	8000	10,000	12,000
Tongue weight should be about 10 to 15 percent of the gross trailer weight.										
CLASS 1										
CLASS 2										
CLASS 3										
CLASS 4										
CLASS 5										
TRAILER TYPE										
Coupler	11"	12"	12"	14"	16"	16"				
	Inc. 1100	1200	1300	1400	1500	1600				
W/coupler	14"	16"	16"	18"	20"	24"	24"	26"	26"	32"
	Inc. 2100	2400	2700	3000	3300	3600	3900	4200	4500	4800
W/coupler	14"	16"	16"	20"	22"	24"	26"	26"	30"	32"
	Inc. 2800	3200	3600	4000	4400	4800	5200	5600	6000	6400
3rd Wheel										
Refer to owner's manual for towing capabilities and limitations.										

Ball Mount

The ball mount is placed inside the opening of the receiver hitch which is mounted to the vehicle. Make sure a hitch pin and clip is properly securing the ball mount to the receiver hitch before you begin towing.

• A: Rise. B: Drop. C: Hole Size. D: Length.

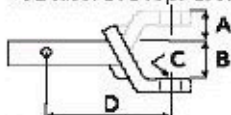

Trailer Ball

The connection from the hitch to the trailer. There are many factors that determine the correct hitch ball:

- Number one is the hitch ball's gross trailer weight rating.
- The mounting platform must be at least 3/8" thick.
- The hole diameter must not be more than 1/16" larger than the threaded shank.
- Every time you tow, check the nut and lock washer to make sure they are fastened securely.

• A: Ball Dia. B: Shank Dia. C: Shank Length. D: Shank Rise.

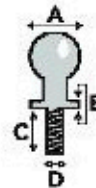

Coupler

The component that is placed over the trailer ball to connect the vehicle to the trailer. Be sure that the coupler size matches the size of the hitch ball and that the coupler handle is securely fastened. To determine what size hitch ball you need for your application you will need to know the size of coupler that is on the trailer. Be sure your coupler is properly adjusted to the ball you are using.

NOTE: For added security the use of safety devices such as Coupler Safety Pins and Locks is strongly recommended.

Safety Chains

Safety chains are a requirement and should be crossed under the tongue of the trailer so that the tongue will not drop to the road if it becomes separated from the hitch. Always leave enough slack so you can turn. Never allow the safety chains to drag on the ground and never attach the chains to the bumper.

Trailer Classification: Safety Chain Breaking Force - Minimum

Class 1: 2,000 lbs. (8.9 kN)

Class 2: 3,500 lbs. (15.6 kN)

Class 3: 5,000 lbs. (22.2 kN)

The strength rating of each length of safety chain or its equivalent and its attachments shall be equal to or exceed in minimum breaking force the GVWR (Gross Vehicle Weight Rating) of the trailer.

Electrical

Trailer lights, Electric Brakes, Break-away systems - Every time you tow, be sure to check that all components are working properly.

Wiring identification by color:



GREEN YELLOW BROWN WHITE RED BLUE PURPLE

11563

NISSAN KICKS

GROSS LOAD CAPACITY WHEN USED AS A WEIGHT CARRYING HITCH: 2,000 LBS. TRAILER WEIGHT & 200 LBS. TONGUE WEIGHT.

WARNING: ALL NON-TRAILER (WHEEL-LESS) LOADS APPLIED TO THIS PRODUCT MUST BE SUPPORTED BY 18050 STABILIZING STRAPS.

**WARNING: ** FAILURE TO PROPERLY SUPPORT NON-TRAILER LOADS WILL VOID PRODUCT WARRANTY ******WARNING: *** DO NOT EXCEED VEHICLE MANUFACTURER'S RECOMMENDED TOWING CAPACITY**

Parts List			
ITEM	QTY	PART NUMBER	DESCRIPTION
1	4	7_16 FISHWIRE	7/16" FISHWIRE
2	4	CM-SP2	.250 x .88 x 2.25" SQUARE HOLE SPACER
3	4	7/16-14 x 1 1/4	CARRIAGE BOLT
4	4	7/16-14	HEX FLANGE NUT

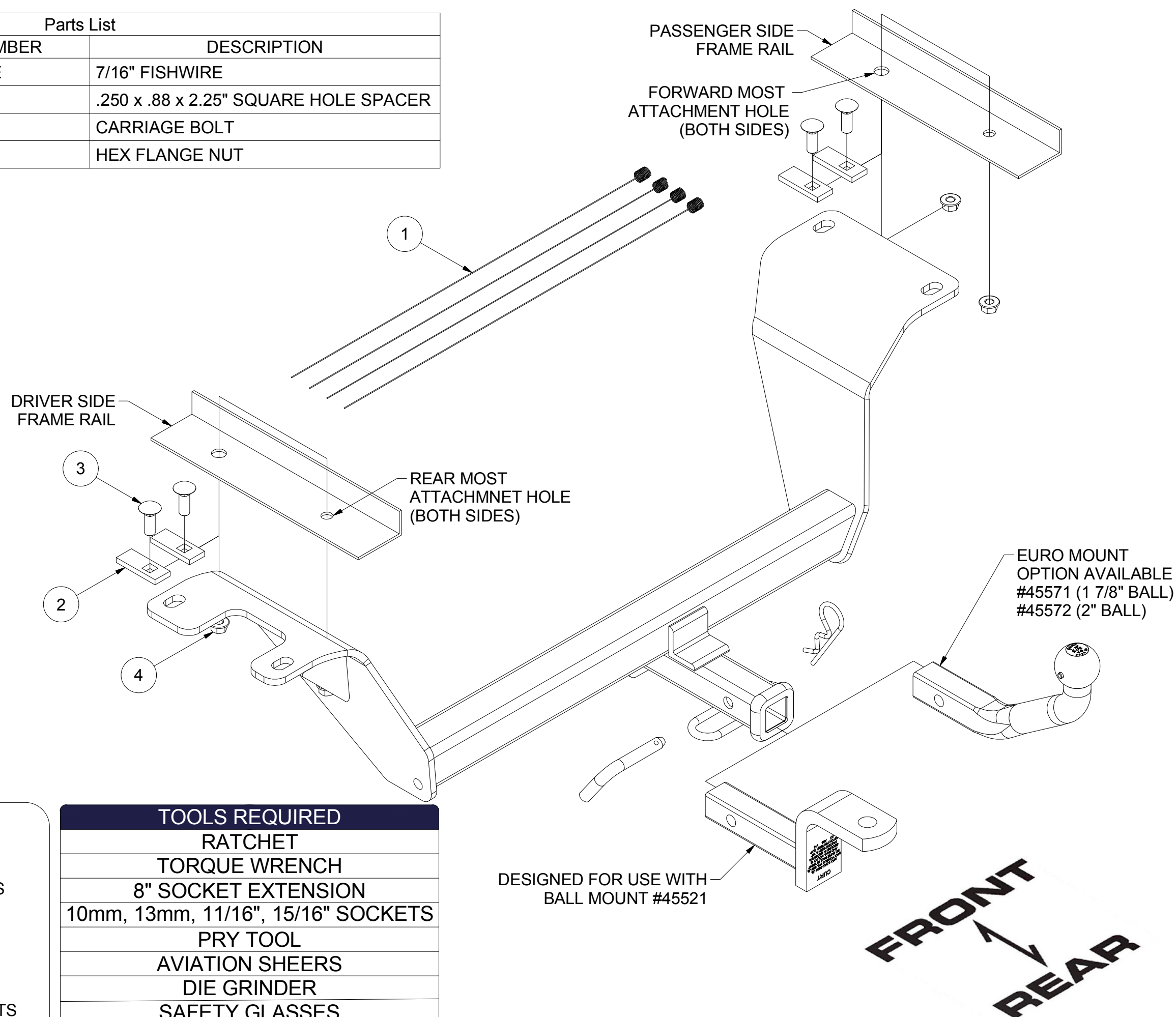

HITCH WEIGHT: 26 LBS.

INSTALL TIME

PROFESSIONAL: 30 MINUTES

NOVICE (DIY): 60 MINUTES

INSTALL NOTES:

-NO DRILL

-NO TRIM

-TEMPORARILY REMOVE PARTS

TOOLS REQUIRED

RATCHET

TORQUE WRENCH

8" SOCKET EXTENSION

10mm, 13mm, 11/16", 15/16" SOCKETS

PRY TOOL

AVIATION SHEERS

DIE GRINDER

SAFETY GLASSES

DESIGNED FOR USE WITH
BALL MOUNT #45521FRONT
↑
REAR

INSTALLATION STEPS

1. Locate on driver side frame rail and temporarily remove emissions canister by removing (1) fastener using 10mm socket.
NOTE: If present remove frame rail plug, to access rear mounting point on driver side.
2. On Passenger side lower exhaust by removing (2) exhaust isolators, using isolator removal diagram, to expose heat shield. Remove heat shield by removing 4 speed nuts.
3. Trim heat shield as shown in the heat shield diagram.
NOTE: All dimensions are approximate, confirm fit prior to trimming.
4. Enlarge forward most attachment hole using a die grinder. Use hole enlargement diagram as a reference.
5. Fishwire 7/16 hardware through enlarged hole and out rear most attachment hole. Use fishwire diagram as a reference.
6. Reverse fishwire 7/16 hardware through enlarged hole. Use reverse fishwire diagram as a reference.
7. Reinstall trimmed heat shield and raise hitch into position.
8. Torque all 7/16 hardware to 59 ft-lbs. Reinstall emissions canister, raise exhaust into vehicle position.

PERIODICALLY CHECK THIS RECEIVER HITCH TO ENSURE THAT ALL FASTENERS ARE TIGHT AND THAT ALL STRUCTURAL COMPONENTS ARE SOUND.

CURT Manufacturing LLC., warrants this product to be free of defects in material and/or workmanship at the time of retail purchase by the original purchaser. If the product is found to be defective, CURT Manufacturing LLC., may repair or replace the product, at their option, when the product is returned, prepaid, with proof of purchase. Alteration to, misuse of, or improper installation of this product voids the warranty. CURT Manufacturing LLC.'s liability is limited to repair or replacement of products found to be defective, and specifically excludes liability for incidental or consequential loss or damage.

This product complies with safety specifications and requirements for connecting devices and towing systems of the state of New York, V.E.S.C.Regulation V-5 and SAE J684.