

INSTALLATION INSTRUCTIONS

DO NOT EXCEED PRODUCT RATING OR TOW VEHICLE LAMP LOAD RATING, WHICHEVER IS LOWER

56295 APPLICATIONS

Make	Model
Kia	Rio 5-door

VEHICLE-TO-TRAILER WIRING HARNESS

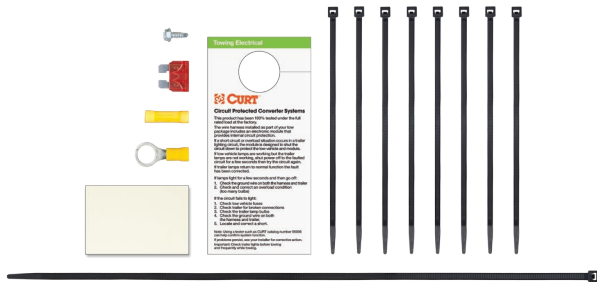
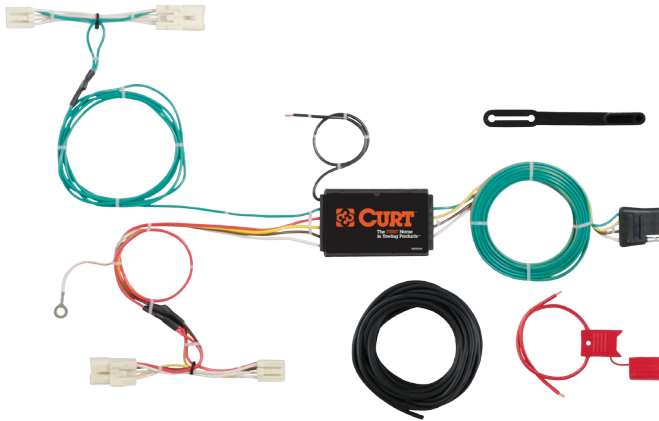

WIRING LOCATION GUIDE

PASSENGER CARS (P)

Representative vehicle shown below

P3 - Behind driver side taillight housing, inside of trunk

P4 - Behind passenger side taillight housing, inside of trunk



NOTE

All steps must be followed to ensure the CURT wiring harness will function properly. Once installed, test for proper function by using a test light or connecting a properly wired trailer.

TOOLS NEEDED

- Panel trim removal tool
- Phillips screwdriver
- Wire stripper
- Crimping tool
- Cutting tool

WARNING

The battery connection must be fuse protected, 10 amp max. Exceeding the product rating can cause loss of warranty, overheating and potential fire. Do not exceed product rating or tow vehicle lamp load rating, whichever is lower.

Signal Circuits - 3.0 amps per side
Tail / Running Circuits - 6.0 amps total

Check vehicle owner's manual or contact the vehicle manufacturer for more information.

INSTALLATION

Step 1

Locate vehicle battery on the driver side under the hood and disconnect the negative battery terminal.

Step 2

Open the vehicle hatchback. Remove the hatch package tray and all floor coverings (A,B). Remove the scuff panel by pulling out on the bottom and then up (C).

Step 3

Starting on the driver side, remove the Phillips screws from the side trim panel (D,E). Pull back on the side trim panel taking care not to damage the alignment tabs on the back (F).

Step 4

Behind the removed trim panel locate the vehicle taillight wiring harness connectors. The connectors will be similar to those on the CURT wiring harness. Separate the connectors from the taillight housing taking care not to damage the locking tabs (G).

Step 5

Insert the CURT wiring harness end with yellow wire between the separated connectors. Make sure the connectors are fully inserted with locking tabs in place.

Step 6

Locate a suitable grounding point near the connector such as an existing screw with nut in the vehicle frame or drill a 3/32" pilot hole for the provided screw. The area should be free of rust, dirt and paint. Secure the white ground wire using the ring terminal and provided screw.

WARNING: Check for miscellaneous items that may be hidden behind or under any surface before drilling to avoid damage and / or personal injury.

Step 7

Route the CURT wiring harness end with the green wire to the passenger side behind the removed scuff panels. Repeat steps 3-5 on the passenger side using the harness end with the green wire.

Step 8

Route the black power wire from the vehicle battery as shown on the included CME-PCL-INS sheet.

Step 9

Locate a flat spot inside the vehicle, near the taillight. Adhere the black converter box using the provided double-sided tape.

Step 10

When in use, route the 4-flat to the center of the vehicle. When not in use, roll up and store in a convenient, out of the way location. Secure any loose wires with the provided cable ties.

Step 11

Reinstall all items removed during install and reconnect negative battery terminal. Install the provided 4-flat dust cover to help prevent corrosion.

