

INSTALLATION INSTRUCTIONS

DO NOT EXCEED PRODUCT RATING OR TOW VEHICLE LAMP LOAD RATING, WHICHEVER IS LOWER

56270 APPLICATIONS

Make	Model
Ram	ProMaster City

VEHICLE-TO-TRAILER WIRING HARNESS

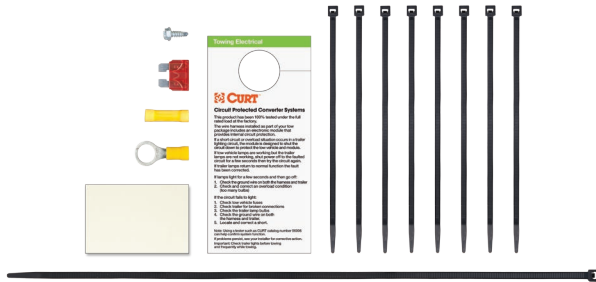
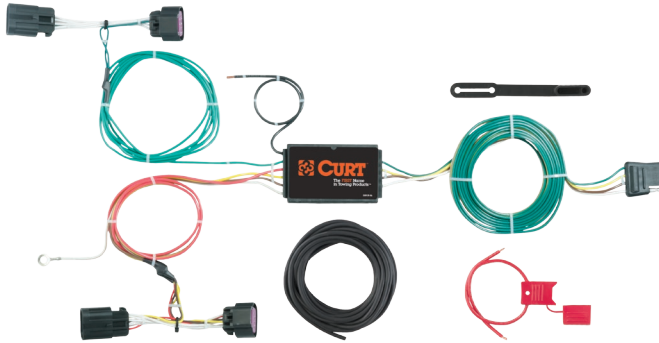

WIRING LOCATION GUIDE

SUVs, MINI & FULL-SIZED VANS (S)

Representative vehicle shown below

S3 - Behind driver side rear access panel

S4 - Behind passenger side rear access panel



NOTE

All steps must be followed to ensure the CURT wiring harness will function properly. Once installed, test for proper function by using a test light or connecting a properly wired trailer.

TOOLS NEEDED

- Panel trim removal tool
- Phillips screwdriver
- Wire stripper
- Crimping tool
- Side cutter
- Fish wire
- Right angle pick

WARNING

The battery connection must be fuse protected, 10 amp max. Exceeding the product rating can cause loss of warranty, overheating and potential fire. Do not exceed product rating or tow vehicle lamp load rating, whichever is lower.

Signal Circuits - 7.5 amps per side

Tail / Running Circuits - 7.5 amps total

INSTALLATION

Step 1

Locate vehicle battery on the driver side under the hood and disconnect the negative battery terminal.

Step 2

Open the rear cargo doors (A). Starting on the driver side, locate the yellow push latch and push the latch in to be able to open cargo door past 90° (B).

Step 3

Locate and remove the Phillips screws holding the taillight in place (C). Remove the taillight to access the vehicle taillight wiring harness. The connectors will be similar to those on the CURT wiring harness. Separate the connectors from the taillight housing taking care not to damage the locking tabs (D).

Step 4

Insert the CURT wiring harness end with yellow wire into the top frame hole on the driver side (E). Fish wire it down the channel leading to the rear of the taillight connector. Route the end through the opening and insert the CURT wiring harness end with yellow wire between the separated connectors (F). Make sure the connectors are fully inserted with locking tabs in place. Reinstall the taillight.

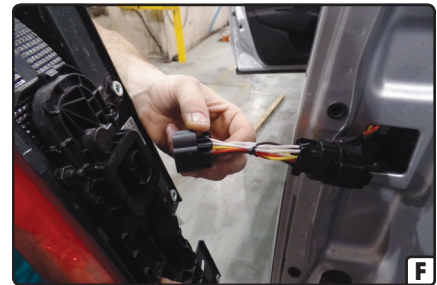
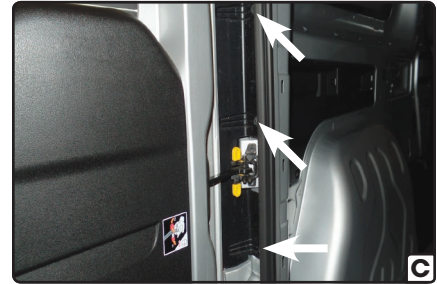
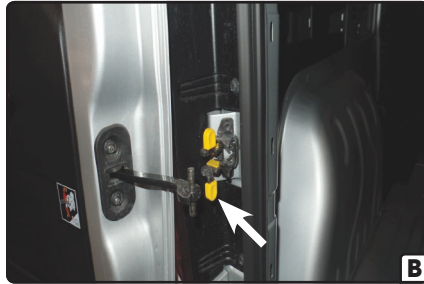

INSTALLATION CONTINUED

Step 5

Remove the dome light located inside the rear cargo area, above the cargo doors (G).

Step 6

Run a long fish wire into the top frame hole on the passenger side above the cargo door towards the center of the vehicle. Use the hole from the removal of the dome light to guide the fish wire all the way to the driver side of the vehicle.

Step 7

Using the routed wire, fasten the CURT wiring harness end with the green wire to it. Route CURT the wiring harness end with the green wire to the passenger side (H, I, J). Repeat step 5 on the passenger side using the harness end with the green wire.

WARNING: Check for miscellaneous items that may be hidden behind or under any surface before drilling to avoid damage and / or personal injury.

Step 8

Locate a suitable grounding point near the connector such as an existing screw with nut in the vehicle frame or drill a 3/32" pilot hole for the provided screw. The area should be free of rust, dirt and paint. Secure the white ground wire using the ring terminal and provided screw.

Step 9

Inside the cargo area, on the driver side, locate a flat spot on the upper corner inside the rear cargo door frame. Adhere the black converter box using the provided double-sided tape (K).

Step 10

Route the black power wire from the vehicle battery as shown on the included CME-PCL-INS sheet.

Step 11

Remove the 12V DC accessory port cover located near the floor on the driver side. Route the 4-flat wire through the top frame hole where the converter is installed and down out the bottom of the 12V DC accessory hole. Reinstall the 12V DC accessory cover and coil the 4-flat wire for storage when it is not in use (L).

Step 12

Reinstall all items removed during install and reconnect negative battery terminal. Install the provided 4-flat dust cover to help prevent corrosion.

