



Quick Start Guide P4500i

TOOLS YOU WILL NEED



Utility Knife (not included)



Fresh clean unleaded gasoline (not included)



Funnel (included)



Screw Driver (not included)



4-stroke engine oil (included)

BEFORE STARTING

1. Add Engine Oil

- Unclip and remove the oil service panel to access the oil/fill drain plug.
- Remove oil fill plug/dipstick.
- Using the supplied 4-cycle engine oil and funnel, slowly add engine oil to the engine until full.
- Do not overfill, if oil level is too high, oil will drain out through the fill plug.

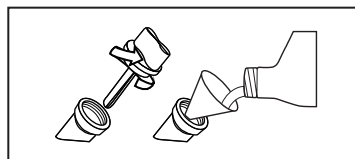
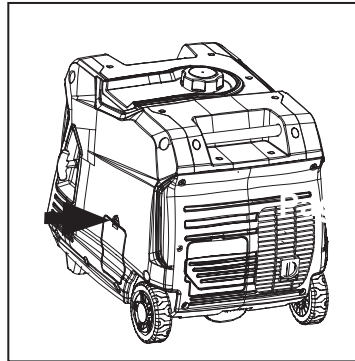

2. Add Unleaded Gasoline to Gas Tank

- Unscrew gas cap on top of tank and insert a clean funnel into the tank.
- Slowly add gasoline into the fuel tank. The gasoline level should NOT be higher than the filler neck.
- Secure gas cap.

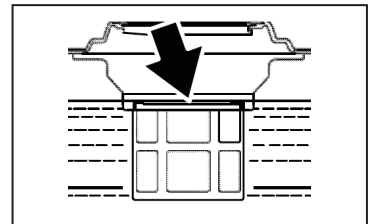

3. Choose safe location to start generator

- Make sure you are outside and 15ft (4.5m) away from any doors or windows.
- Only operate on flat, dry surfaces. Do not move the generator while it is running. Do not refill gas while generator is running.

MANUAL STARTING

1. Make sure nothing is plugged into power outlets.

2. Remove battery access cover and connect battery leads.

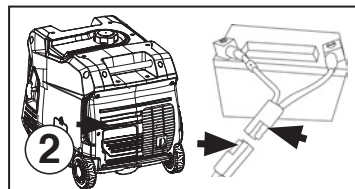

3. Make sure the circuit breakers are properly set to operating.

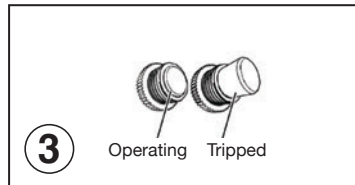

4. Turn the Fuel Control Switch to the ON position.

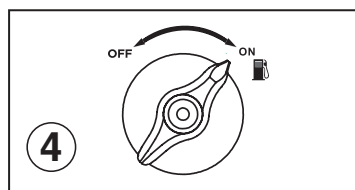

5. Switch Engine Control Switch to RUN.

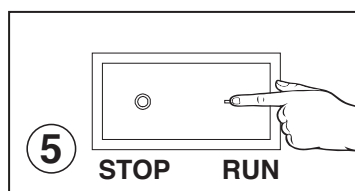

6. Firmly grasp and pull the recoil handle slowly until you feel increased resistance. At this point, apply a rapid pull while pulling out from the inverter.

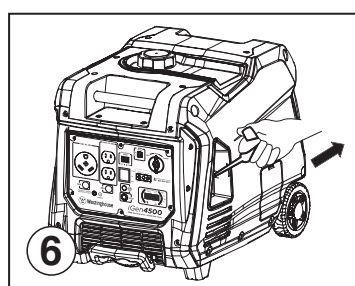

7. Plug in electronic devices.

ELECTRIC STARTING

1. Make sure nothing is plugged into power outlets.

2. Remove battery access cover and connect battery leads.

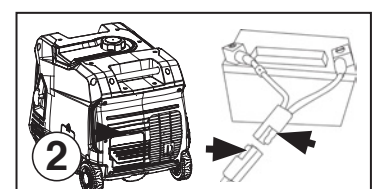

3. Make sure the circuit breakers are properly set to operating.

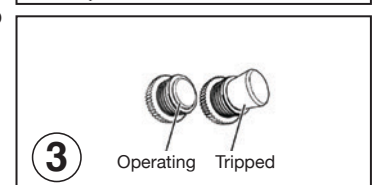

4. Turn the Fuel Control Switch to the ON position.

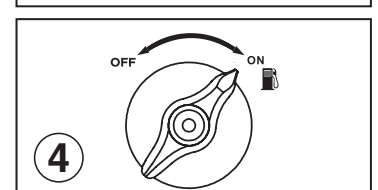

5. Switch Engine Control Switch to RUN.

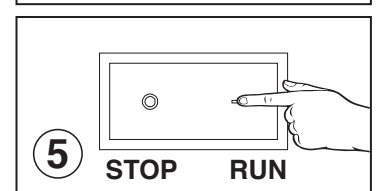

6. Push and hold the engine start button for 1 second and release.

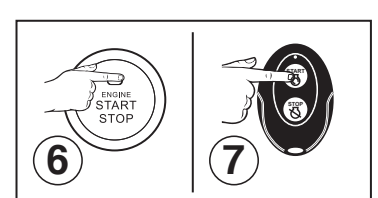

7. For remote start hold the START button on the wireless remote for 1 second and release.



Maintenance Guide P4500i

INVERTER MECHANICAL SPECIFICATIONS

Model Number	Running Watts	Peak Watts	Fuel Tank Size (L/G)	Rated Speed (RPM)	Ignition Type	Spark plug	Engine Disp (cc)	Stroke X Bore	Oil Capacity (L)	Oil Type	THD
OnanP4500i	3700	4500	13L/3.4G	3600	TCI	F7RTC	224	70X58	0.60	10W30	<3%

MAINTENANCE SCHEDULE

Following the maintenance schedule is important to keep the inverter in good operating condition. The following is a summary of maintenance items by periodic maintenance intervals. Refer to the *Maintenance* section in the *Owners Manual* to find out how to properly perform maintenance.

TABLE 1: MAINTENANCE SCHEDULE - OWNER PERFORMED

Maintenance Item	Before Every Use	After First 20 Hours or First Month of Use	After 50 Hours of Use or Every 6 Months	After 100 Hour of Use or Every 6 Months	After 300 Hours of Use or Every Year
Engine Oil	Check Level	Change	Change	-	-
Cooling Features	Check/Clean	-	-	-	-
Air Filter	Check	-	Clean*	-	Replace
Spark Plug	-	-	-	Check/Clean	Replace
Spark Arrestor	-	-	-	Check/Clean	-

*Service more frequently if operating in dry and dusty conditions

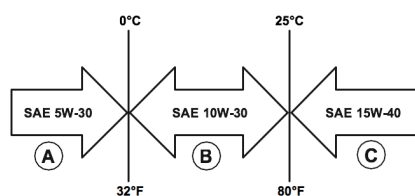

ENGINE OIL | ACEITE DEL MOTOR

Only use 4-stroke/cycle engine oil. **NEVER USE 2-STROKE/CYCLE OIL.** Synthetic oil is an acceptable substitute for conventional oil.

SPARK PLUG REPLACEMENT

Cummins	Torch Spark plug	Champion	Bosch	Autolite
A058V025	F7RTC	N9YC	W7DC	52

BATTERY REPLACEMENT

Cummins Part Number	A058U961
After Market Battery Model	YT5AL
Volts	12
Amp Hr	5
Dimensions	4.63 in by 2.38 in by 5 in

⚠ DANGER
Using a generator indoors **CAN KILL YOU IN MINUTES.** Generator exhaust contains carbon monoxide. This is a poison you cannot see or smell.

NEVER use inside a home or garage, **EVEN IF** doors and windows are open.

Only use **OUTSIDE** and far away from windows, doors, and vents.

Avoid other generator hazards. **READ MANUAL BEFORE USE**



3-2019