

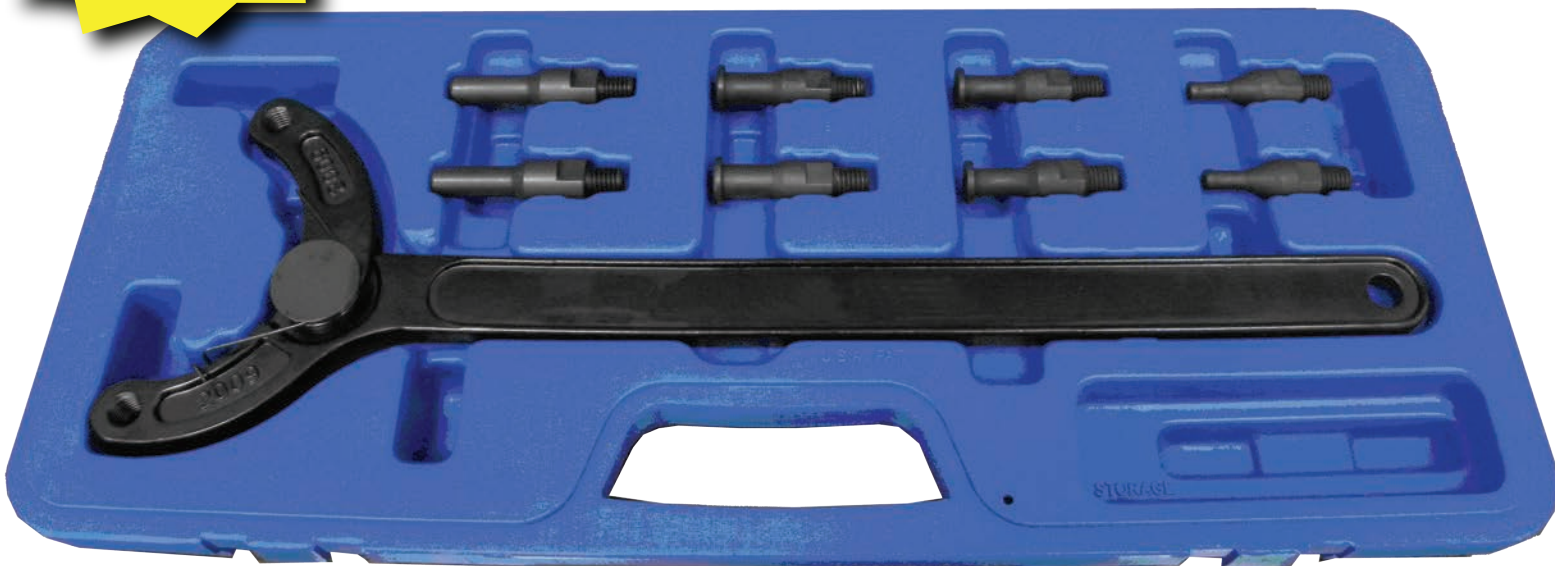

ADJUSTABLE CAMSHAFT PULLEY HOLDING TOOL

#4333

NEW!!



- Spring-loaded design for setting pins in variable positions
- Grooved pins hold the camshaft pulley stationary while loosening and tightening the center shaft bolt
- Applications include:
Mercedes, BMW, Ford, Honda, Audi, Volkswagen, Nissan, Volvo, Toyota Mitsubishi, Chrysler and more
- Especially useful for transverse mounted V6 engines, including: VG30 (Nissan Maxima) & the 3VZFE and 1MZFE (Toyota Camry)
- Adjusting range: 21mm-100mm

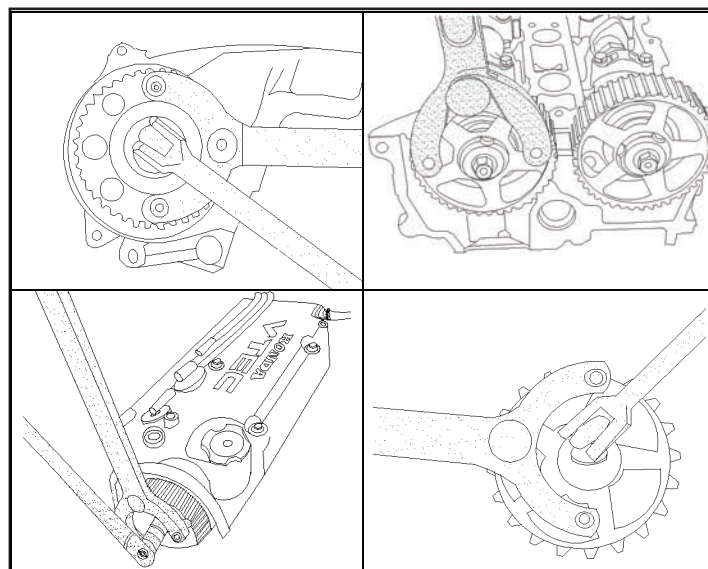

PART #	UPC	STD QTY
4333	053001043330	1

Form # 999433