



PRODUCT FEATURES:

- Retains factory features in select GM LAN 29 Bit vehicles while functioning with an aftermarket radio.
- Pre-programmed to retain factory Steering Wheel Controls.
- iPhone Voice Recognition (VR) feature from SWC on Kenwood, Pioneer, Alpine and JVC radios.
- Supports Pick Up/End Call, Pick Up and Toggle between 1st and 2nd Incoming call, AVRCP Track, Seek.
- Supports Bose, non-Bose and Y-91 audio systems.
- Provides Factory Rear Seat Entertainment Activation. Requires Cable #CRUX2333A (sold separately).
- Retains backup sensors / park assist system.
- Retains chime functions.
- EIA color coded wiring for easy installation.

NOTES:

1. ***NOT** compatible with 2012-Up SUVs/Trucks that are equipped with factory-installed Navigation radios.
2. ****NOT** compatible with Express and Savana vans that are powered by a diesel engine.
3. Supports Rear Entertainment System with special order harness #CJA2333A (sold separately).
4. **DOES NOT** support ONSTAR.

PARTS INCLUDED:

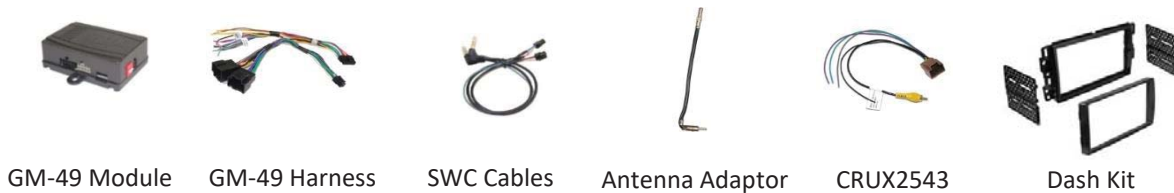

INSTALLATION DIAGRAM:

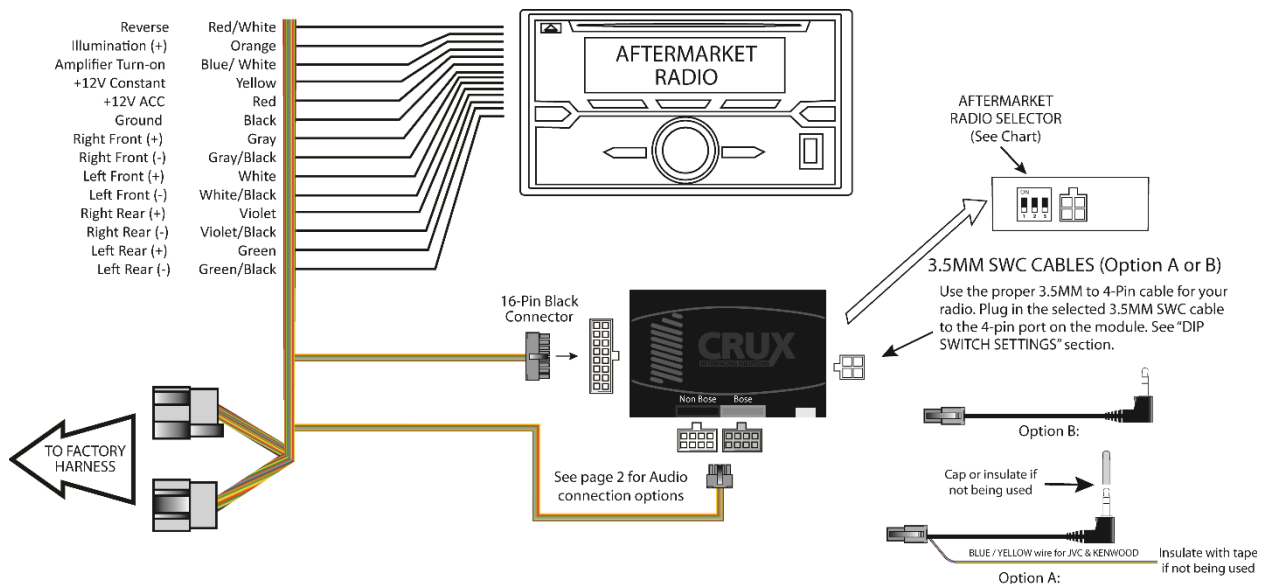



DIP SWITCH SETTINGS:

SETTING THE AFTERMARKET RADIO BRAND

With the key in the off position, set the DIP switches to the corresponding radio listed below.

RADIO BRAND:	DIP#:	1	2	3
Atoto, Dual, Fahrenheit, Jensen		OFF	ON	ON
Pioneer, Power Acoustik, Soundstream		OFF	ON	ON
Blaupunkt, Most off-brand Radio		OFF	ON	ON
Alpine		OFF	OFF	OFF
Clarion		ON	ON	OFF
Kenwood		ON	ON	ON
JVC		ON	OFF	ON
Boss, Old Sony		ON	OFF	OFF
New Sony		OFF	ON	OFF

SWC MODULE
DIP SWITCH



NOTE: For Atoto, Blaupunkt, Dual, Fahrenheit, Power Acoustik, Soundstream, and most off-brand radios, check the aftermarket radio's manual to see if the SWC buttons need to be programmed.

3.5MM SWC CABLE

Use the proper 3.5 to 4 pin SWC cable for the aftermarket radio being used:

OPTION A is used for ALPINE, CLARION, (JVC and KENWOOD units will use the Blue/Yellow wire).

OPTION B is used for ATOTO, BOSS, DUAL, FAHRENHEIT, JENSEN, POWER ACOUSTIK, PIONEER, SONY, SOUND STREAM and most OFF-BRAND headunits.

NOTE: Cap or insulate the 3.5mm plug or Blue/Yellow wire if not being used.

SELECTING THE AUDIO SYSTEM:

If the vehicle is equipped with a Bose system, the DKGM-49 module has a built-in Bose adaptor that allows the proper audio input gain from the aftermarket radio to the Bose amplifier. To use this feature, plug in the male 8-pin connector on the harness to the GRAY female 8-pin connector on the DKGM-49 module. The module is also labeled "Bose" and "Non Bose" to avoid confusion. (see picture below)

If the vehicle is NOT equipped with a Bose system, plug in the male 8-pin connector to the BLACK female 8-pin on the GM-49 module.





CHIME VOLUME ADJUSTMENT:

The DKGM-49 module has a potentiometer to adjust the chime volume. It is set at halfway by default. To adjust the volume, simply use a suitable screwdriver and turn the potentiometer clockwise to increase the volume and counter-clockwise to decrease the volume.

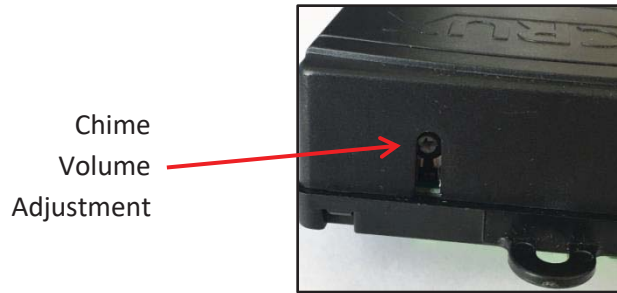

BACK UP CAMERA CONNECTION:

You can retain use of the factory backup camera by using the CRUX2543 harness provided in the kit. See below for connection instructions. (Note: Loose wires may not be needed in the installation.)

BACK-UP CAMERA CONNECTION

1. Connect the back-up camera 16-Pin connector to the vehicles 16-Pin factory connector.
2. Connect the yellow video RCA to the new aftermarket radio reverse camera input.
3. Test the video feed before installing the radio back into the dashboard. (Radio may need to be set prior to testing)



DASH KIT INSTALLATION:

A double DIN radio replacement dash kit is included in the kit to make the installation quick and easy. You have the option of installing a Double DIN or two Single DIN radios. The DKGM-49 kit includes:





INSTALLATION:

NOTE: Suzuki XL7 trim top corners of radio housing. See diagram A.

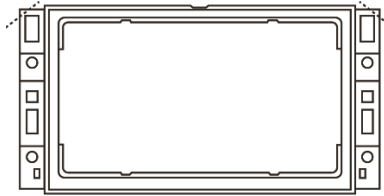

Diagram A

Before installation:

1. Locate the main trim.
2. Locate the left and right mounting brackets.
3. Slide the appropriate mounting bracket into the trim ring, aligning the holes in the trim ring to the clips on the bracket. (See Diagram B)
4. For two Single DIN radio installation, slide the stacked ISO DIN unit into the trim ring bracket assembly and secure the unit to the kit using the screws supplied with the radio. (See Diagram C)

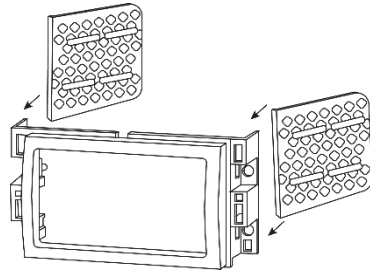

Diagram B

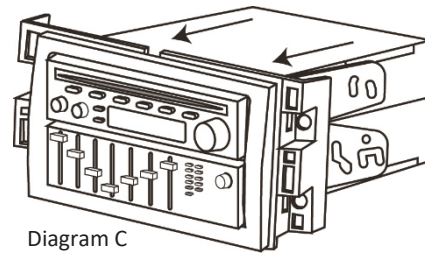

Diagram C

VEHICLE APPLICATIONS:

BUICK

2008-2017 Enclave
2006-2011 Lucerne

CADILLAC

2006-2011 DTS
2007-2014 Escalade
2007-2009 SRX

CHEVROLET

2007-2013 Avalanche*
2007-2008 Equinox
2008-2016 Express Van**
2006-2013 Impala / Impala SS
2014-2016 Impala Classic
2006-2007 Monte Carlo
2007-2013 Silverado 1500-3500 Pickup*
2007-2014 Suburban*
2007-2014 Tahoe*
2009-2017 Traverse

GMC

2007-2016 Acadia
2017 Acadia Classic
2008-2017 Savana**
2007-2013 Sierra 1500-3500 Pickup*
2007-2014 Yukon*

HUMMER

2008-2009 H2

PONTIAC

2007-2009 Torrent

SATURN

2007-2010 Outlook
2008-2009 Vue

SUZUKI

2007-2008 XL7

PRODUCT FEATURES:

- Retains factory features in select GM LAN 29 Bit vehicles while functioning with an aftermarket radio.
- Pre-programmed to retain factory Steering Wheel Controls.
- iPhone Voice Recognition (VR) feature from SWC on select radios.
- Supports Pick Up/End Call, Pick up and Toggle between 1st and 2nd incoming call, AVRCP Track, Seek.
- Supports Bose, non-Bose and Y-91 audio systems.
- Retains chime functions.
- Provides Factory Rear Seat Entertainment Activation. Requires Cable #CRUX2333A (sold separately).
- Retains factory back-up camera.
- Retains factory backup sensors / park assist system.
- EIA color coded wiring for easy installation.

PARTS INCLUDED:



SWRGM-49 MODULE



SWRGM-49 HARNESS



SWC CABLES



ANTENNA ADAPTER



Backup Camera Harness

INSTALLATION DIAGRAM:

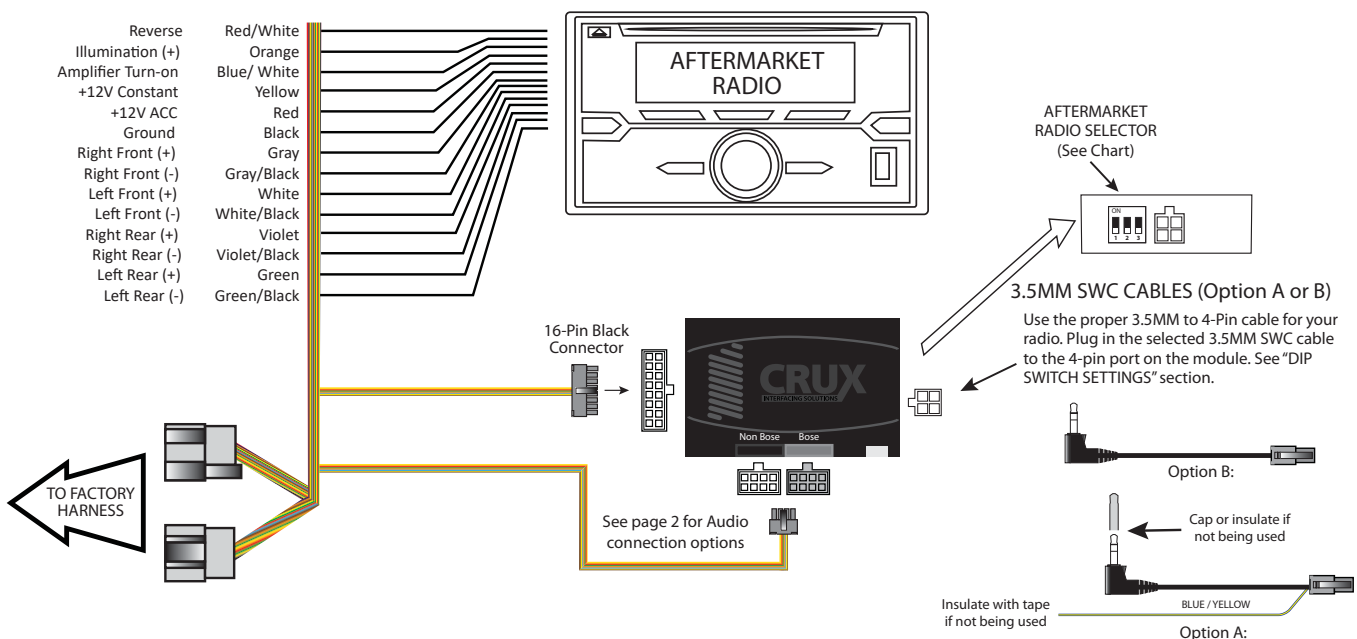

DI S I T S TTINGS:

AFTERMARKET RADIO DIP SWITCH SETTINGS:

RADIO BRAND:	DIP#:	1	2	3
Atoto, Dual, Fahrenheit, Jensen		OFF	ON	ON
Pioneer, Power Acoustik, Soundstream		OFF	ON	ON
Blaupunkt, Most off-brand Radio		OFF	ON	ON
Alpine		OFF	OFF	OFF
Clarion		ON	ON	OFF
Kenwood		ON	ON	ON
JVC		ON	OFF	ON
Boss, Old Sony		ON	OFF	OFF
New Sony		OFF	ON	OFF

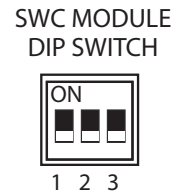

NOTE: For Atoto, Blaupunkt, Dual, Farenheit, Power Acoustik, Soundstream, and most off-brand radios, check the aftermarket radio's manual to see if the SWC buttons need to be programmed.

4-PIN SWC CABLE

Use the proper 3.5MM to 4-Pin SWC cable for the aftermarket radio you are using.

OPTION A is used for ALPINE, CLARION, JVC, and KENWOOD units (Blue/Yellow wire is attached)
OPTION B is used for ATOTO, BLAUPUNKT, BOSS, DUAL, FARENHEIT, JENSEN, POWER ACOUSTIK, PIONEER, SONY, SOUNDSTREAM and Most Off-Brand Radios.

NOTE: Cap or insulate the 3.5mm plug or Blue/Yellow wire if not being used.

For aftermarket radios that have wires for SWC connections, cut off the 3.5mm plug on the Crux SWC Cable (option B) and connect the SWC wires as follows:

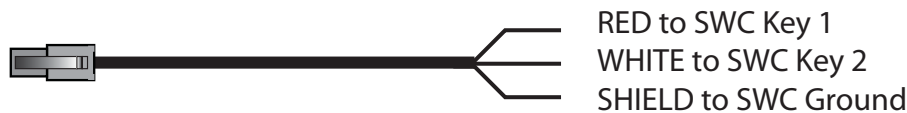

Note that there are some radios that only have SWC1 and SWC2, in this case "shield" does not need to be connected.

S L TING T A DIO S ST M:

If the vehicle is equipped with an amplified audio system, the SWRGM-49 has a built-in audio level adaptor that outputs the proper audio level from the aftermarket radio to the factory amplifier. To use this feature, plug in the male 8-pin connector on the SWRGM-49 harness to the GRAY female 8-pin connector on the SWRGM-49 module. The module is also labeled "Bose" and "Non Bose" to avoid confusion. (see picture below)

If the vehicle is NOT equipped with a factory amplified system, plug in the male 8-pin connector to the BLACK female 8-pin on the SWRGM-49 module.

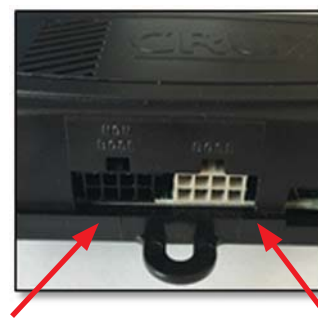

NON BOSE
(Non-Amplified)
Connection

BOSE
(Amplified)
Connection

INSTALLATION:

The SWRGM-49 has a potentiometer to adjust the chime volume. It is set at half way by default. To adjust the volume, simply use a suitable screw driver and turn the potentiometer clockwise to increase the volume and counter-clockwise to decrease the volume.

Chime
Volume
Adjustment



ADDITIONAL INFORMATION:

You can retain the factory back-up camera by using the CRUX 2543 harness included in the kit.

1. Connect the 16-pin back-up camera harness to the vehicle's 16-pin factory backup camera connector.
2. Connect the Yellow video RCA to the new aftermarket radio camera input.
3. Test the video feed before installing the radio back into the dashboard.



INSTALLATIONS:

BUICK		GMC	
2008-2017	Enclave	2007-2016	Acadia
2006-2011	Lucerne	2017	Acadia Classic
CADILLAC		2008-2017	Savana**
2007-2014	Escalade	2007-2013	Sierra 1500-3500 Pickup*
2007-2009	SRX	2007-2014	Yukon*
CHEVROLET		HUMMER	
2007-2013	Avalanche*	2008-2009	H2
2007-2008	Equinox	PONTIAC	
2008-2016	Express Van**	2007-2009	Torrent
2006-2013	Impala / Impala SS	SATURN	
2014-2016	Impala Classic	2007-2009	Outlook
2006-2007	Monte Carlo	2008-2009	Vue
2007-2013	Silverado 1500-3500 Pickup*	SUZUKI	
2007-2014	Suburban*	2007-2008	XL7
2007-2014	Tahoe*		
2009-2017	Traverse		

1. *NOT compatible with 2012-Up SUVs/Trucks that are equipped with factory-installed Navigation radios.
2. **NOT compatible with Express and Savana vans that are powered by a diesel engine.