

CROW 
ENTERPRIZES®

**UTV - SAND CAR
RESTRAINTS**

Issue #2



The
NEXT GENERATION
UTV Restraint System

Features a
Quick Adjust latch.
Available in 2x3,
2x2 or 3x3 models.

Colors Available:

Red • Blue • Black • Gray • Purple

PART 32032

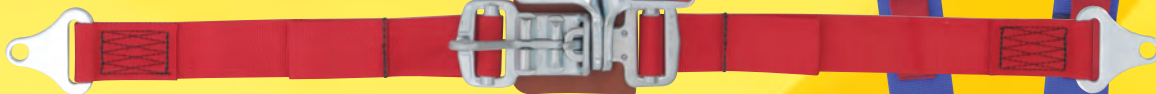

Proven Fact:

A narrower lap belt works better than the traditional 3" lap belt. The new narrower 2" lap belt rides within the crest of the pelvis vs the 3" that rides on the crest of the pelvis. A tighter belt will respond quicker in a sudden stop and is more comfortable.

PART 32053



Available in QA and Standard Latch & Link

Trouble tightening your restraints with the standard style 14" latch & link system?

The **NEXT GENERATION** Restraint System with the 6" latch & link solves that problem. The adjuster is built into the latch.

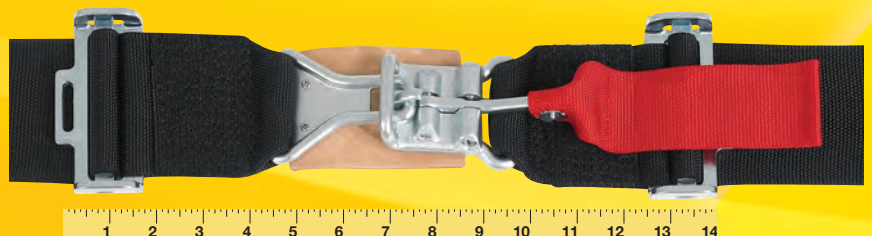

2X2, 2X3 & 3X3 UTV-TYPE & SAND CAR RESTRAINTS

Not For Competition Use

PART #32034

- 2" seat belts with Quick Adjust Latch & Link bolt in.
- 3" harness with sewn in pads, bolt in.
 - 32032 (Red)
 - 32033 (Blue)
 - 32034 (Black)
 - 32035 (Purple)
 - 32036 (Gray)

PART #32024

- 2" seat belts with Quick Adjust Latch & Link bolt in.
- 3" harness without pads, bolt in.
 - 32022 (Red)
 - 32023 (Blue)
 - 32024 (Black)
 - 32025 (Purple)
 - 32026 (Gray)



PART #32053

- 2" seat belts with Quick Adjust Latch & Link bolt in.
- 2" harness with sewn in pads, bolt in.
 - 32052 (Red)
 - 32053 (Blue)
 - 32054 (Black)
 - 32055 (Purple)
 - 32056 (Gray)

PART #32043

- 2" seat belts with Quick Adjust Latch & Link bolt in.
- 2" harness without pads, bolt in.
 - 32042 (Red)
 - 32043 (Blue)
 - 32044 (Black)
 - 32045 (Purple)
 - 32046 (Gray)



PART #32072

- 3" seat belts with Quick Adjust Latch & Link bolt in.
- 3" harness with sewn in pads, wrap around.
 - 32052 (Red)
 - 32053 (Blue)
 - 32054 (Black)
 - 32055 (Purple)
 - 32056 (Gray)

PART #32062

- 3" seat belts with Quick Adjust Latch & Link bolt in.
- 3" harness without pads, wrap around.
 - 32062 (Red)
 - 32063 (Blue)
 - 32064 (Black)
 - 32065 (Purple)
 - 32066 (Gray)



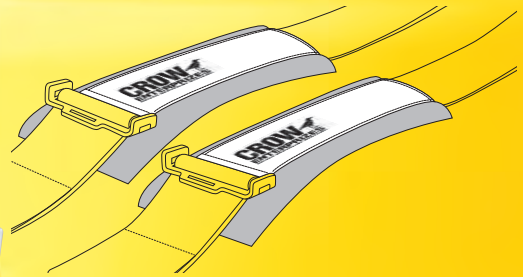

Sewn on harness pads available for all models.

2X3 & 3X3 UTV-TYPE & SAND CAR RESTRAINTS

Not For Competition Use

PART #32012

- 3" seat belts with Quick Adjust Latch & Link bolt in.
- 3" harness with sewn in pads, bolt in.
 - 32012 (Red)
 - 32013 (Blue)
 - 32014 (Black)
 - 32015 (Purple)
 - 32016 (Gray)

PART #32002

- 3" seat belts with Quick Adjust Latch & Link bolt in.
- 3" harness without pads, bolt in.
 - 32002 (Red)
 - 32003 (Blue)
 - 32004 (Black)
 - 32005 (Purple)
 - 32006 (Gray)



PART #20134P

- 3" seat belts bolt in.
- 3" individual harness with sewn in pads, wrap around.
 - 20132P (Red)
 - 20133P (Blue)
 - 20134P (Black)
 - 20135P (Purple)
 - 20136P (Gray)

PART #20134

- 3" seat belts bolt in.
- 3" individual harness without pads, wrap around.
 - 20132 (Red)
 - 20133 (Blue)
 - 20134 (Black)
 - 20135 (Purple)
 - 20136 (Gray)



PART #20143

- 3" seat belts bolt in.
- 3" Y-type harness without pads, bolt in.
 - 20142 (Red)
 - 20143 (Blue)
 - 20144 (Black)
 - 20145 (Purple)
 - 20146 (Gray)

PART #20143P

- 3" seat belts bolt in.
- 3" Y-type harness with sewn in pads, bolt in.
 - 20142P (Red)
 - 20143P (Blue)
 - 20144P (Black)
 - 20145P (Purple)
 - 20146P (Gray)



Anti-submarine belts are highly recommended with all 4-way restraints.

Anti-submarine belts available.

3X2 UTV-TYPE & SAND CAR RESTRAINTS



Not For Competition Use

Anti-submarine belts are highly recommended with all 4-way restraints.

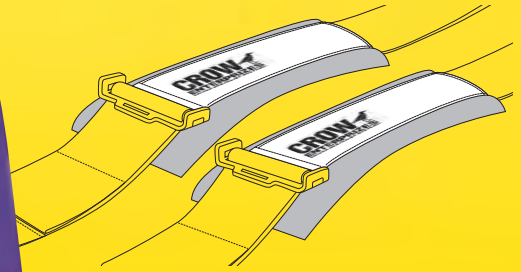

Sewn on harness pads available for all models.

Anti-submarine belts available.

PART #11195

- 3" seat belts bolt in.
- 2" V-type harness without pads, bolt in.
 - 11192 (Red)
 - 11193 (Blue)
 - 11194 (Black)
 - 11195 (Purple)
 - 11196 (Gray)

PART #11195P

- 3" seat belts bolt in.
- 2" V-type harness with sewn in pads, bolt in.
 - 11192P (Red)
 - 11193P (Blue)
 - 11194P (Black)
 - 11195P (Purple)
 - 11196P (Gray)



PART #11204

- 3" seat belts bolt in.
- 2" Y-type harness without pads, bolt in.
 - 11202 (Red)
 - 11203 (Blue)
 - 11204 (Black)
 - 11205 (Purple)
 - 11206 (Gray)

PART #11204P

- 3" seat belts bolt in.
- 2" Y-type harness with sewn in pads, bolt in.
 - 11202P (Red)
 - 11203P (Blue)
 - 11204P (Black)
 - 11205P (Purple)
 - 11206P (Gray)



PART #11212

- 3" seat belts bolt in.
- 2" individual harness without pads, wrap around.
 - 11212 (Red)
 - 11213 (Blue)
 - 11214 (Black)
 - 11215 (Purple)
 - 11216 (Gray)

PART #11212P

- 3" seat belts bolt in.
- 2" individual harness with sewn in pads, wrap around.
 - 11212P (Red)
 - 11213P (Blue)
 - 11214P (Black)
 - 11215P (Purple)
 - 11216P (Gray)



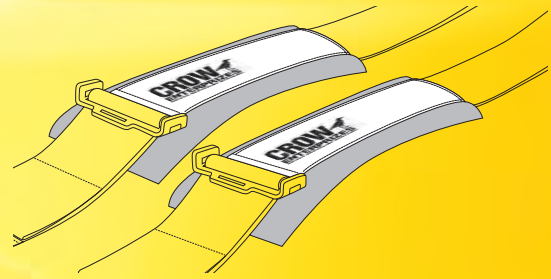

Sewn on harness pads available for all models.

2X2 UTV-TYPE & SAND CAR RESTRAINTS

Not For Competition Use

PART #20094

- 2" seat belts bolt in.
- 2" V-type harness without pads, bolt in.
 - 20092 (Red)
 - 20093 (Blue)
 - 20094 (Black)
 - 20095 (Purple)
 - 20096 (Gray)

PART #20094P

- 2" seat belts bolt in.
- 2" V-type harness with sewn in pads, bolt in.
 - 20092P (Red)
 - 20093P (Blue)
 - 20094P (Black)
 - 20095P (Purple)
 - 20096P (Gray)



PART #20104P

- 2" seat belts bolt in.
- 2" individual harness with sewn in pads, wrap around.
 - 20102P (Red)
 - 20103P (Blue)
 - 20104P (Black)
 - 20105P (Purple)
 - 20106P (Gray)

PART #20104

- 2" seat belts bolt in.
- 2" individual harness without pads, wrap around.
 - 20102 (Red)
 - 20103 (Blue)
 - 20104 (Black)
 - 20105 (Purple)
 - 20106 (Gray)



PART #20113

- 2" seat belts bolt in.
- 2" Y-type harness without pads, bolt in.
 - 20112 (Red)
 - 20113 (Blue)
 - 20114 (Black)
 - 20115 (Purple)
 - 20116 (Gray)

PART #20113P

- 2" seat belts bolt in.
- 2" Y-type harness with sewn in pads, bolt in.
 - 20112P (Red)
 - 20113P (Blue)
 - 20114P (Black)
 - 20115P (Purple)
 - 20116P (Gray)



Anti-submarine belts are highly recommended with all 4-way restraints.

Anti-submarine belts available.

UTV-TYPE RECREATIONAL RESTRAINTS

PART #30104

2X2 UTV Restraint with Standard Latch & Link

- 2" 52" Lap Belt Bolt In.
- 2" Individual H-Type Harness, Sewn in Lap Belt with Harness Pads & Plastic Sternum Buckle, Harness Wrap Around.
- 30102 (Red)
- 30103 (Blue)
- 30104 (Black)
- 30105 (Purple)
- 30106 (Gray)



PART #30134

3X3 UTV Restraint with Standard Latch & Link

- 3" 52" Lap Belt Bolt In.
- 3" Individual H-Type Harness, Sewn in Lap Belt with Harness Pads & Plastic Sternum Buckle, Harness Wrap Around.
- 30132 (Red)
- 30133 (Blue)
- 30134 (Black)
- 30135 (Purple)
- 30136 (Gray)



PART #30154

2X2 UTV Restraint with Automotive Buckle

- 2" Automotive 52" Lap Belt Bolt In.
- 2" Individual H-Type Harness, Sewn in Lap Belt, Harness Pads & Plastic Sternum Buckle, Harness Wrap Around.
- 30152 (Red)
- 30153 (Blue)
- 30154 (Black)
- 30155 (Purple)
- 30156 (Gray)



PART #32094

2X2 UTV Restraint with Push-Button Side Release

- 2" 52" Lap Belt Bolt In.
- 2" Individual H-Type Harness, Sewn in Lap Belt with Harness Pads & Plastic Sternum Buckle, Harness Wrap Around.
- 32092 (Red)
- 32093 (Blue)
- 32094 (Black)
- 32095 (Purple)
- 32096 (Gray)



PART #30144

2X2 UTV Restraint with Automotive Buckle

*No Photo, Same as part no. 30154 Less Pads & Sternum Buckle

- 2" Automotive 52" Lap Belt Bolt In.
- 2" Individual H-Type Harness, Sewn in Lap Belt, Harness Wrap Around.
- 30142 (Red)
- 30143 (Blue)
- 30144 (Black)
- 30145 (Purple)
- 30146 (Gray)

PART #32084

2X2 UTV Restraint with Push-Button Side Release

*No Photo, Same as part no. 32096 Less Pads & Sternum Buckle

- 2" 52" Lap Belt Bolt In.
- 2" Individual H-Type Harness, Sewn in Lap Belt, Harness Wrap Around.
- 32082 (Red)
- 32083 (Blue)
- 32084 (Black)
- 32085 (Purple)
- 32086 (Gray)

Sewn in Harness

PART #30184

3X3 UTV Restraint with Standard Latch & Link

- 3" 52" Lap Belt Bolt In.
- 3" Individual H-Type Harness, Sewn in Lap Belt with Harness Pads & Plastic Sternum Buckle, Harness Wrap Around.
- Black Hardware.
 - 30182 (Red)
 - 30183 (Blue)
 - 30184 (Black)
 - 30185 (Purple)
 - 30136 (Gray)



PART #30163

2X2 UTV Restraint with Standard Latch & Link

- 2" 52" Lap Belt Bolt In.
- 2" Individual H-Type Harness, Sewn in Lap Belt with Harness Pads & Plastic Sternum Buckle, Harness Wrap Around.
- Black Hardware.
 - 30162 (Red)
 - 30163 (Blue)
 - 30164 (Black)
 - 30165 (Purple)
 - 30166 (Gray)



BLACKBIRD

By CROW

PART #20132B

3X3 UTV Restraint with Standard Latch & Link

- 3" 52" Lap Belt Bolt In.
- 3" Individual H-Type Harness, Harness Wrap Around.
- Black Hardware.
 - 20132B (Red)
 - 20133B (Blue)
 - 20134B (Black)
 - 20135B (Purple)
 - 20136B (Gray)

PART #20132BP

3X3 UTV Restraint with Standard Latch & Link

- 3" 52" Lap Belt Bolt In.
- 3" Individual H-Type Harness, Harness Wrap Around with sewn-in Harness Pads.
- Black Hardware.
 - 20132BP (Red)
 - 20133BP (Blue)
 - 20134BP (Black)
 - 20135BP (Purple)
 - 20136BP (Gray)



PART #20106B

2X2 UTV Restraint with Standard Latch & Link Racer Net

- 2" 52" Lap Belt Bolt In.
- 2" Individual H-Type Harness, Harness Wrap Around.
- Black Hardware.
 - 20102B (Red)
 - 20103B (Blue)
 - 20104B (Black)
 - 20105B (Purple)
 - 20106B (Gray)

PART #20106BP

2X2 UTV Restraint with Standard Latch & Link Racer Net

- 2" 52" Lap Belt Bolt In.
- 2" Individual H-Type Harness, Harness Wrap Around with sewn-in Harness Pads.
- Black Hardware.
 - 20102BP (Red)
 - 20103BP (Blue)
 - 20104BP (Black)
 - 20105BP (Purple)
 - 20106BP (Gray)





**UTV-TYPE
RECREATIONAL
RESTRAINTS**

2" 5-Way Restraints

PART #11172R

- 2" seat belt, bolt in.
- 2" Y-type harness bolt in.
- Anti-submarine belt bolt in.
 - 11172R (Red)
 - 11173R (Blue)
 - 11174R (Black)
 - 11175R (Purple)
 - 11176R (Gray)



PART #11183R

- 2" seat belt, bolt in.
- 2" individual harness wrap around.
- Anti-submarine belt bolt in.
 - 11182R (Red)
 - 11183R (Blue)
 - 11184R (Black)
 - 11185R (Purple)
 - 11186R (Gray)



**UTV-TYPE
RECREATIONAL
RESTRAINTS
WITH PADS**

PART #11174RP

- 2" seat belt, bolt in.
- 2" Y-type harness bolt in.
- Anti-submarine belt bolt in.
 - 11172RP (Red)
 - 11173RP (Blue)
 - 11174RP (Black)
 - 11175RP (Purple)
 - 11176RP (Gray)



PART #11186RP

- 2" seat belt, bolt in.
- 2" individual harness wrap around or bolt in.
- Anti-submarine belt bolt in.
 - 11182RP (Red)
 - 11183RP (Blue)
 - 11184RP (Black)
 - 11185RP (Purple)
 - 11186RP (Gray)

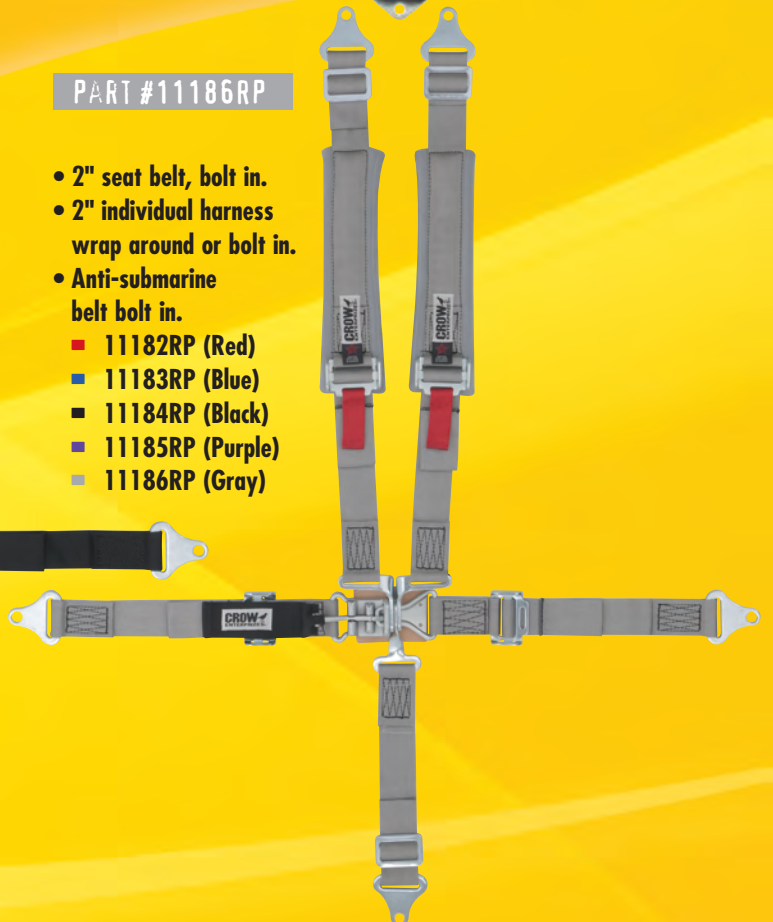

SAND CAR WRIST RESTRAINTS

Not For Competition Use

PART #11662

- 11662 (Red)
- 11663 (Blue)
- 11664 (Black)
- 11665 (Purple)
- 11666 (Gray)

- Attach around wrist with hook and loop fastener closures.



2" ANTI-SUBMARINE BELTS

PART #11384

- 11382 (Red)
- 11383 (Blue)
- 11384 (Black)
- 11385 (Purple)
- 11386 (Gray)

- Standard anti-submarine belt.



PART #11392

- 11392 (Red)
- 11393 (Blue)
- 11394 (Black)
- 11395 (Purple)
- 11396 (Gray)

- Adjustable anti-submarine belt.



TENSION SPRINGS

PART #11550

- Tension springs for 3" seat belts & harnesses.
- Sold in sets of Four.

PART #11550A

- Tension springs for 2" seat belts & harnesses.
- Sold in sets of four.



MOUNTING HARDWARE

PART #11546

- Floor mount snap, eye bolt, nut & washer.
- 1 each per set.



PART #11547

- 3" 3-bar slide.
- 2 each per set.



PART #11549

- Bolt in bracket.
- 2 each per set.



PART #11548

- Eye bolt nut & washer.
- 2 each per set.
- Thread size 7/16 x 20.



PART #11551

- 2" 3-bar slide.
- 2 each per set.



LATCH GUARDS

PART #LG2

- Latch guard
 - LG2 (Red)
 - LG4 (Black)



STERNUM LATCHES

It is highly recommended, when using a sternum latch or hook and loop fastener sternum, to use an anti-sub belt with these applications.

PART #11326

- Hook and loop fastener sternum assembly.



PART #11328

- 1" Plastic sternum buckle.

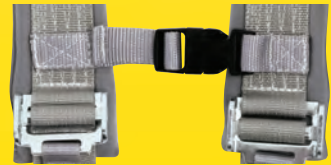

INSTALLATION TIPS

- Driver Restraint Systems: Sub Belt

1. Lap belt must be anchored to the frame rail or roll cage as close to the hip as possible at an angle of 45 degrees, but no greater than 60 degrees to the ground.

2. 5-Point Anti-Submarine Belt should be anchored on or slightly behind the Chest Line.

MOUNTING BRACKETS

Mounting brackets should be installed at an angle that is compatible with the direction of pull on the webbing under full load. Preferred mount is in a double shear with allowance for the bolt-in bracket to pivot and align toward the direction of the load as shown in Figure 1.

FIGURE 1

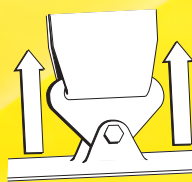

CORRECT

FIGURE 2

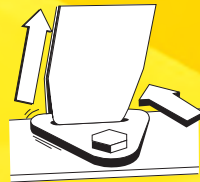

INCORRECT

FIGURE 1 AND FIGURE 2

All mounting brackets should be attached directly to the frame or chassis of the car and installed to limit the driver's body travel both upward and forward. Do not weld around or near belts or belt hardware.

Minimum specification for bolts and washers to attach the seat belts, harnesses and anti-submarine belt hardware are Grade 8.

"LOCKING" the 3-bar Slide Adjuster shown in Steps 1 through 4 is **VERY IMPORTANT**. The 3-Bar Slide Adjuster must be located as close as possible to the Bolt-in bracket or Roll Bar (In Wrap Around design).

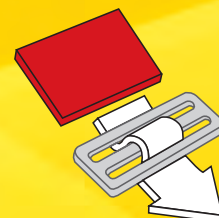
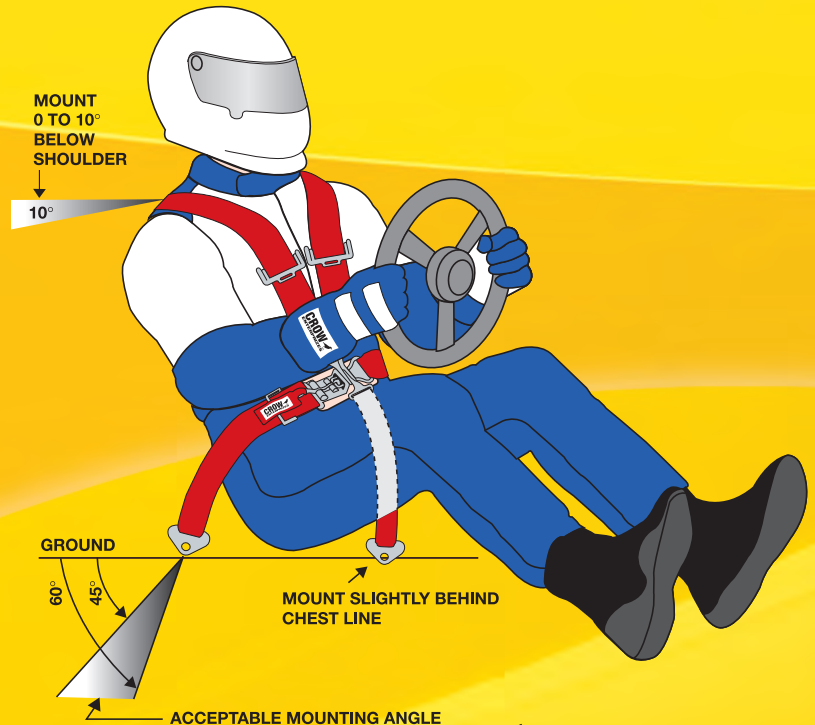

STEP 1: Insert strap through tightening buckle.



STEP 2: Pull strap to 8"-10" beyond buckle, fold edges and insert into mounting bracket.



STEP 3: Fold back strap and reinsert through buckle as shown.



STEP 4: Fold back strap again and insert through bottom portion of buckle.