

18-19 JEEP WRANGLER JL

CORSA
PERFORMANCE



IMPORTANT! WARRANTY AND INSTALLATION INSTRUCTIONS

Please Forward All Information to Consumer



NEVER work on a hot engine bay.
Allow time for the vehicle to cool.

INSTALL DIFFICULTY



RECOMMENDED TOOLS & SUPPLIES

- Flathead Screwdriver
- Trim Removal Tools
- 10mm Socket
- Ratchet Extension
- Philips Screwdriver
- 8mm Socket
- Ratchet
-

Please take time to read and understand these installation instructions.

CORSA recommends that the installation of this system be performed by a qualified service center or professional installer who has the necessary equipment, tools, and experienced personnel. However, if you decide to perform this installation yourself, the use of an additional person may be required.

WARNING: Never work on a hot engine bay. Allow time for the vehicle to cool.

Check that this air intake complies with your Federal, State, and Local laws. We recommend saving your stock system.

This warranty does not extend to damaged or defect in the finish of a product or to any product, that in the opinion of CORSA Performance, has been misused, damaged by accident or negligence, altered or modified in any way, faulty installation or installed contrary to CORSA installation instructions, or repaired by an unauthorized service facility.

2018-2019 JEEP WRANGLER JL

Closed Box Air Intake

Part #: 47736, 47736D, 477366

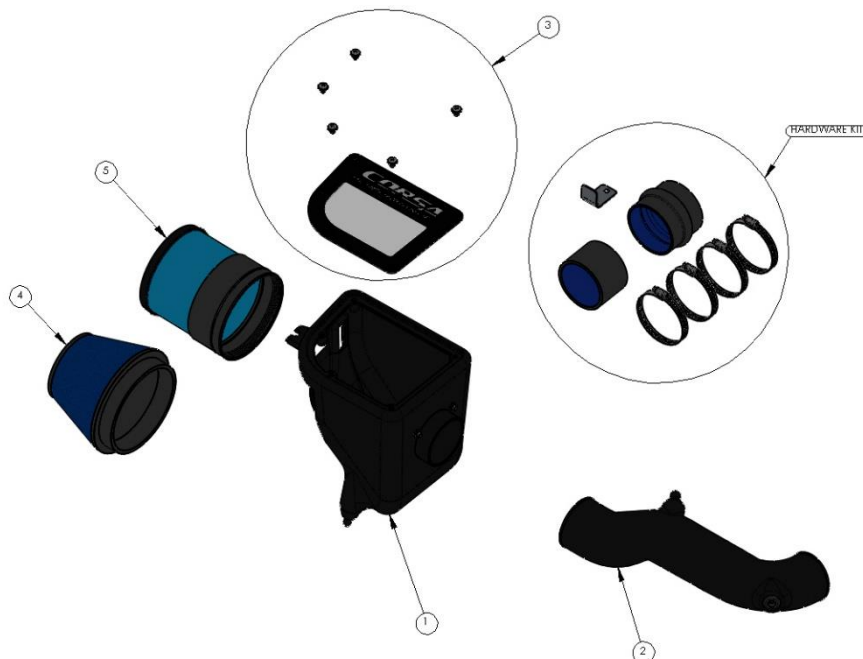

PREASSEMBLED MATERIALS

1. CORSA Air Box (412219)		2. CORSA Air Duct (441304)		3. CORSA Lid Assembly (652093)	
Filter Adapter (460635)	1	5/8" Quick Connect Fitting (59034138)	1	Lid Screw (5900)	5
Socket Head Screw (59051414)	3	1/2" Grommet (59045101)		Rubber Washer (59025122)	5
Flat Washer (59020109)	3				
Lock Washer (59020117)	3				

Filter Options

4. MaxFlow 5 Filter (5120)	5. DryTech 3D Filter (5120D)	6. PowerCore Filter (61513)
----------------------------	------------------------------	-----------------------------

HARDWARE KIT

#56 Clamp (52056)	4	Ø3.25" Straight Sleeve (53106)	2.5 in	Ø3.5" Hump Hose (53203)	1
Mounting Bracket (652061-240)	1				

*Locate the vehicle's battery and disconnect the negative battery cable.
This may reset the computer and clear old air flow data to help prevent CEL errors.*

REMOVAL INSTRUCTIONS

FACTORY INTAKE



- 1.** Unclip wiring harness for air temperature sensor.



- 2.** Using a trim removal tool, remove the two clips securing the ATS wiring harness to the factory air duct.

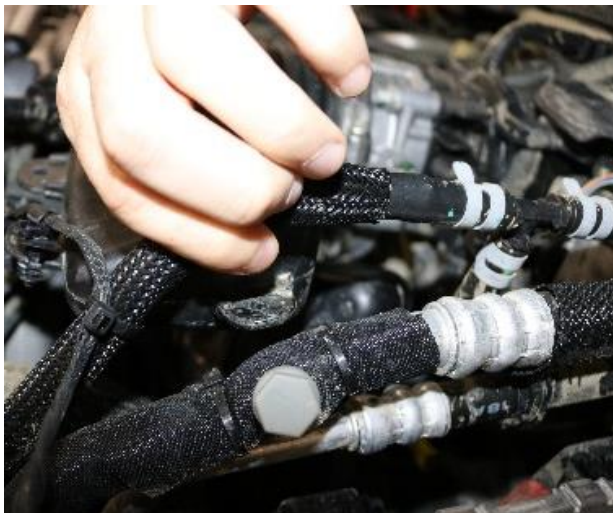

- 3.** Using a trim removal tool, remove the clip securing the coolant hose to the factory air duct.



- 4.** Remove the two bolts securing the factory air duct to the core support with a ratchet and 10mm socket.

Continued on Next Page . . .

REMOVAL INSTRUCTIONS

FACTORY INTAKE



- 5.** Remove the bolt securing the factory air box to the inner fender with a ratchet and 10mm socket.
NOTE: Save bolt for installation.



- 6.** Disconnect the breather hose from the factory air duct by squeezing gray tab and pulling straight off.
NOTE: Pushing the hose more onto the duct fitting may aid in releasing the quick connect while squeezing gray tab.



- 7.** Loosen clamp securing factory duct to throttle body using a flathead screwdriver or ratchet and 8mm socket.



- 8.** Lift complete factory air intake from vehicle as one assembly.

Continued on Next Page . . .

REMOVAL INSTRUCTIONS

FACTORY INTAKE



- 9.** Remove the two mounting grommets from the bottom of the factory air box.
NOTE: Save grommets for installation.



- 10.** Remove the air temperature sensor from the factory air duct. Pay attention to the orientation of the sensor prior to removal to aid in installation.
NOTE: Gently lift tab to clear locking feature and rotate sensor approximately one quarter turn counterclockwise until it stops. Pull sensor straight out.

This concludes the removal of the factory intake.

INSTALLATION INSTRUCTIONS

CORSA INTAKE



- 1.** Locate the two factory grommets from removal step 9 and install them back into the factory location beneath the air box.



- 2.** Locate the air temperature sensor from removal step 10 and CORSA air duct and install the sensor into the air duct



- 3.** Sensor orientation.



- 4.** Locate the CORSA air box and install into vehicle by fitting the posts on the bottom of air box into the factory grommets installed in step 1.

Continued on Next Page ...

INSTALLATION INSTRUCTIONS

CORSA INTAKE



- 5.** Locate the supplied mounting bracket and the factory bolt from removal step 5. Install the bracket from the inside of the air box under the tab. Install factory bolt through bracket with a ratchet and 10mm socket.



- 6.** Locate the Ø3.5" Hump Hose and two of the #56 clamps. Install the hump hose and one #56 clamp onto to filter adapter. Snug the clamp to hold the hump hose in place, but do not fully tighten. Place the other clamp onto hump hose.



- 7.** Locate the CORSA air duct, Ø3.25" straight sleeve, and two remaining #56 clamps. Install straight sleeve and one #56 clamp onto air duct and snug clamp to hold straight sleeve in place. Place the other clamp onto straight sleeve.



- 8.** Install the air duct into the hump hose.

Continued on Next Page . . .

INSTALLATION INSTRUCTIONS

CORSA INTAKE



9. Install the straight sleeve onto the throttle body.



10. Adjust air duct as necessary and tighten all four clamps using a flathead screwdriver or ratchet and 8mm socket.



11. Connect factory breather hose to quick connect fitting in CORSA air duct.



12. Connect ATS wiring harness onto sensor.



13. Locate either MaxFlow 5 Oiled Filter 5120 or PowerCore Filter 61513 and install into air box onto filter adapter.

15. Locate CORSA lid and lid screws with rubber washers and install lid onto air box using a Philips screwdriver.



14. Ensure filter is fully seated onto adapter and tighten clamp using a flathead screwdriver or a ratchet and 8mm socket.

16. Connect negative battery cable and check all connections.

This completes the installation of your CORSA air intake system

*Check that this air intake complies with your Federal, State and Local laws.
We recommend saving your stock system.*

BEFORE ROAD TESTING

- 1.** Start engine, leaving the transmission in park and securing the parking brake.
- 2.** Make sure to look and listen for any unusual noises or air leaks. Repair problems if needed.
- 3.** Once completed it will be necessary to check periodically, after a few heat cycles, for realignment and tightening of all connections.

MaxFlow 5 CARE AND CLEANING

Check the MaxFlow 5 cotton reusable filter periodically and remove any excessive dirt build-up by tapping the filter on the ground and brushing off the loosened dirt. Clean the filter by using a two stage cleaning kit to thoroughly clean and re-oil the filter. Re-oil every 10,000 miles without cleaning to improve filtering in sand and dirt. Clean only when dirt is very excessive or 50,000 miles.

Reference for Replacement Filters: MaxFlow 5 Filter Part # 5120, DryTech 3D Filter Part # 5120D or PowerCore[®] Filter Part # 61513