



Exhaust System Installation
 Cat-Back Exhaust System
2009+ Dodge Challenger 5.7L HEMI (MDS & Non-MDS)
 Dual Rear Exit with GTX Style Tips
SPORT PART NUMBER 14428 (MDS) & 14429 (Non-MDS)
XTREME PART NUMBER 14436 (MDS) & 14437 (Non-MDS)

Please take time to read and understand these installation instructions.

CORSA recommends that installation of this system be performed by an authorized CORSA service center or professional muffler installer who has the necessary equipment, tools and experienced personnel. However, if you decide to perform this install, the use of a hoist and an additional person will be required.

CAUTION: Never work on a hot exhaust system. Allow time for the vehicle to cool. Always wear eye protection when working under a vehicle.

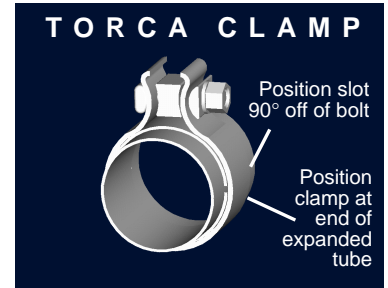

Please confirm that all parts are present before beginning the factory exhaust system removal and CORSA exhaust system installation.

14428 & 14436 Bill of Materials:

- Driver Side Rear Muffler Assembly (**SPORT 17CH2057**) OR (**XTREME 17CH2110**)
- Passenger Side Rear Muffler Assembly (**SPORT 17CH2058**) OR (**XTREME 17CH2111**)
- Driver Side Axle Pipe (**17CH4056**)
- Passenger Side Axle Pipe (**17CH4057**)
- Driver Side Tunnel Muffler (**17CH2046**)
- Passenger Side Tunnel Muffler (**17CH2046**)
- X-Pipe Assembly (**17CH4052**)
- (8) 2.5" Clamps
- (1) Anti-Seize Lube Pouch

Recommended Tools:

- Safety Glasses
- 13mm Wrench
- 13mm Socket
- 15mm Wrench
- 15mm Socket
- Grommet Pullers
- 3/8" Ratchet
- 12" Ratchet Extension
- Torque Wrench

14429 & 14437 Bill of Materials:

- Driver Side Rear Muffler Assembly (**SPORT 17CH2057**) OR (**XTREME 17CH2110**)
- Passenger Side Rear Muffler Assembly (**SPORT 17CH2058**) OR (**XTREME 17CH2111**)
- Driver Side Axle Pipe (**17CH4056**)
- Passenger Side Axle Pipe (**17CH4057**)
- Driver Side Tunnel Muffler (**17CH2054**)
- Passenger Side Tunnel Muffler (**17CH2054**)
- X-Pipe Assembly (**17CH4052**)
- (8) 2.5" Clamps
- (1) Anti-Seize Lube Pouch

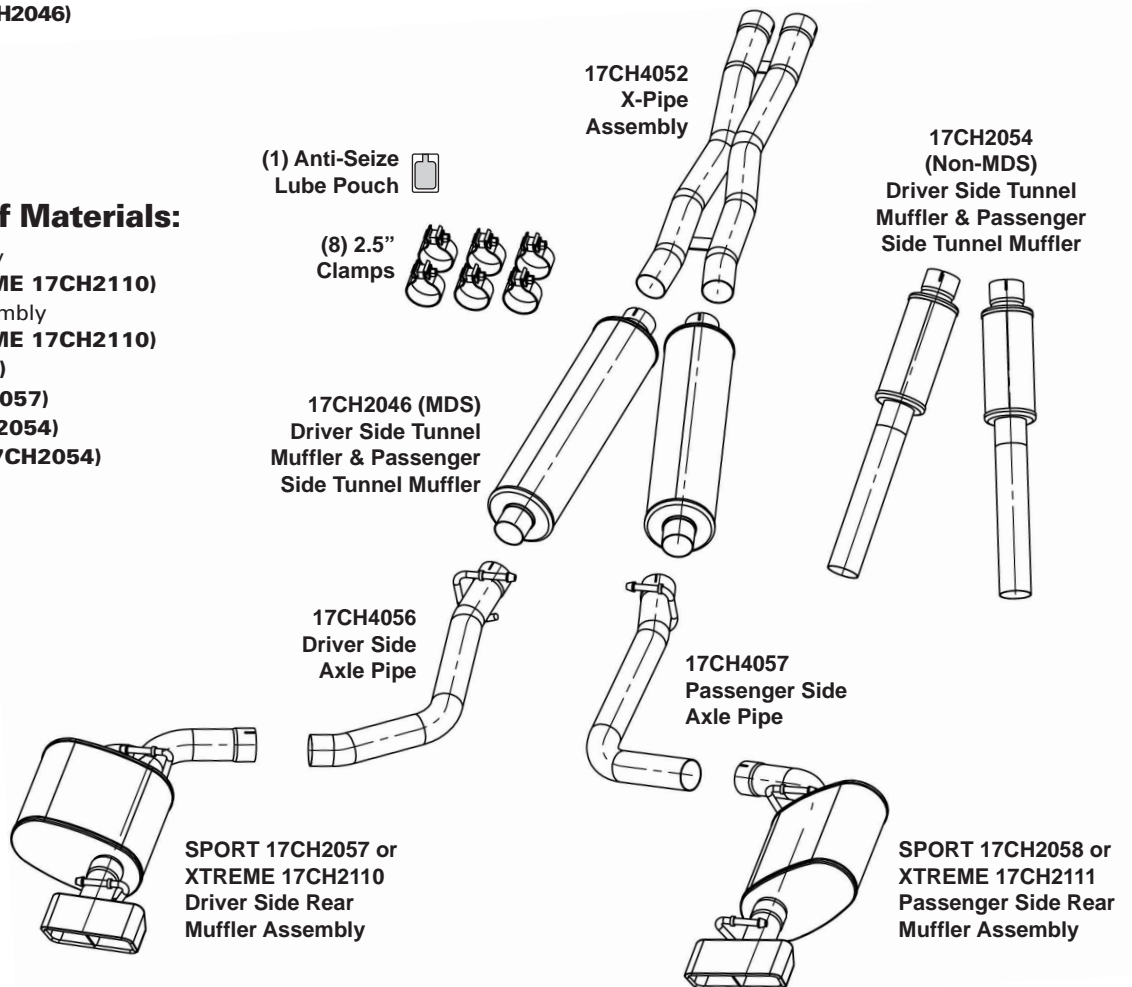

Factory Exhaust System Removal:

NOTE: Penetrating spray lubricant will assist with removal.

1. Loosen the nuts and bolts at the flange connection on the driver side of the tunnel muffler using a 13mm wrench or socket. **(See Fig. A)**
2. Remove the driver side rear muffler factory hangers from the chassis using a 13mm socket and 12" extension attached to a 3/8" ratchet. **(See Fig's B & C)**
3. Remove the driver side axle pipe hanger from the grommet shown in **Fig. D** using grommet pullers or a similar device. Carefully remove the rear driver side section of the stock exhaust from the vehicle.
4. Remove the grommets and chassis hangers from the driver side section of the stock exhaust and replace in the original factory position. Torque the bolts to 18 ft-lbs. **(See Fig's E, F & G)**
5. Remove the grounding clip from the passenger side rear muffler. **(See Fig. H)**
6. Repeat step 2 for the Passenger Side rear muffler factory chassis hangers.
7. Using a 15mm Socket loosen the clamps at the front of the stock exhaust system. **(See Fig. I)**



FIG. A



FIG. B



FIG. C



FIG. D



FIG. E



FIG. F



FIG. G



FIG. H



FIG. I

8. Remove the passenger side axle pipe hanger from the rubber grommet shown in **Fig. J**. Carefully remove the remaining stock exhaust system from the vehicle. **(See Fig. K)**
9. Repeat step 4 for the passenger side. **Fig's L & M** show the passenger side chassis hangers and grommets replaced to the original factory position. **Torque the bolts to 18 ft-lbs.** The removal of the factory system is complete.

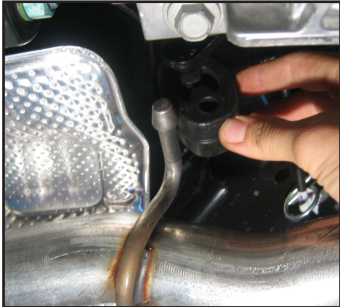

FIG. J

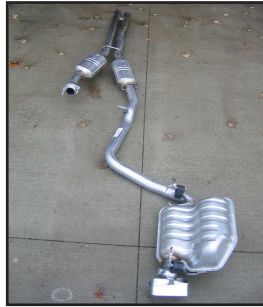

FIG. K



FIG. L



FIG. M

CORSA Exhaust System Installation:

INSTALLATION NOTE: Be sure to apply the provided anti-seize lubricant to all bolts, fasteners and clamps. A pouch is included with the hardware kit. Apply the supplied anti-seize lubricant to the threads **ONLY** of all TORCA band clamps. Failure to follow this procedure can cause the nuts to seize on clamps and potentially damage threads. **WARNING:** Be sure to thoroughly clean hands after use. Anti-seize lubricant will tarnish stainless steel parts.

All clamps should be tightened using a properly calibrated Torque Wrench. Using an air impact gun will damage the clamp and reduce its ability to effectively seal the joint. It may also cause the joint to separate thereby causing damage to your exhaust system and your vehicle.

1. Locate the CORSA crossover pipe assembly. Place two of the supplied 2.5" Torca clamps over the inlet side of the crossover pipe. The inlet side is expanded and notched. Slide the crossover-pipe over the stock pipes until it completely bottoms out. **(See Fig's N & O)**



FIG. N

2. Locate the CORSA Tunnel muffler. Place a 2.5" Torca clamp over the inlet side of the muffler. Slide the tunnel muffler over the passenger side leg of the x-pipe. **(See Fig's P & Q)** **(See Drain Hole NOTE, Fig. R - for tunnel muffler 17CH2046 – Make sure that small drain holes in muffler face down when installed.)**



FIG. O



FIG. P



FIG. Q



FIG. R

3. Locate the passenger side axle pipe and place a supplied 2.5" Torca clamp over the inlet side of the pipe. Then slide the pipe onto the end of the tunnel muffler and insert the hanger into the factory rubber grommet. **(See Fig's S & T)** Pre-tighten the Torca clamp at this time, leaving clamp loose enough for adjustment later.
4. Locate the Passenger Side Rear muffler and insert a supplied 2.5" clamp over the inlet side of the muffler. Slide muffler onto axle-pipe; then slide hangers into rubber grommets. **(See Fig's U&V)** (Soapy water in the grommet holes will aid in the installation of the muffler.) Insert the grounding clip on the muffler hanger. **(See Fig. W)** Pre-tighten the clamp at this time, leaving clamp loose enough for adjustment later.
5. Repeat steps 2 through 4 to install the driver side tunnel muffler, axle pipe, and rear muffler. There should be a gap between the two end-caps at the inlet side of the tunnel mufflers. **(See Fig. X)**
6. Replace the factory tunnel brace to its original location. **Torque the nuts to 18 ft-lbs.** Using a shop stand **(see Fig's Y & Z)** or a spacer block, create 1/2" clearance between the crossover pipe and the factory tunnel brace. The 1/2" gap will be maintained between the pipe and tunnel brace when tightening the clamps in step 7.
7. At this time start from the front of the exhaust system and **tighten all Torca clamps to 45 ft-lbs.** Remove the spacer or stand from the previous step.
8. It is **strongly suggested** that all clamps be checked and tightened after road testing the vehicle once the system has cooled.



FIG. S



FIG. T



FIG. U



FIG. V

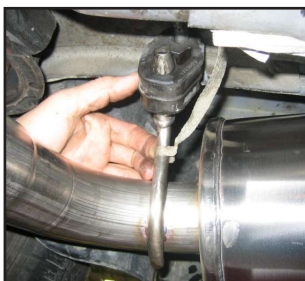

FIG. W



FIG. X



FIG. Y



FIG. Z

Adjustment Section:

At each clamp location, axial and rotational adjustments may be made to center the exhaust tips within the rear fascia.

NOTE: During cold weather start-ups, you may experience an exhaust sound that is deeper and louder in tone than usual. This is temporary and will diminish to normal levels once your engine has reached its normal operating temperature. **NOTE:** Immediately following the installation of your CORSA exhaust system, you may experience a trace of smoke after initial start-up. DO NOT be alarmed. The smoke is caused by the burning of a small amount of forming oil residue used in the manufacturing process.