

Please take time to read and understand these installation instructions.

CORSA recommends that the installation of this system be performed by a qualified service center or professional muffler installer who has the necessary equipment, tools and experienced personnel. However, if you decide to perform this install, the use of a hoist and an additional person will be required.

**CAUTION:** Never work on a hot exhaust system. Allow time for the vehicle to cool. Always wear eye protection when working under a vehicle.

### Recommended Tools:

- 3/8" drive ratchet
- 3/8" drive 15mm deep socket
- 3/8" drive 13mm deep socket
- Short extension (3")
- Long extension (10")
- 13mm wrench
- Torque Wrench
- Safety glasses

Please confirm that all parts are present before beginning the factory exhaust system removal and CORSA exhaust system installation.

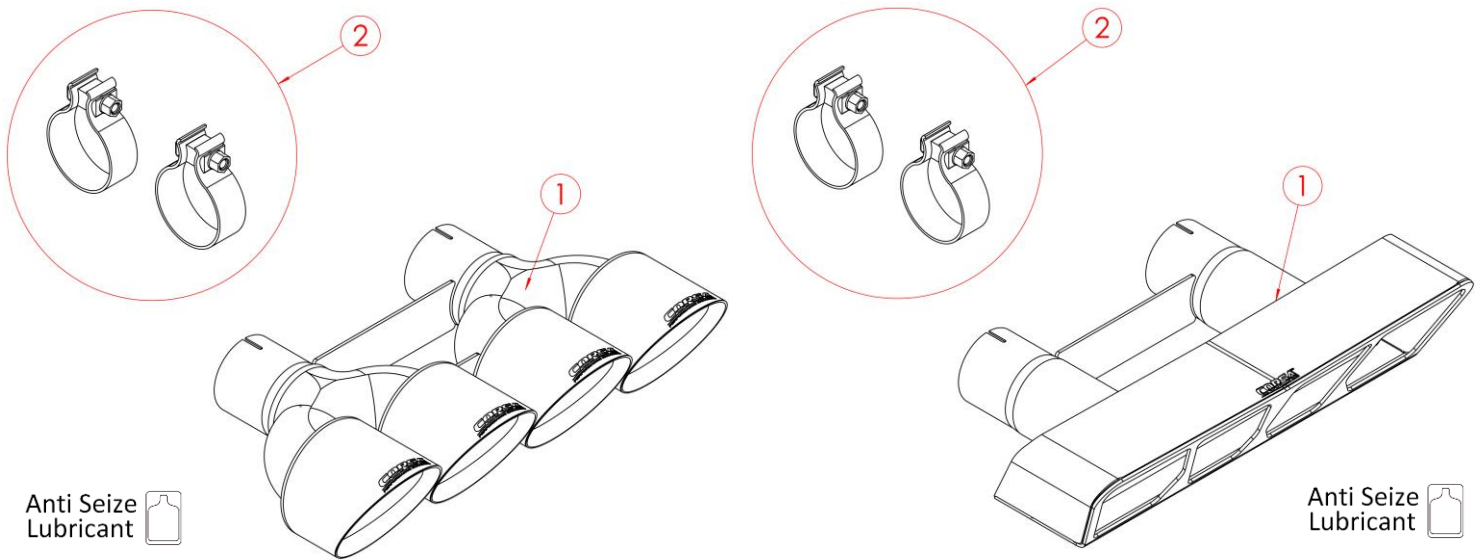

### Bill of Materials

1. Tip Assembly:  
14062/14062BLK (Quad 4.5" Pro Series Tip Asm.)  
14063/14063BLK (Polygon Tip Asm.)
2. 16CN7017 – Tip Hardware Kit

### CORSA Tip Assembly Removal:

1. Loosen the two clamp bolts at the inlet of the current CORSA tip assembly using a 15mm socket and a 3/8" ratchet, and a short extension. **(Fig. A)**
2. CAREFULLY remove the tip assembly from the mufflers to free it from the vehicle. **(Fig. B)**
3. Store the tip assembly in a safe location. CORSA recommends wrapping the tip assembly in foam or something soft and non-abrasive that will keep it from getting scratched or dented.



Fig. A

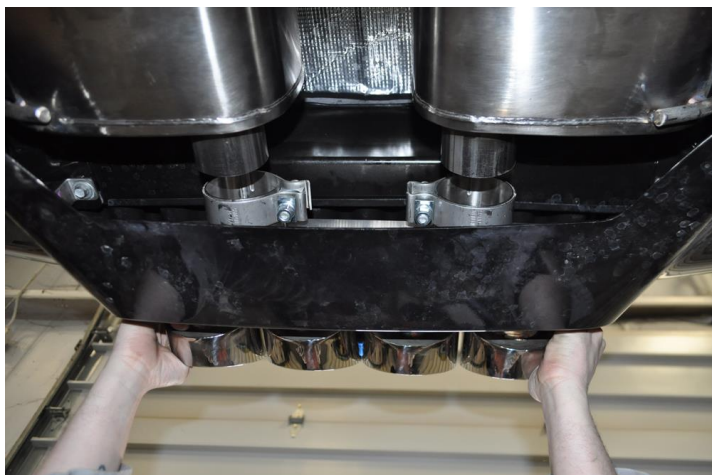
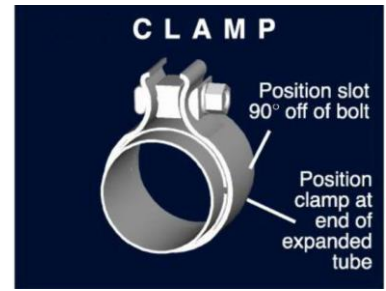

Fig. B

## CORSA Tip Assembly Installation:

**NOTE:** Apply the anti-seize lubricant (supplied) to the threads **ONLY** of all the clamps. Failure to follow this procedure can cause nuts to seize on clamps and potentially destroy threads. After applying anti-seize lubricant, be sure to thoroughly clean your hands, as lubricant will tarnish stainless steel. All clamps should be tightened using a properly calibrated Torque Wrench. Using an air impact gun will damage the clamp and reduce its ability to effectively seal the joint. It may also cause the joint to separate, thereby causing damage to your exhaust system and to your vehicle.

**NOTE:** Align all clamps so that the center of the clamp bolt is 90 degrees from the notch in the pipe. (See Fig. CLAMP)



1. Locate the new Corsa tip assembly, along with the two 2.75" clamps. Align both clamps on the tip inlet as shown, with the clamp bolts to the inside and the clamp nuts facing downwards. (Fig. C (Quad Pro Tips) or Fig. D (Poly Tip))
2. CAREFULLY insert the tip assembly into the cutout in the rear valence. Align the tip assembly inlet with both muffler outlets before sliding it into place as shown. (Fig. E & F (Quad Pro Tips) or Fig. G & H (Poly Tip))

**NOTE:** Loosening the 13mm muffler tie bracket hardware, along with the 15mm clamps at the muffler inlet, will allow additional adjustment (if needed) to install the new tip assembly. (Fig I & J)

3. Adjust the position and depth of the tip assembly until it is centered in the cutout, and has an equal amount of reveal on each side, then tighten the clamps using a 15mm socket and 3/8" ratchet. Re-tighten the clamps at the muffler inlet (if loosened in step 2). Starting at the front and working backwards, torque the clamps to 45ft-lb using the torque wrench and 15mm socket, ensuring that the tips are still in the desired position. (Fig. J & A)

**IMPORTANT NOTE** DO NOT over-tighten the clamps on the tip assembly, as this will make future removal of the tip assembly much more difficult. The C7 CORSA tip assemblies are designed to be interchangeable, between the different tip designs and finishes.

4. Re-tighten the muffler tie bracket hardware (if loosened in step 2) using a 13mm wrench, along with a 13mm socket and 3/8" ratchet. Torque to 15 Ft-Lbs. (Fig. I) Installation complete.

**NOTE:** During cold weather start-ups, you may experience an exhaust sound that is deeper and louder in tone than usual. This is temporary and will diminish to normal levels once your engine has reached its normal operating temperature.

**NOTE:** Immediately following the installation of your exhaust system, you may experience a trace of smoke after initial start-up. DO NOT be alarmed. The smoke is caused by the burning of a small amount of forming oil residue used in the manufacturing process.

**CORSA Exhaust Installation Pictures:**



Fig. C



Fig. D



Fig. E



Fig. F



Fig. G



Fig. H



Fig. I

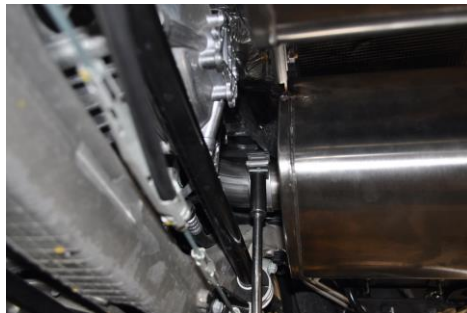

Fig. J