



QUICK START

QUICK START GUIDE



200977

4250W Dual Fuel Open Frame Inverter

⚠ WARNING:

Read the ENTIRE operator's manual to become familiar with the features of the product before operating.

Failure to operate the product correctly can result in damage to the product, personal property and cause serious injury or even death.

CHAMPION
GLOBAL POWER EQUIPMENT™-MC

1. Open shipping carton. Assembly > Unpacking

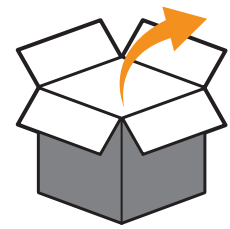

2. Remove shipping spacers. Assembly > Remove Shipping Support Spacers.

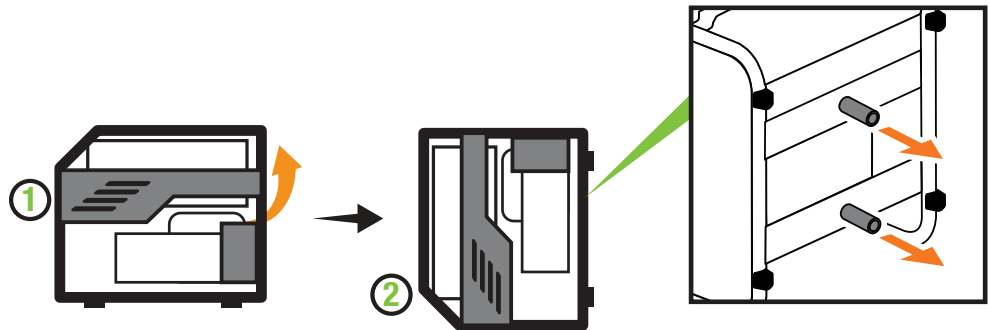

3. Add oil. Assembly > Add Engine Oil. Recommended: 10W-30, up to 18.6 fl. oz. (550 ml) DO NOT overfill.

10W-30



4. Move the generator outdoors. Move generator to an open, outdoor area. Point exhaust away. Never run generator in enclosed areas (e.g., not in house or garage).

Keep all objects at least 5 feet (1.5 m) from generator. Heat from the muffler and exhaust gas can ignite combustible materials.



5.

Add fuel - Gasoline or Propane (LPG)

 Assembly > Add Fuel



**FOR GASOLINE OPERATION:
DO NOT USE E15 OR E85**



6.

DO NOT plug in any electrical devices.



NEVER START OR STOP THE GENERATOR WITH ELECTRICAL DEVICES CONNECTED OR TURNED ON!

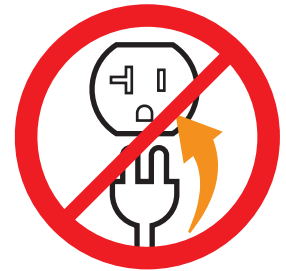

7.

Select Fuel.  Operation > Starting the Engine.

Gasoline: Turn **fuel selector dial** to “GASOLINE RUN” position.
Propane: Turn **fuel selector dial** to “PROPANE RUN” position.

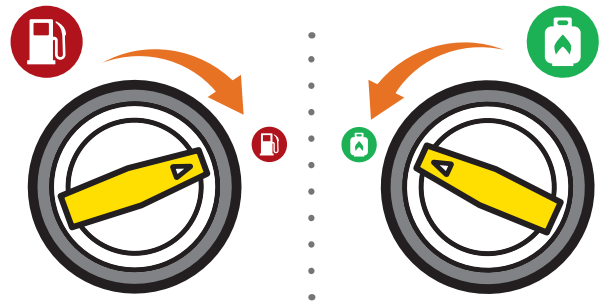

8.

Move the **choke lever** to the “CHOKE” position.

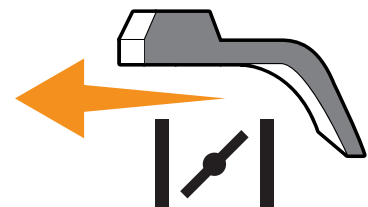

9a.



Starting the Engine: Gasoline

Manual Start

1. Pull the **starter cord**.
2. Move the **choke lever** to the "RUN" position.

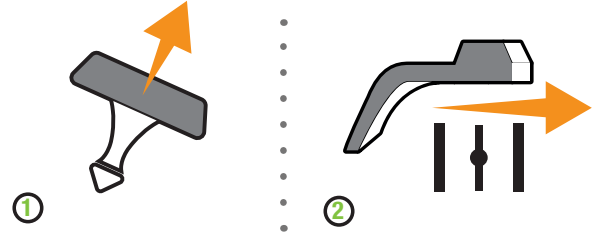

9b.



Starting the Engine: Propane (LPG)

Manual Start

1. Pull the **starter cord** 3-5 times until you feel some combustion pulses.
2. Move the **choke lever** to the "RUN" position.
3. Pull the **starter cord**.

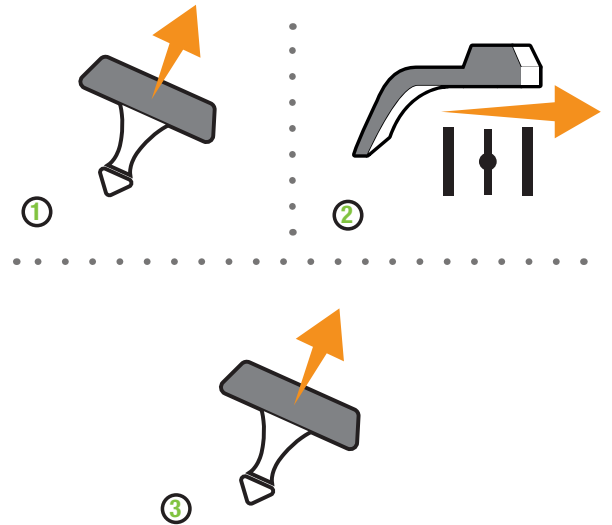

10.

Plug in.  Operation > Connecting Electrical Loads.

