



QUICK START

QUICK START GUIDE



200966

3500W Dual Fuel Portable Generator

⚠ WARNING:

Read the ENTIRE operator's manual to become familiar with the features of the product before operating.

Failure to operate the product correctly can result in damage to the product, personal property and cause serious injury or even death.

CHAMPION
GLOBAL POWER EQUIPMENT™-MC

Set Up

1.

Open shipping carton.  Assembly > Unpacking



2.

Remove brackets.  Assembly > Remove Shipping Support Brackets.

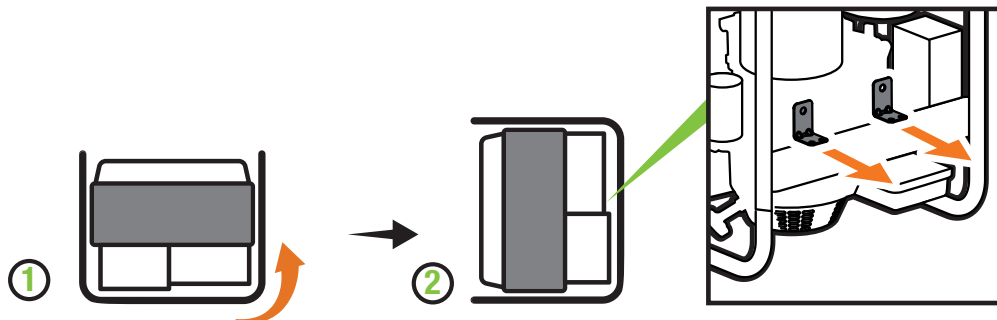

3.

Attach wheel kit.  Assembly > Install Wheel Kit

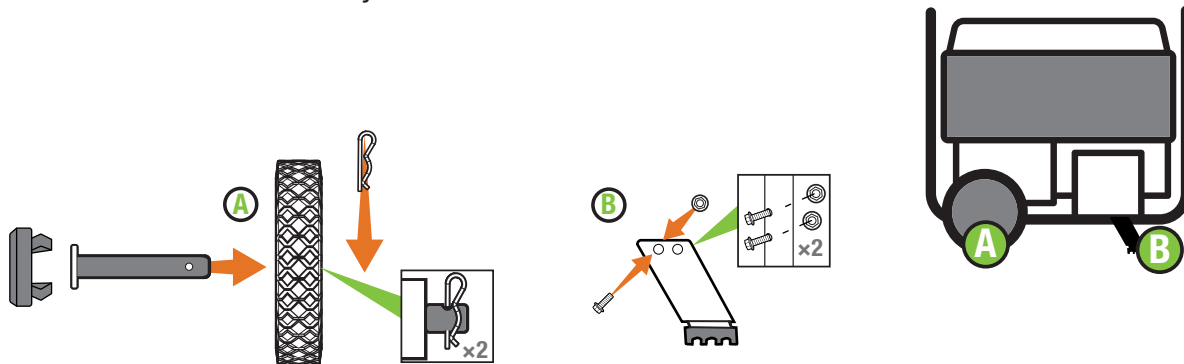

4.

Connect the battery.  Assembly > Connect the Battery.

Cut cable tie on each side of battery connector.
Push two halves of battery connector together tightly.

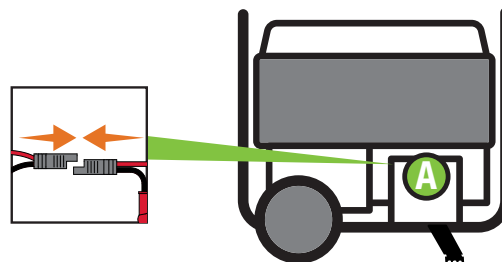

5.

Add oil.  Assembly > Add Engine Oil.

Recommended: 10W-30, up to 20.3 fl. oz. (600 ml) DO NOT overfill.

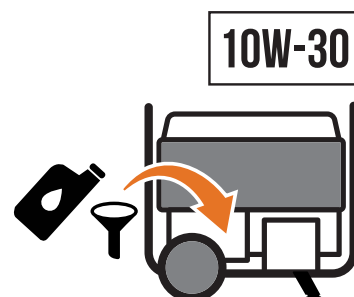

6.

Move the generator outdoors.

Move generator to an open, outdoor area. Point exhaust away. Never run generator in enclosed areas (e.g., not in house or garage).



Keep all objects at least 5 feet (1.5 m) from generator. Heat from the muffler and exhaust gas can ignite combustible materials.



7.

Add fuel. Assembly > Add Fuel: Gasoline
DO NOT use E15 or E85.



Connect propane cylinder.

Assembly > Add Fuel: Propane (LPG)

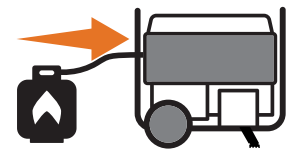

DO NOT plug in any electrical devices.

8.

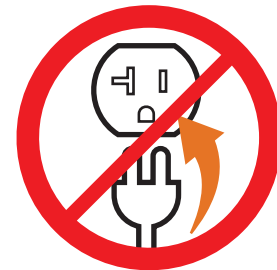

9.

Select Fuel. Operation > Starting the Engine.

Gasoline: Turn fuel select dial to “Gasoline Run” position.
Propane: Turn fuel select dial to “Propane Run” position.

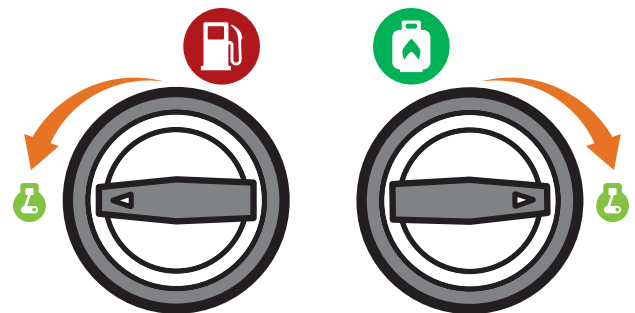

10.

Move the **choke lever** to the “CHOKE” position.

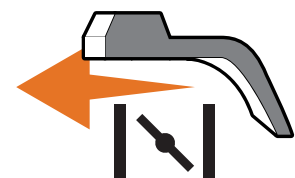

11a.



Gasoline

Electric Start

1. Press and hold the ignition switch to the "START" position.
2. Move the choke lever to the "RUN" position.

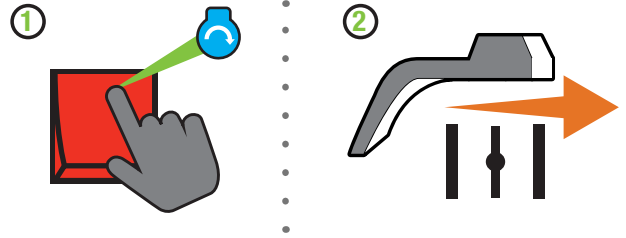

Manual Start

1. Pull the starter cord.
2. Move the choke lever to the "RUN" position.

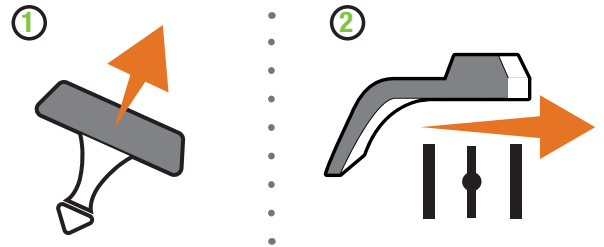

11b.



Propane

Electric Start

1. Press the ignition switch to the "START" position for 2-3 seconds.
2. Move the choke lever to the "RUN" position.
3. Press and hold the ignition switch to the "START" position.
4. If engine does not start, wait 10 seconds, then repeat step 3.

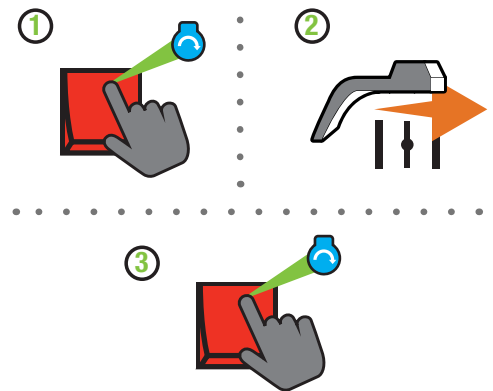

Manual Start

1. Pull the starter cord 2-3 times until you feel some combustion pulses.
2. Move the choke lever to the "RUN" position.
3. Pull the starter cord.

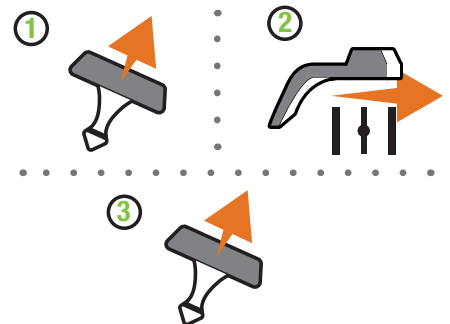

12.

Plug in.  Operation > Connecting Electrical Loads.

