

Please read all instructions carefully before assembly, installation and/or use of this product.

WARNING: DO NOT exceed 400 Lbs. (182 Kgs)
WARNING: DO NOT exceed vehicle manufacturer's weight rating.

Kit Contents:

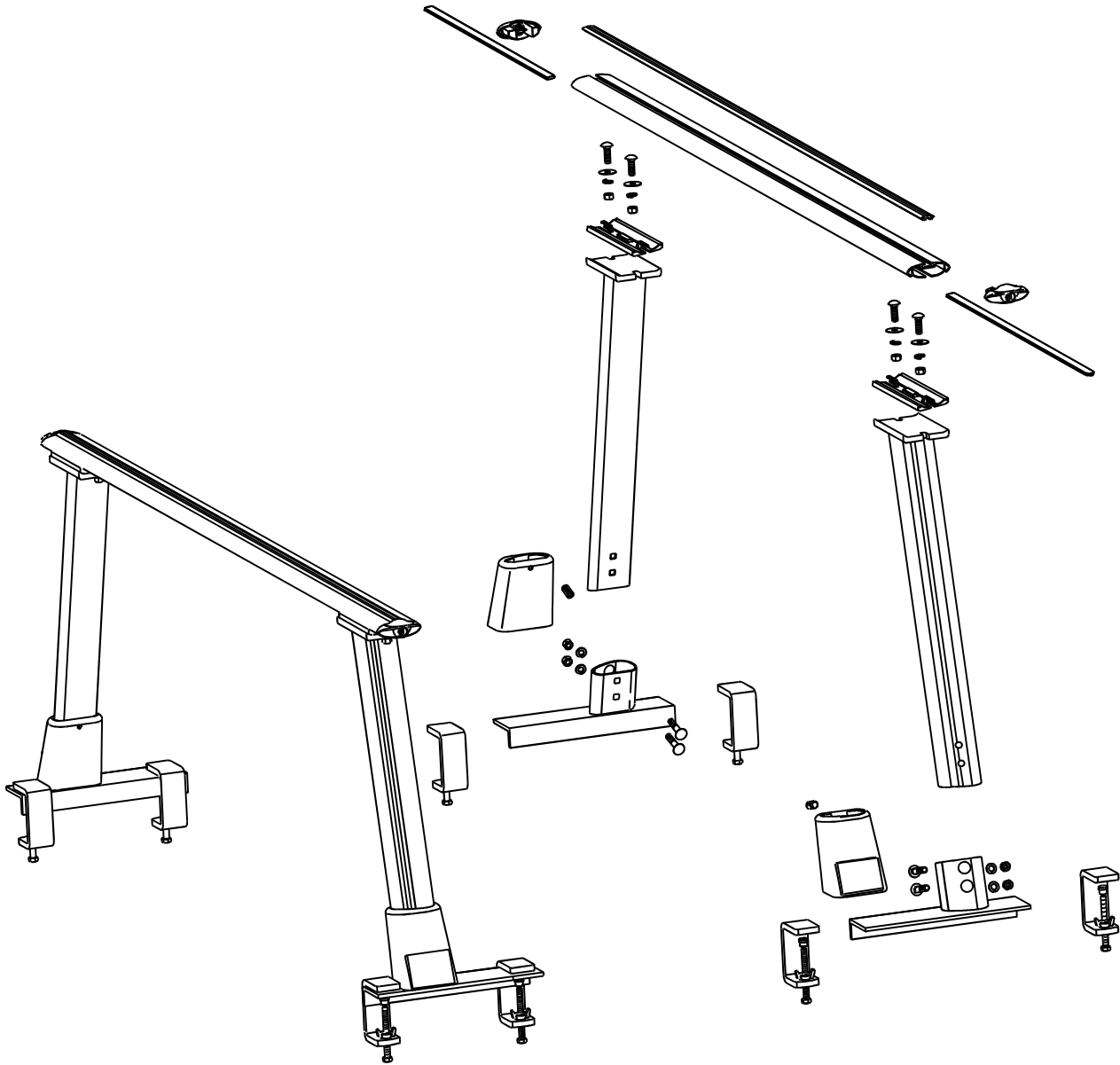

KEY FEATURES:

- Fully adjustable, fits most pick-up trucks without integrated bed rail systems
- Stainless Steel hardware
- Light-weight Aluminum extrusion
- Wear-resistant finish
- Aerodynamic design
- Easy-on bar clamps
- No-drill installation
- Double Lock anchor points

Please read all instructions carefully before assembly, installation and/or use of this product.

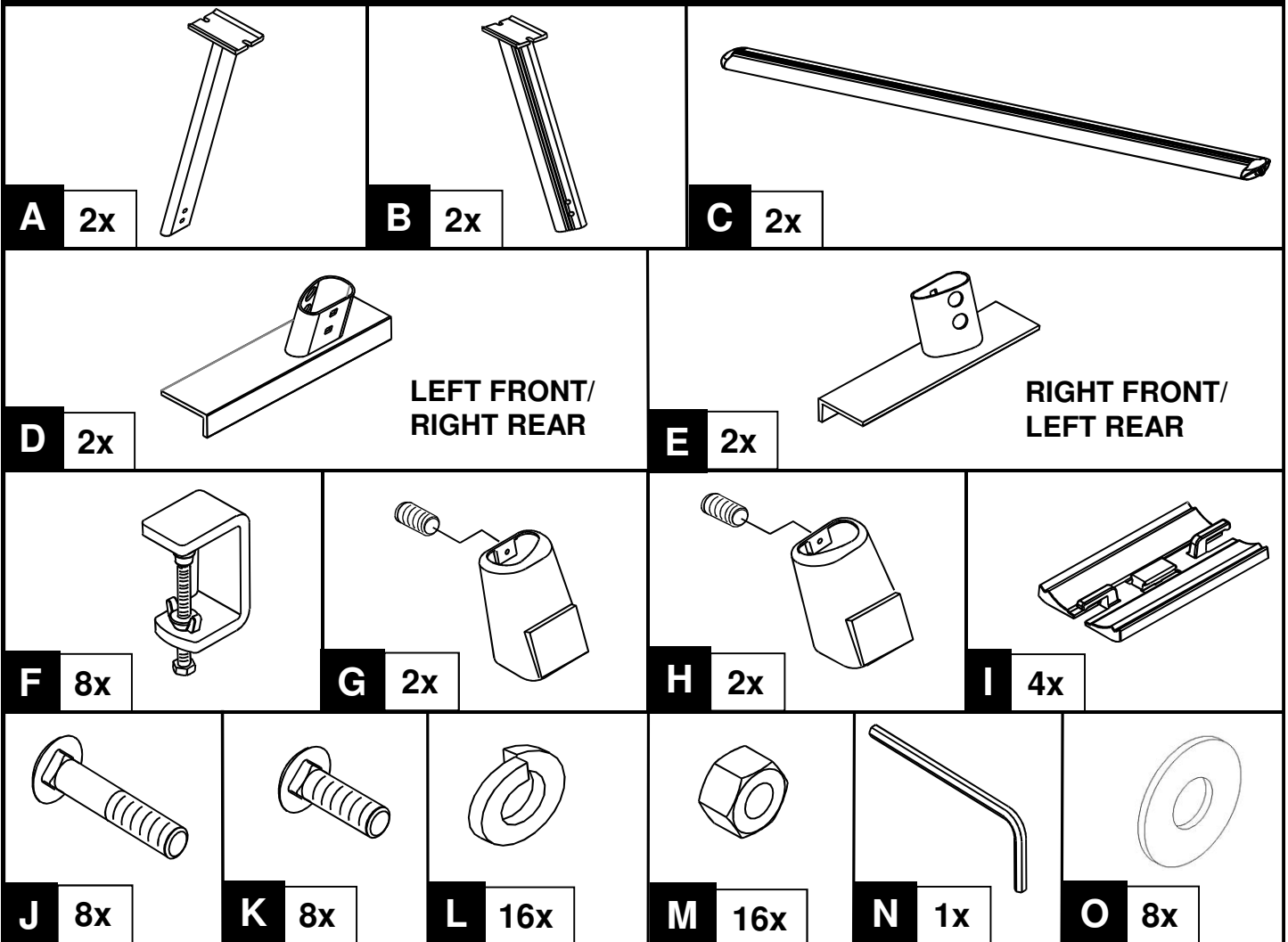

Tools Required:



9/16" Socket



9/16" Wrench



1/8" Hex Key



Tape Measure



Utility knife

Parts included:

ITEM	DESCRIPTION	ITEM	DESCRIPTION
A	Vertical Support Left Hand	I	Crossbar Mounting Adapter
B	Vertical Support Right Hand	J	3/8-16 x 2.00 GR5 Carriage bolt (SS)
C	Crossbar Assembly	K	3/8-16 x 1.25 GR5 Carriage bolt (SS)
D	Support Base Left Front / Right Rear	L	3/8 Helical Lock Washer (SS)
E	Support Base Right Front / Left Rear	M	3/8-16 Hex Nut (SS)
F	Clamp	N	Hex Key Wrench 1/8"
G	Cover & 1/4-20 Set Screw LH	O	Flat Washer 3/8 (SS)
H	Cover & 1/4-20 Set Screw RH		

Please read all instructions carefully before assembly, installation and/or use of this product.

Assembly of Vertical Supports

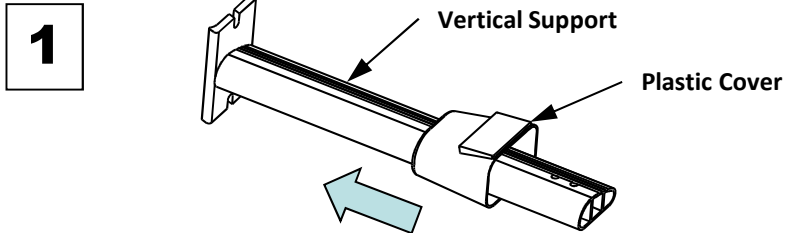

- Slide plastic cover over vertical support as shown.

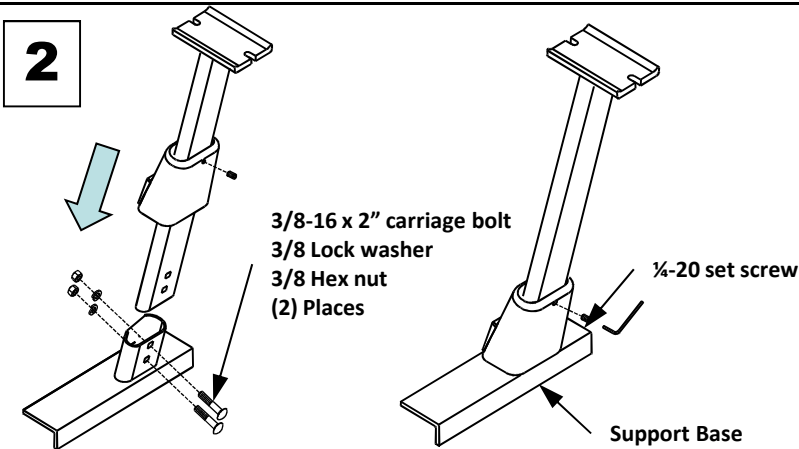

- Slide vertical support and cover into Support Base.
- Install two 3/8-16 x 2" long carriage bolts through the two square holes in back of base and through vertical support.
- Install the 3/8 lock washers and hex nuts onto carriage bolts.
- Securely tighten all 3/8-16 fasteners (approximately 25 Lb.-Ft.)
- Slide cover into position and secure with 1/4-20 set screw using a 1/8" hex key wrench. **DO NOT over tighten.**
- Repeat steps for all four supports.

Vehicle Installation

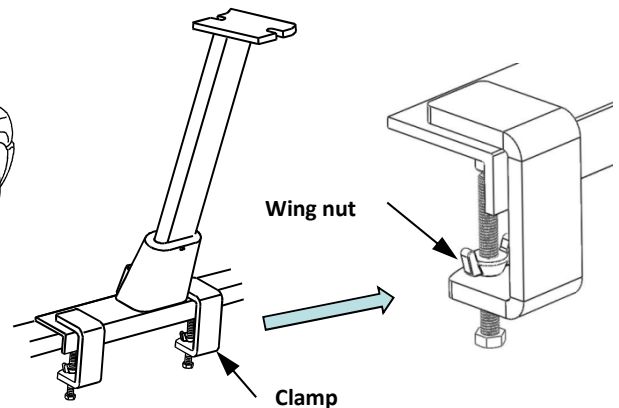
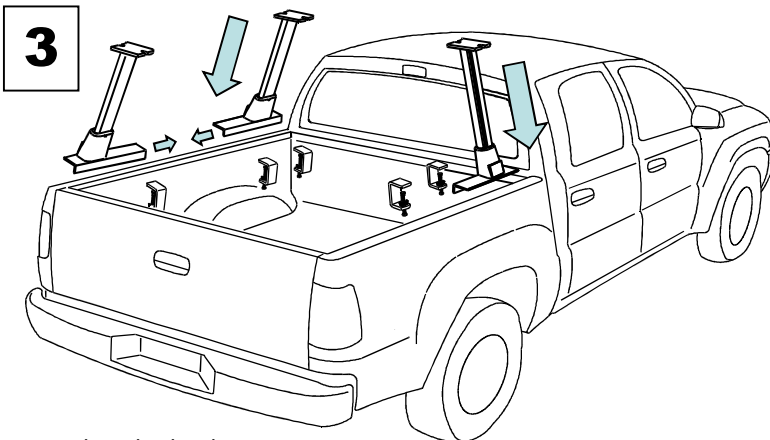

- Clean bed rails.
- Place Vertical Supports onto bed rail in desired location. The long end of base must point towards the inside of truck bed.

TIP: Mounting location is different for each bed design and may require adjustment to avoid interference with mounting hardware.

**** Note: Some bed liners or bedrail covers may require alteration. It may be necessary to cut away a section of the liner on the underside of the bedrail.**

- Attach clamps and hand tighten.
- Ensure both support bases are aligned front to back on bed rail, both sides.
- Confirm position of supports on bed and securely tighten clamps.
- Tighten wing nut against bottom of clamp.

Please read all instructions carefully before assembly, installation and/or use of this product.

4

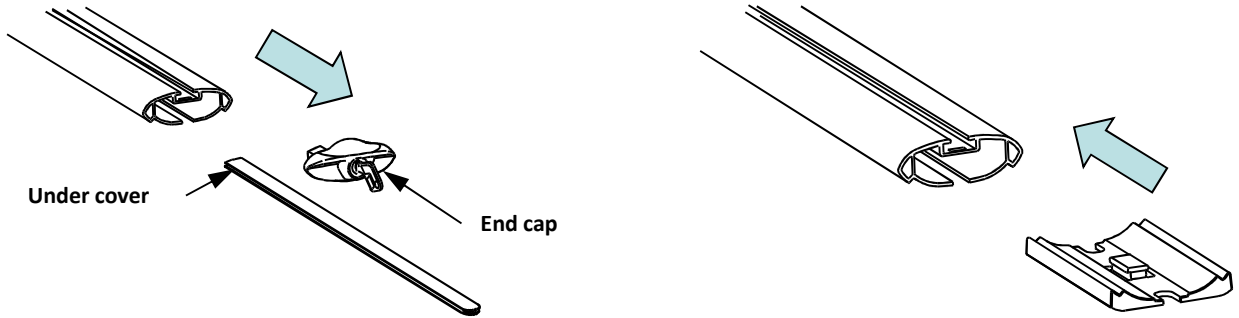

- Remove end cap and under cover from both ends of crossbars.

- Install Adapter Blocks into each end of crossbar.

5

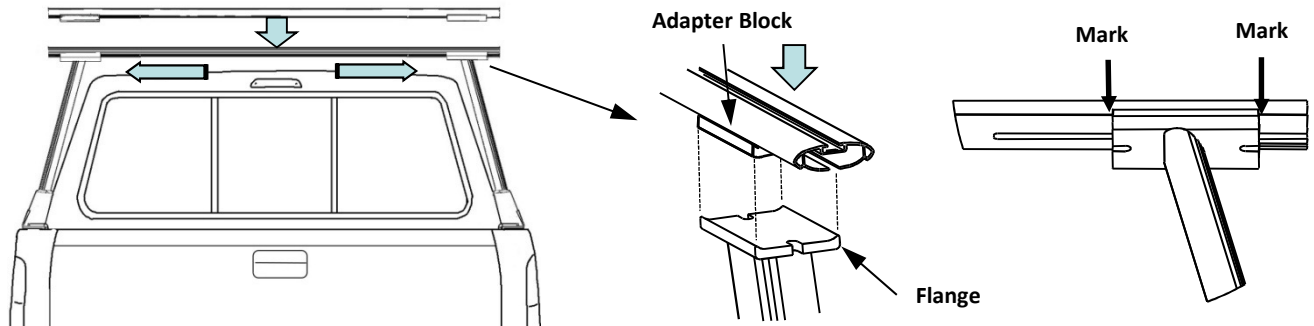

- Place crossbar onto Vertical Supports and center side-to-side.
- Be sure to align the Adapter Blocks with the Vertical Supports Flanges.
- Mark with pencil the crossbar location on each side of Vertical Support Flange for under cover installation.

6

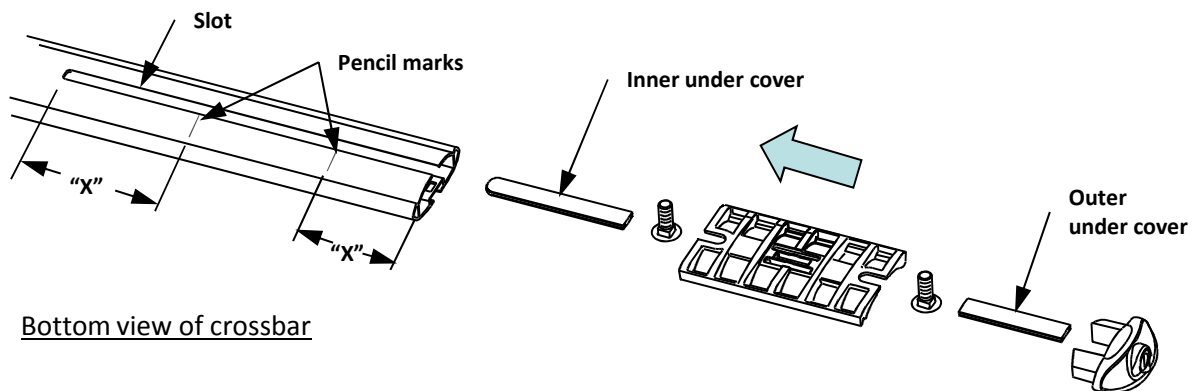

- Remove crossbar from vertical supports. Remove adapter blocks from crossbars.
- Measure distance "x" from pencil marks to end of slot as shown above.
- Cut inner under cover to length first (rounded end), then cut outer under cover to length.
- Install under covers, 3/8 x 1.25 carriage bolts, adapter block and end cap to both ends of crossbars as shown.

Please read all instructions carefully before assembly, installation and/or use of this product.

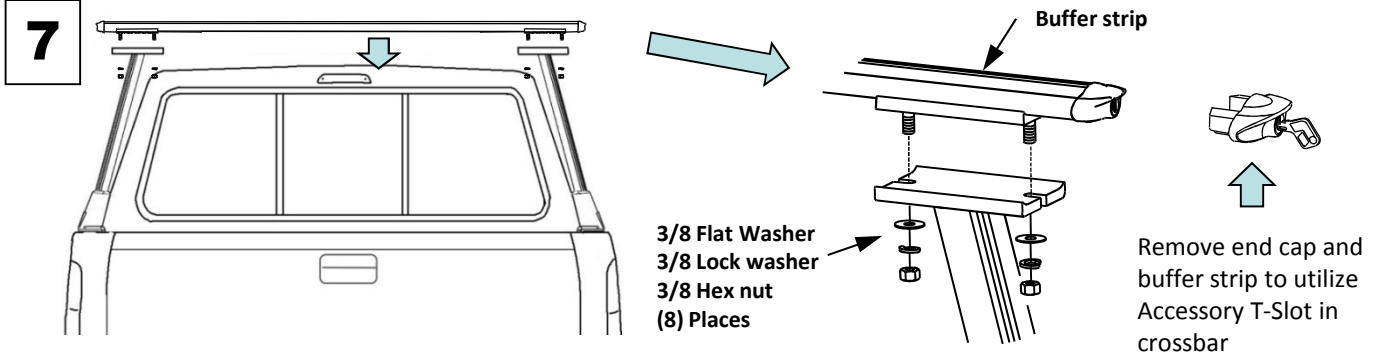

- Install crossbars onto Vertical Supports, align carriage bolts with slots in Vertical Support Flanges.
- Secure crossbars to supports using the 3/8 flat washer, lock washers and hex nuts onto carriage bolts.
- Securely tighten all 3/8-16 fasteners (approximately 25 Lb.-Ft.)

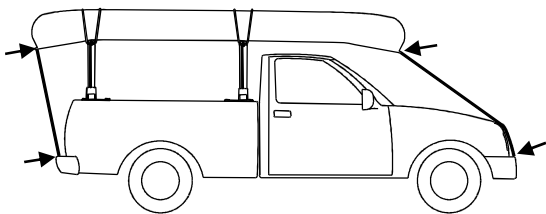

⚠ WARNING

Always secure front and rear of long loads to ends of vehicle for safe transport. Failure to do so can result in property damage, personal injury, or death.

REMOVE YOUR RACK AND ACCESSORIES WHEN NOT IN USE AND BEFORE ENTERING AUTOMATIC CAR WASHES

Optional permanent mounting

Your Pick-Up-Rack™ can be permanently mounted to your truck if you desire. You will need (8) 3/8-16 Grade 5 hex bolts, (16) 3/8" flat washers and (8) 3/8 -16 grade "A" lock nuts. Stainless steel hardware is recommended. Start by placing a piece of tape on top of the mounting base. Mark the tape as shown below. Place the mounting base on the truck and check that there will be no interference where the bolts will be placed. Remove the base from the truck and drill the (2) 3/8" holes in the marked locations on the base. Mark the truck bed rails using the drilled base as a template. Then drill the (2) 3/8" holes in truck bed rail, 4 places.

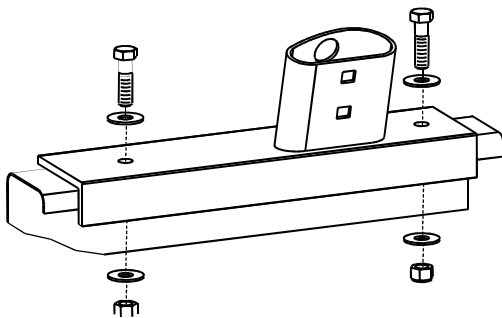
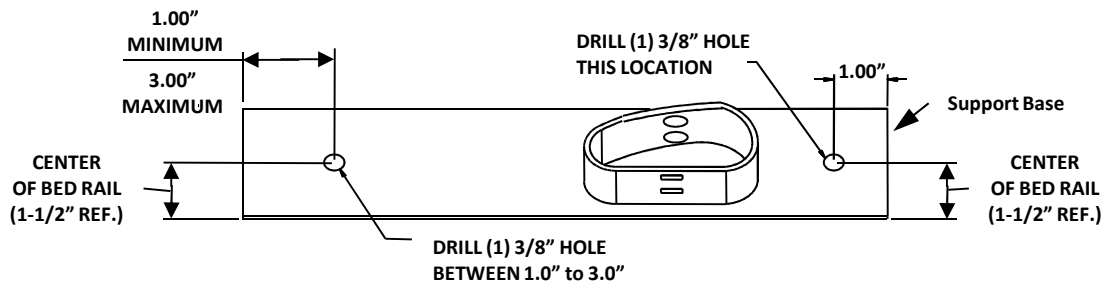

Place a 3/8" washer on a 3/8-16 bolt and insert it through the base and truck bed. Install a 3/8" washer and 3/8-16 nut on the bolt underneath the bed rail and tighten.

Please read all instructions carefully before assembly, installation and/or use of this product.

Recommendations

- Inspect entire rack often. Discontinue use if any signs of damage are seen such as bends, creases, cracks or breaks.
- Check all connections for tightness.
- If the rack will not be moved or removed frequently, it may be helpful to use a thread locker on connecting hardware.

Vehicle Fit

The Pick-Up-Rack™ was designed to be installed on trucks without a traditional over the rail plastic bed liner. Installation is possible on trucks with under-the-rail bed liners with minimal trimming. Spray on bed liners will not interfere with this product. The Pick-Up-Rack™ is based on vehicle designs available at the revision date of these instructions. The Pick-Up-Rack™ is designed to fit a variety of bed lengths and cab designs. It is not recommended for pick-up beds with integrated bed rail systems.

WARNING!

- **DO NOT exceed** the lesser of the maximum load capacity of 400 lbs. (182 Kg.) evenly distributed . “Distributed load” is defined as a load that is not concentrated in a small area.
- Any load carried above the bed rails will increase your truck’s center of gravity and will significantly hinder your trucks ability to maneuver, stop turn or accelerate. Avoid sharp turns and excessive speeds as this will increase risks.
- This truck rack is solely intended for, and only safe for, transporting ladders, lumber, pipe and other similar materials or recreational items such as canoes and kayaks.
- Any modification or unintended use of this product voids any warranty and could create a hazardous condition that may result in property damage, serious bodily injury and/or death. The sole exception being permanent mounting within the prescribed method.
- Truck beds with liners may require modification prior to use of the product.
- Not for off-road use.
- Only use non-stretch tie down straps.

IMPORTANT!

- Loads that exceed the vehicle manufacturer cargo and / or entire gross vehicle weight (GVW) rating, are not covered by warranty.
- Always evenly distribute load on rack before driving.
- Loads must be secure according to local height and identification regulations and or laws.
- Secured loads and connections must be re-checked periodically for tightness.
- Overloading the vehicles GVW may cause damage and severely alter the vehicle’s handling and braking characteristics and or cause the vehicle to roll over.
- It is recommended the tailgate be in the up position during use to better stabilize the truck bed.
- For safety to your vehicle and rack system, obey all posted speed limits and traffic cautions. Adapt your speed to the conditions of the road and the load being carried.
- All locks must be turned and moved periodically to ensure smooth operation. Use graphite or dry lubricant on locks.
- Cequent locks are designed to deter theft and vandalism, but should not be considered theft proof. Remove valuable gear if your vehicle is unattended for an extended period of time. Place one key in the glove department.
- Lubricate hardware with anti-seize for best long term performance.
- Failure to follow these warnings or instructions will void the warranty.