

Installation instructions

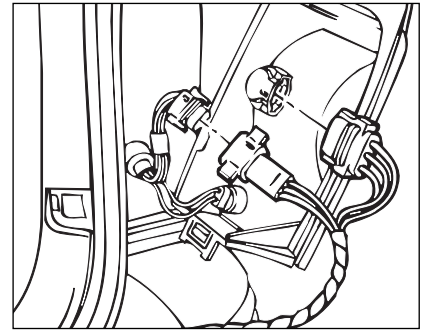

Chrysler Town N' Country, Dodge Caravan, Plymouth Voyager

1. Remove the right tail lamp assembly from vehicle.
 2. Disconnect the wire harness from the upper tail lamp socket. Be careful not to damage connector locking tabs.
 3. Lay T-connector harness on the top of the bumper. Route the connectors with green, brown and white wires to the right side of the vehicle.
 4. Plug T-connector harness connectors into mating plugs on the tail lamp socket and vehicle wiring harness. Be sure that connectors are fully inserted with locking tabs in place (see above illustration).
 5. Repeat this procedure for the left side.
 6. Push the 4-flat plug of the T-connector harness behind the bumper fascia at the center of the vehicle. Route the remainder of the harness behind the bumper as well.
 7. Re-install the tail lamp assemblies, positioning the wireharness between the housing and the body. Be careful not to pinch the wires. Secure harness under bumper.
 8. Test the installation with a test light or trailer.
- This unit is rated for **7.5** amps per circuit.

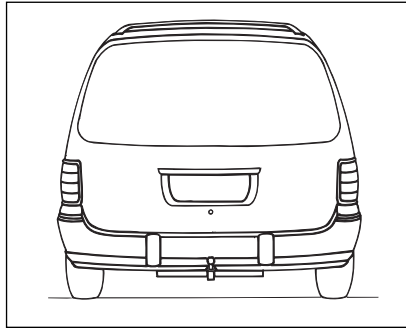
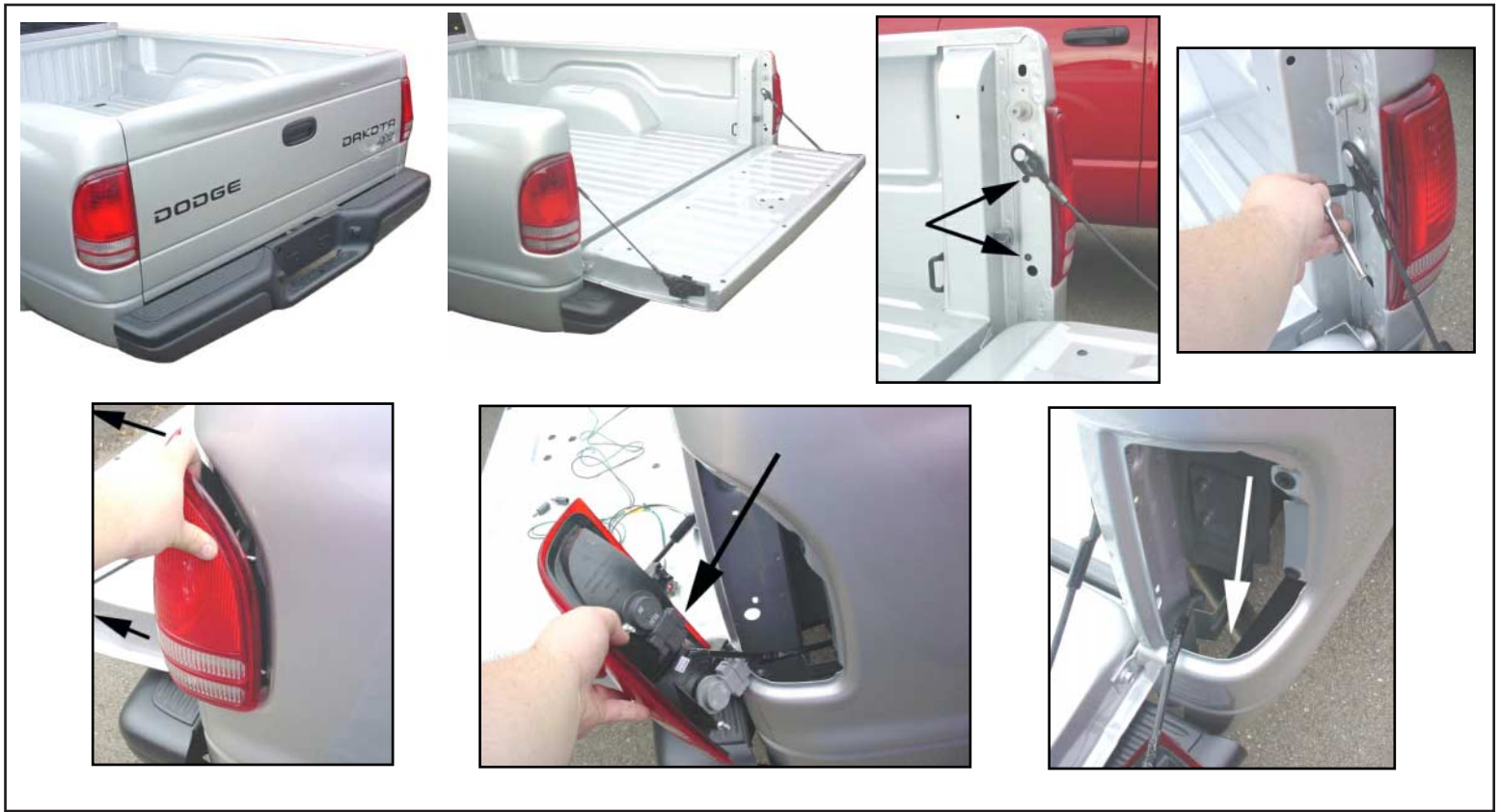

Dodge Dakota

- 1.** Remove both taillight assemblies and access the taillight connectors. Beginning on the left (driver) side, route the T-Connector harness containing the yellow wire out from under the vehicle through the taillight opening.
- 2.** Disconnect the vehicle's wiring harness connector from the taillight assembly and plug the T-Connector between these separated halves, ensuring the connector are fully inserted together.
- 3.** Route the connector with the green wire across the vehicle along the vehicle frame and out from under the vehicle through the right (passenger) side tail light opening. Repeat step 2 using the connector containing the green wire.
- 4.** Re-install taillight assemblies removed in step 1.

This unit is rated for **7.5** amps per circuit.