



FENDER TRIM

Installation Instructions



WARNING
MAGNETIC DEVICES
DO NOT USE NEAR MECHANISM
ADVERTENCIA
DISPOSITIVOS MAGNÉTICOS
NO UTILICEN CON FRENO



Users are responsible for all compliance of state and local laws while operating a motor vehicle. Users assume all risks.

STEP 1. Place fender trim over fender to be installed and align properly from edge to edge

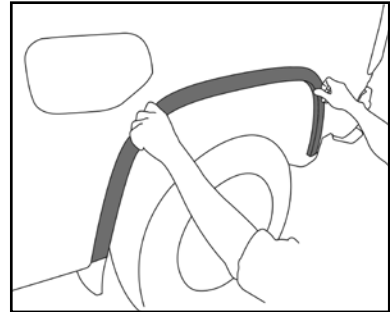

STEP 2 . Firmly press Carrichs' fender trim onto vehicle's fender and mark reference points located on fender trim. Do this to all pilot holes on fender trim.

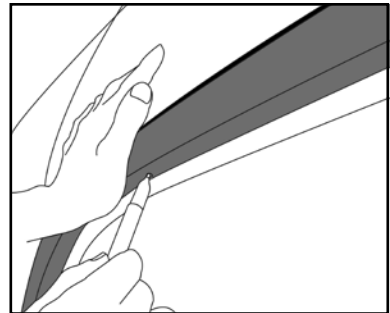

STEP 3 . With fender trim removed, make pilot holes using 7/64 drill bit at designated reference points marked from previous step. Do this to all marked reference points.

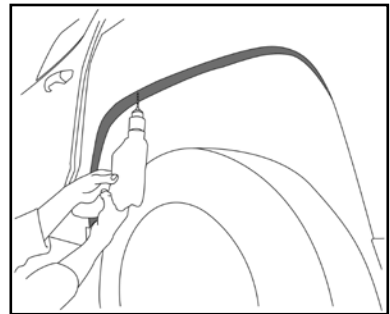

STEP 4 . Drive the supplied stainless steel screws to fender trim with a Phillips screwdriver. Repeat for all other pilot holes.

