

Installation Instructions

5562112 Suspension Leveling Kit, GM 1500 2007+

⚠ WARNING

This product should be installed by a professional mechanic.

Modifying the suspension of this vehicle will alter the steering, braking and handling from factory condition. This will result in the vehicle reacting differently under driving conditions which may occur. Avoid sharp turns, rapid stops, and any other actions or driving conditions that could result in a loss of control and accident, resulting in serious injury or death to driver and occupants.

A wheel alignment must be done after installation of this product to ensure proper steering and suspension performance.

Read all instructions prior to installation to ensure that you have all materials and tools required.

1. Raise vehicle and remove front wheels
2. Disconnect the sway bar link

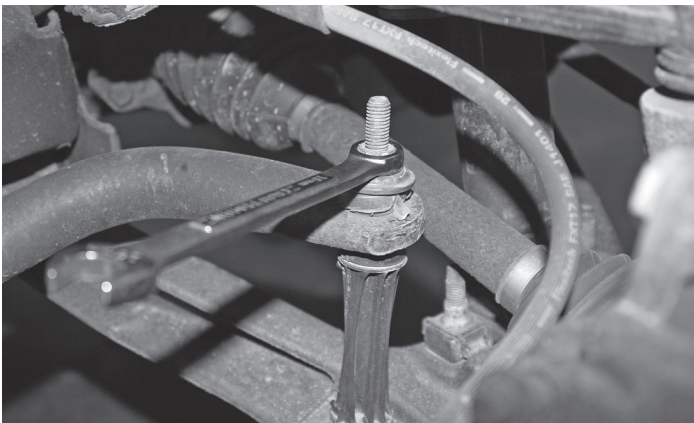

3. Disconnect the ABS line from upper control arm/knuckle



4. Remove and set aside for later reinstallation:
 - a. Upper strut tower nuts

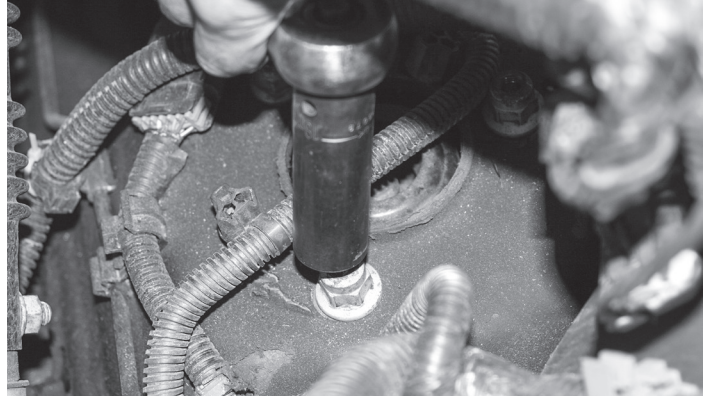

- b. Lower strut bolts.



- c. Upper ball joint nut – it may be separated by striking on the side with a mallet or hammer

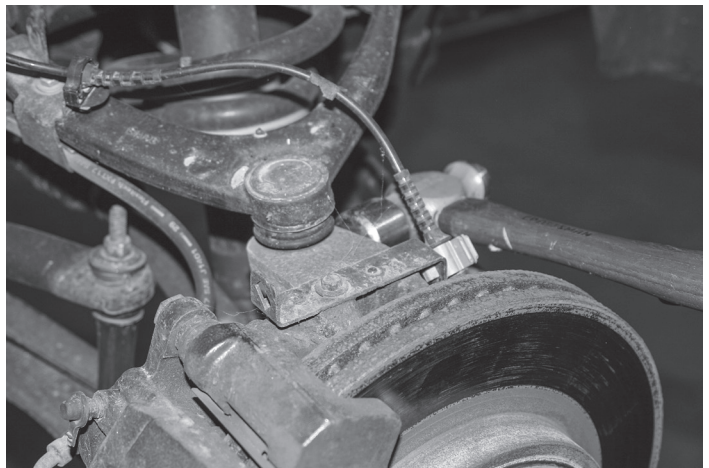

5. Remove the strut

6. Cut the strut bolts to 5/8" length to allow the stud extender to screw down to the bottom of the stud.



7. Apply thread lock and install the stud extenders.

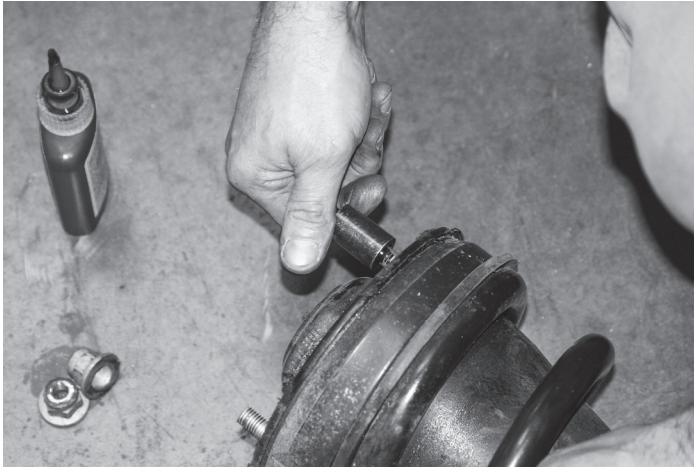

8. Install the lift spacer.

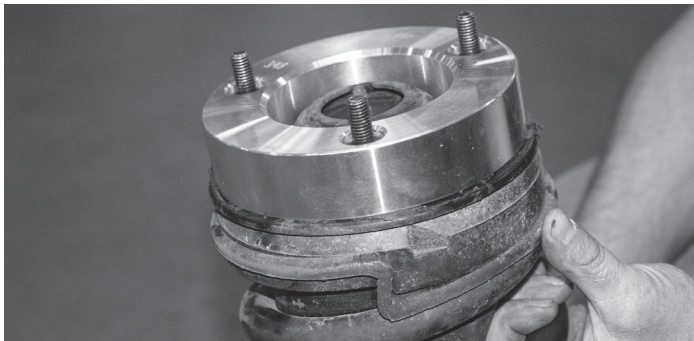

9. Install the lower bolts first & tighten to 39 ft-lbs.

10. Install the upper portion of the strut using lock nuts and tighten to 22 ft-lbs.

11. Reinstall the lower ball joint, sway bar, & ABS lines.

12. Repeat for the other side of the vehicle.

NOTE: A wheel alignment must be done after installation of this product. All fasteners must be checked and retorqued after 5 hours of use.

Bill of Materials

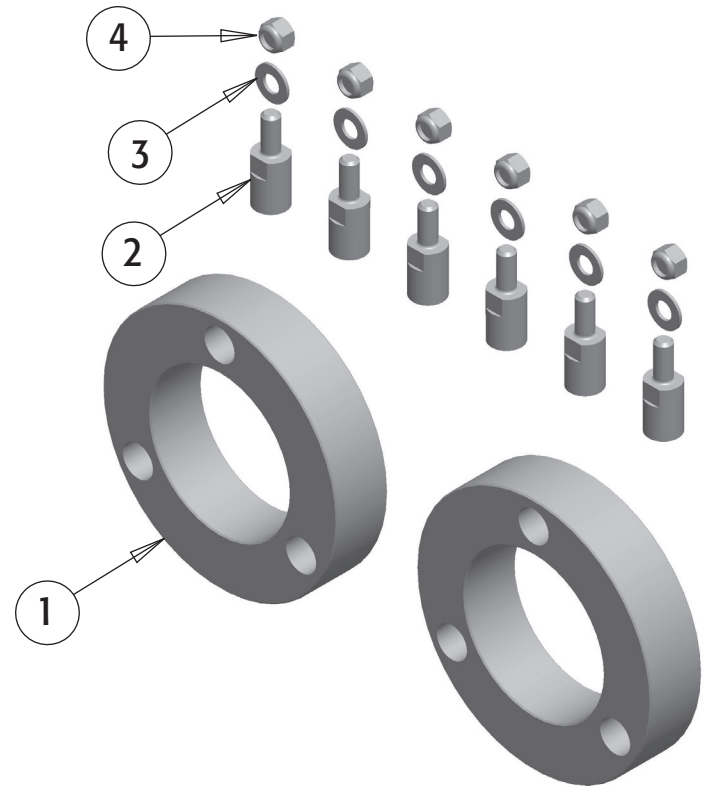

ITEM	PART NO.	QTY.	DESCRIPTION
1	3022113	2	Spacer, GM 1500
2	3022275	6	Extender, Stud
3	FWF038081006	6	Washer, Flat 3/8 SAE, ZN
4	3023590	6	Nut, Nylock M10-1.5, ZN
-	-	1	Sealer, Loctite 27105 Kit