

Installation Instructions

PB10 Pump Support Bracket Kit

1. Install PTO & direct mount dump pump onto the bottom opening of transmission. Rotate pump with valve body positioned down, (other positions are possible).
2. Remove outer nuts presently installed on pump's extended studs. Install (2) 3" coupling nuts onto the hydraulic pump's upper extended studs. Next, install pump plate (3008089 or 3008090) according to your application, to the hydraulic pump with (2) 5/8" x 1.5 hex head bolts, and (2) 5/8" lock washers and flat washers as required.

This step is a pre-assembly step that will be explained later in the text, as 5/8" flat washers also act as shims.

3. Remove the two bolts in transmission auxiliary section directly above hydraulic pump and install 3008091 transmission plate with the same bolts that were just removed. The two mounting plates now overlap.

4. Clamp the transmission plate and the pump plate together with "C" clamp or equivalent. Remove from pump and transmission and weld the two pieces together.

5. Now, re-install the finished pump support bracket. Install transmission bolts and tighten.

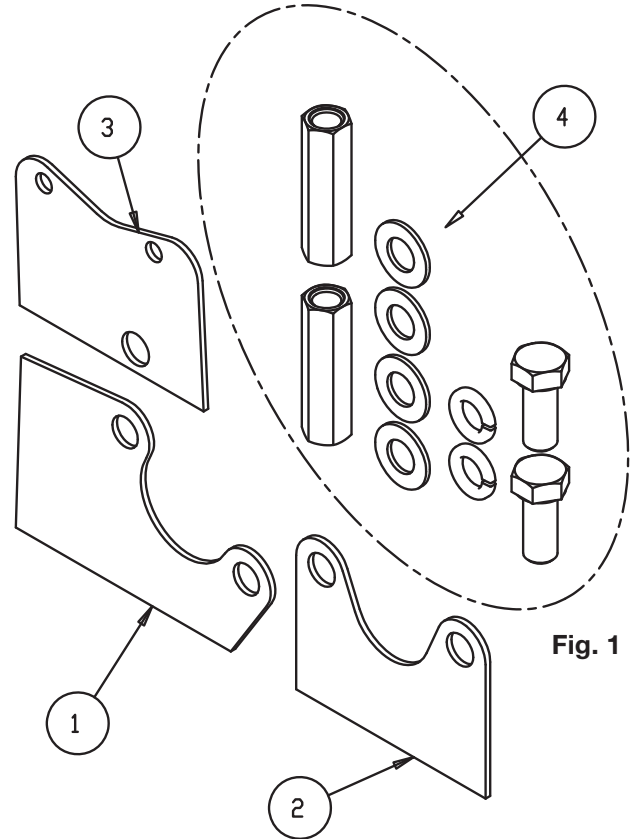

Fig. 1

Bill of Materials

ITEM	PART NO.	QTY.	DESCRIPTION
1	3008090	1	Plate, 5 Arrangement Pump
2	3008089	1	Plate, 3 Arrangement Pump
3	3008091	1	Plate, Transmission
4	3003225	1	Hardware Kit contains:
-	-	2	Coupling Nuts
-	-	2	Bolts, 5/8" x 1.5 Hex Head
-	-	4	Washers, 5/8" Flat
-	-	2	Washers, 5/8" Lock

CAUTION

5/8" washer is required to shim or space distance between coupling nuts and pump plate so that when the two 5/8" x 1.5 hex head bolts are tightened. MAKE SURE IT DOES NOT CAUSE THE BRACKET TO BIND OR FLEX.

Warranty

Buyers Products Co. warrants all truck/trailer hardware manufactured or distributed by it, to be free from defects in material and workmanship for a period of one year from date of shipment. Parts must be properly installed and used under normal conditions. Any product which has been altered, including modification, misuse, accident or lack of maintenance will not be considered under warranty. Normal wear is excluded. The sole responsibility of Buyers Products Co. under this warranty is limited to repairing or replacing any part or parts which are returned, prepaid, and are found to be defective by Buyers Products Co. Authorization from Buyers Products Co. must be obtained before returning any part. No charges for transportation or labor performed on Buyers' products will be allowed under this warranty.