

# 8891500 Series LED Strobe Light Installation Instructions

## Surface Mount

To +VDC (fuse @ 3A).....**RED**

To Chassis Ground.....**BLACK**

For Synchronization:.....**YELLOW**

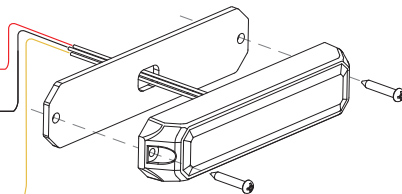

Connect **YELLOW** wires of all heads together for synchronization  
(all heads must be set at the same pattern)

### For Simultaneous or Alternating Flash:

- Apply +VDC to **RED** and **YELLOW** wires simultaneously to enter Grouping mode; lighthouse will display short (single or double) flashes:
  - Single flash = Group 1 · Double flash = Group 2
- Remove **YELLOW** wire from +VDC and momentarily apply to +VDC to change groups:
  - Heads in the same Group flash together.
  - Group 1 Heads alternate with Group 2 Heads.

### For Flash Patterns:

Momentarily apply +VDC to **YELLOW** wire:

- once for next pattern
- quickly three times for pattern 1.

**NOTE:** This unit may not be factory set at FP# 1.

FP#	Flash Patterns	
1	Random	11 Double (all)
2	Single (split)	12 Quad (all)
3	Double (split)	13 Quint (all)
4	Quad (split)	14 Mega (all)
5	Quint (split)	15 Ultra (all)
6	Mega (split)	16 Single-Quad (all)
7	Ultra (split)	17 Single H/L (all)
8	Single-Quad (split)	18 Steady 2 (CA)
9	Single H/L (split)	19 Steady 4 (all)
10	Single (all)	

\*SPLIT = Left alternate Right

\*ALL = Simultaneous

