

Installation Instructions

.....

3020625 V-Box Chain Oiler System

This chain oiler system (3020625) is recommended for the drive chain and sprockets on most V-box salt spreaders.

NOTE: Do a rough layout of the hoses and fittings during the next few steps. Do not drill any holes or make any final connections or cuts until determining where all hoses and fittings will be installed.

1. If not provided on your SaltDogg spreader, select a location to mount the stainless oil tank. Make sure this location is easily accessible to fill tank with oil.
2. Use the predrilled mounting holes, if provided on your SaltDogg spreader, or determine the desired mounting location using the oil tank (3020808) as a template. Mark and drill four 3/8" mounting holes. Four 3/8-16" Screws, nuts and washers are supplied for mounting.
3. Mount the oil tank securely to the spreader.

Bill of Materials

ITEM	PART NO.	QTY.	DESCRIPTION
1	3020808	1	TANK, WELDMENT, OIL SYSTEM, SS
2	HBF16	1	BREATHER CAP 1" NPT
3	3020761	1	FITTING, VALVE, 1/4" MALE TO FEMALE
4	3020749	1	FITTING, ADAPTER, HOSE TO 1/4", PLASTIC
5	3020748	1	FITTING, TEE, 1/4", PLASTIC
6	3020747	2	FITTING, 90 DEGREE, 1/4", PLASTIC
7	3020763	5	1/4" PVC HOSE, CLEAR
8	HK079	1	HOSE CLAMP, .375 DIA
9	3015873	1	SCREW #12-14x.74 SS SELF DRIL HEX WASHER HD
10	H3409X4	1	ELBOW, 90 DEG, MALE NPT, TO FEM 1/4" X 1/4"

4. Install the valve (3020761) into the oil tank, (use the 90 degree fitting if needed, H3409X4).
5. Install the hose adapter fitting (3020749) into valve.
6. Install the hoses (3020763) as needed, see Fig. 1 for layout example.
 - Determine the length of the first hose. Cut and insert the T-fitting (3020748).
 - Cut two more hose lengths and add 90 degree fittings (3020747) above the chain.
 - Cut two more hoses to dispense the oil on the chain.
7. Secure the hoses in place using the provided clamps (HK0709). Make sure not to crush or pinch the PVC lines When installing the clamps.
8. Fill tank with desired oil. **NOTE: Synthetic oils will not freeze.**
9. Open valve to allow oil to flow down to the chain.
10. Oil chain regularly.

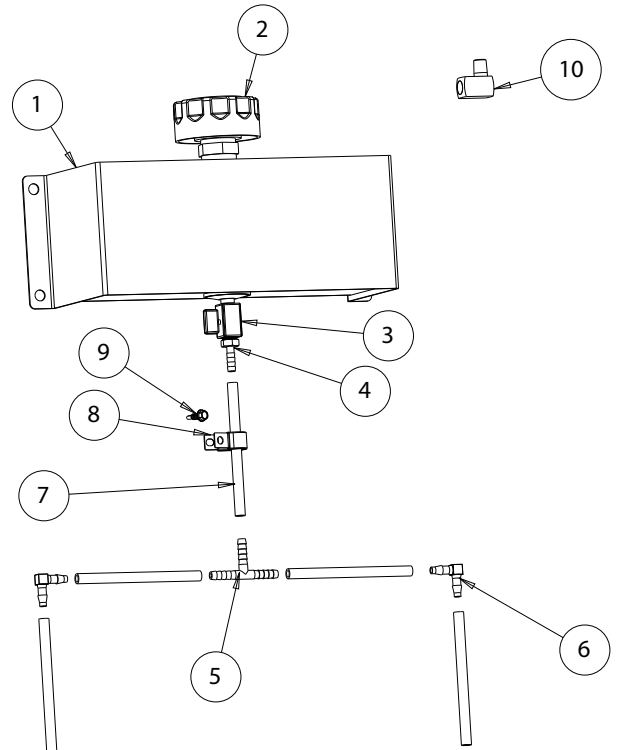

Fig. 1