

# AGA

## 1/4" x 5/8" Fast-acting glass tube fuses



### Product features

- Fast-acting
- 1/4" x 5/8" (6.4 x 15.9mm) physical size
- Glass tube, nickel-plated brass end cap construction
- Optional axial leaded version available
- UL Listed product meets standard 248-14

### Agency information

- UL Listed, Guide JDYX, File E19180 (AGA: 0 - 3 1/2A)
- UL Recognized, Guide JDYX2, File E19180 (AGA: 12 - 30A)

### Ordering

- Specify packaging, product and option code

| Electrical characteristics |                 |                     |
|----------------------------|-----------------|---------------------|
| Rated Current              | % of Amp Rating | Opening Time        |
| 1/4 - 10A                  | 100%            | 4 hours minimum     |
|                            | 135%            | 60 minutes maximum  |
|                            | 200%            | 120 seconds maximum |

| Specifications        |                       |                                |        |       |                                  |       |
|-----------------------|-----------------------|--------------------------------|--------|-------|----------------------------------|-------|
| Part Number<br>(Amps) | Voltage Rating<br>Vac | AC Interrupting Rating* (Amps) |        |       | Typical DC Cold Resistance (Ω)** |       |
|                       |                       | 250Vac                         | 125Vac | 32Vac | Lower                            | Upper |
| AGA-1/10              | 250                   | 35                             | 10,000 | -     | 6.186                            | 8.370 |
| AGA-1/4               | 250                   | 35                             | 10,000 | -     | 0.649                            | 0.879 |
| AGA-1/2               | 250                   | 35                             | 10,000 | -     | 0.223                            | 0.301 |
| AGA-3/4               | 250                   | 35                             | 10,000 | -     | 0.116                            | 0.157 |
| AGA-1                 | 250                   | 35                             | 10,000 | -     | 0.088                            | 0.118 |
| AGA-1 1/2             | 250                   | 100                            | 10,000 | -     | 0.056                            | 0.076 |
| AGA-2                 | 250                   | 100                            | 200    | -     | 0.038                            | 0.052 |
| AGA-2 1/2             | 250                   | 100                            | 200    | -     | 0.027                            | 0.036 |
| AGA-3                 | 250                   | 100                            | 200    | -     | 0.022                            | 0.030 |
| AGA-5                 | 125                   | -                              | 1000   | -     | 0.013                            | 0.017 |
| AGA-6                 | 125                   | -                              | 1000   | 1000  | 0.011                            | 0.015 |
| AGA-7                 | 125                   | -                              | 1000   | 1000  | 0.008                            | 0.011 |
| AGA-7 1/2             | 125                   | -                              | 1000   | 1000  | 0.008                            | 0.010 |
| AGA-10                | 125                   | -                              | 1000   | 1000  | 0.006                            | 0.008 |
| AGA-15***             | 32                    | -                              | -      | 1000  | 0.003                            | 0.004 |
| AGA-20***             | 32                    | -                              | -      | 1000  | 0.002                            | 0.003 |
| AGA-25***             | 32                    | -                              | -      | 1000  | 0.001                            | 0.002 |
| AGA-30***             | 32                    | -                              | -      | 1000  | 0.001                            | 0.002 |

\* Interrupting Rating: Interrupting ratings has been measured at 70%-80% power factor.

\*\* DC Cold Resistance (Measured at <10% of rated current)

\*\*\* UR Component Recognized at 125Vac 100A IR



Powering Business Worldwide

Dimensions - mm (in)

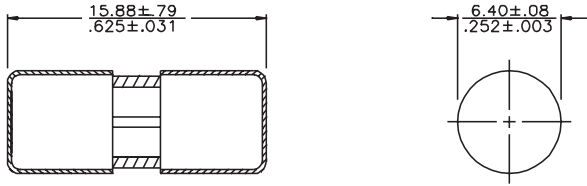

Time-Current Characteristic Curves—Average Melt

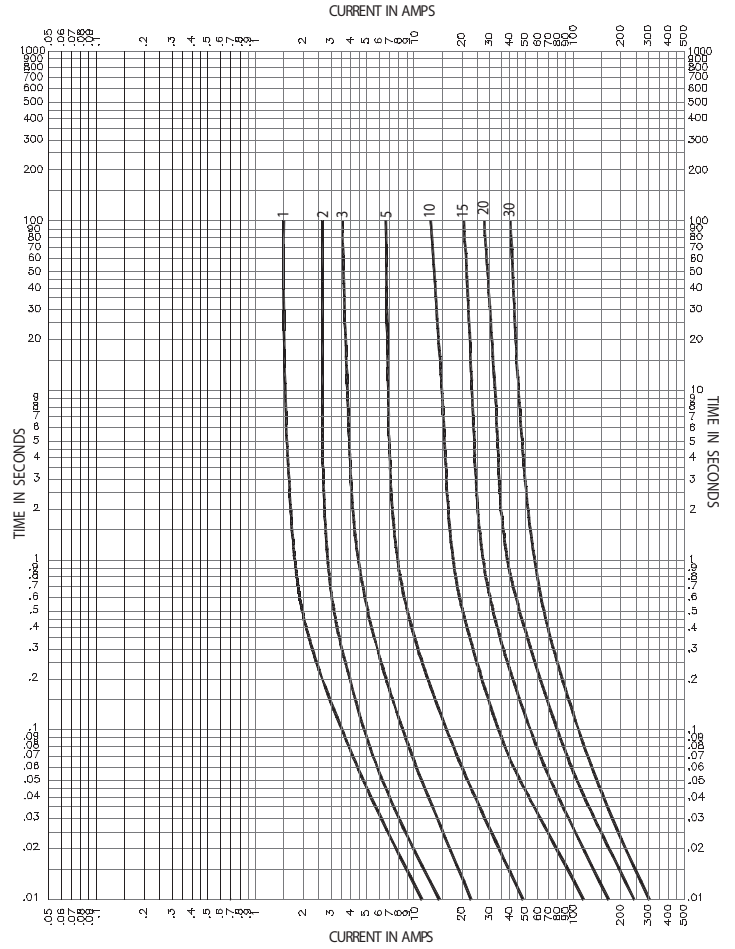

| Packaging Code |   |
|----------------|---|
| Packaging Code | Description                               |
| BK             | 100 fuses packed into a cardboard carton  |
| BK8            | 8000 fuses packed into a cardboard carton |

| Option Code |  |
|-------------|--|
| Option Code | Description  |
| B           | Board Washable - Hermetically sealed to withstand aqueous cleaning |