



Jeep® Flat Style Fender Flares Set of 4

Set Part #10928-07
Rev-0 12/18/2019

STEP 1 – PRIOR TO INSTALLATION

- A) Bushwacker®** only approves installing the flares according to these written instructions with the hardware provided. **WARNING:** Failure to install according to these instructions will invalidate the warranty. This includes, but is not limited to using alternative installation methods, hardware, or materials. **DO NOT USE:** Loctite, SuperGlue, or similar products on the hardware or the flares.
- B) Fit:** Verify the fit of the flares to vehicle. (Some filing, sanding, or cutting may be necessary to ensure proper fit).
- C) Painting:** (Optional) if paint is desired it must be done prior to installing flares on vehicle. Clean outer surface with a good grade degreaser. **DO NOT USE LACQUER THINNER OR ENAMEL REDUCER AS A DEGREASER.** Wipe outer surface thoroughly with a tack rag prior to paint. Application of plastic adhesion promoter for ABS plastic as per your paint system manufacturer's recommendations is required. Paint flares using a high quality enamel, or polyurethane automotive paint. If painting edge trim (not recommended), use a flex additive.
- D) Performance:** Using larger Tires may increase the area required to turn the vehicle. Some Tire/Rim combinations may require lowering bump stops and or installing steering stops to prevent tire from contacting flare.
- E) Exhaust System:** Modifications may be necessary to maintain a minimum 4" clearance between flares and exhaust pipes. (Exhaust gases should not vent directly onto flares)
- F) Metal Protection:** All exposed fasteners and bare metal should be treated with rust resistant paint **BEFORE** installing flares. Spray inner fender wells with undercoating **AFTER** flare attachments have been completed.
- G) Decals:** Flares may interfere with existing decals on vehicle. If you wish, remove decals prior to installation of flares.
- H) Care & Cleaning:** Bushwacker fender flares are built to last; any detergent you use to wash your vehicle is sufficient to clean the flare. Do not use any harsh abrasive detergents.

TOOLS FOR EASY INSTALLATION:

- Utility Knife
- Pneumatic Hand Saw or Metal Hacksaw
- #2 Phillips Drive Bit
- Electric Drill
- 5/16" Drill Bit
- #2 Phillips Screwdriver
- Socket Wrench
- Socket Set
- 1/2" Wrench
- Needle Nose Pliers or Vise Grips
- Scratch Awl (optional)
- Soft Wiping Cloth/Shop Towels
- Safety Glasses
- Grease Pencil
- Punch



The material that your product is made from can be recycled. Please also consider recycling the packaging that your product came in.



PLEASE READ: Dirt and debris can become lodged between the fender flares and the vehicle's fenders, causing scratching and paint wear from vibration. Lund International is not responsible for any damage, and the installation of our fender flares is done with the buyer's understanding that this scratching and paint wear may occur.

Included in Hardware Kit:

- | | | | | | | | |
|---|---|--|--|--|--|---|--|
| 1. 
CL1-0022,
#10 "U" Clip,
36 pcs | 2. 
SW1-0057,
#14 x 3/4" Phillips
Truss Tap Screw,
1/4 x 20,
36 pcs | 3. 
133606A
Rivnut,
1/4 x 20,
44 pcs | 4. 
133606H
Rivnut Installation
Tool,
1 pcs | 5. 
133606B
Allen Bolt,
1/4-20x1
44 pcs | 6. 
WA1-0012,
.320 x 700 x .03
SS Washer,
44 pcs | 7. 
JB1-0001
Metal Brace
2 pcs | 8. 
SW1-0081
Carriage Bolt,
3/8" x 3/4"
4 pcs |
| 9. 
NU1-0027
Nylock Nut,
3/8-16,
4 pcs | 10. 
WA1-0027
Anti Rotating
Clipped Washer,
4 pcs | 11. 
RV1-P001,
1/4" Black Nylon
Retainer
11 pcs | 12. 
RV1-P006,
8 x 20mm Black
Nylon Retainer
13 pcs | 13. 
SW1-0082
Flange Screw,
5/16-18,
2 pcs | 14. 
NU1-0028
Nylock Nut,
5/16-18,
2 pcs | 15. 
WA1-0028
Washer,
5/16,
2 pcs | 16. 
GP1-0025,
EX4008 Wiper
Style Edge Trim,
276 inches |
| 17. 
ET1-0002,
Edge Trim Tool,
1 pc | 18. 
AD1-0008,
ALCOHOL PREP
PAD,
4 pcs | 19. 
EC1-0007
Female Wire
Connector,
10 pcs | 20. 
EC1-0008
Male Wire
Connector,
10 pcs | 21. 
LT1-0005
Light Kit,
2 pcs | 22. 
Protective Case,
Front Wiring
Harness
1 pc (LH ONLY) | 23. 
Protective Case,
Rear Wiring
Harness, Lower
2 pcs (LH/RH) | 24. 
Protective Case,
Rear Wiring
Harness, Upper
2 pcs(LH/RH) |

STEP 1 - EDGE TRIM INSTALLATION

EDGE TRIM IS ONLY INSTALLED ON THE FLARES, NOT THE INNER COVER PIECES.

A) Clean the edge of each fender flare using the enclosed alcohol prep pads.

B) Peel two to three inches of red vinyl backing away from edge trim tape. Applying the adhesive side of the edge trim to the inner side of the flare, affix the edge trim to the top edge of the flare (the portion that comes in contact with the vehicle).



Front Flare Installation Procedures (Driver's Side):

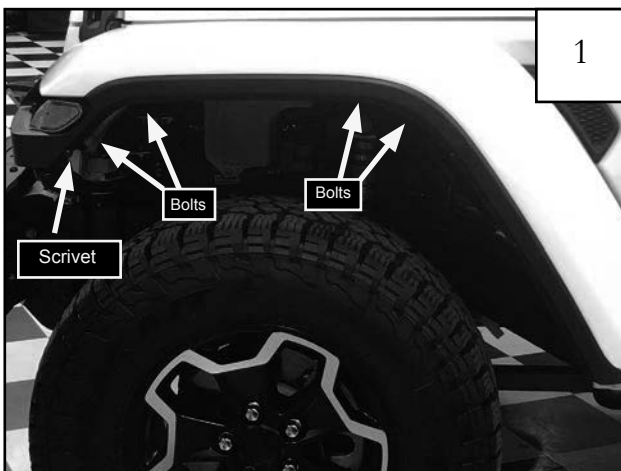

Remove and retain bolts and scrivet fastener from inside of factory fender.



Starting at front of flare, pull *firmly* to release flare and splash shield from fender, working your way to the back. You will hear popping noises as clips release. It is okay. If clips break, they will be discarded. Clip off both socket connectors at the existing light.

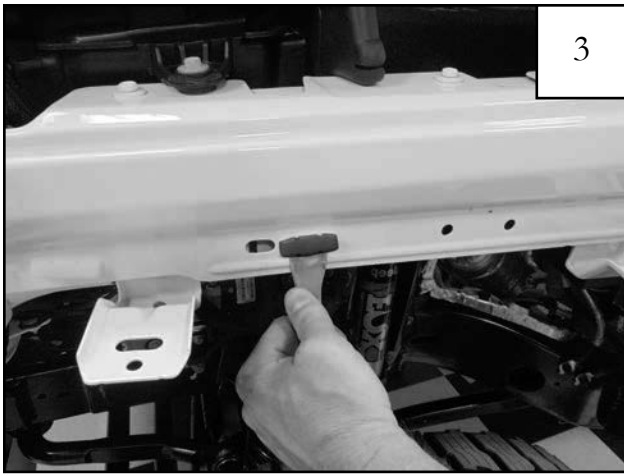

Using a pry tool or flat head screwdriver, remove any plastic clips still in fender.



Use a punch or drill with 5/16" bit to drill through eight plastic rivets along edge of flare/splash shield. Discard flare. Save splash shield for reinstallation.

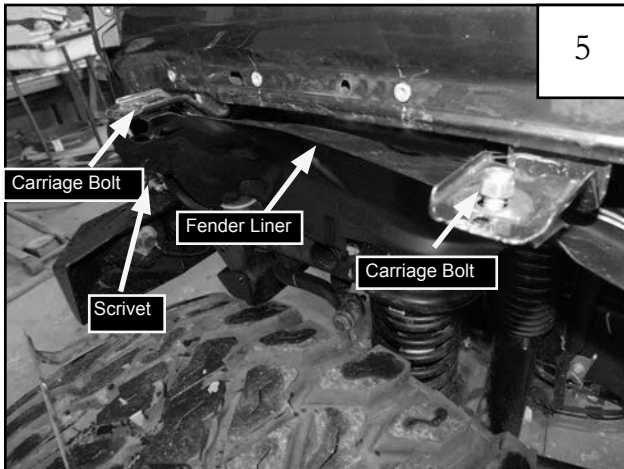

Reinstall the splash shield using the previously removed factory scrivet and (2) supplied carriage bolts, in preparation for marking before cutting.



Using sheet metal as a guide, mark the rear portion of the splash shield with a grease pencil in preparation for trimming. The splash shield should be flush with the sheet metal after being trimmed. *NOTE: If trimmed too little, flare won't fit; if trimmed too much, shield won't stay behind flare. Rear portion beneath vent may be left long.*



Remove splash shield. Save factory hardware for reinstallation. Using a metal hacksaw, pneumatic hand saw, or other suitable cutting device, trim the splash shield along the marked lines.



Splash shield properly trimmed.

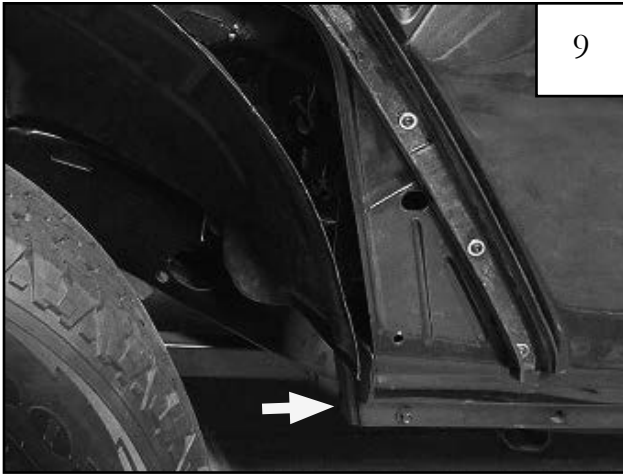

NOTE: It may be necessary to trim the factory installed lower plastic cover piece indicated above to obtain correct fit.



Thoroughly clean the exposed metal fender with a damp cloth and dry.



Place a rivnut on the provided rivnut tool.



Insert rivnut in fender hole.



Using a wrench to hold rivnut tool in place, install rivnut in place on fender using an 11/16" socket. The rivnut will expand to secure itself in place. NOTE: Use of impact driver recommended for rivnut installation.



Remove rivnut tool. Repeat for remaining holes.

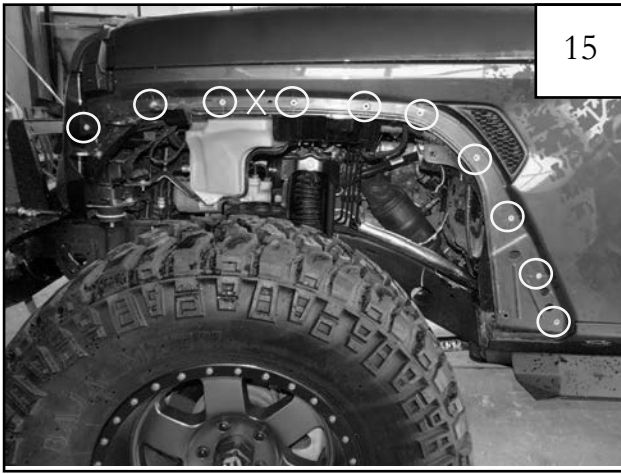

Ten rivnuts installed. NOTE: The "X" above indicates a hole that is not used.

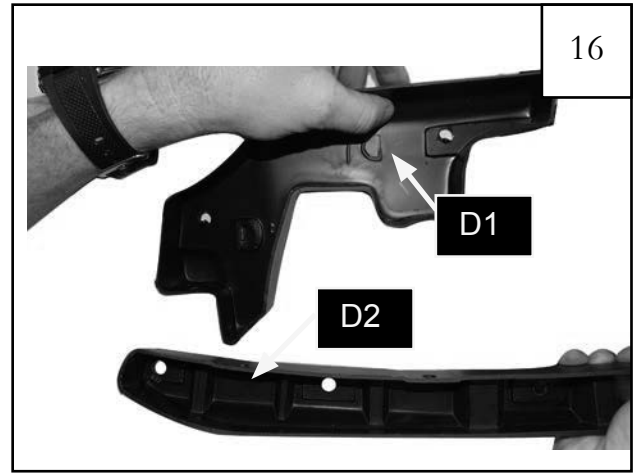

Locate the flat flare front inner pieces. The driver side front inner pieces are marked D1 & D2. The passenger side front inner pieces are marked P1 & P2.



Install a U-clip at each clip location on the inner pieces, centering them on the predrilled holes with threaded portion on inside (9 locations). NOTE: Clips may slide out of place. Try pinching the metal tightly onto the inner piece with pliers.



Position support brace along the top edge of fender opening, aligning with the existing factory supports.



Install a U-clip on both flanges of the support bracket.



Attach both flanges of the support bracket to the existing factory fender support using a carriage bolt, anti-rotating clipped washer and nylock nut.



Support bracket flange properly attached to existing factory support in (2) locations.

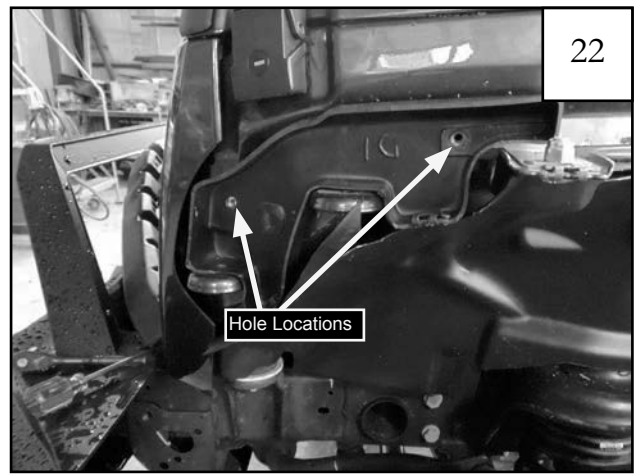

Secure inner piece D1 (and P1 for passenger side installation) to the sheet metal using the following **3 Steps: Step 1** Position inner piece on fender by aligning holes with previously installed rivnuts.

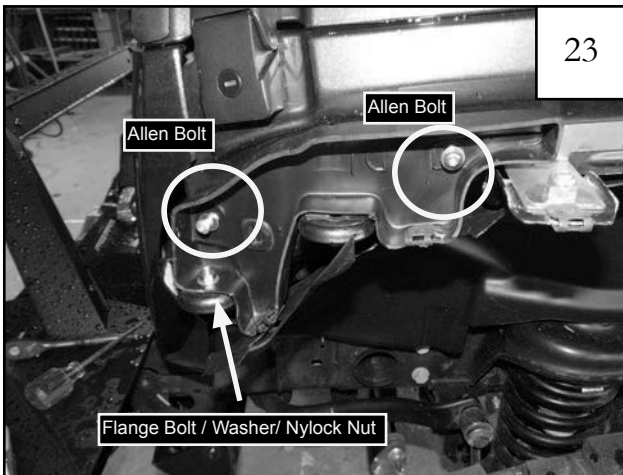

Step 2 Slide a washer onto allen bolt. Insert a bolt/washer assembly through inner piece and fender and secure to rivnut. *Start the bolts but do not tighten.* Next, install a 1/4-20 flange bolt and washer with nyloc nut as indicated above. Tighten this bolt fully.



Step 3 Secure inner piece D2 with allen bolts and washers using the same procedure described in Step 22 and 23.



Ensure that inner pieces D1 and D2 are aligned together properly, and tighten all allen head bolts.

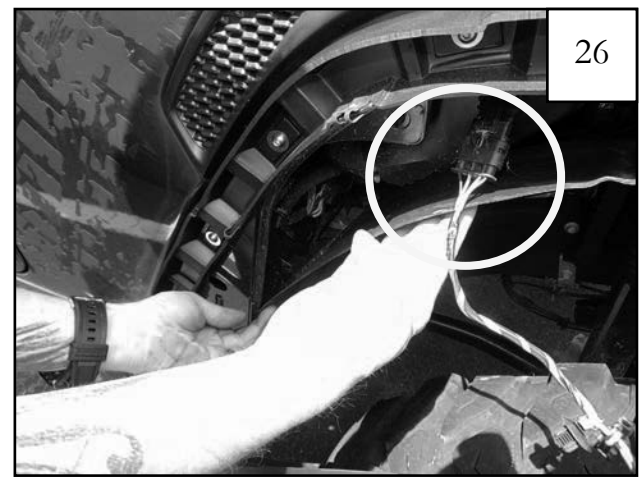

Position inner splash shield for reinstallation, making sure that side marker light wires are outside of splash shield.

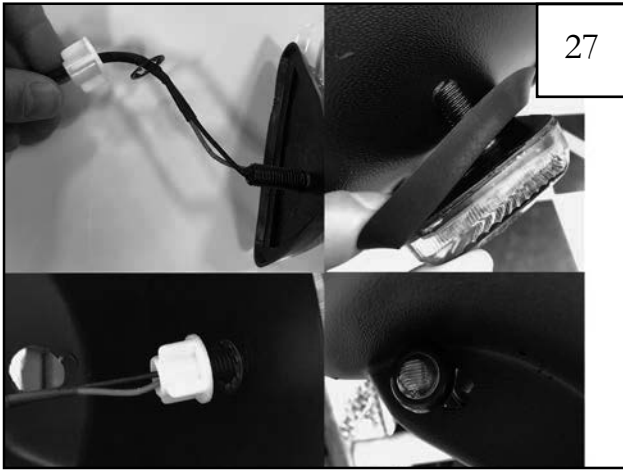

27

Front Turn Signal Install: remove plastic nut and lock washer from light. Slide stem through hole in front of fender flare. Add lock washer and nut back to the light behind the fender flare and tighten down. Side Marker Light: Push round button light through the hole under the lip of the fender flare.



29

Place the outer flare over the inner pieces and push until snug against the sheet metal. Make sure that the side marker light wires are inside the flare. Make sure splash shield is tucked behind flare.

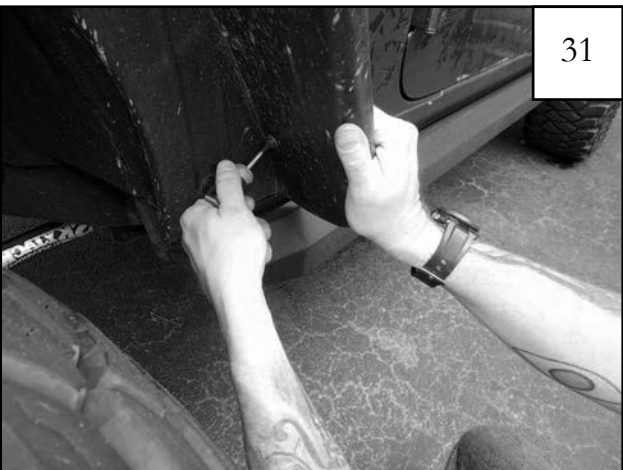

31

Hold flare in place on fender and start a Phillips truss screw into each hole location and through speed clip on inner structure and metal frame angle support bracket (9 locations). Do not tighten.

<ol style="list-style-type: none"> 1. Install 10 Male connectors onto leads on all lights. 2. Install lights into fenders. 3. Install 10 Female connectors onto previously clipped wires in the wiring harness. 4. Front light: Black to Black White to White/Brown Red to White/Green 5. Side Marker Light: Black to Black Red to White/Orange 6. Route wiring safely through fender while proceeding with installation. 	<p>28</p>
---	-----------

Wiring the lights.



30

Use a scratch awl (or another pointed tool) to line up the speed clips with the outer flare holes (9 locations). If needed, use a flashlight to better locate the speed clips.

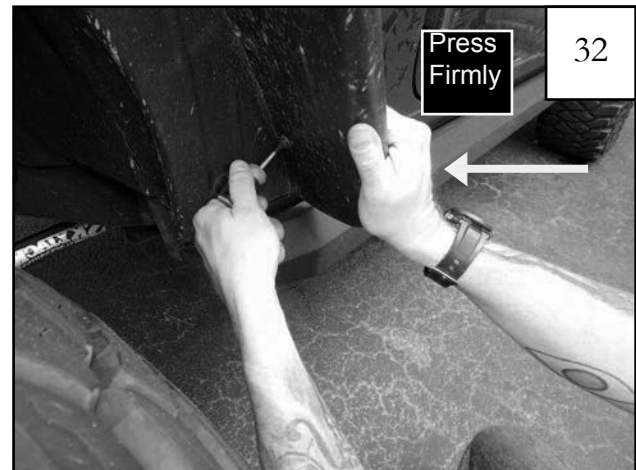

32

After all screws have been started, tighten the screws by *firmly* pressing the flare toward the vehicle *while* tightening.



33

Use the hooked end of the edge trim tool to check for proper placement of rubber gasket. Do this by sliding it along the top of the edge trim and visually verify that the wiper is positioned correctly.

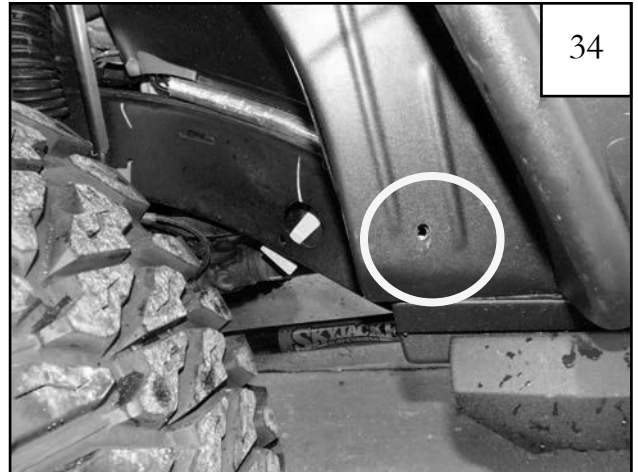

34

Install a RV1-P006 8-20mm nylon retainer in lower inside corner of fender flare.



35

Nylon retainer installed.



36

Completed front driver's side flare installation.

Rear Flare Installation Procedures (Driver's Side):

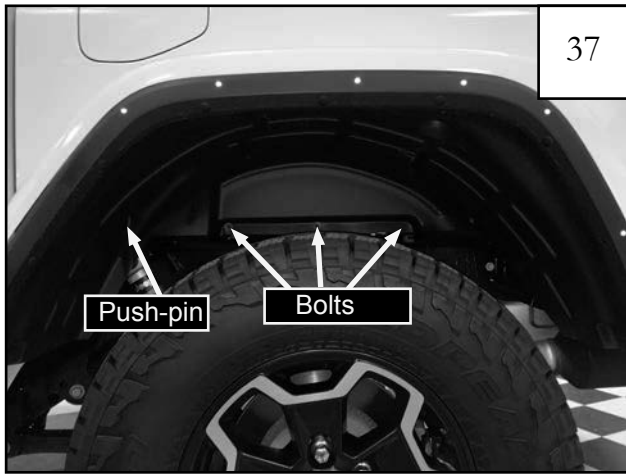

Using a pry tool, pliers, or flat head screwdriver, remove (3) 8mm bolts and (1) push-pin from inside of splash shield.

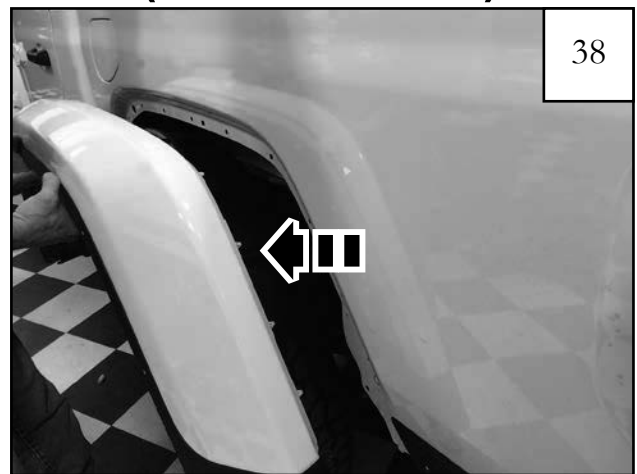

Starting at front of flare, pull *firmly* to release flare and splash shield from fender, working your way to the back. You will hear popping noises as clips release. It is okay if clips break, they will be discarded. Discard fender and fender liner.

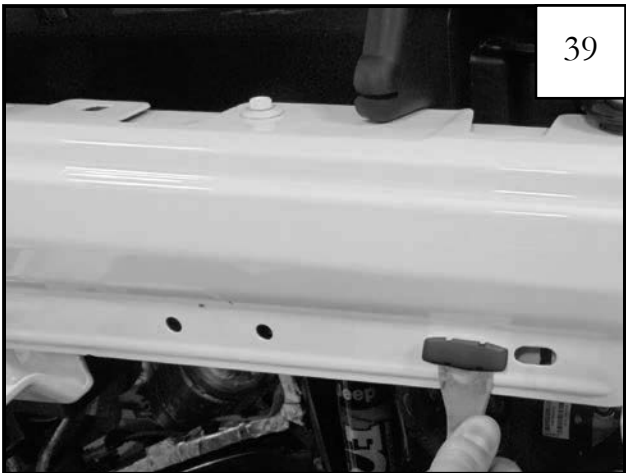

Using a pry tool or flat head screwdriver, remove any plastic clips still in fender.



Thoroughly clean the exposed metal fender with a damp cloth then dry.

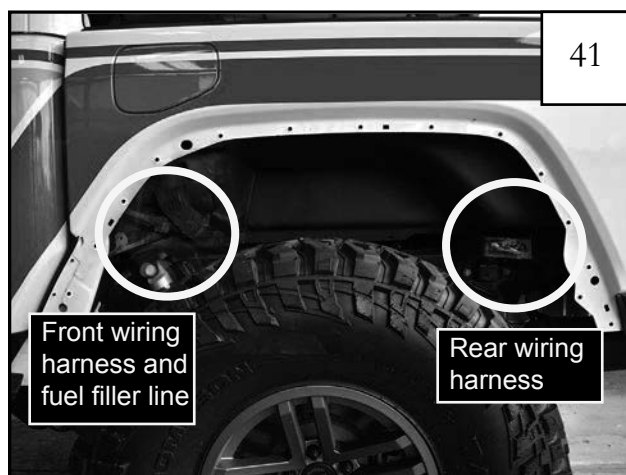

Locate the (2) exposed wiring harness areas inside the rear wheel well. NOTE: The passenger side only has the rear harness.

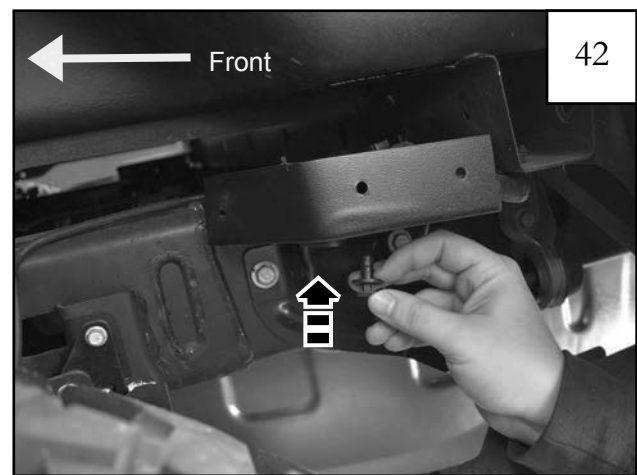

Position the Lower Protective Case under the rear wiring harness. NOTE: There is (1) hole facing front, and (2) facing outward. Install the Lower Protective Case in place using (1) RV1-P006 fastener.



Remove the red tape liner from the Upper Protective Case for the rear wiring harness. NOTE: the tape should be facing the rear of the vehicle.

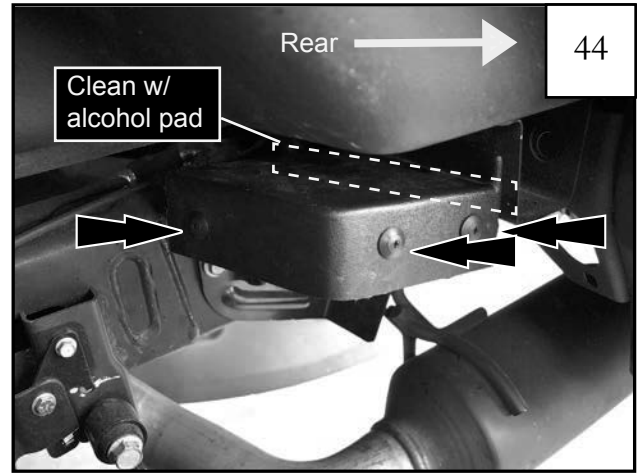

Clean the surface where tape will adhere with an alcohol pad. Position the Upper Protective Case in place over the Lower portion, with the tape facing the rear of vehicle. Press the exposed tape liner against the rear surface to tack it in place. Install (3) RV1-P001 fasteners to secure in place.

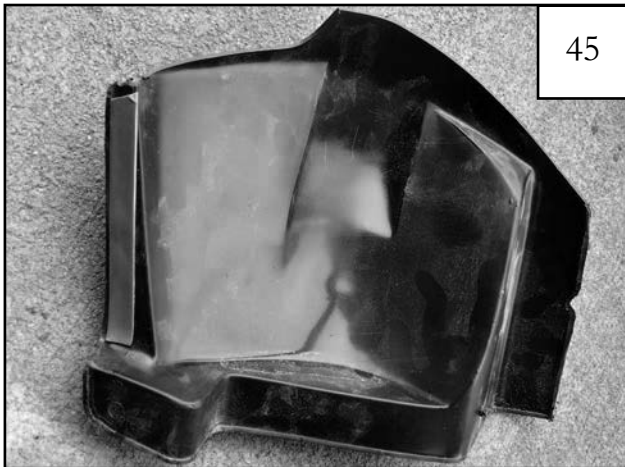

Remove the red tape liner from the Protective Case for the front wiring harness and fuel filler lines.

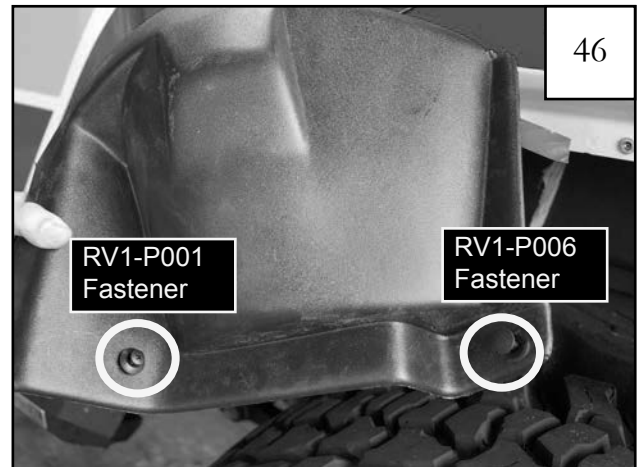

Clean the surface where tape will adhere with an alcohol pad. Press the exposed tape liner against the rear surface to tack it in place. Place (1) RV1-P001 fastener and (1) RV1-P006 fastener in place on the Protective case as shown.

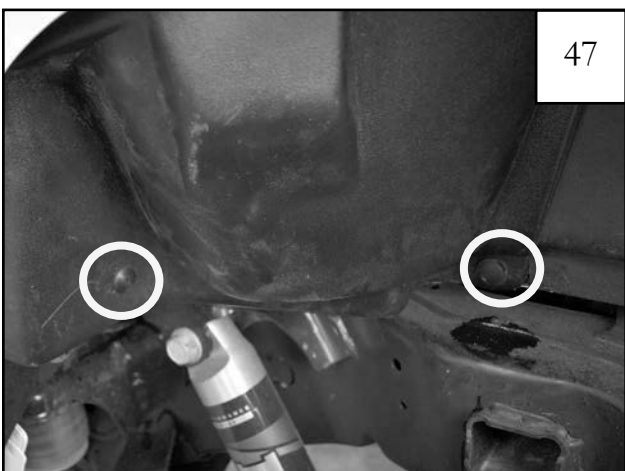

Position the Protective Case over the front wiring harness. Press the exposed tape liner against the side surface to tack it in place. Install the Protective Case in place using the fasteners.



Locate the flat flare rear inner pieces. The driver side rear inner pieces are marked LR1, LR2 & LR3.

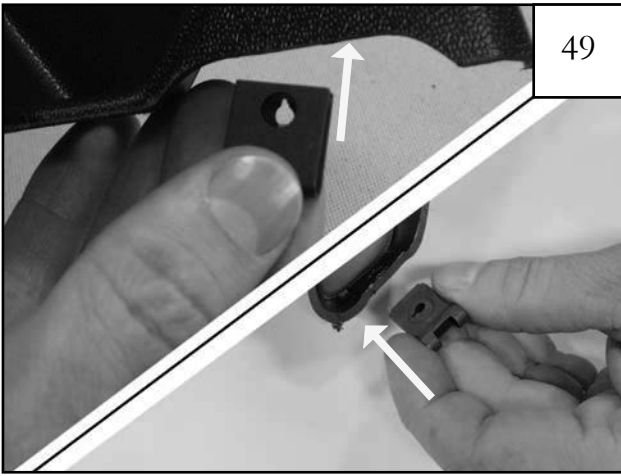

Install a CL1-0022 U-clip at each clip location on the inner pieces, centering them on the predrilled holes with threaded portion on inside. (9 locations) *NOTE: Clips may slide out of place. Try pinching the metal tightly onto the inner piece with pliers.*



Place a rivnut on the provided rivnut tool.



Insert rivnut in fender hole.



Using a wrench to hold rivnut tool in place, install rivnut in place on fender using an 11/16" socket. The rivnut will expand to secure itself in place. *NOTE: Use of impact driver recommended for rivnut installation.*



Remove rivnut tool. Repeat for remaining holes.



Install (12) rivnuts in rear fender area using the same procedure as Steps 13 thru 17. Test fit inner pieces LR3, LR2, and LR1 (Front to back). *NOTE: The "X" above indicates a hole that is not used.*



Slide a washer onto allen bolt. Insert a bolt/washer assembly through inner pieces and fender and secure to rivnut. *Start the bolts but do not tighten.*

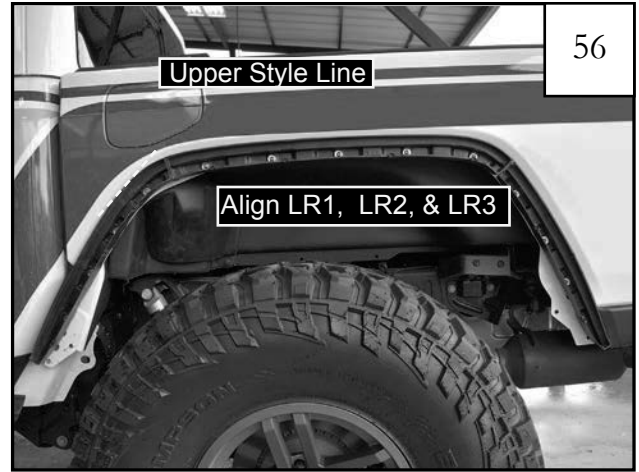

Ensure that inner pieces LR1, LR2, & LR3 are aligned together properly, and tighten all allen head bolts. **Inner piece should rest along upper style line of sheet metal radius and not below it.**

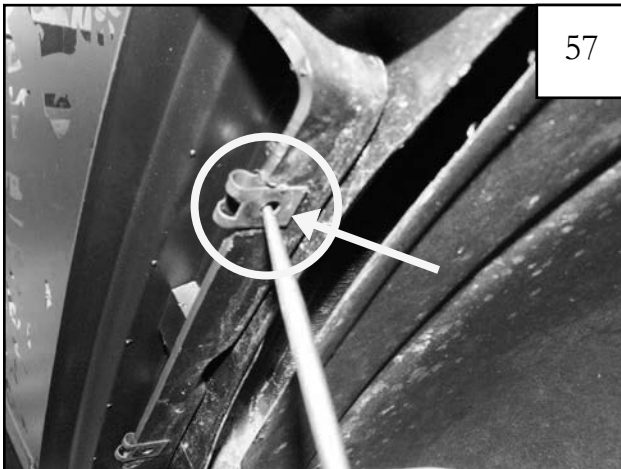

Before installing the outer flare, make sure that the CL1-0022 U-clips on the inner pieces are centered over the predrilled holes.



Place the outer flare over the inner pieces and push until snug against the vehicle surface.

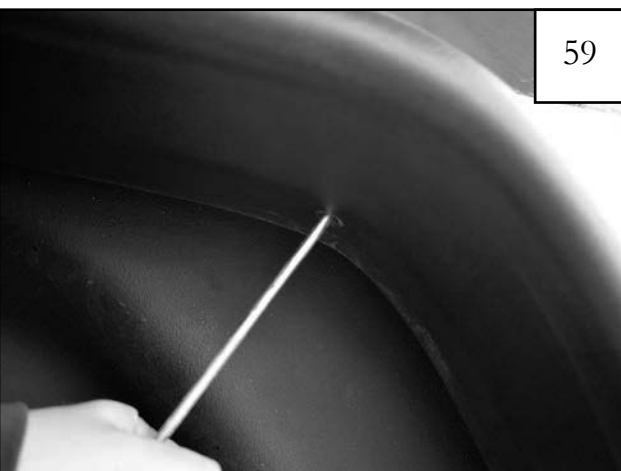

Use a scratch awl (or another pointed tool) to line up the U-clips with the outer flare holes (9 locations). If needed, use a flashlight to better locate the speed clips.

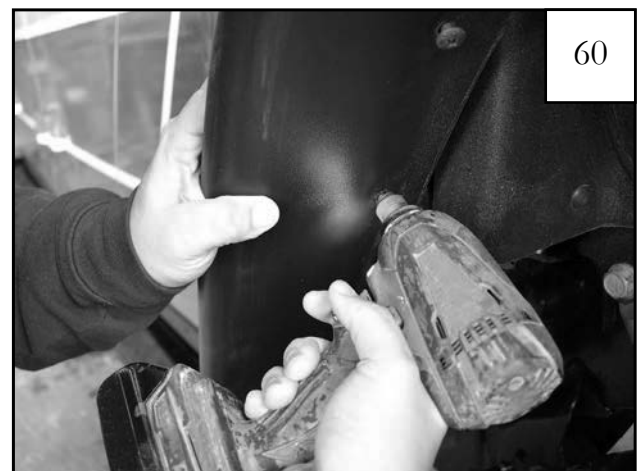

Hold flare in place on fender and **START** a SW1-0057 Phillips Truss Screw into each hole location and through the U-clip on inner structure (9 locations). **DO NOT TIGHTEN.**



AFTER ALL SCREWS HAVE BEEN STARTED, tighten the screws by *firmly* pressing the flare toward the vehicle *while* tightening.



Install (2) RV1-P006 nylon retainers.



Use the hooked end of the edge trim tool to check for proper placement of rubber gasket. Do this by sliding it along the top of the edge trim and visually verify that the wiper is positioned correctly.



Completed rear driver's side flare installation.