



# Components List:



Driver Side x1



Passenger Side x1



Driver Side x1



Passenger Side x1

## EDGE TRIM INSTALLATION

A. Peel two to three inches of red vinyl backing away from Edge Trim (GP1-0025) tape. Applying the adhesive side of the edge trim to the inner side of the flare, affix the edge trim to the top edge of the flare (the portion that comes in contact with the vehicle).

B. Press edge trim into place along the top edge of the flare in one-foot increments, pulling red vinyl backing free as you continue to work your way around the top edge of the flare.



## Pocket Hardware Installation:

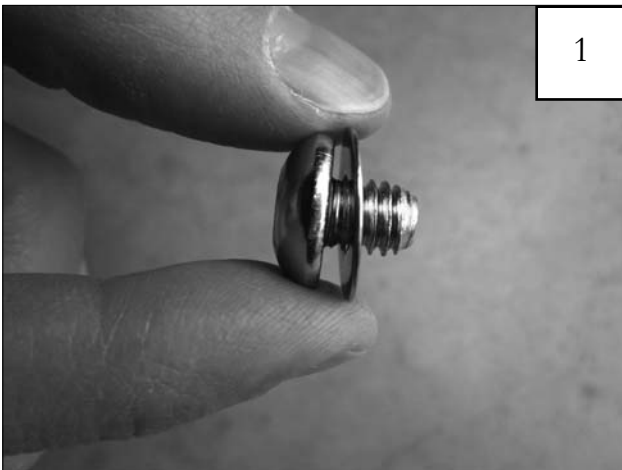

Put a Washer (WA1-0012) on each Bolt (SW1-0067).



Put each Bolt/Washer combination through a pocket hole in the flare, Bolt head and Washer on the outside.

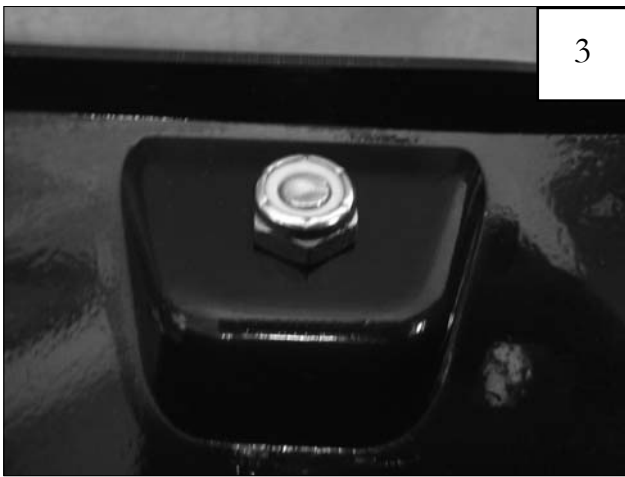

Place a Nut (NU1-0019) over the end of each Bolt and tighten, using a 1/2" wrench for the Nut and the supplied Torx Bit (SW1-0052) for the Bolt. Repeat for remaining pockets.

## Rear Main Flare Installation Procedures:

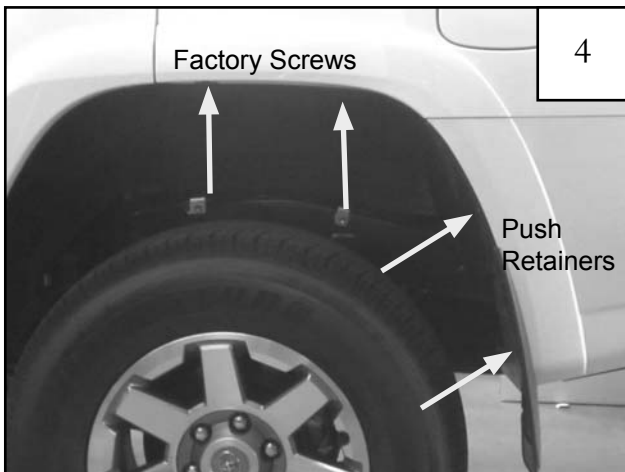

Remove two factory screws and two factory push retainers from the Rear Main Flare ONLY. Retain screws for reinstallation.



Remove factory Rear Main Flare by pulling the part away from the clips on both ends of the part, then grasp in the wheel well and pull off.

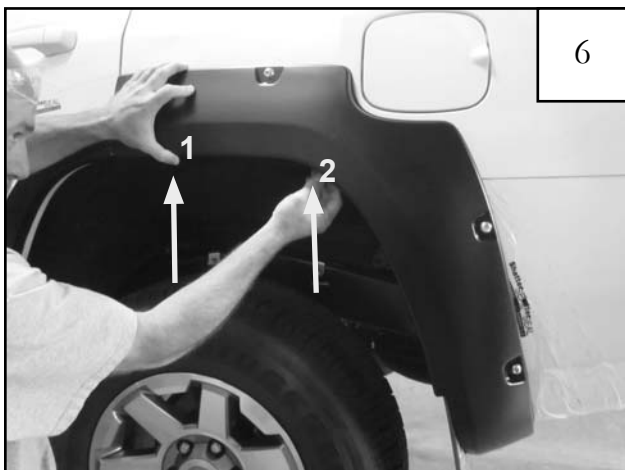

Position Flare and hand start two factory screws in to the top two holes in flare. Ensure flare is positioned properly, then apply inward pressure on the flare at each hole location while tightening each screw. *NOTE: Tighten screw at the front of the flare first.*

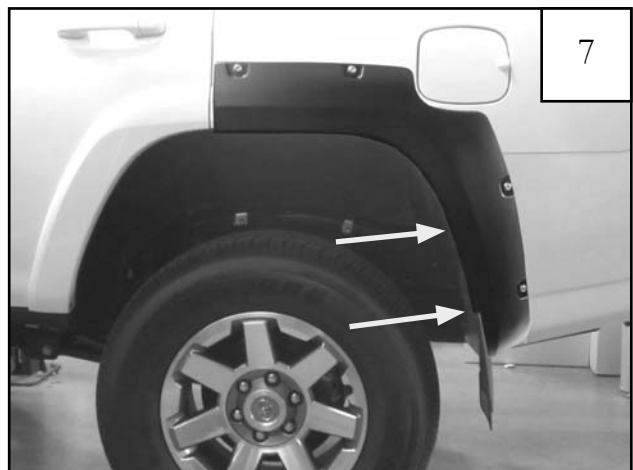

Install supplied push retainers (RV1-P009) in the two lower holes in the flare.



Drill a 5/16" hole in the lower rear hole location.  
*NOTE: Press inward on the flare when drilling to ensure proper hole location.*

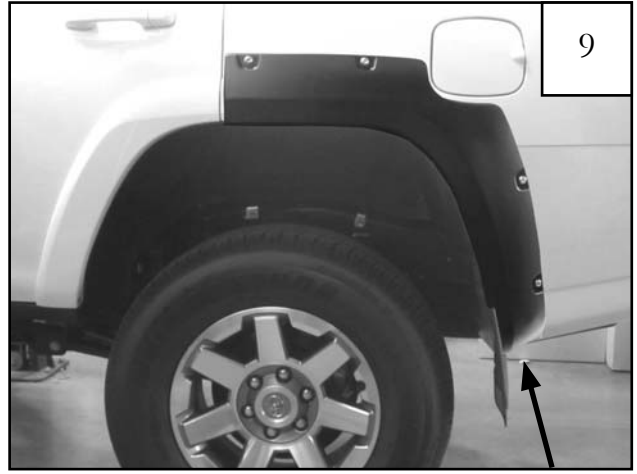

Install supplied push retainer (RV1-P009) into the lower rear hole.

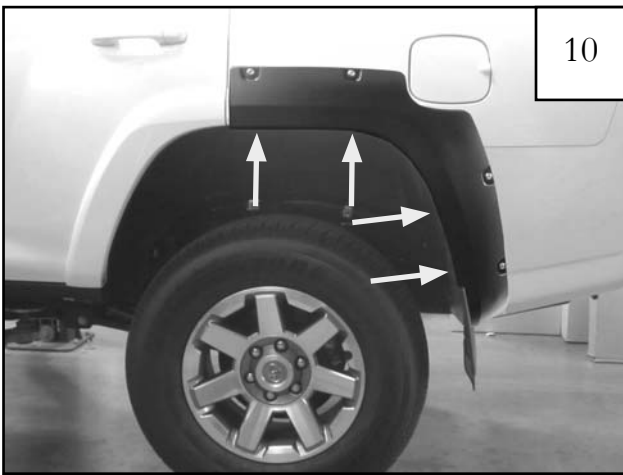

Ensure flare is positioned properly, then apply inward pressure on the flare at each hole location while tightening each screw.

## Rear Door Piece Installation Procedures:



**NOTE: Clean factory door piece installation surfaces with a soft cloth and mixture of 50/50 water and isopropyl alcohol.**

Before installing door piece over the factory flare, hold flare in position on the door and dry fit. Using a Grease Pencil, draw a line along the outer edge of the door piece onto the door to make it easier to line up when installing.



Remove tape liner from all tape on back of door piece.



**NOTE: You cannot remove the door piece once it has stuck to the vehicle.**

Use the line drawn in step 11 as a guide. Align door piece with edge of door and carefully press into position on the door over the factory flare.



Apply pressure along the entire surface of the door piece to ensure all tape is adhered to the vehicle door. Apply 30 PSI to the taped areas for proper bond. Tape reaches maximum adhesive bond after 24 hours of contact.



Align door piece with rear flare before drilling and installing screws.



Hold top of flare and drill pilot holes in door piece with 1/8" bit.



Install supplied Truss Head Screws (SW1-0044) into holes. Screws are attached to factory flare. **DO NOT OVER TIGHTEN SCREWS.**



Installation Complete.

## Edge Trim Tool Procedures:

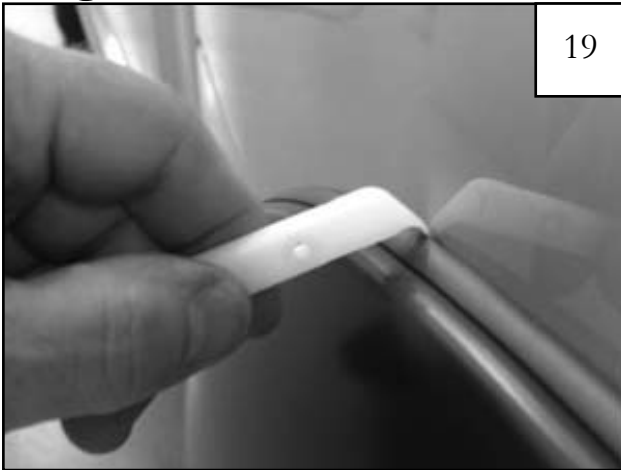

Using supplied Edge Trim Tool (ET1-0002), seat edge trim against vehicle by hooking curved end under edge trim at one end of flare. Next, slide around outer edge of flare to the other end.



Using flat end of supplied Edge Trim Tool (ET1-0002), seat edge trim against flare by inserting straight end between edge trim and flare at one end. Next, slide around entire edge to the other end.