



INSTALLATION INSTRUCTIONS FOR
FORD
PERFORMANCE
MODULE

Engineered For Power

Information about your...



PERFORMANCE MODULE

The Jet Performance Module is designed to enhance the performance and driveability of your vehicle. By optimizing the air/fuel ratio, ignition advance and various other parameters, the Jet Module retunes your engine for maximum performance.

The use of premium fuel (91 octane or higher) is recommended for maximum results. Lower octane fuels may be used, but could result in lower performance gains. JET Performance strongly recommends the use of premium fuel when towing.

ECU Location Chart

1989-2003	Cougar, T-Bird	#1
1994-2004	Crown Victoria	#8
2003	Marauder	#13
1987-2004	Mustang	#1
1989-2004	Taurus / Sable	#7

#1= Behind the passenger kick panel.

#2= Under hood on drivers side

#3= Driver's side kick panel, behind emergency brake

#4= Under hood, near top of firewall, near passenger side

#5= Passenger side above kick panel

#6= Under dash on drivers side, inside plastic sleeve

#7= Back firewall, under cowl panel

#8= Behind panel below steering column

#9= Eng, compartment-pass side rear-under cowl panel

#10= Drivers side engine compartment near firewall

#11= Above passenger side kick panel

#12= Underneath the battery tray, remove battery tray to gain access to PCM connectors

#13=Under hood next to master cylinder

#14=Under hood passenger side

1. Remove negative battery cable.
2. Remove any covers (kick panels, etc.).
3. Remove the ECU mounting bracket screw and pull the ECU out of it's bracket.
4. On the rear of the ECU remove the warranty sticker or plastic cap to expose the connector.

IMPORTANT: It is necessary to clean the protective coating off of the circuit board connection on the factory computer. Using the supplied cleaning pad, gently rub back and forth over the circuit board to remove all of the coating (see pictures). You MUST clean both sides of the circuit board for the module to get a proper contact. Remove any flakes of coating left from cleaning.

If the vehicle does not start or any warning lamps stay on after installing the module, reclean the circuit board and remove any residual coating from inside the connector on the JET module.

5. Plug the JET Module onto the exposed connector (see pages 4-7 for pictured instructions.)

IMPORTANT: When installing the module onto the connector, care should be taken **NOT to **FORCE** the module inside the computer. Damage to your computer could result.**

6. To prevent the module from working loose - use the provided mounting strip and tape over the module to hold it on the ECU.
7. Reinstall the ECU, bracket and any panels back in their original location.
8. Reconnect the negative battery cable.
9. Start the vehicle - verify that the service engine light is **NOT** on and that the idle RPM is normal. If **NOT**, turn **OFF** the engine. Verify all the installation procedures.

Module A Photo Instructions

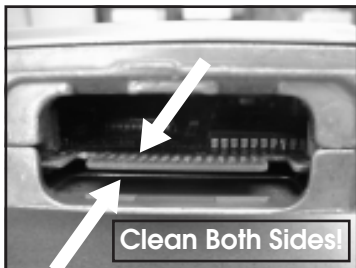

Step 1

Clean both sides of connector.



Step 2

Plug Jet Module onto connector.



Step 3

Make sure the module is seated all the way down.

Module A Photo Instructions (Continued)



Step 4

Secure the module with the supplied sticker.



Step 5

Finished!

Module B Photo Instructions

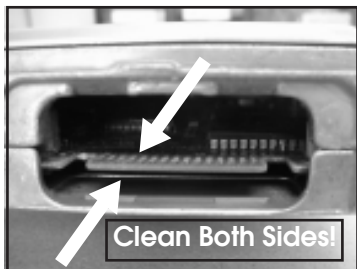

Step 1

Clean both sides of connector.



Step 2

Plug Jet Module onto connector.



Step 3

Make sure the module is seated all the way down.

Module B Photo Instructions (Continued)



Step 4

Secure the module with the supplied sticker.



Step 5

Finished!

TROUBLESHOOTING GUIDE...

Most computer or module problems are due to poor electrical contacts. If you have a problem, try the following:

1. Disconnect the negative battery cable, unplug the factory harness and the Jet Module.
2. Inspect both the factory parts and Jet Module for any bent or broken pins, dirt or contamination. Fix any minor problems you find.
3. Reinstall the module, harness, battery cable and recheck for the service engine light or any drivability problems.
4. If the problem still exists...

ASK ABOUT OTHER JET PRODUCTS FOR YOUR CAR OR TRUCK

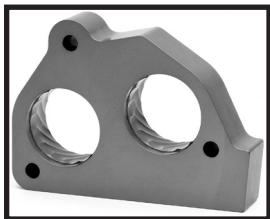

- T.B.I SPACERS

- POWR-FLO AIR INTAKE SYSTEMS



- PERFORMANCE PROGRAMMER

- MASS AIR SENSORS

- JET POWER SHIFT

