

BOYO[®] WiFi High Resolution Wireless Rear View Camera System

user's manual

VTC464RB (Black)

1. Parts list



A Monitor×1

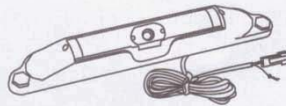

B Wireless transmission camera×1



C Monitor power extending line×2



D Cigarette lighter power line×1



E Screw×2

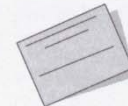

F User's manual×1

2. Testing

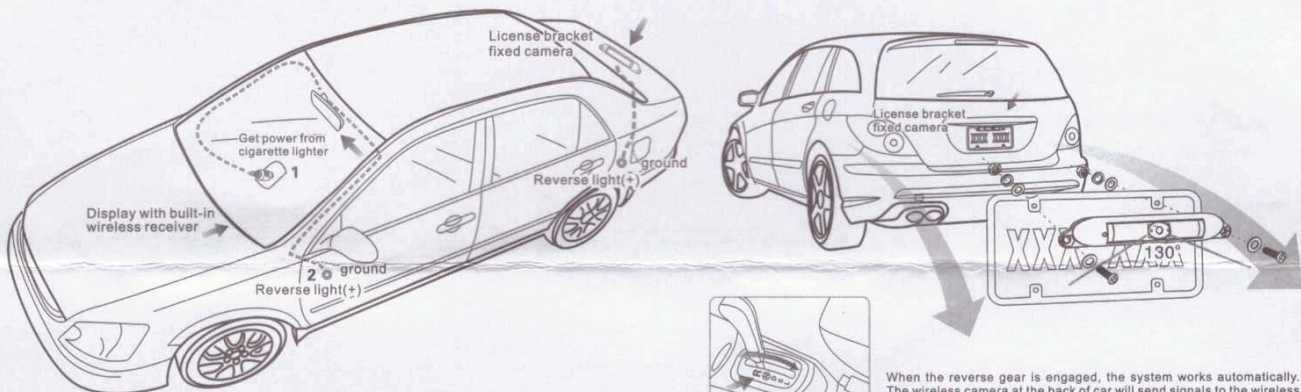

Testing:



When the reverse gear is engaged, the system works automatically. The wireless camera at the back of car will send signals to the wireless monitor in front of car. Images at the back of car will be shown clearly. When there's no transmission signal, monitor will turn to sleep mode.

3. Preparations



① Turn the key to the on, the power of the car is on.

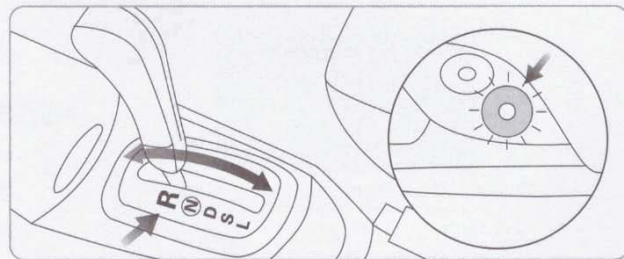

② Turn to the reverse gear, the reverse light is on

4. Camera installation

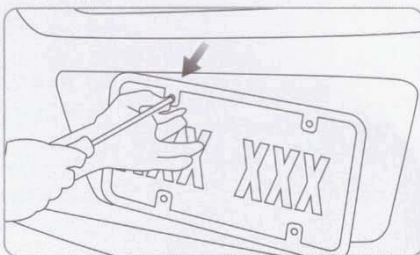

① Take down the license plate.

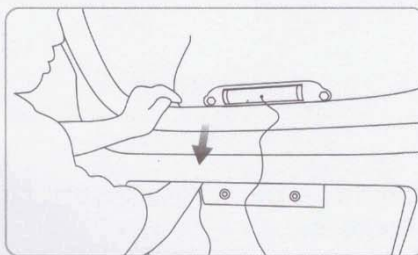

② Tow the camera power line into the car though the interstices of the car.

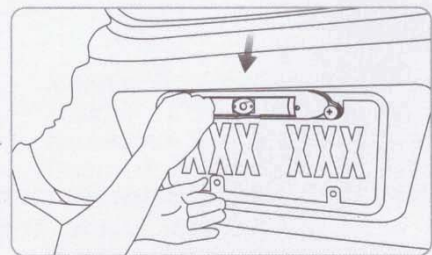

③ Install the camera onto the license plate, fix it with the spared screws.

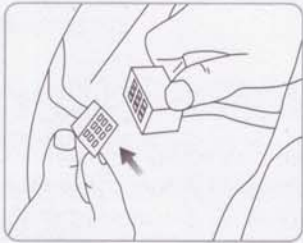

④ Find the power lines from the trunk at the back of car. Cut off the power of car.

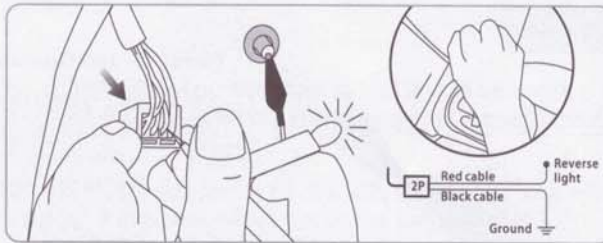

⑤ Black clamp connects to any iron part of car. Use the red pen to test every power line from the reverse light until the LED light is on. Then you can ensure that this is the power line.

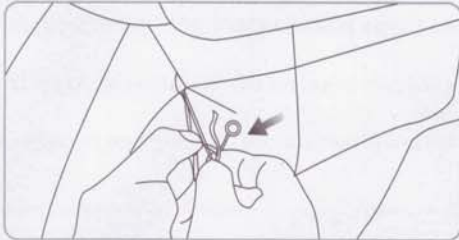

⑥ Connect the camera power line to the reverse light power line, anode to anode, cathode to cathode, then fix the cables with the rubberized fabric.

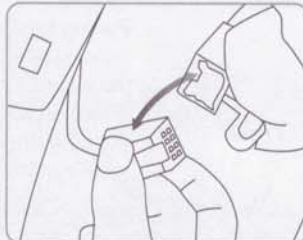

⑦ Connect the power lines as before.

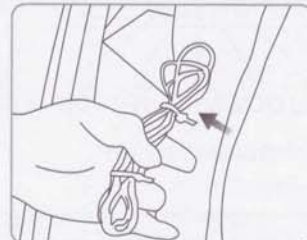

⑧ Enlase and hind other lines properly.

5. Two methods of monitor installation

1. Installation with cigarette lighter

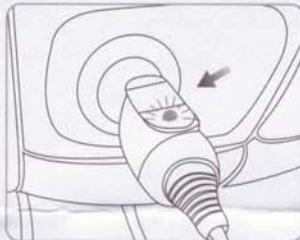

① Insert the cigarette lighter power line into the cigarette lighter in the car. When the light of the cigarette lighter is on, the power is on.

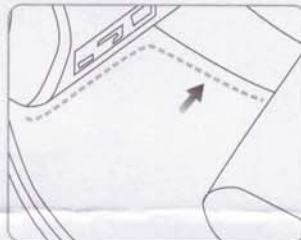

② Tow the cigarette lighter power line to the dashboard through the interstices of the car.

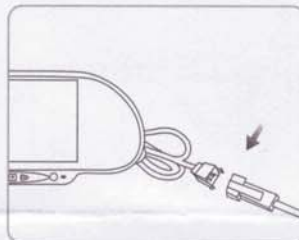

③ Connect the cigarette lighter power line to the 6" monitor

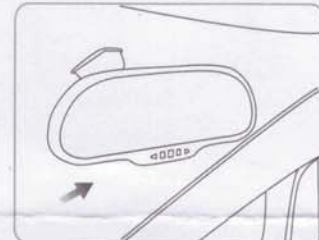

④ Fix the 6" monitor with clip onto the original mirror where is suitable.

2. Installation of power from the front reverse light

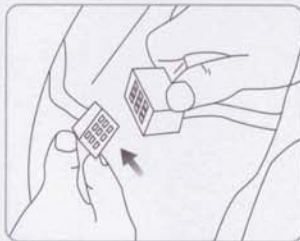

① Find the power lines from the driving room, cut off the power of car.

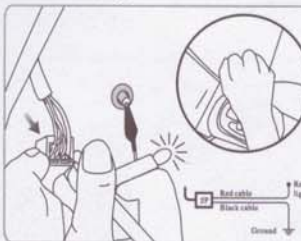

② Black clamp connects to any iron part of car. Use the red pen to test every power line from the reverse light until the LED light is on. Then you can ensure that this is the power line.



③ Connect the monitor power extending line to the reverse light power line, anode to anode, cathode to cathode, then fix the cables with the rubberized fabric.

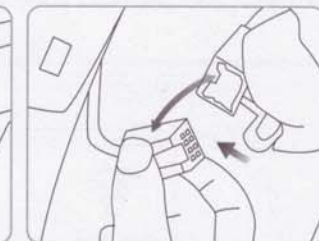

④ Connect the power lines as before.

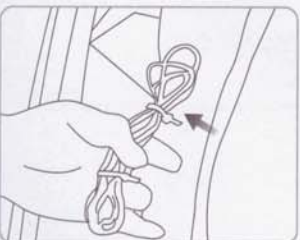

⑤ Enlase and hind other lines properly.

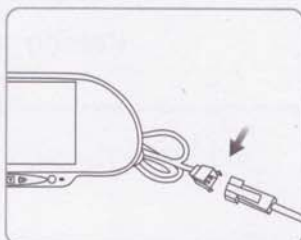

⑥ Connect the monitor power extending line to the 6" monitor

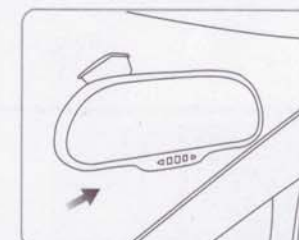

⑦ Fix the 6" monitor with clip onto the original mirror where is suitable.

FCC Statement

1. This device complies with Part 15 of the FCC Rules.

Operation is subject to the following two conditions:

- (1) This device may not cause harmful interference, and
- (2) This device must accept any interference received, including interference that may cause undesired operation.

2. Changes or modifications not expressly approved by the party responsible for compliance could void the user's authority to operate the equipment.

Operation Guide:

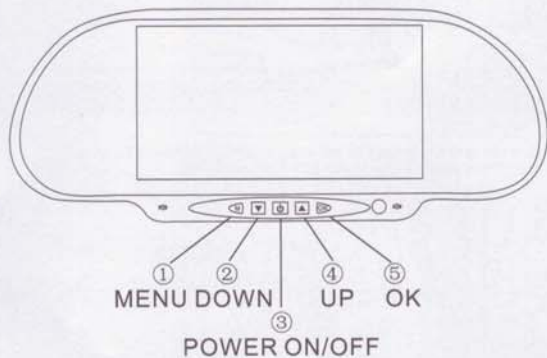

Function and Operation:

- M**: Menu: select the Brightness/Color/Default, press the "M" button 2-3S exit to Menu.
- ▼**: a. In the menu, up and down to select the Brightness/ Color/ Default
b. Not in the menu state, switching image to reverse and non-reverse view.
- ⏻**: a. Power on/ off.
b. Pairing: All the products paired in advance. If you have to replace the camera to another BOYO WiFi Bartype Camera, press the Paring button and the monitor will pair with the new camera automatically.
- ▲**: In the menu, up and down to select the Brightness/ Color/ Default
- OK**: a. Enter and confirm
b. Parking line: Not in the menu state, parking line or without parking line.

● Pairing between the camera and monitor ●

Automatic pairing function: All the products are paired before selling,
The following procedure only be used if you have to replace the camera to another BOYO WiFi Bartype Camera for service.

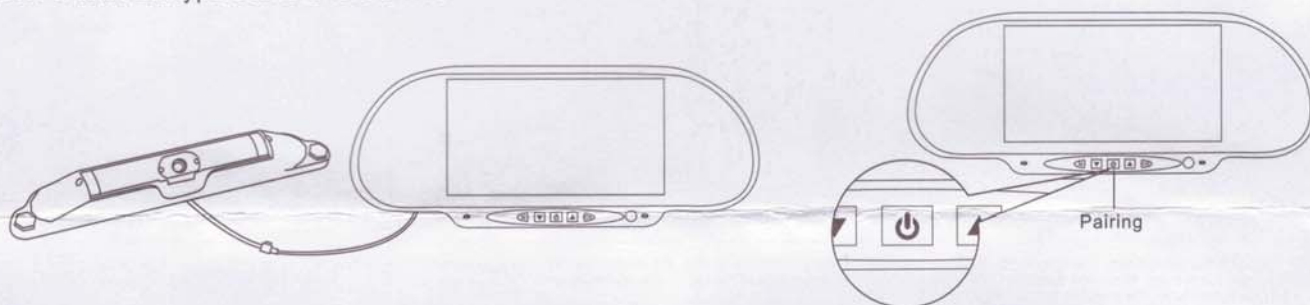

Camera power line with the monitor connection

Press the button "Pairing" to pair, as shown on above picture

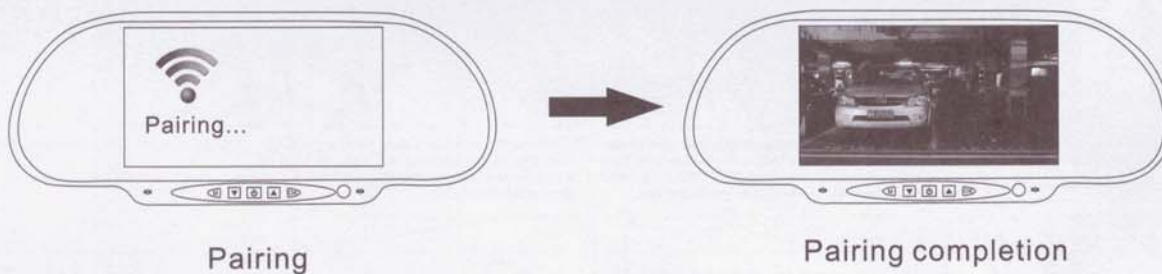

Pairing

Pairing completion

Specifications:

Model:

Transmission method: WiFi Digital Signal
Transmission distance: 65ft
Working temperature: -4°F ~ +140°F
Store temperature: -22°F ~ +158°F
Working humidity: 85%RH

Camera:

Image Sensor: CMOS
Resolution: 720*480
Viewing angle: 120°~150°
Illumination: 0.01Lux
Transmission power: 80mW
Voltage: 12V
Waterproof level: IP67

Monitor:

Display: 6" TFT Monitor
Resolution: 800*480
Contrast: adjustable
Brightness: adjustable
Voltage: 12V
Working temperature: -4°F ~ +140°F

Troubleshooting

As Wifi have 11 signaling channels, it will affect the signal receiving and lead to lost link in seconds if there is much Wifi device in the same signaling channel. Once such situation occurred, you can select the other Wifi signaling channel by manual operation. Then signal can be more stable.

This product had set 5 signaling channels for choice, including channel 01, 04, 07, 09 and 11. The option can be selected circularly by pressing UP key (pressing last for 2 seconds when out of the menu status)

When out of the menu status, please press the UP key till LOST LINK show up. Then please release the key while the signaling channel number shows on the monitor. If the signal is still unsteady, please re-operate the above instruction till the signal become stable.

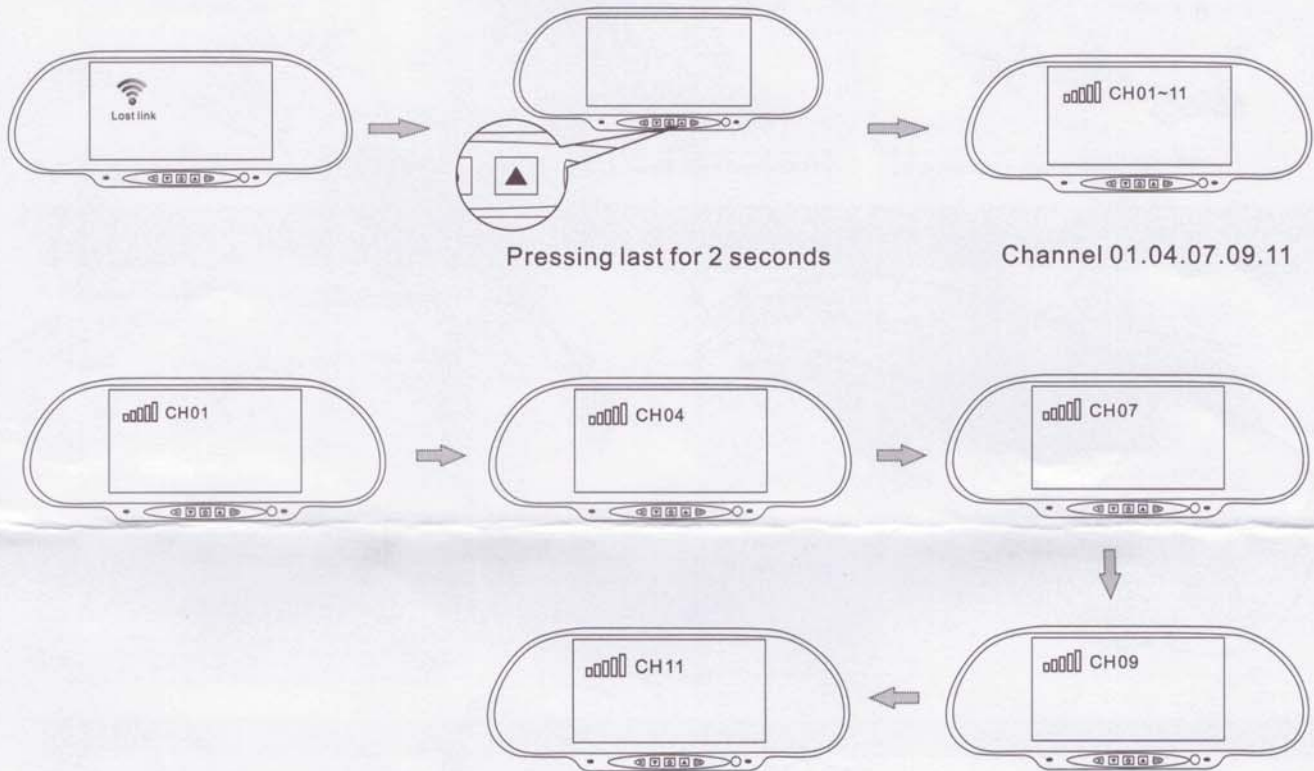

Notice:VTC464RB are Recommended ideal wireless solution for SUV,Sedans,Family Vans etc, but NOT for Trucks and Trailers.