

## Endgate Handle with Codeable Lock

### Removal of Existing Endgate Handle without Lock

1. Remove pickup box endgate latch handle bezel bolt as shown in Figure 1, item #1.
2. Release the 3 retainer clips securing the bezel to the endgate outer panel as shown in Figure 1, item #2. Lift the endgate latch handle in order to aid in the removal of the latch handle bezel.
3. Remove remaining pickup box endgate latch handle bolts (Qty 2) as shown in Figure 2, item #1.
4. Pull pickup box endgate latch handle free as shown in Figure 2, item #2. Release the rods from the latch handle.

### Installation of New Endgate Handle with Lock

1. Align latch handle to endgate using the 3 holes in the part. Install 2 endgate latch handle bolts. Do not tighten.
2. Re-install rods to handle. Verify lock cylinder is properly installed to latch handle assembly.
3. Install endgate latch handle bezel by snapping the 3 clips into place and securing with 1 bezel bolt. Do not tighten.
4. Tighten all three bolts to 25 N·m (18 lb ft).

**CAUTION:** Only insert key intended for everyday use.

1. Remove protective label.
2. Fully insert key intended for everyday use.
3. Rotate key clockwise until it stops while maintaining full key insertion.

Lock is now fully coded and ready for everyday use.

**FIGURE 1**

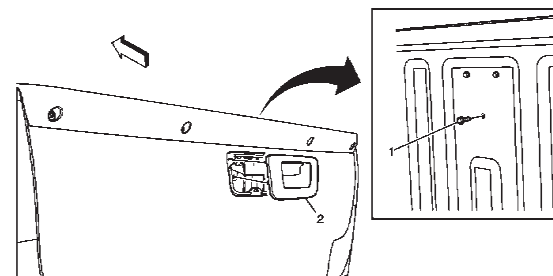

**FIGURE 2**

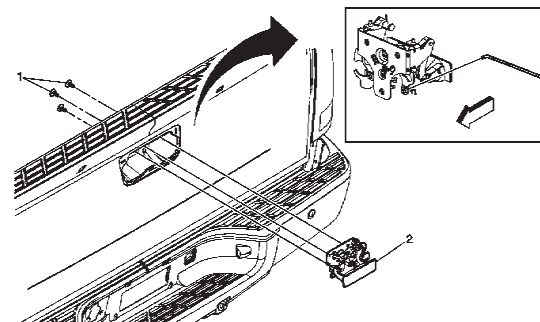

## Endgate Handle with Codeable Lock

REV 16OC12

PART NO. **19132330**

SHEET **1** OF **1**

ALL INFORMATION WITHIN ABOVE BORDER TO BE PRINTED EXACTLY AS SHOWN ON 8.5 x 11 WHITE 16 POUND NON-BOND RECYCLABLE PAPER. PRINT ON BOTH SIDES, EXCLUDING TEMPLATES. TO BE UNITIZED IN ACCORDANCE WITH GM SPECIFICATIONS.

DATE	REVISION	AUTH	DR
21SE06	Initial Release - Barton Crowell		
29AU07	Revised - Scott Besemer		
16OC12	Revised - John Wessels		

TITLE
<b>INSTALLATION INSTRUCTIONS</b>
<b>Endgate Handle with Codeable Lock</b>
PART NO. <b>19132330</b>
SHEET <b>1</b> OF <b>1</b>

Looking for dependable truck bed accessories? Rely on Bolt Lock for quality and long-lasting products.