



BX88371

Single Pull Immobilizer, 2" Installation Instructions

BX88371

The BX88371 Single Pull Immobilizer Kit is designed to be used with most 2" receiver hitches. The immobilizer eliminates or greatly reduces rattling and movement in the receiver hitch.

Tools Required
5/8" Socket
or
5/8" Wrench

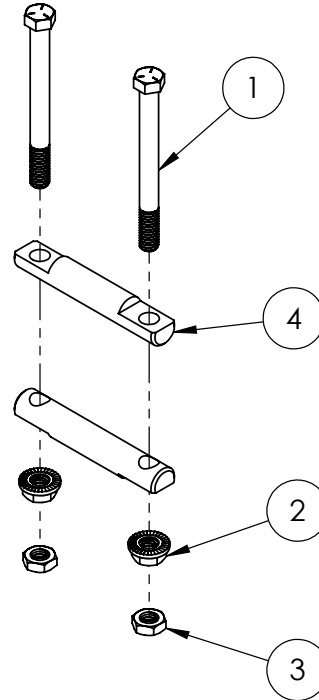

Item No.	Part No.	Description	Qty.
1.....	201-0560	7/16"-14 x 4-1/2" Hex Head Bolt, Grade 5, ZP	2
2.....	202-0248	7/16"-14 Whiz Flange Nut, ZP	2
3.....	202-0249	7/16"-14 Jam Nut, ZP	2
4.....	299-0825	Cross Bar, SP, ZP	2

Installation Instructions

1. Insure the drop receiver or tow bar is pinned into receiver.
2. Place 7/16" bolts through one of the cross bars. Place the rounded side of the cross bar just behind the lip of the vehicle receiver tube. Slide second cross bar onto bolts so that the rounded side of the cross bar is facing inward as shown below.
3. Install a 7/16" flange nut onto each bolt and torque to 23 ft/lbs so that each nut is tightened down evenly. Then using a wrench to hold the flange nut stationary, install a 7/16" jam nut onto each bolt and tighten each jam nut evenly to 23 ft/lbs.

