



BX2657

2015-18 Ford Edge (Includes Sport) (No 2.0L EcoBoost or ACC) Installation Instructions

Attachment Tab Height: 17"

Attachment Tab Width: 24"

Please read BOTH these Installation Instructions and the General Instructions prior to installing or operating this equipment.

- Blue Ox® towing products and accessories are intended to be installed by Blue Ox® Dealers who are familiar with our products and have the equipment and knowledge necessary to do "it work".
- Many Blue Ox® baseplates are designed to use existing holes and hardware to mount the baseplate to the towed vehicle. Even though bolts are there, do not assume they are adequate for baseplate mounting. Always use the hardware supplied in the hardware kit and existing hardware as specified in the installation instructions.

Bolt Torque Specifications
Torque in Foot-Pounds for Inch Bolts

| Bolt Size | Grade 5 | Grade 8 |
|-----------|---------|---------|
| 1/4" | 10 | 14 |
| 5/16" | 19 | 29 |
| 3/8" | 33 | 47 |
| 7/16" | 54 | 78 |
| 1/2" | 78 | 119 |
| 5/8" | 154 | 230 |
| 3/4" | 257 | 380 |



Bolt Torque Specifications
Torque in Foot-Pounds for Metric Bolts

| Bolt Size | Grade 8.8 | Grade 10.9 |
|-----------|-----------|------------|
| 6MM | 6 | 8 |
| 8MM | 16 | 22 |
| 10MM | 31 | 40 |
| 12MM | 54 | 70 |
| 14MM | 89 | 117 |
| 16MM | 161 | 230 |
| 18MM | 222 | 318 |

Reference your vehicle owner's manual for manufacturer's towing specifications.

! WARNING

Failure to read and follow these instructions could result in separation of the towed vehicle from the tow bar, causing property damage, loss of towed vehicle, personal injury or death.

BX2657
2015-18 Ford Edge (Includes Sport) (No 2.0L EcoBoost or ACC)
Installation Instructions

Instruction Notes: The fascia cover, fascia, and headlights are removed and reinstalled for the baseplate installation. Some drilling and trimming is required.

Place all components that are removed on a flat, sturdy surface. All items will be reinstalled unless otherwise noted after the baseplate is installed.

The dimensional variations between otherwise identical vehicles can be considerable. While the baseplate was designed for easy installation, it may be necessary to tailor the baseplate slightly to compensate for vehicle manufacturer's tolerances.

NOTICE

- Handling of some cosmetic parts when installing this product may require the use of protective covers, rags, specialty tools, etc. to prevent damage.
- When using power drills be aware of the dangers of torque and drill bit length.
- When using a reciprocating saw be aware of objects behind the cutting surface.
- Use a good quality paint to spray cut edges of frame to prevent rusting.
- Be sure that **ALL** electrical connections are plugged in and accessories are functioning properly before reinstalling the fascia.
- The baseplate is computer tested to your vehicle's GVWR, exceeding this weight will void the manufacturer's warranty.
- Be sure to use a sufficient amount of Loctite® Red on all bolt threads before tightening. Tighten all bolts according to the torque chart provided.
- Dealer or installer be certain the user receives these instruction sheets.
- If the baseplate is in an accident, it must be replaced. **DO NOT** use it again! An accident can cause unseen damage and using it again could result in more damage or serious injury. **DO NOT** use the baseplate if it is damaged or missing parts.

BX2657

2015-18 Ford Edge (Includes Sport) (No 2.0L EcoBoost or ACC) Installation Instructions

Tools Required

Flat Screwdriver
Utility Knife
Phillips Screwdriver
Torque Wrench
Drill
Loctite® RED
3/8" Drill Bit
1-1/4" Hole Saw
8MM Socket
10MM Socket
9/16" Socket
9/16" Wrench

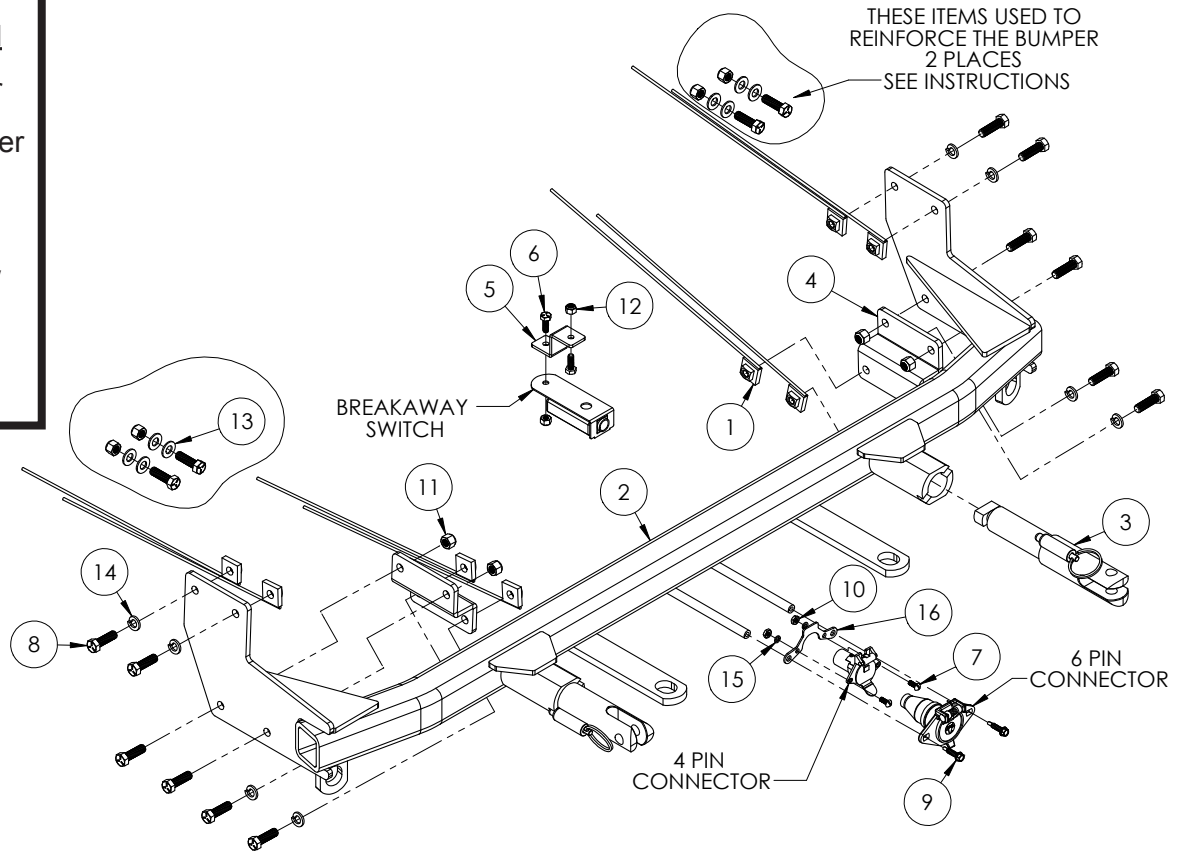

| Item No. | Part No. | Description | Qty. |
|----------|---------------------|--|------|
| 1..... | 61-5208 | 3/8" Nut Plate w/ 14" Wire..... | 8 |
| 2..... | 61-7496 | BX2657 Baseplate..... | 1 |
| 3..... | 62-3469 | Attachment Tab Assembly with Hole..... | 2 |
| 4..... | 101-8665 | Lower Support Plate..... | 2 |
| 5..... | 102-7134 | Breakaway Bracket..... | 1 |
| 6..... | 201-0050 | 1/4"-20 x 3/4" Hex Head Bolt, Grade 5, ZP..... | 2 |
| 7..... | 201-0192 | #10-32 1/2" Round Slotted Head Screw..... | 2 |
| 8..... | 201-0368 | 3/8"-16 x 1-1/4" Hex Head Bolt, Grade 5, ZP..... | 16 |
| 9..... | 201-0979 | #12-14 x 1" Self Drilling Screw, ZP..... | 2 |
| 10..... | 202-0047 | #10-32 Hex Nut..... | 2 |
| 11..... | 202-0090 | 3/8"-16 Hex Nylon Insert Lock Nut, ZP..... | 8 |
| 12..... | 202-0102 | 1/4"-20 Hex Nylon Nut, ZP..... | 2 |
| 13..... | 203-0003 | 3/8" Flat Washer, ZP..... | 8 |
| 14..... | 203-0010 | 3/8" Lock Washer, ZP..... | 8 |
| 15..... | 203-0054 | #10 Lock Washer, ZP..... | 2 |
| 16..... | 299-0685 | 4-Way Bracket..... | 1 |
| 17..... | 226-0049(not shown) | Class IV Safety Cables..... | 2 |
| 18..... | 229-0512(not shown) | 1/2" Quicklink, ZP..... | 2 |
| 19..... | 290-0437(not shown) | Black Cap Plug Receiver..... | 2 |

Important:

Use only genuine factory replacement parts on your baseplate. Do **NOT** substitute homemade or non-typical parts. If a bolt is lost or in need of replacement, for your safety and the preservation of your baseplate, be sure to use a replacement bolt of the same grade (In most cases it will be Grade 5, please reference the parts list above). Replacement parts may be ordered through your nearest Blue Ox® Dealer or Distributor. Failing to follow and/or altering these installation instructions in either installation or required equipment will void the manufacturer's warranty. Towing behind a non-motorized vehicle will void the warranty.

BX2657

2015-18 Ford Edge (Includes Sport) (No 2.0L EcoBoost or ACC) Installation Instructions

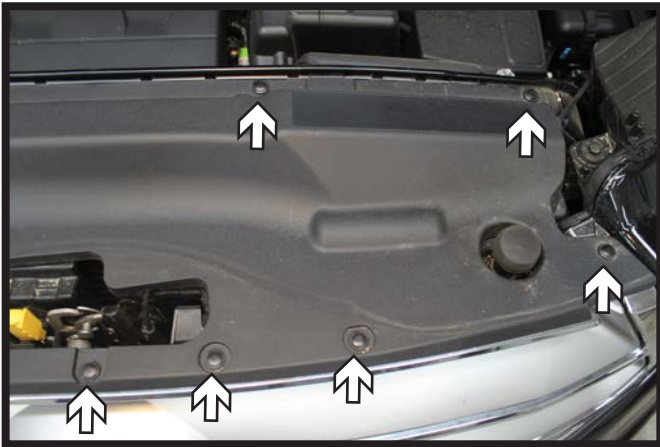

1. Remove the twelve (12) push pins from the fascia cover. There are six (6) on each side. Set the cover aside.

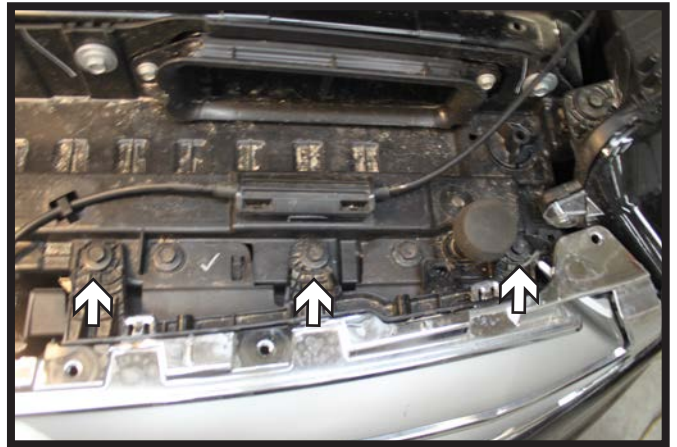

2. Using a 10MM socket, remove the six (6) screws from the top edge of the fascia. There are three (3) on each side.



3. Using a 10MM socket, remove the two (2) screws from the headlight (white). Remove the indicated push pin from the driver side (gray). Disconnect all electrical connections and set the headlight aside. Do this on both sides of the vehicle.

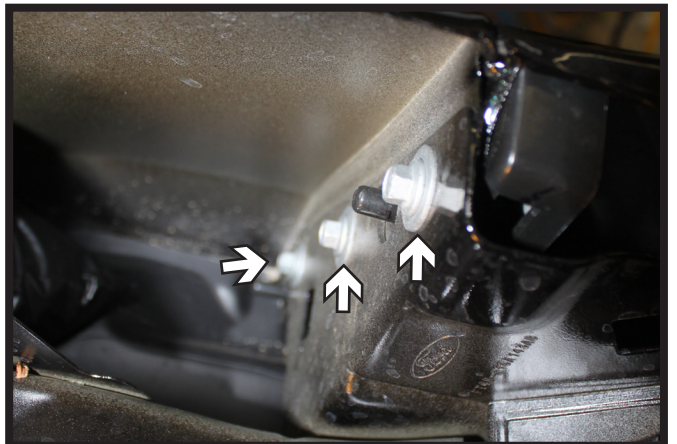

4. Using a 8MM socket, remove the three (3) screws from the fascia/fender joint underneath where the headlight was. Do this on both sides of the vehicle.

BX2657

2015-18 Ford Edge (Includes Sport) (No 2.0L EcoBoost or ACC) Installation Instructions

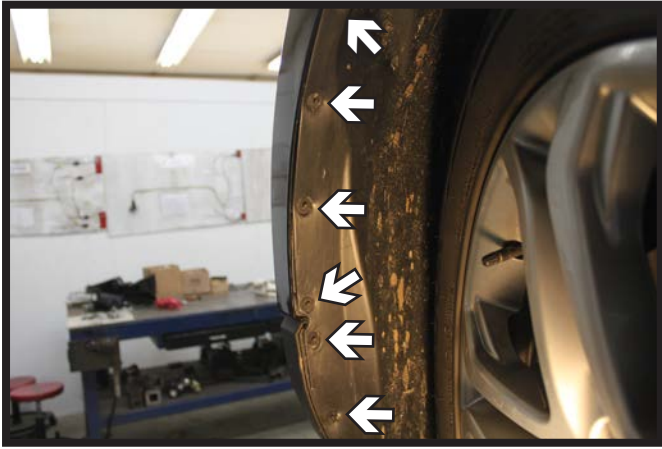

5. Using a 5.5MM socket, remove the six (6) screws from the edge of the wheel well. Do this on both sides of the vehicle.



6. Using a 5.5MM socket, remove the ten (10) screws from the underside of the fascia. There are five (5) on each side.



6. Unsnap the fascia by the headlight locations. Pull the corners of the fascia away from the vehicle disconnecting any electrical connections and set the fascia aside.

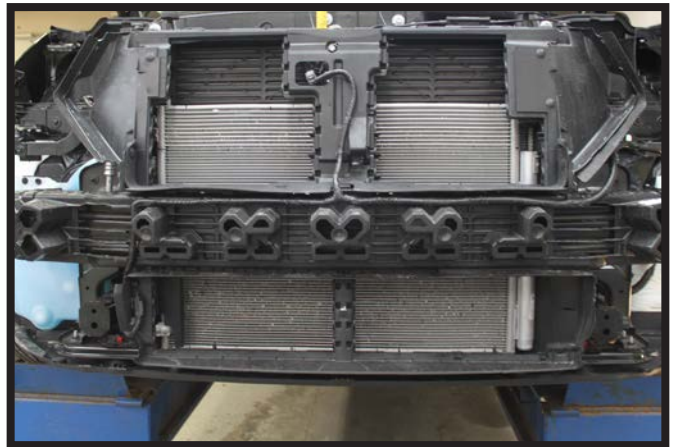

7. Disconnect the temperature sensor and wiring loom from the plastic bumper cover. Unsnap the bumper cover from the bumper and set aside.

BX2657

2015-18 Ford Edge (Includes Sport) (No 2.0L EcoBoost or ACC) Installation Instructions

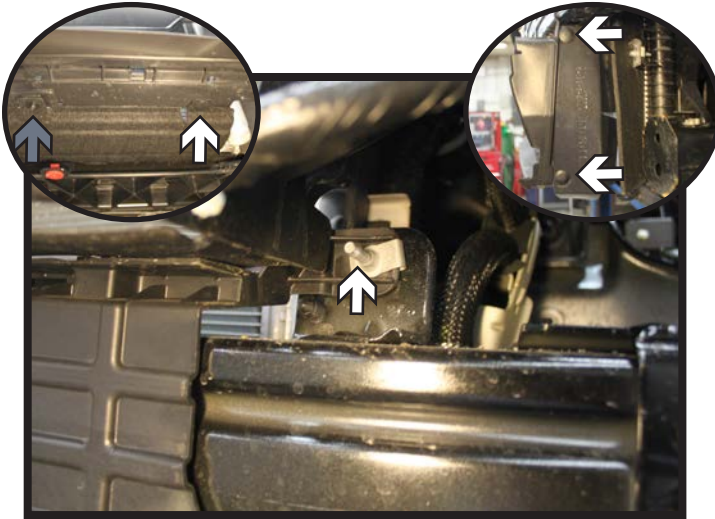

8a. **All Models:** Using a 10MM socket, remove the screw from the shielding just above the bumper.

Along the sides remove the two (2) push pins on both sides (right inset).

On the bottom side, remove the two (2) push pins one on each side. Then using a 5.5MM socket remove the middle screw (gray), pull the bottom of the shielding away from the vehicle (left inset).

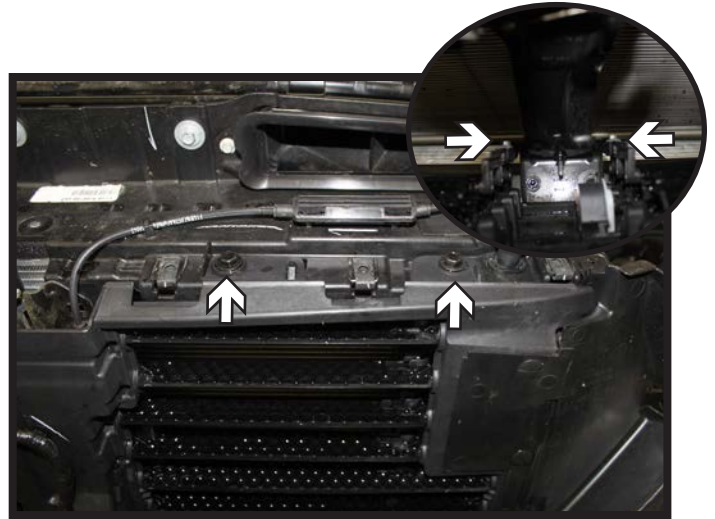

8b. **Shutter Models:** In addition to the 8a steps, using a 10MM socket, remove the four (4) screws from the top of the shielding.

Pull back the top of the shielding and remove the two (2) lower screws with a 10MM socket (inset).

Disconnect all wiring and unsnap the entire shielding from the vehicle and set aside,

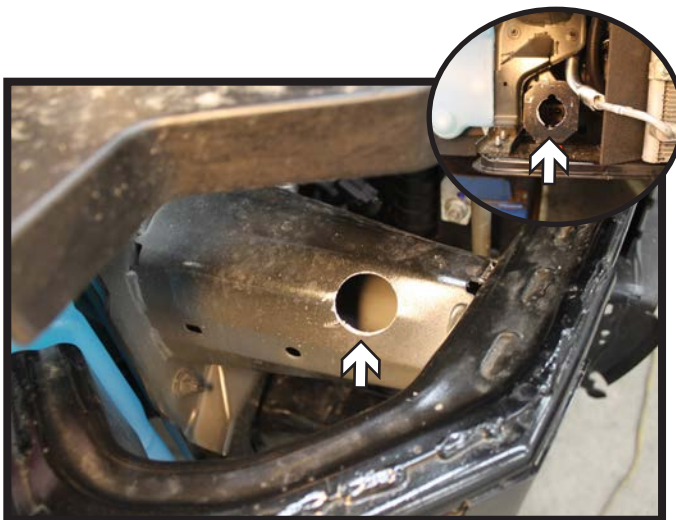

9. Using a 1-1/4" hole saw, drill access holes in the side of the frame as shown and in the face of the lower support (inset). Do this on both sides of the vehicle.



10. Using a 3/8" drill bit, ream out the rear existing hole. Do this on both sides of the vehicle.

BX2657

2015-18 Ford Edge (Includes Sport) (No 2.0L EcoBoost or ACC) Installation Instructions

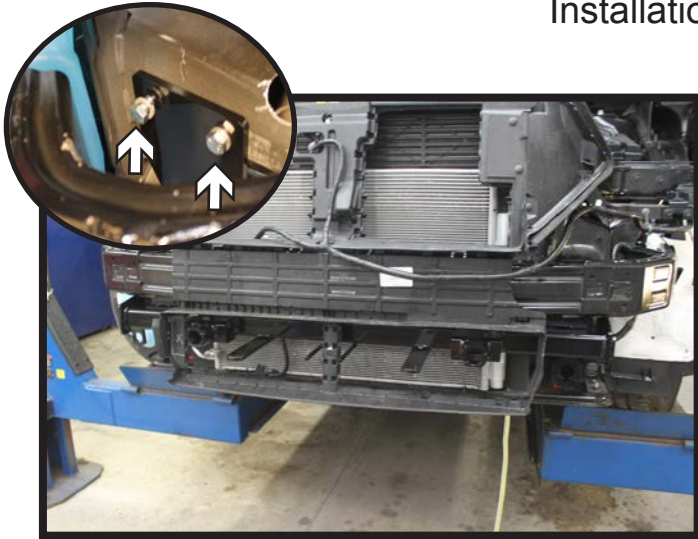

11. Pull the shielding out away from the vehicle (if applicable) and install the baseplate onto the frame with the 3/8" hardware (inset). Level the baseplate prior to fully tightening the bolts.

** Use Loctite® Red on all bolt threads and tighten all bolts to the appropriate torque.

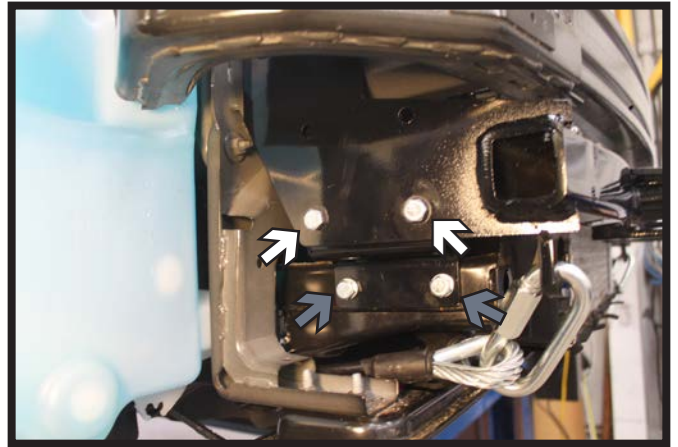

12. Install the lower support plate to the baseplate holes with the supplied 3/8" hardware (white). Then using a 3/8" drill bit, drill the lower plate holes thru the support and install the 3/8" hardware (gray). Do this on both sides of the vehicle. Fully tighten all hardware.

** Use Loctite® Red on all bolt threads and tighten all bolts to the appropriate torque.

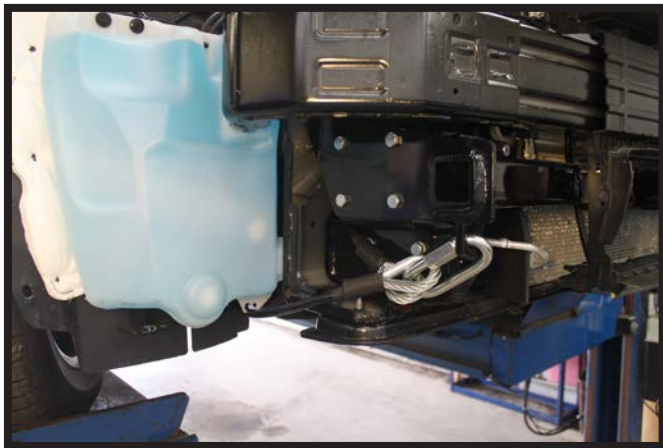

13. Attach the permanent baseplate safety cables to the provided convenience link on the baseplate. The photo above shows the recommended installation of the cables to frame of vehicle. Additional options may interfere with suggested mounting; in this case, secure the cables to a solid piece of the frame as described in the instructions included with the permanent baseplate safety cables. Be sure the safety cables do not rub against any hoses or moving parts. Do this on **BOTH** sides of the vehicle.

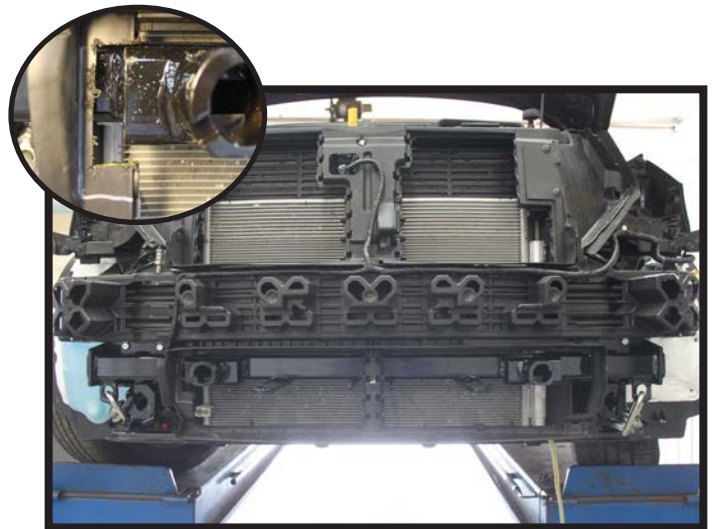

- 14a. **Non Shutter Models:** Reinstall the shielding, trimming as necessary on the passenger side (inset).

Reinstall the plastic bumper cover and temperature sensor.

BX2657

2015-18 Ford Edge (Includes Sport) (No 2.0L EcoBoost or ACC) Installation Instructions



14b. **Shutter Models:** Remove the lower shutters from the shielding and trim as needed to clear the baseplate. Reinstall the shielding.

Reinstall the plastic bumper cover and temperature sensor.



15. Along the top side of the frame, drill two (2) 3/8" holes thru both flanges, insuring enough room for the flat washers. Install the 3/8" hardware and fully tighten the bolts. Do this on both sides of the vehicle.

** Use Loctite® Red on all bolt threads and tighten all bolts to the appropriate torque.

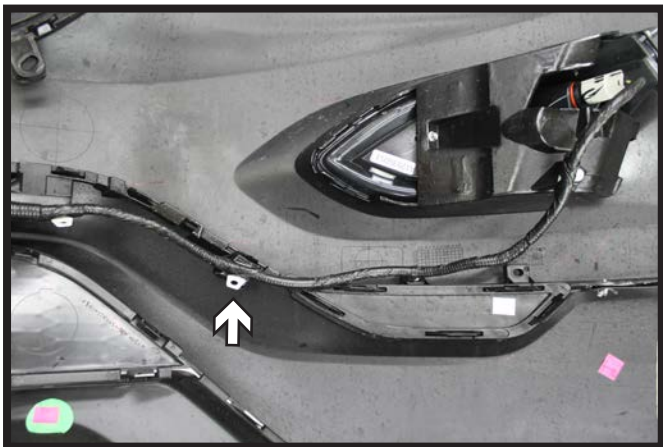

16. On the backside of the fascia, unhook the loom from the hook. Trim off the hook as necessary for clearance of the baseplate. Do this on both sides of the fascia.



17. Hold the fascia as close to its original position, mark and trim the fascia around the convenience links and attachment tabs. Reinstall the fascia and fascia cover.

BX2657

2015-18 Ford Edge (Includes Sport) (No 2.0L EcoBoost or ACC)
Installation Instructions



18. **Optional Breakaway:** The breakaway bracket can be installed to the license plate bracket or the lip of the fascia at the desired location with the supplied 1/4" hardware.



General Information

1. **It is the owner's responsibility to inspect all towing equipment for cracked welds, missing or worn parts and loose bolts before each towing trip.** Be sure to use Loctite® Red on all bolts and tighten to the recommended specifications.
2. **It is the owner's responsibility to hook up all towing equipment per manufacturer's instructions/ recommendations.**
3. Remove the attachment tabs when not in use (if applicable).

Notice To Baseplate Installer

1. It is YOUR responsibility to watch for:

- Oil cooler and air conditioner lines
- Electrical wires and hoses
- Missing parts or attaching points on the frame

** If the baseplate is improperly installed and is against a wire or hose, it could cause fluid leaks or electrical shorts some time after the actual baseplate installation.

Permanent Baseplate Safety Cable Installation

Permanent baseplate safety cables are strongly recommended when towing a vehicle with a tow bar. The principle function of the permanent baseplate safety cables is to prevent the towed vehicle from breaking loose in the event the connection between the frame of the towed vehicle and the baseplate fails or becomes disconnected. The cables must be connected from the baseplate to the frame rail or cross member of the vehicle's frame. The illustrations below show the possible arrangements recommended by Blue Ox®. Each permanent baseplate safety cable must have an adequate weight rating for the towing system. The weight rating of the two (2) cables together will not qualify.

Do not mount the permanent baseplate safety cables against wires, hoses or brake lines.

These permanent baseplate safety cables should remain installed as long as the baseplate is installed on the vehicle. Permanent baseplate safety cables are to be used in conjunction with, and NOT a replacement for legally required safety cables attaching the towed vehicle to the towing vehicle.

Option #1

(Baseplates with Convenience Link Tabs)



Option #2

(Baseplates with out Convenience Link Tabs)

