



# BX2170 2000 Ford Ranger (2WD/4WD, Not Northland) Installation Instructions

Attachment Tab Height: 17"

Attachment Tab Width: 24"

**Please read BOTH these Installation Instructions and the General Instructions before attempting to install or operate this equipment.**

- Blue Ox® towing products and accessories are intended to be installed by Blue Ox® Dealers who are familiar with our products and have the equipment necessary and knowledge to do "fit work".
- Many Blue Ox® Baseplates are designed to use existing holes and hardware to mount the baseplate to the towed vehicle. Even though bolts are there, do not assume they are adequate for baseplate mounting. Always use hardware supplied in the hardware kit and existing hardware specified in the Baseplate Installation Instructions.

Confirm the towability and pre-towing procedures for your vehicle with the owner's manual or contact the vehicle's manufacturer for specific towing procedures.

**Bolt Torque Specifications**  
Torque in Foot-Pounds per Metric Bolts

| Bolt Size | Grade 8.8 | Grade 10.9 |
|-----------|-----------|------------|
| 6MM       | 6         | 8          |
| 8MM       | 16        | 22         |
| 10MM      | 31        | 40         |
| 12MM      | 54        | 70         |
| 14MM      | 89        | 117        |

**Bolt Torque Specifications**  
Torque in Foot-Pounds per Inch Bolts

| Bolt Size | Grade 5 | Grade 8 |
|-----------|---------|---------|
| 1/4"      | 10      | 14      |
| 5/16"     | 19      | 29      |
| 3/8"      | 33      | 47      |
| 7/16"     | 54      | 78      |
| 1/2"      | 78      | 119     |
| 5/8"      | 154     | 230     |

**! WARNING**

Failure to read and follow these instructions could result in separation of the towed vehicle from the tow bar, causing property damage, loss of towed vehicle, personal injury or death.

# BX2170 2000 Ford Ranger Installation Instructions

## Parts List

| Ref. No. | Qty. | Part #              | Description                           |
|----------|------|---------------------|---------------------------------------|
| 1        | 1    | 61-5156             | Weldment, Baseplate, BX2135/BX2170    |
| 2        | 1    | 101-6609            | Plate Support, DS BX2135              |
| 3        | 1    | 101-6610            | Plate Support, PS BX2135              |
| 4        | 4    | 61-5159             | Weldment, 1/2" Nut Plate              |
| 5        | 2    | 61-4029             | Weldment, 1/2" Nut Plate              |
| 6        | 4    | 61-5208             | Weldment, 3/8" Nut Plate, With Wire   |
| 7        | 6    | 201-0051            | 1/2-13 x 1 1/2" Hex Bolt, Grade 5     |
| 8        | 6    | 203-0012            | 1/2" Lock Washer                      |
| 9        | 4    | 203-0005            | 1/2" Flat Washer                      |
| 10       | 4    | 201-0368            | 3/8-16 x 1 1/4" Hex Bolt, Grade 5, ZP |
| 11       | 4    | 201-0440            | 3/8-16 x 1 1/2" Hex Bolt, Grade 5, ZP |
| 12       | 2    | 201-0010            | 3/8" Lock Washer                      |
| 13       | 4    | 202-0003            | 3/8-16 Hex Nut, ZP                    |
| 14       | 2    | 201-0979            | #12-14 x 1" Self Drilling Screw, ZP   |
| 15       | 2    | 201-0192            | #10-32 x 1/2" Slot, Rd. Hd. Screw     |
| 16       | 2    | 203-0054            | #10 Lock Washer                       |
| 17       | 2    | 202-0047            | #10 Hex Nut                           |
| 18       | 2    | 101-5822            | Adapter, 4 way Connector              |
| 19       | 2    | 226-0049(not shown) | Class III Safety Cables               |

## Tools Required

|              |                  |
|--------------|------------------|
| 18MM Socket  | 13/32" Drill Bit |
| 10MM Socket  | 17/32" Drill Bit |
| 3/4" Socket  | LOCTITE Red      |
| 9/16" Socket |                  |

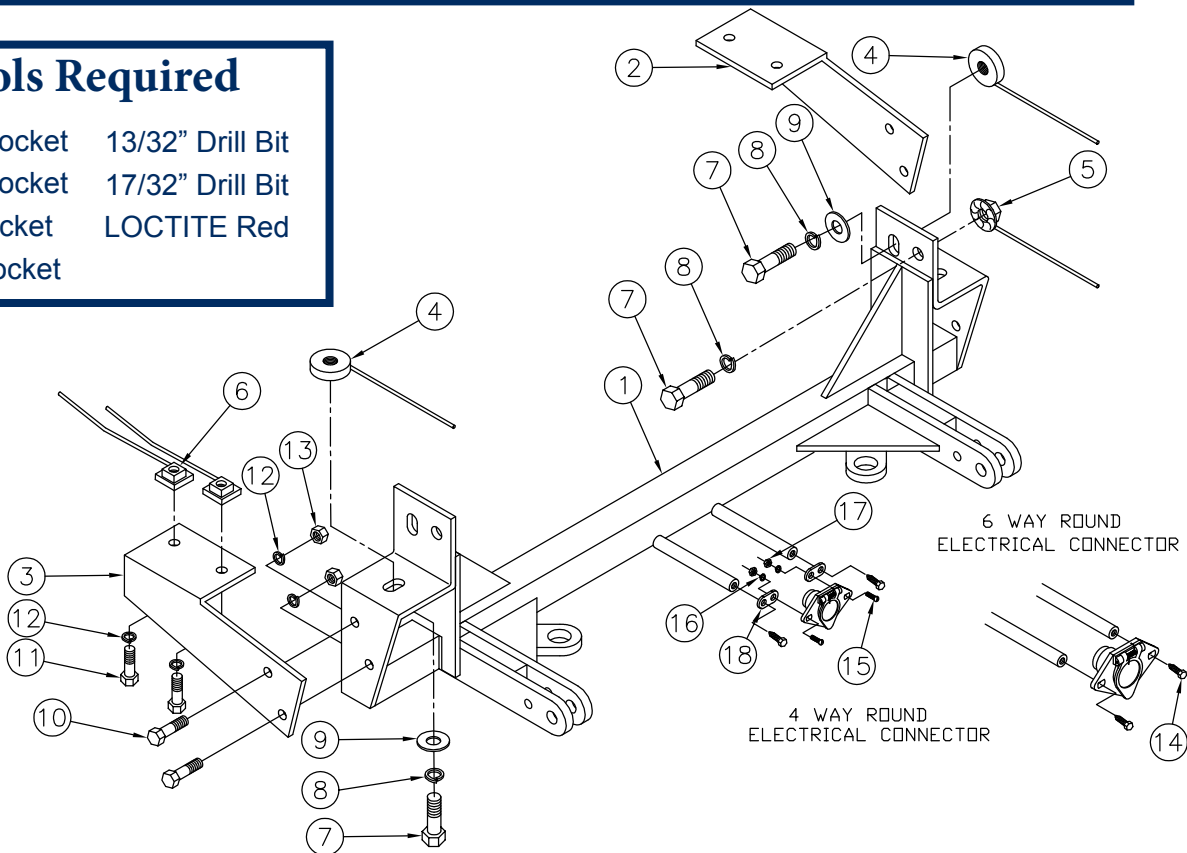

### Important:

Use only genuine factory replacement parts on your baseplate. Do NOT substitute homemade or non-typical parts. If a bolt is lost or in need of replacement, for your safety and the preservation of your baseplate, be sure to use a replacement bolt of the same grade (In most cases it will be Grade 5, please reference the parts list above).

# BX2170

## 2000 Ford Ranger

### Installation Instructions

#### Standard Tab Spacing Guidelines:

To use certain adapters or a RangeFinder II tow bar in conjunction with standard tab baseplates an additional 5/16" hole must be drilled in the attachment tabs. The Ambassador tow bar will require an adapter for attachment tabs that are not 24" wide. The Adventurer tow bar will require an adapter for attachment tabs that are less than 24" wide. The Acclaim tow bar will not fold and store without the use of an adapter on vehicles with attachment tabs less than 24" wide. The BX88152 adapter cannot be used with this baseplate.

#### Instructions:

**Installation of the baseplate requires removing and reinstalling the bumper and belly pan. Drilling is required. Trimming of the belly pan and fascia is required.**

**The dimensional variations between otherwise identical vehicles can be considerable. While the baseplate was designed for easy installation, it may be necessary to tailor the baseplate slightly to compensate for auto manufacturer's tolerances. These minor adjustments may include filing a hole slightly, bending electrical rods, and/ or bending end plates.**

**The BX8869 Bulb and Socket wiring kit is recommended for this vehicle.**

#### Installation Instructions

1. The baseplate mounts to the frame using six bolts which are included with the baseplate. The lower plastic air dam needs to be trimmed for the attachment tabs to protrude.
2. There are four hex nuts that hold the bumper on the end of the frame rails. Remove the bolts with the 18MM socket and set the bumper aside to be reinstalled later.
3. The baseplate fits on the inside and bottom of the frame rails near the front of the frame. There are slots in the frame that will match up to the slots in the end of pieces of the baseplate. Hold the baseplate up in position and then mark the location of the two round holes in the side of the end pieces. Remove the baseplate and drill 17/32" holes in these locations.
4. Position the baseplate on the frame again and start the bolts. The four nut plates supplied are to be used on the bolts going into the slotted holes and the nut wires for the two drilled holes. Use the flat washers to cover the slots. When all bolts are started, tighten completely. Be sure to apply LOCTITE Red to all bolts before tightening. Tighten all bolts according to the Torque Chart in the General Instructions sheet.

BX2170  
**2000 Ford Ranger**  
**Installation Instructions**

5. Align the holes of the plate support to the outside of the baseplate end, insert the 3/8" hex bolt, fasten the lock washer and hex nut, according to the drawing on page 2. Do this to both sides of the vehicle. Using the plate support as a template, drill holes into the bottom of the frame with the 13/32" drill bit. Do this to both sides of the vehicle. Tighten all bolts according to the torque chart found on page 3 of the Baseplate General Towing Instructions sheet.
6. Hold the bumper up to its original position, mark where the attachment tabs will protrude out, trim the plastic on the front bumper and reinstall the bumper.

Install the tow bar and safety cables according to the instructions included in their packages.

Do not substitute other devices if the tow bar pin and clip are lost.

**DEALER OR INSTALLER:** BE CERTAIN THE USER RECEIVES THE INSTRUCTION SHEETS.

# General Information

1. It is the owner's responsibility to inspect all towing equipment for cracked welds, missing or worn parts and loose bolts before each towing trip. Be sure to use Loctite® Red on all bolts and tighten to the recommended specifications.
2. It is the owner's responsibility to hook up all towing equipment per manufacturer's instructions/ recommendations.
3. Remove the attachment tabs when not in use (if applicable).

## Notice To Baseplate Installer

1. It is YOUR responsibility to watch for:

- Oil cooler and air conditioner lines
- Electrical wires and hoses
- Missing parts or attaching points on the frame

\*\* If the baseplate is improperly installed and is against a wire or hose, it could cause fluid leaks or electrical shorts some time after the actual baseplate installation.

## Permanent Baseplate Safety Cable Installation

Permanent baseplate safety cables are strongly recommended when towing a vehicle with a tow bar. The principle function of the permanent baseplate safety cables is to prevent the towed vehicle from breaking loose in the event the connection between the frame of the towed vehicle and the baseplate fails or becomes disconnected. The cables must be connected from the baseplate to the frame rail or cross member of the vehicle's frame. The illustrations below show the possible arrangements recommended by Blue Ox®. Each permanent baseplate safety cable must have an adequate weight rating for the towing system. The weight rating of the two (2) cables together will not qualify.

***Do not mount the permanent baseplate safety cables against wires, hoses or brake lines.***

These permanent baseplate safety cables should remain installed as long as the baseplate is installed on the vehicle. Permanent baseplate safety cables are to be used in conjunction with, and NOT a replacement for legally required safety cables attaching the towed vehicle to the towing vehicle.

### Option #1

(Baseplates with Convenience Link Tabs)

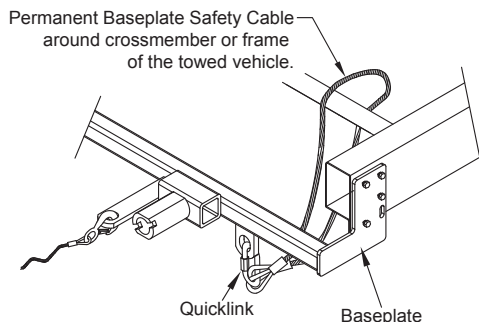

### Option #2

(Baseplates with out Convenience Link Tabs)

