



BX1726

2016-18 Chevy Malibu (All Models) (No Active Shutters or E-Assist) Installation Instructions

Attachment Tab Height: 12"

Attachment Tab Width: 24"

Please read BOTH these Installation Instructions and the General Information sheet prior to installing or operating this equipment.

1. Blue Ox® towing products and accessories are intended to be installed by Blue Ox® Dealers who are familiar with our products and have the equipment and knowledge necessary to do "it work".
2. Many Blue Ox® baseplates are designed to use existing holes and hardware to mount the baseplate to the towed vehicle. Even though bolts are there, do not assume they are adequate for baseplate mounting. Always use the hardware supplied in the hardware kit and existing hardware as specified in the installation instructions.

Bolt Torque Specifications
Torque in Foot-Pounds for Inch Bolts

| Bolt Size | Grade 5 | Grade 8 |
|-----------|---------|---------|
| 1/4" | 10 | 14 |
| 5/16" | 19 | 29 |
| 3/8" | 33 | 47 |
| 7/16" | 54 | 78 |
| 1/2" | 78 | 119 |
| 5/8" | 154 | 230 |
| 3/4" | 257 | 380 |



Bolt Torque Specifications
Torque in Foot-Pounds for Metric Bolts

| Bolt Size | Grade 8.8 | Grade 10.9 |
|-----------|-----------|------------|
| 6MM | 6 | 8 |
| 8MM | 16 | 22 |
| 10MM | 31 | 40 |
| 12MM | 54 | 70 |
| 14MM | 89 | 117 |
| 16MM | 161 | 230 |
| 18MM | 222 | 318 |

Reference your vehicle owner's manual for manufacturer's towing specifications.

! WARNING

Failure to read and follow these instructions could result in separation of the towed vehicle from the tow bar, causing property damage, loss of towed vehicle, personal injury or death.

BX1726
2016-18 Chevy Malibu
(All Models)(No Active Shutters or E-Assist)
Installation Instructions

Instruction Notes: The fascia, PS headlight, air baffle and windshield washer fluid reservoir are removed and reinstalled for the baseplate installation. Some drilling and trimming is required.

Place all components that are removed on a flat, sturdy surface. All items will be reinstalled unless otherwise noted after the baseplate is installed.

The dimensional variations between otherwise identical vehicles can be considerable. While the baseplate was designed for easy installation, it may be necessary to tailor the baseplate slightly to compensate for vehicle manufacturer's tolerances.

The BX8869 Tail Light Wiring Kit is recommended for this vehicle.

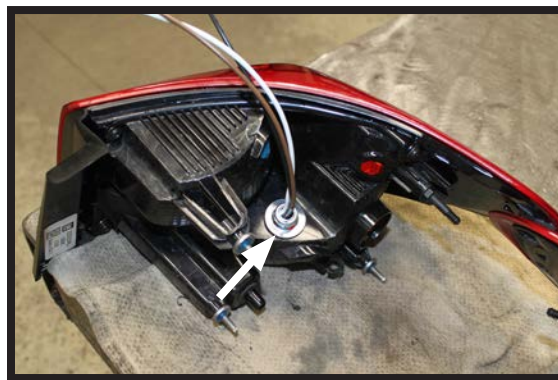

Drill a hole according to the tail
light wiring kit instructions.

NOTICE

- Handling of some cosmetic parts when installing this product may require the use of protective covers, rags, specialty tools, etc. to prevent damage.
- When using power drills be aware of the dangers of torque and drill bit length.
- When using a reciprocating saw be aware of objects behind the cutting surface.
- Use a good quality paint to spray cut edges of frame to prevent rusting.
- Be sure that **ALL** electrical connections are plugged in and accessories are functioning properly before reinstalling the fascia.
- The baseplate is computer tested to your vehicle's GVWR, exceeding this weight will void the manufacturer's warranty.
- Be sure to use a sufficient amount of Loctite® Red on all bolt threads before tightening. Tighten all bolts according to the torque chart provided.
- Dealer or installer be certain the user receives these instruction sheets.
- If the baseplate is in an accident, it must be replaced. **DO NOT** use it again! An accident can cause unseen damage and using it again could result in more damage or serious injury. **DO NOT** use the baseplate if it is damaged or missing parts.

BX1726
2016-18 Chevy Malibu
(All Models)(No Active Shutters or E-Assist)
Installation Instructions

Tools Required

- Flat Screwdriver
- Utility Knife
- Torque Wrench
- Drill
- Reciprocating Saw
- Tape Measure
- Loctite® RED
- 1-1/4" Hole Saw
- 1/4" Drill Bit
- 3/8" Drill Bit
- 1/2" Drill Bit
- 7MM Socket
- 10MM Socket
- 18MM Socket
- 7/16" Socket
- 7/16" Wrench
- 9/16" Socket
- 9/16" Wrench
- 3/4" Socket
- T15 Torx
- 5/16" Nut Driver

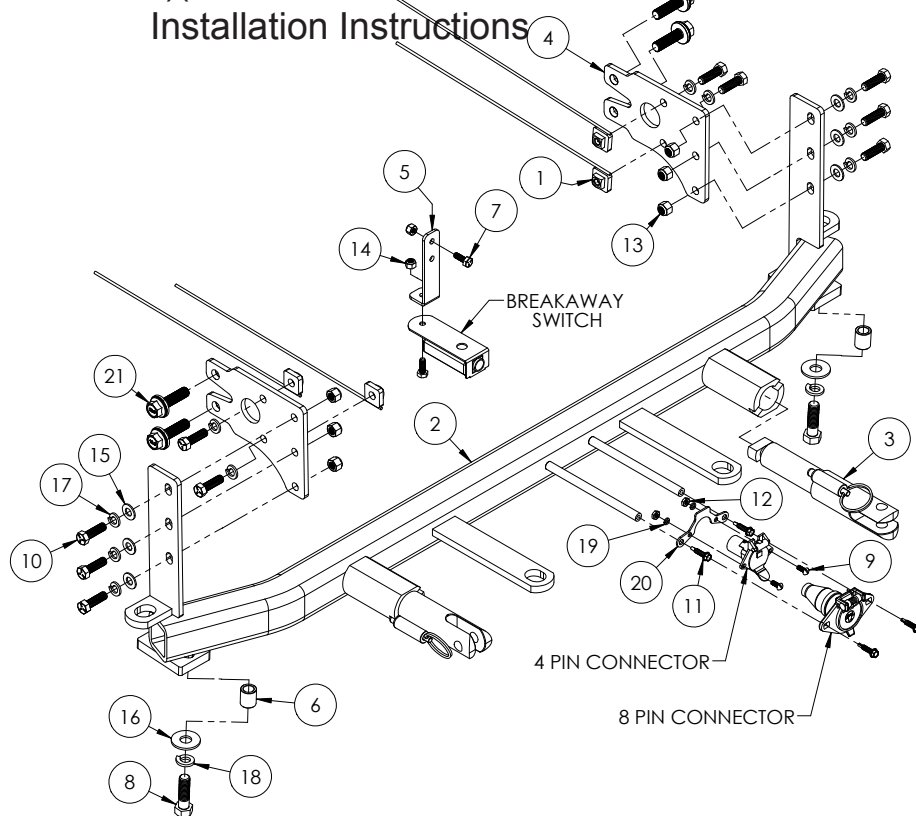

| Item No. | Part No. | Description | Qty. |
|----------|--------------------------|---|------|
| 1..... | 61-5208 | 3/8" Nut Plate w/ 14" Wire | 4 |
| 2..... | 61-7702 | BX1726 Baseplate..... | 1 |
| 3..... | 62-3469 | Attachment Tab Assembly with Hole..... | 2 |
| 4..... | 101-9194 | Side Plate | 2 |
| 5..... | 102-7186 | Breakaway Bracket..... | 1 |
| 6..... | 107-3788 | Spacer Tube, 3/4"Dia x 7/8"..... | 2 |
| 7..... | 201-0050 | 1/4"-20 x 3/4" Hex Head Bolt, Grade 5, ZP..... | 2 |
| 8..... | 201-0068 | 1/2"-13 x 1-3/4" Hex Head Bolt, Grade 5, ZP | 2 |
| 9..... | 201-0192 | #10-32 1/2" Round Slotted Head Screw..... | 2 |
| 10..... | 201-0368 | 3/8"-16 x 1-1/4" Hex Head Bolt, Grade 5, ZP | 10 |
| 11..... | 201-0979 | #12-14 x 1" Self Drilling Screw, ZP | 2 |
| 12..... | 202-0047 | #10-32 Hex Nut | 2 |
| 13..... | 202-0090 | 3/8"-16 Hex Nylon Insert Lock Nut, ZP..... | 6 |
| 14..... | 202-0102 | 1/4"-20 Hex Nylon Nut, ZP..... | 2 |
| 15..... | 203-0003 | 3/8" Flat Washer, ZP..... | 6 |
| 16..... | 203-0005 | 1/2" Flat Washer, ZP..... | 2 |
| 17..... | 203-0010 | 3/8" Lock Washer, ZP | 10 |
| 18..... | 203-0012 | 1/2" Lock Washer, ZP | 2 |
| 19..... | 203-0054 | #10 Lock Washer, ZP | 2 |
| 20..... | 299-0685 | 4-Way Bracket | 1 |
| 21..... | Existing | Frame Bolts | 4 |
| 22..... | 226-0046(not shown)..... | Class III Safety Cables | 2 |
| 23..... | 229-0359(not shown)..... | 3/8" Quicklink, ZP | 2 |
| 24..... | 290-0437(not shown)..... | Black Cap Plug Receiver | 2 |

Important:

Use only genuine factory replacement parts on your baseplate. Do **NOT** substitute homemade or non-typical parts. If a bolt is lost or in need of replacement, for your safety and the preservation of your baseplate, be sure to use a replacement bolt of the same grade (In most cases it will be Grade 5, please reference the parts list above). Replacement parts may be ordered through your nearest Blue Ox® Dealer or Distributor. Failing to follow and/or altering these installation instructions in either installation or required equipment will void the manufacturer's warranty. Towing behind a non-motorized vehicle will void the warranty.

BX1726
2016-18 Chevy Malibu
(All Models)(No Active Shutters or E-Assist)
Installation Instructions

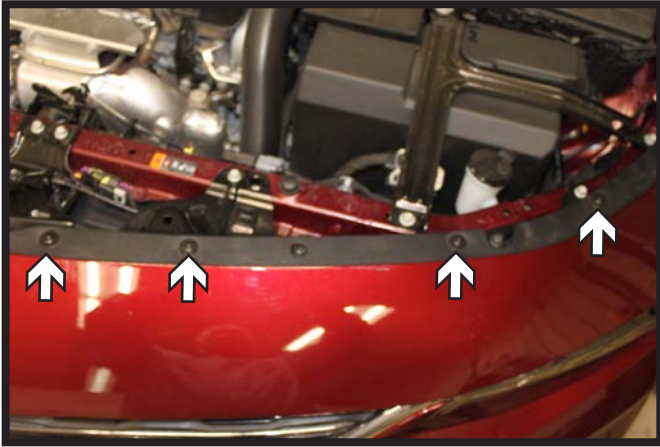

1. Using a T15 Torx, remove the eight (8) screws from the top edge of the fascia. There are four (4) on each side.

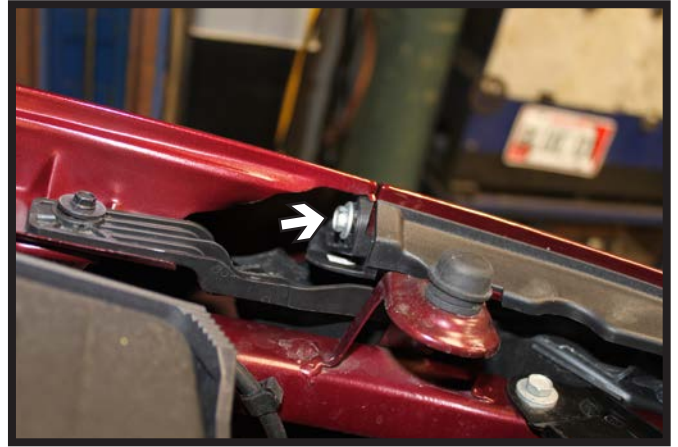

2. Using a 10MM socket, remove the screw from the fender/fascia joint in the engine compartment. Do this on both sides of the vehicle.

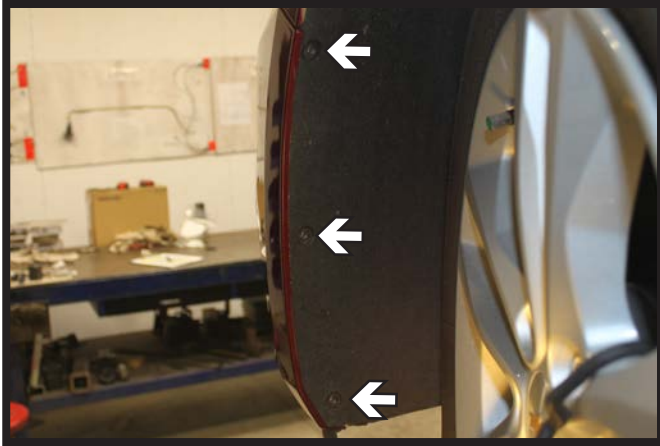

3. Using a T15 Torx, remove the three (3) screws from the wheel well. Do this on both sides of the vehicle.

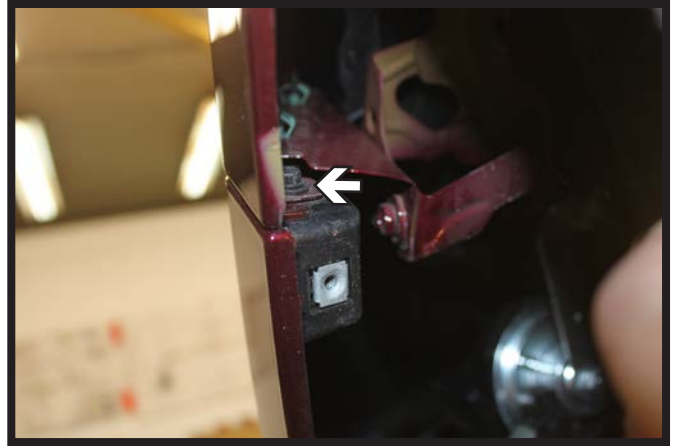

4. Pull back the wheel well liner, using a 10MM socket, remove the screw from the fascia/fender joint. Do this on both sides of the vehicle.

BX1726
2016-18 Chevy Malibu
(All Models)(No Active Shuttters or E-Assist)
Installation Instructions

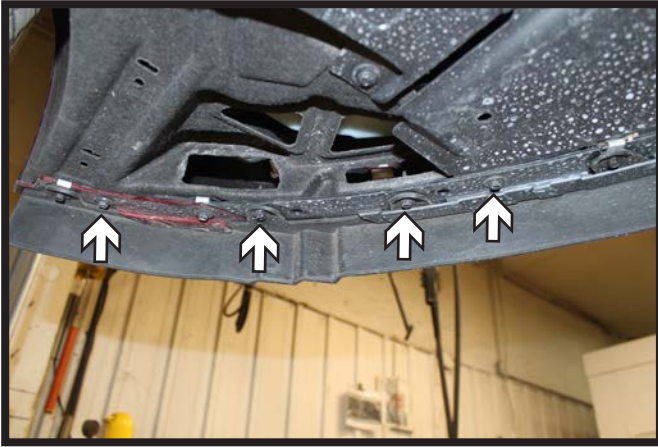

5. Using a 7MM socket, remove the fifteen (15) screws from the underside of the fascia. The screws with the clips do not need to be removed.
Pull the corners of the fascia away from the vehicle disconnecting any electrical connections and set the fascia aside.

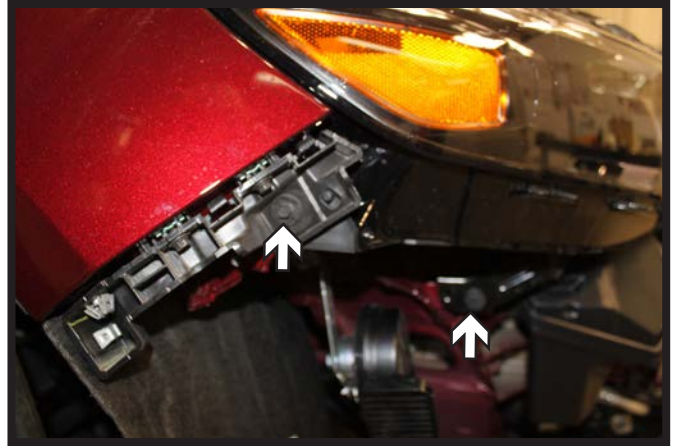
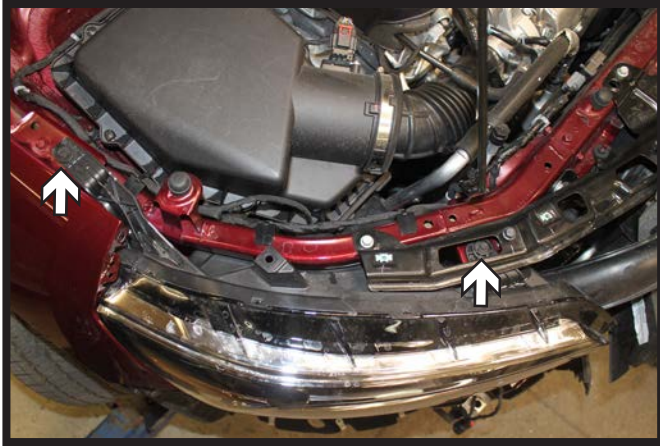

6. Using a 7MM socket, remove the four (4) screws from the PS headlight only. Disconnect any electrical connections and set the headlight aside.

BX1726
2016-18 Chevy Malibu
(All Models)(No Active Shutters or E-Assist)
Installation Instructions

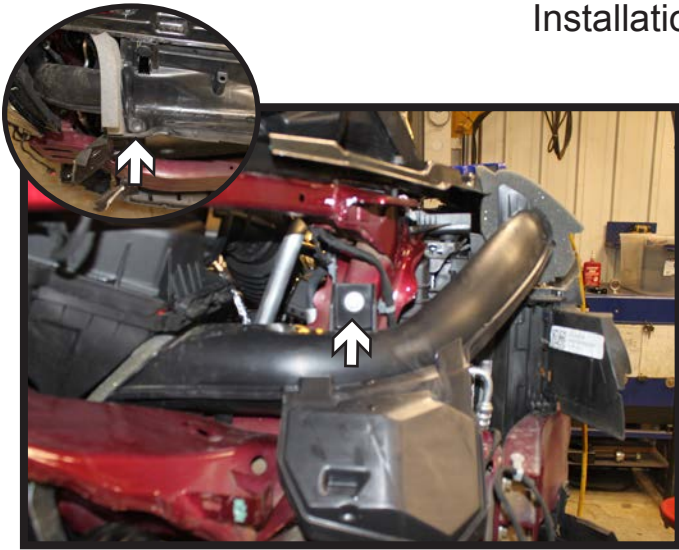

7. Using a 10MM socket, remove the screw from the air baffle on the passenger side. Then remove the push pin next to the radiator and set the baffle aside.

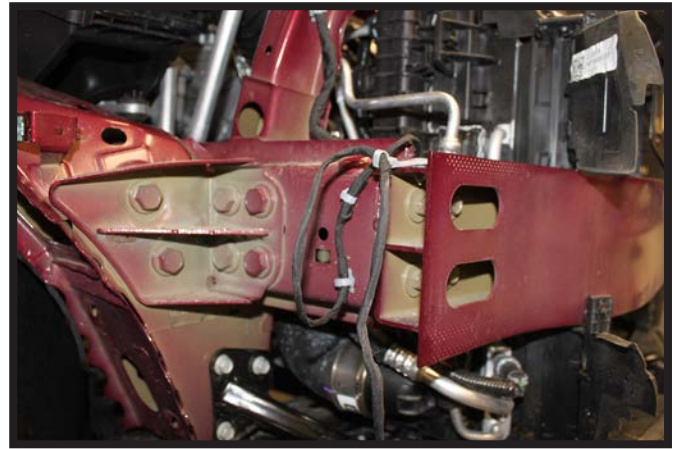

8. On the passenger side, remove the wiring loom clips from the frame and set the loom to the side.

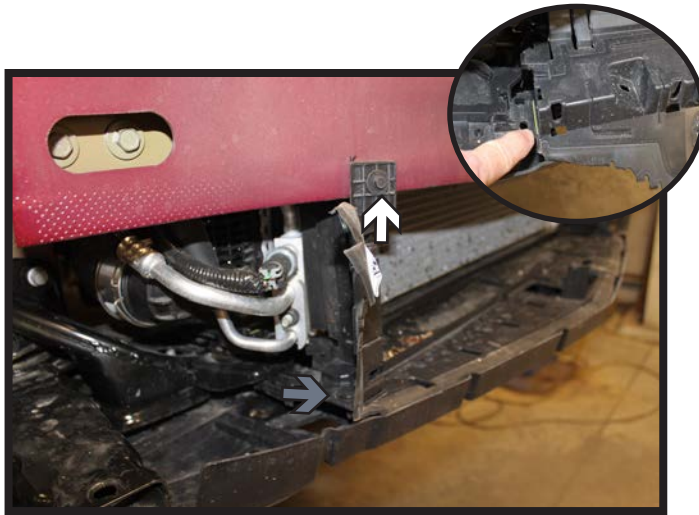

9. Using a 7MM socket, remove the screw from the side shielding (white). Remove the lower push pin (gray). Lay the shield flat and trim off (inset). Do this on both sides of the vehicle. The shields will not be reinstalled.



10. On the driver side, using a 10MM socket, remove the three (3) nuts from the washer reservoir. Disconnect/plug all lines and set the reservoir aside.

BX1726
2016-18 Chevy Malibu
(All Models)(No Active Shutters or E-Assist)
Installation Instructions

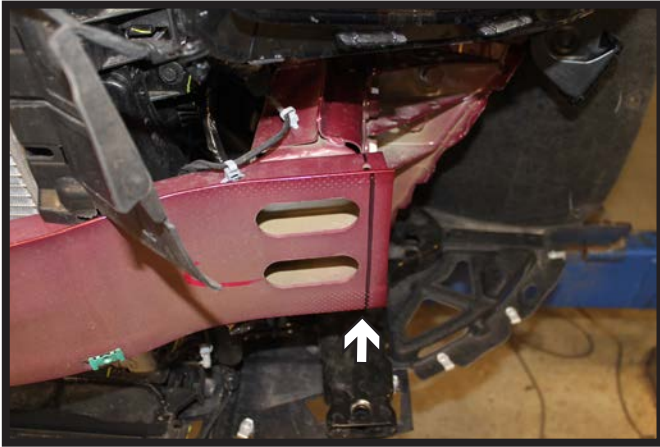

11. Using a reciprocating saw, trim the end of the bumper back flush with the face of the frame. Do this on both sides of the vehicle.

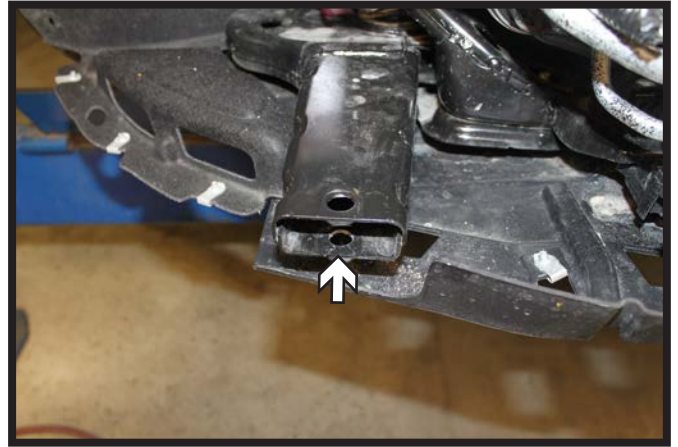

12. Using a 1/2" drill bit, ream the lower existing hole in the frame extension. Do this on both sides of the vehicle.



13. Using a 18MM socket, remove the two (2) existing bolts from the frame. Reinstall the bolts with the side plates. Level the side plate and fully tighten the existing bolts. Do this on both sides of the vehicle.

** Use Loctite® Red on all bolt threads and tighten all bolts to the appropriate torque.

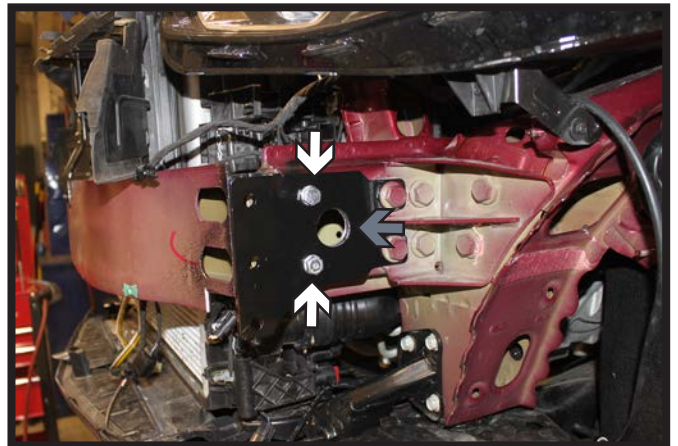

14. Using a 1-1/4" hole saw, drill the existing hole thru the frame (gray). Using a 3/8" drill bit, drill the two (2) side plate holes thru the frame (white). Install the 3/8" hardware and fully tighten. Do this on both sides of the vehicle.

** Use Loctite® Red on all bolt threads and tighten all bolts to the appropriate torque.

BX1726
2016-18 Chevy Malibu
(All Models)(No Active Shutters or E-Assist)
Installation Instructions

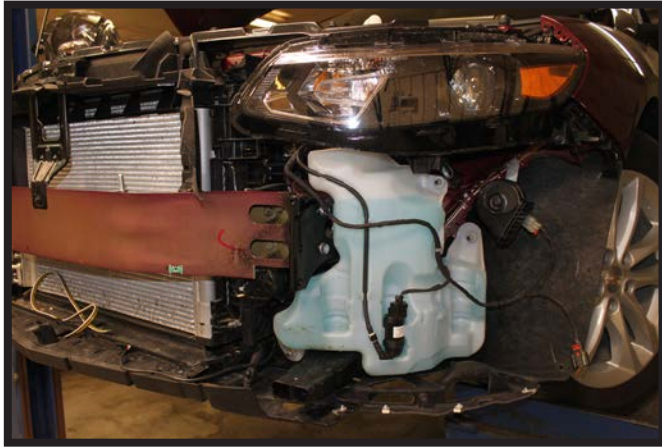

15. Reinstall the washer reservoir.

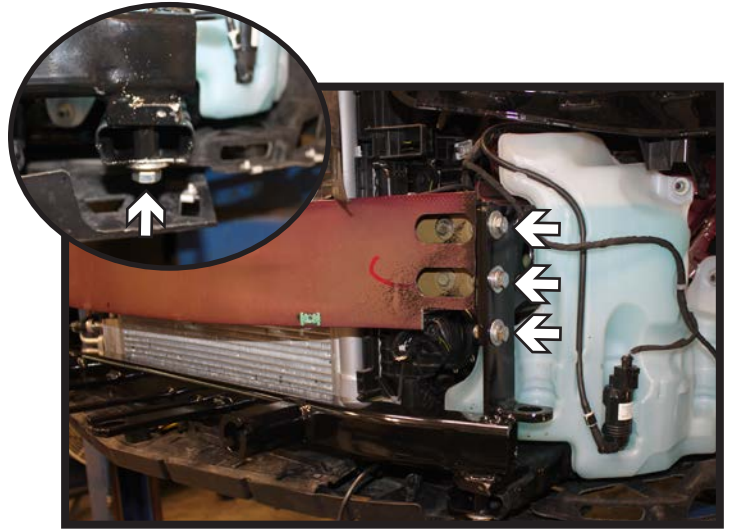

16. Pin the baseplate to the side plates with the 3/8" hardware (DO NOT tighten at this time). Install the spacer tube and 1/2" hardware into the extension on both sides of the vehicle and fully tighten.

After the 1/2" hardware is tightened, continue tightening the 3/8" hardware along the side plates.

** Use Loctite® Red on all bolt threads and tighten all bolts to the appropriate torque.

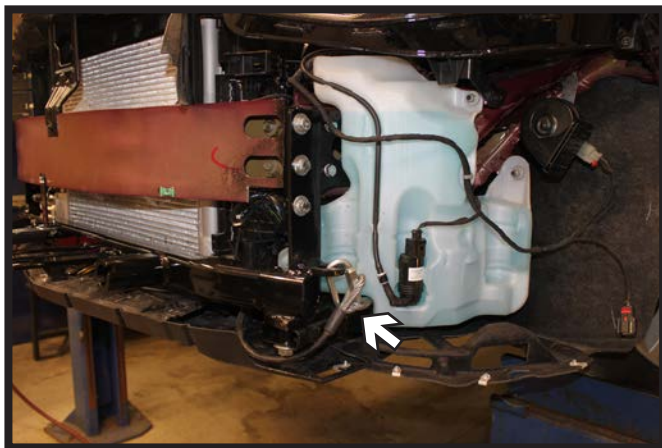

17. Attach the permanent baseplate safety cables to the provided convenience link on the baseplate. The photo above shows the recommended installation of the cables to frame of vehicle. Additional options may interfere with suggested mounting; in this case, secure the cables to a solid piece of the frame as described in the General Information sheet. Be sure the safety cables do not rub against any hoses or moving parts. Do this on **BOTH** sides of the vehicle.



18. **Optional Breakaway:** In the desired location, drill a 1/4" hole thru the bumper lip. Install the bracket to the bumper with the provided 1/4" hardware. Attache the breakaway to the bracket with the 1/4" hardware provided.

BX1726
2016-18 Chevy Malibu
(All Models)(No Active Shutters or E-Assist)
Installation Instructions



19. On the backside of the fascia trim the lip off so it sits flush to the face. Do this on both sides of the fascia.



20. Reinstall the air baffle, passenger side headlight and fascia.



General Information

1. **It is the owner's responsibility to inspect all towing equipment for cracked welds, missing or worn parts and loose bolts before each towing trip.** Be sure to use Loctite® Red on all bolts and tighten to the recommended specifications.
2. **It is the owner's responsibility to hook up all towing equipment per manufacturer's instructions/ recommendations.**
3. Remove the attachment tabs when not in use (if applicable).

Notice To Baseplate Installer

1. **It is YOUR responsibility to watch for:**

- Oil cooler and air conditioner lines
- Electrical wires and hoses
- Missing parts or attaching points on the frame

** If the baseplate is improperly installed and is against a wire or hose, it could cause fluid leaks or electrical shorts some time after the actual baseplate installation.

Permanent Baseplate Safety Cable Installation

Permanent baseplate safety cables are strongly recommended when towing a vehicle with a tow bar. The principle function of the permanent baseplate safety cables is to prevent the towed vehicle from breaking loose in the event the connection between the frame of the towed vehicle and the baseplate fails or becomes disconnected. The cables must be connected from the baseplate to the frame rail or cross member of the vehicle's frame. The illustrations below show the possible arrangements recommended by Blue Ox®. Each permanent baseplate safety cable must have an adequate weight rating for the towing system. The weight rating of the two (2) cables together will not qualify.

Do not mount the permanent baseplate safety cables against wires, hoses or brake lines.

These permanent baseplate safety cables should remain installed as long as the baseplate is installed on the vehicle. Permanent baseplate safety cables are to be used in conjunction with, and NOT a replacement for legally required safety cables attaching the towed vehicle to the towing vehicle.

Option #1

(Baseplates with Convenience Link Tabs)

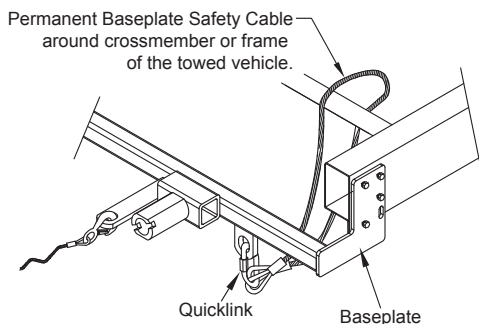

Option #2

(Baseplates with out Convenience Link Tabs)

