



BX1703

2012-18 Chevy Sonic (LS/LT/LTZ/RS)

Installation Instructions

Attachment Tab Height: 13-1/2"

Attachment Tab Width: 18"

Please read BOTH these Installation Instructions and the General Information sheet prior to installing or operating this equipment.

1. Blue Ox® towing products and accessories are intended to be installed by Blue Ox® Dealers who are familiar with our products and have the equipment and knowledge necessary to do "it work".
2. Many Blue Ox® baseplates are designed to use existing holes and hardware to mount the baseplate to the towed vehicle. Even though bolts are there, do not assume they are adequate for baseplate mounting. Always use the hardware supplied in the hardware kit and existing hardware as specified in the installation instructions.

Bolt Torque Specifications

Torque in Foot-Pounds for Inch Bolts

Bolt Size	Grade 5	Grade 8
1/4"	10	14
5/16"	19	29
3/8"	33	47
7/16"	54	78
1/2"	78	119
5/8"	154	230
3/4"	257	380

Bolt Torque Specifications

Torque in Foot-Pounds for Metric Bolts

Bolt Size	Grade 8.8	Grade 10.9
6MM	6	8
8MM	16	22
10MM	31	40
12MM	54	70
14MM	89	117
16MM	161	230
18MM	222	318



WARNING

Failure to read and follow these instructions could result in separation of the towed vehicle from the tow bar, causing property damage, loss of towed vehicle, personal injury or death.

BX1703
2012-18 Chevy Sonic (LS/LT/LTZ/RS)
Installation Instructions

Reference your vehicle owner's manual for manufacturer's towing specifications.

Instruction Notes: The fascia, steel fascia support and part of the belly pan are removed and reinstalled for the baseplate installation. Some drilling and trimming is required.

Place all components that are removed on a flat, sturdy surface. All items will be reinstalled unless otherwise noted after the baseplate is installed.

The dimensional variations between otherwise identical vehicles can be considerable. While the baseplate was designed for easy installation, it may be necessary to tailor the baseplate slightly to compensate for vehicle manufacturer's tolerances.

The BX8869 Tail Light Wiring Kit is recommended for this vehicle.

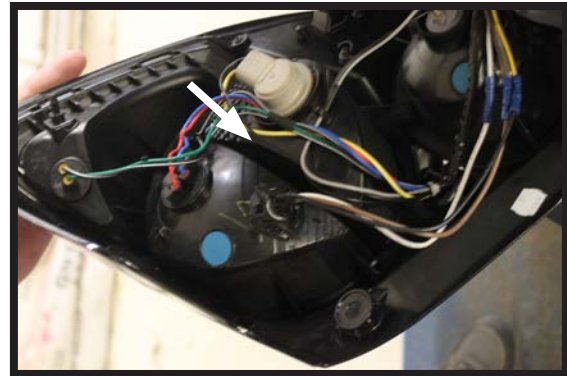
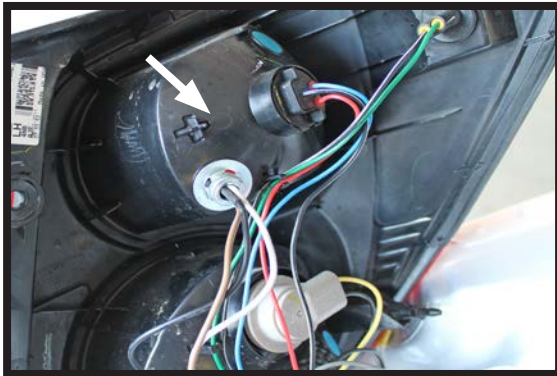

Drill a hole according to the tail
light wiring kit instructions.

NOTICE

- Handling of some cosmetic parts when installing this product may require the use of protective covers, rags, specialty tools, etc. to prevent damage.
- When using power drills be aware of the dangers of torque and drill bit length.
- When using a reciprocating saw be aware of objects behind the cutting surface.
- Use a good quality paint to spray cut edges of frame to prevent rusting.
- Be sure that **ALL** electrical connections are plugged in and accessories are functioning properly before reinstalling the fascia.
- The baseplate is computer tested to your vehicle's GVWR, exceeding this weight will void the manufacturer's warranty.
- Be sure to use a sufficient amount of Loctite® Red on all bolt threads before tightening. Tighten all bolts according to the torque chart provided.
- Dealer or installer be certain the user receives these instruction sheets.
- If the baseplate is in an accident, it must be replaced. **DO NOT** use it again! An accident can cause unseen damage and using it again could result in more damage or serious injury. **DO NOT** use the baseplate if it is damaged or missing parts.

BX1703
2012-18 Chevy Sonic (LS/LT/LTZ/RS)
Installation Instructions

Tools Required

- Large Vise Grip
- Flat Screwdriver
- Utility Knife
- Phillips Screwdriver
- Torque Wrench
- Drill
- Reciprocating Saw
- Tape Measure
- Loctite® RED
- 1/4" Drill Bit
- 13/32" Drill Bit
- 10MM Socket
- 13MM Socket
- 9/16" Socket
- T20 Torx

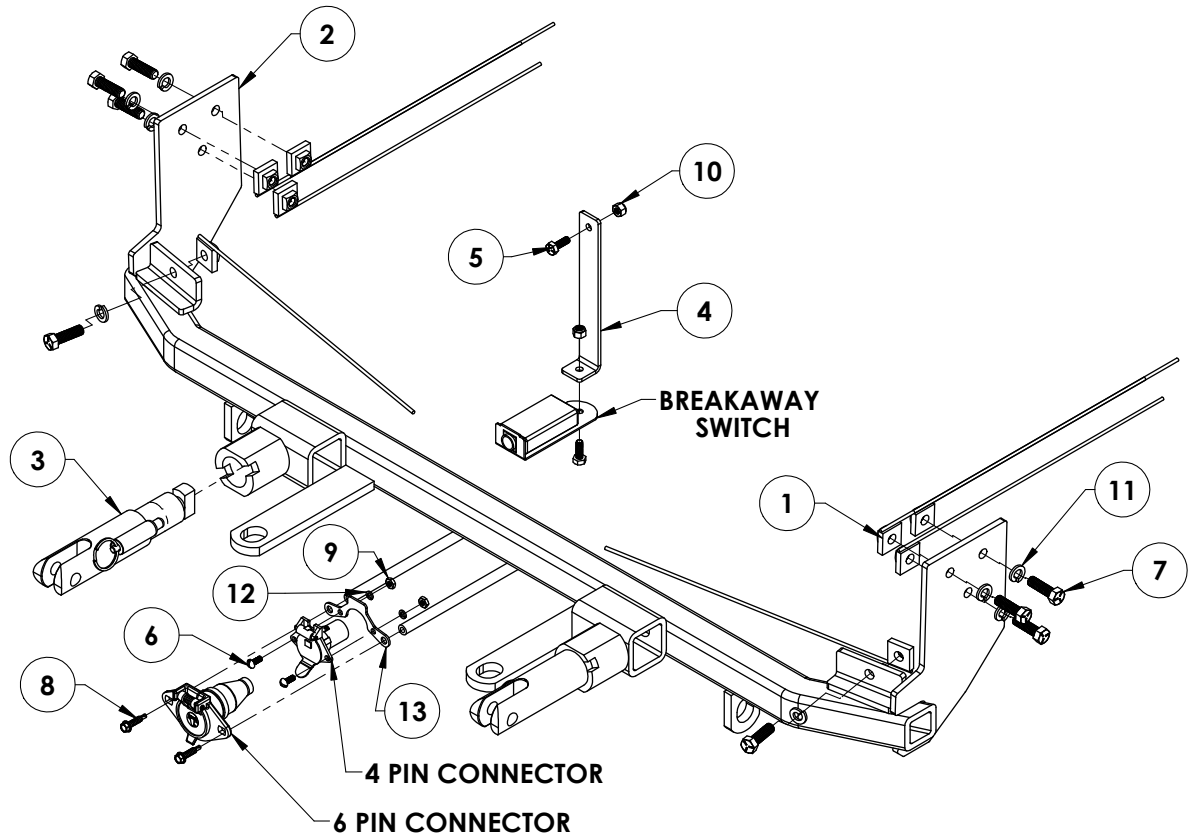

Item No.	Part No.	Description	Qty.
1.....	61-5208	3/8"-16 Nut Plate	8
2.....	61-7004	BX1703 Baseplate.....	1
3.....	62-3468	Attachment Tab with Hole.....	2
4.....	102-7282	Breakaway Bracket	1
5.....	201-0050	1/4"-20 x 3/4" Hex Head Bolt, Grade 5, ZP	2
6.....	201-0192	#10-32 1/2" Round Slotted Head Screw.....	2
7.....	201-0368	3/8"-16 x 1-1/4" Hex Head Bolt, Grade 5.....	8
8.....	201-0979	#12-14 x 1" Self Drilling Screw, ZP	2
9.....	202-0047	#10-32 Hex Nut	2
10.....	202-0102	1/4"-20 Hex Nylon Insert Nut, ZP	2
11.....	203-0010	3/8" Lock Washer, ZP	8
12.....	203-0054	#10 Lock Washer.....	2
13.....	299-0685	Electrical Bracket, ZP	1
14.....	226-0046(not shown)	Class III Safety Cables	2
15.....	229-0359(not shown)	3/8" Quicklink, ZP	2
16.....	290-0437(not shown)	Black Cap Plug Receiver.....	1

Important:

Use only genuine factory replacement parts on your baseplate. Do NOT substitute homemade or non-typical parts. If a bolt is lost or in need of replacement, for your safety and the preservation of your baseplate, be sure to use a replacement bolt of the same grade (In most cases it will be Grade 5, please reference the parts list above).

BX1703
2012-18 Chevy Sonic (LS/LT/LTZ/RS)
Installation Instructions

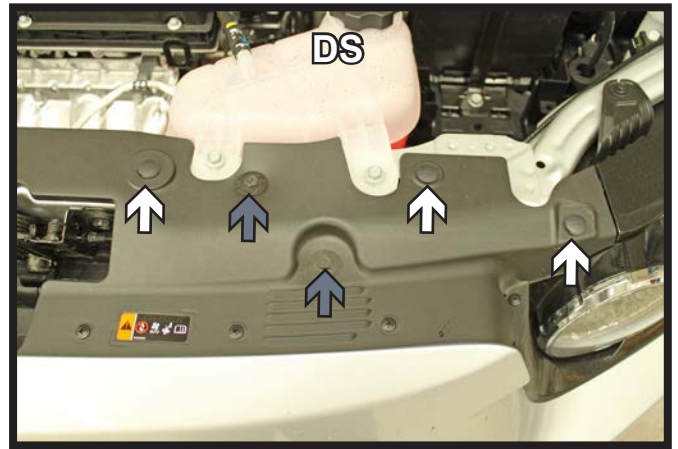
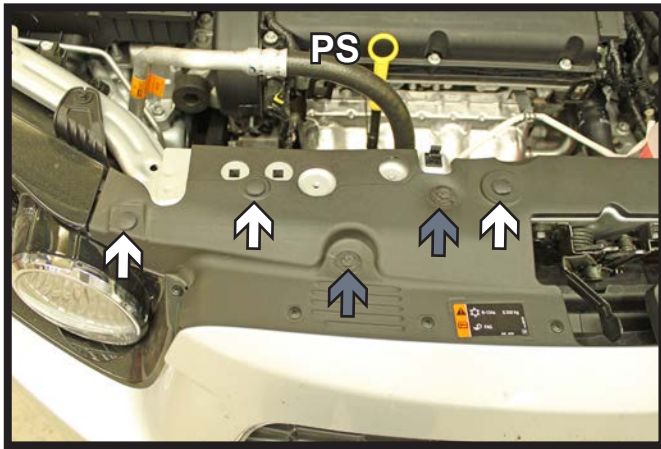

1. Remove the six (6) push pins from the top of the plastic radiator cover (white arrows). With 10MM socket, remove the four (4) bolts from the top of the plastic radiator cover (gray arrows).



2. In the wheel well, using T20 Torx, remove the four (4) screws. Do this to both sides of the vehicle.

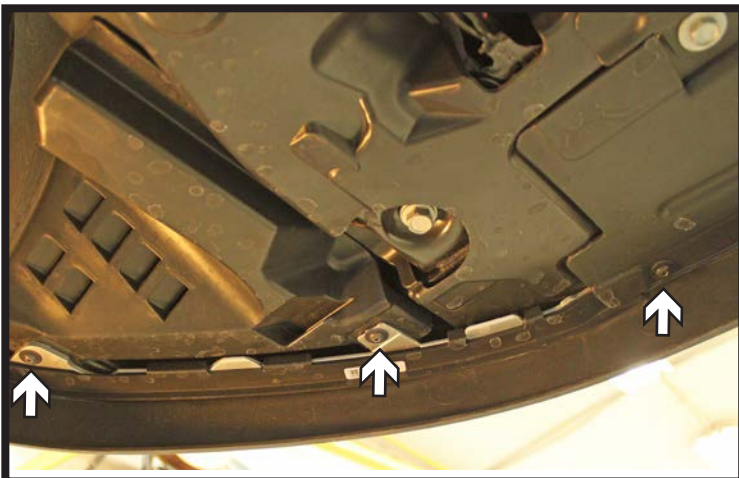

3. Using a T20 Torx, remove the six (6) screws from the underside of the fascia. There are three (3) on each side.

BX1703
2012-18 Chevy Sonic (LS/LT/LTZ/RS)
Installation Instructions



4. On the bellypan, remove the one (1) push pin (white arrow) and with a 13MM socket, remove the two (2) bolts (gray arrows).



5. Underneath the license plate, with T20 Torx, remove the one (1) screw. Remove the front portion of the belly pan.



6. Using a Phillips screwdriver, remove the two (2) screws that are now visible after the removal of the bellypan. There is one (1) on each side.

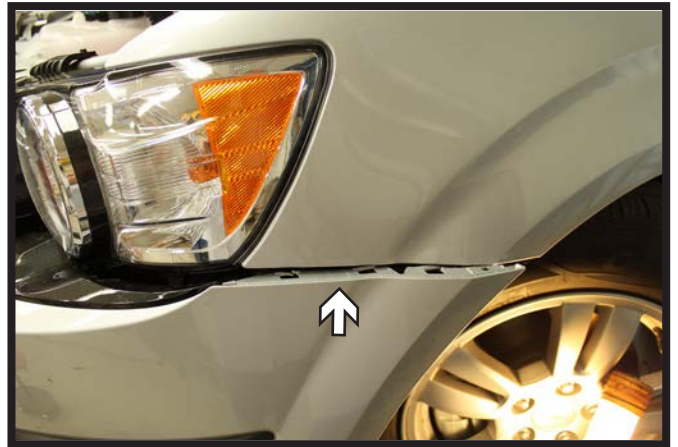

7. To remove the fascia, lift up and pull out at the fascia seam by the wheel wells. Disconnect any electrical connections and remove the fascia.

BX1703
2012-18 Chevy Sonic (LS/LT/LTZ/RS)
Installation Instructions

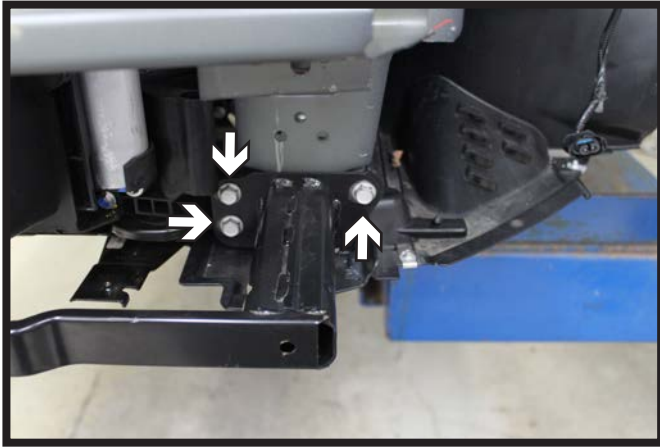

8. Using a 13MM socket, remove the three (3) bolts from the lower fascia support. Do this on both sides of the vehicle. Set the support aside.

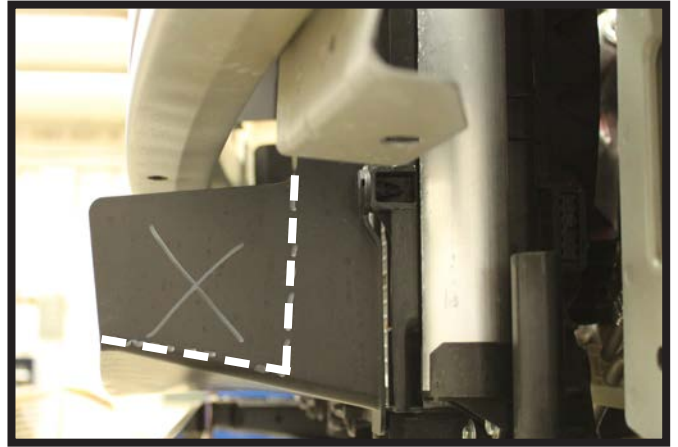

9. **Non-Turbo Vehicles:** Using a utility knife, trim the plastic shrouding as shown above. Do this on both sides of the vehicle.

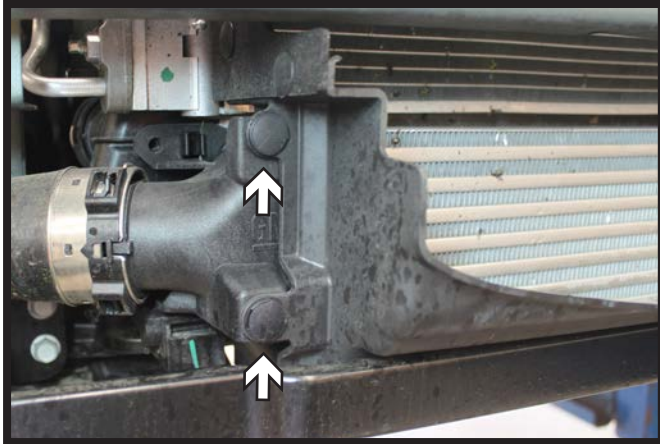

10. **RS-Models:** Remove the two (2) push pins from the plastic shroud. Do this on both sides of the vehicle. Set the shroud aside it will not be reinstalled.

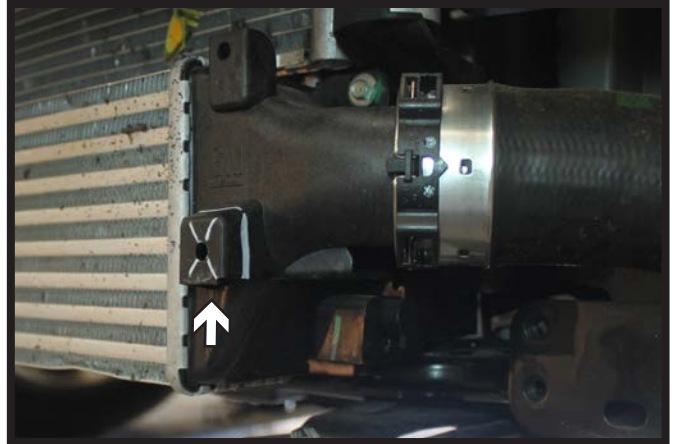

11. **RS-Models:** Trim off the lower plastic shrouding mount as shown above for baseplate clearance. Do this on both sides of the vehicle.

BX1703
2012-18 Chevy Sonic (LS/LT/LTZ/RS)
Installation Instructions



12. With a reciprocating saw, notch over 1" from the edge and upward to just slightly under the bumper. Do this on **BOTH** sides of the vehicle.

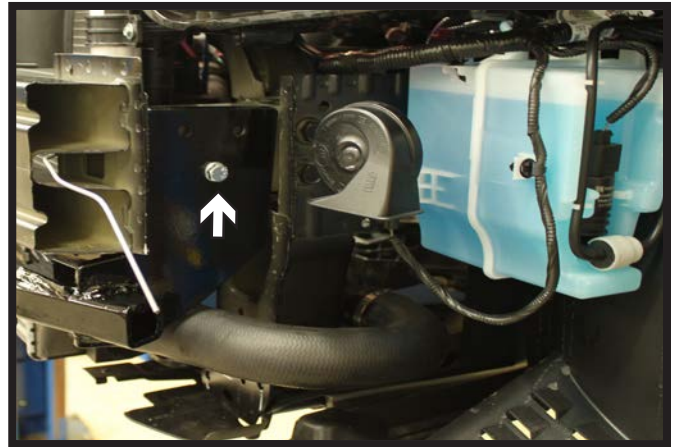

13. Slide baseplate up onto the frame of the vehicle. The baseplate support tabs on the front of the baseplate should be directly under the bumper. Be sure the baseplate is level. Clamp securely in place.

Using a 13/32" drill bit, drill the bottom hole and insert a 3/8"-16 x 1-1/4" bolt with lock washer and 3/8"-16 nut plate. Verify the baseplate is still level and tighten all fasteners securely. Do this on **BOTH** sides of the vehicle.

**** Use Loctite® Red on all bolt threads and tighten all bolts to the appropriate torque.**

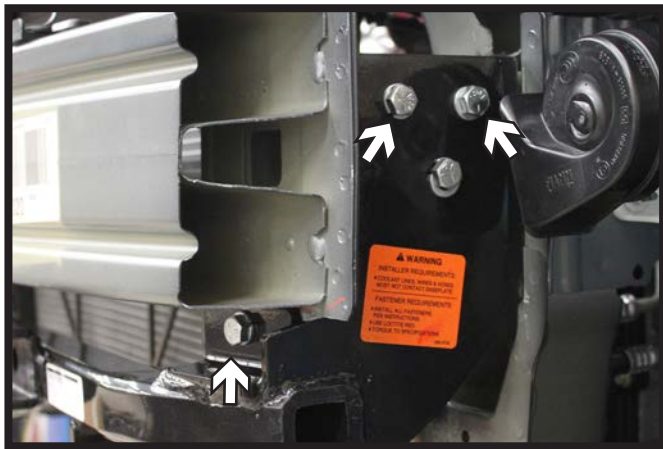

14. Drill the remaining two (2) holes at the top of the endplates and the front hole thru the frame. Install the 3/8" hardware and fully tighten all fasteners. Do this on **BOTH** sides of the vehicle.

Note: On the driver side the horn bracket may have to be loosened or bent to accommodate drilling.

**** Use Loctite® Red on all bolt threads and tighten all bolts to the appropriate torque.**

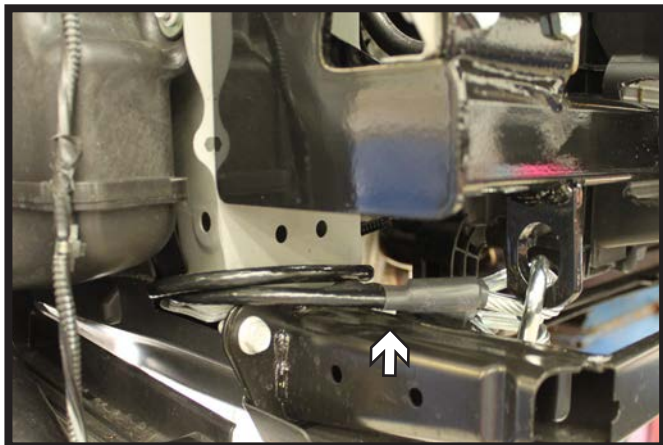

15. Attach the permanent baseplate safety cables to the provided convenience link on the baseplate. The photo above shows the recommended installation of the cables to frame of vehicle. Additional options may interfere with suggested mounting; in this case, secure the cables to a solid piece of the frame as described in the General Instructions. Be sure the safety cables do not rub against any hoses or moving parts. Do this on **BOTH** sides of the vehicle.

BX1703
2012-18 Chevy Sonic (LS/LT/LTZ/RS)
Installation Instructions

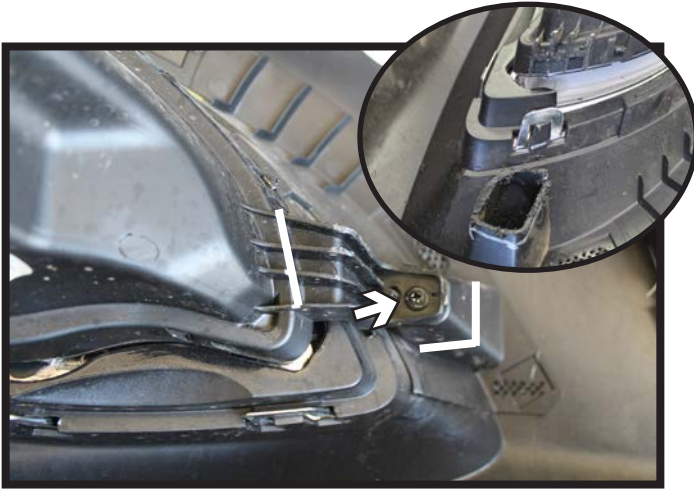

16. **RS Models:** Remove the screw on the lower foglight housing bracket. Trim off the bracket from the fog light housing and the lower mounting surface for baseplate clearance. Do this on both sides of the vehicle.



17. Hold the fascia as close to its original position, mark and trim the fascia around the convenience links and attachment tabs.

Reinstall the lower fascia support, front fascia and belly pan.

Note: The license plate bracket may need to be raised to clear electrical rods.



General Information

1. It is the owner's responsibility to inspect all towing equipment for cracked welds, missing or worn parts and loose bolts before each towing trip. Be sure to use Loctite® Red on all bolts and tighten to the recommended specifications.
2. It is the owner's responsibility to hook up all towing equipment per manufacturer's instructions/ recommendations.
3. Remove the attachment tabs when not in use (if applicable).

Notice To Baseplate Installer

1. It is YOUR responsibility to watch for:

- Oil cooler and air conditioner lines
- Electrical wires and hoses
- Missing parts or attaching points on the frame

** If the baseplate is improperly installed and is against a wire or hose, it could cause fluid leaks or electrical shorts some time after the actual baseplate installation.

Permanent Baseplate Safety Cable Installation

Permanent baseplate safety cables are strongly recommended when towing a vehicle with a tow bar. The principle function of the permanent baseplate safety cables is to prevent the towed vehicle from breaking loose in the event the connection between the frame of the towed vehicle and the baseplate fails or becomes disconnected. The cables must be connected from the baseplate to the frame rail or cross member of the vehicle's frame. The illustrations below show the possible arrangements recommended by Blue Ox®. Each permanent baseplate safety cable must have an adequate weight rating for the towing system. The weight rating of the two (2) cables together will not qualify.

Do not mount the permanent baseplate safety cables against wires, hoses or brake lines.

These permanent baseplate safety cables should remain installed as long as the baseplate is installed on the vehicle. Permanent baseplate safety cables are to be used in conjunction with, and NOT a replacement for legally required safety cables attaching the towed vehicle to the towing vehicle.

OPTION #1

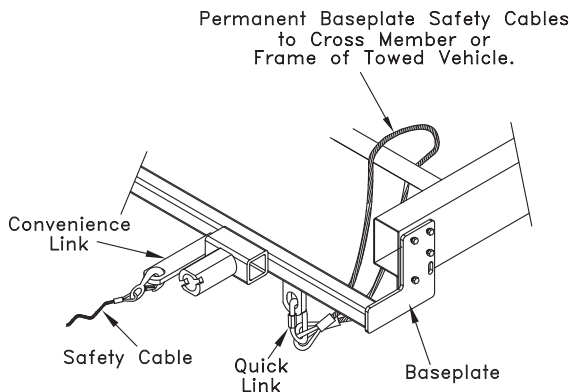

OPTION #2

