



BX1518

2016-18 Buick Envision (Includes ACC) Installation Instructions

Attachment Tab Height: 17-1/2"

Attachment Tab Width: 24"

Please read BOTH these Installation Instructions and the General Information sheet prior to installing or operating this equipment.

1. Blue Ox® towing products and accessories are intended to be installed by Blue Ox® Dealers who are familiar with our products and have the equipment and knowledge necessary to do "it work".
2. Many Blue Ox® baseplates are designed to use existing holes and hardware to mount the baseplate to the towed vehicle. Even though bolts are there, do not assume they are adequate for baseplate mounting. Always use the hardware supplied in the hardware kit and existing hardware as specified in the installation instructions.

| Bolt Torque Specifications | | |
|--------------------------------------|----------------|----------------|
| Torque in Foot-Pounds for Inch Bolts | | |
| Bolt Size | Grade 5 | Grade 8 |
| 1/4" | 10 | 14 |
| 5/16" | 19 | 29 |
| 3/8" | 33 | 47 |
| 7/16" | 54 | 78 |
| 1/2" | 78 | 119 |
| 5/8" | 154 | 230 |
| 3/4" | 257 | 380 |



| Bolt Torque Specifications | | |
|--|------------------|-------------------|
| Torque in Foot-Pounds for Metric Bolts | | |
| Bolt Size | Grade 8.8 | Grade 10.9 |
| 6MM | 6 | 8 |
| 8MM | 16 | 22 |
| 10MM | 31 | 40 |
| 12MM | 54 | 70 |
| 14MM | 89 | 117 |
| 16MM | 161 | 230 |
| 18MM | 222 | 318 |

Reference your vehicle owner's manual for manufacturer's towing specifications.

WARNING

Failure to read and follow these instructions could result in separation of the towed vehicle from the tow bar, causing property damage, loss of towed vehicle, personal injury or death.

BX1518
2016-18 Buick Envision (Includes ACC)
Installation Instructions

Instruction Notes: The fascia cover and fascia are removed and reinstalled for the baseplate installation. Some drilling and trimming is required.

Place all components that are removed on a flat, sturdy surface. All items will be reinstalled unless otherwise noted after the baseplate is installed.

The dimensional variations between otherwise identical vehicles can be considerable. While the baseplate was designed for easy installation, it may be necessary to tailor the baseplate slightly to compensate for vehicle manufacturer's tolerances.

The BX8848 4-Diode Wiring Kit is recommended for this vehicle.

NOTICE

- Handling of some cosmetic parts when installing this product may require the use of protective covers, rags, specialty tools, etc. to prevent damage.
- When using power drills be aware of the dangers of torque and drill bit length.
- When using a reciprocating saw be aware of objects behind the cutting surface.
- Use a good quality paint to spray cut edges of frame to prevent rusting.
- Be sure that **ALL** electrical connections are plugged in and accessories are functioning properly before reinstalling the fascia.
- The baseplate is computer tested to your vehicle's GVWR, exceeding this weight will void the manufacturer's warranty.
- Be sure to use a sufficient amount of Loctite® Red on all bolt threads before tightening. Tighten all bolts according to the torque chart provided unless specified.
- Dealer or installer be certain the user receives these instruction sheets.
- If the baseplate is in an accident, it must be replaced. **DO NOT** use it again! An accident can cause unseen damage and using it again could result in more damage or serious injury. **DO NOT** use the baseplate if it is damaged or missing parts.

BX1518

2016-18 Buick Envision (Includes ACC)

Installation Instructions

Tools Required

Large Vise Grip
 Flat Screwdriver
 Utility Knife
 Torque Wrench
 Drill
 Reciprocating Saw
 Tape Measure
 Loctite® RED
 3/8" Drill Bit
 7MM Socket
 7/16" Socket
 7/16" Wrench
 9/16" Socket
 9/16" Wrench
 T15 Torx
 T25 Torx
 5/16" Nut Driver

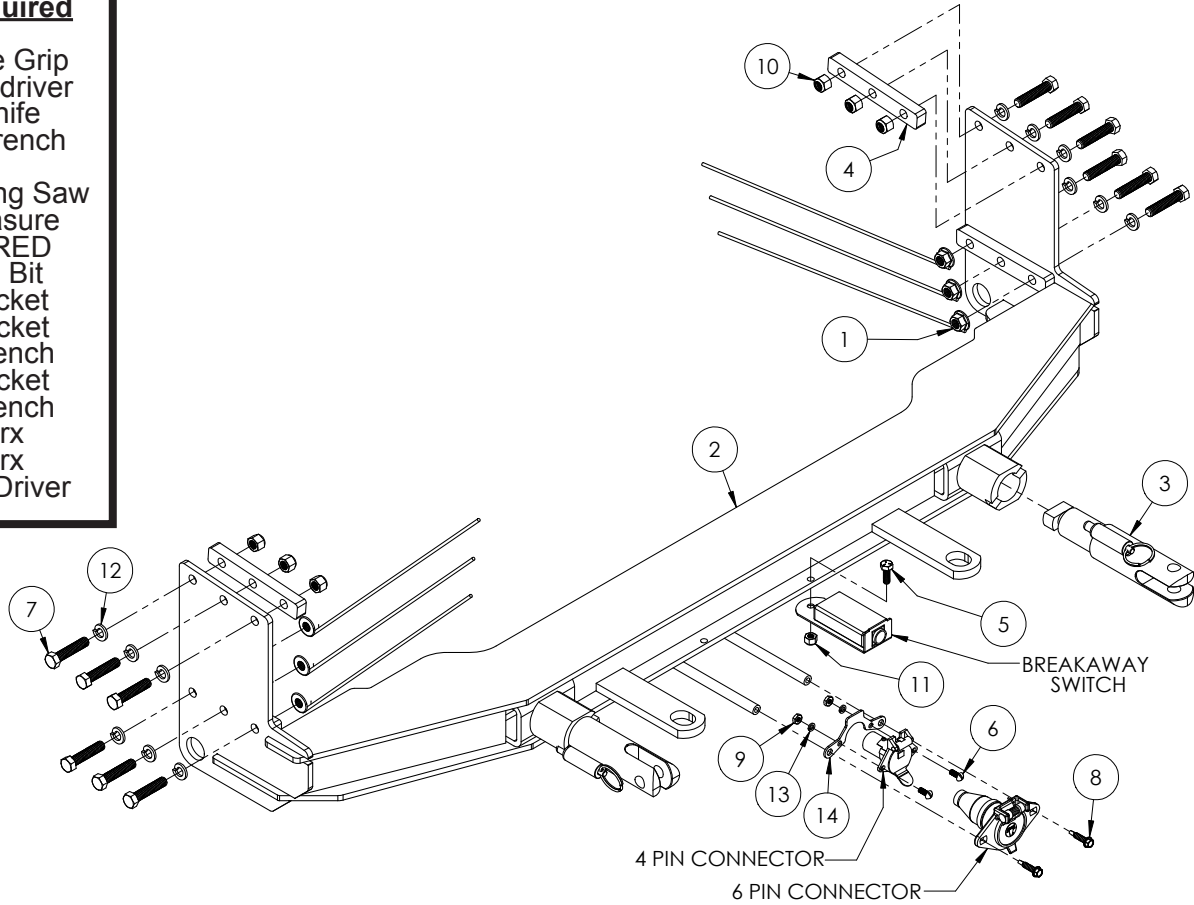

| Item No. | Part No. | Description | Qty. |
|----------|---------------------------|---|------|
| 1..... | 61-4978 | 3/8" Whiz Nut w/ 14" Wire | 6 |
| 2..... | 61-7767 | BX1518 Baseplate..... | 1 |
| 3..... | 62-3468 | Attachment Tab Assembly with Hole | 2 |
| 4..... | 102-7697 | Spacer Plate..... | 2 |
| 5..... | 201-0050 | 1/4"-20 x 3/4" Hex Head Bolt, Grade 5, ZP | 1 |
| 6..... | 201-0192 | #10-32 1/2" Round Slotted Head Screw..... | 2 |
| 7..... | 201-0404 | 3/8"-16 x 1-3/4" Hex Head Bolt, Grade 5, ZP | 12 |
| 8..... | 201-0979 | #12-14 x 1" Self Drilling Screw, ZP..... | 2 |
| 9..... | 202-0047 | #10-32 Hex Nut | 2 |
| 10..... | 202-0090 | 3/8"-16 Hex Nylon Insert Lock Nut, ZP..... | 6 |
| 11..... | 202-0102 | 1/4"-20 Hex Nylon Nut, ZP | 1 |
| 12..... | 203-0010 | 3/8" Lock Washer, ZP | 12 |
| 13..... | 203-0054 | #10 Lock Washer, ZP | 2 |
| 14..... | 299-0685 | 4-Way Bracket..... | 1 |
| 15..... | 226-0049(not shown) | Class IV Safety Cables..... | 2 |
| 16..... | 229-0512(not shown) | 1/2" Quicklink, ZP | 2 |
| 17..... | 290-0437(not shown) | Black Cap Plug Receiver..... | 2 |

Important:

Use only genuine factory replacement parts on your baseplate. Do **NOT** substitute homemade or non-typical parts. If a bolt is lost or in need of replacement, for your safety and the preservation of your baseplate, be sure to use a replacement bolt of the same grade (In most cases it will be Grade 5, please reference the parts list above). Replacement parts may be ordered through your nearest Blue Ox® Dealer or Distributor. Failing to follow and/or altering these installation instructions in either installation or required equipment will void the manufacturer's warranty. Towing behind a non-motorized vehicle will void the warranty.

BX1518
2016-18 Buick Envision (Includes ACC)
Installation Instructions

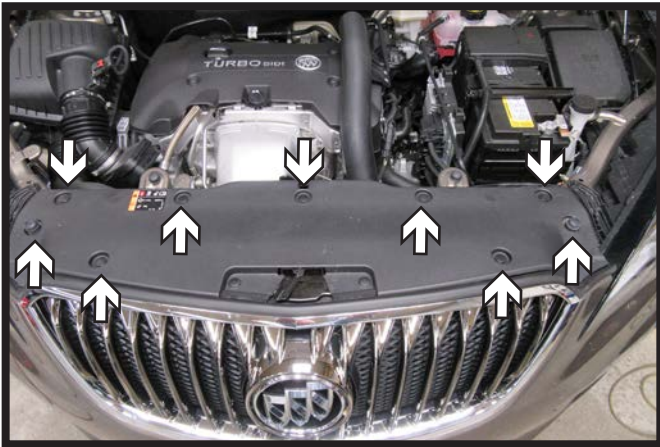

1. Remove the nine (9) push pins from the fascia cover and set aside.

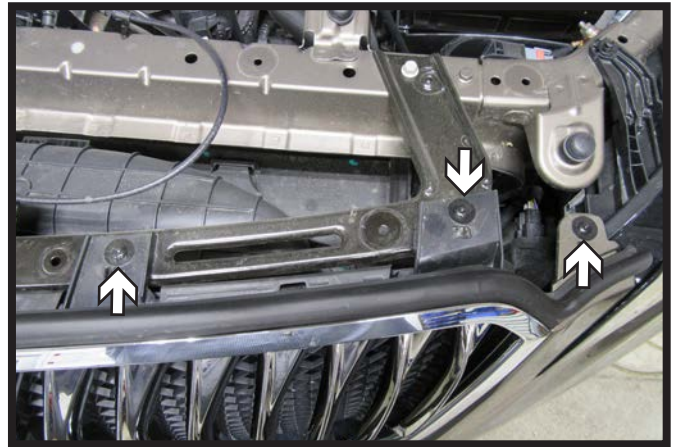

2. Using a T15 Torx, remove the six (6) screws from the top edge of the fascia. There are three (3) on each side.

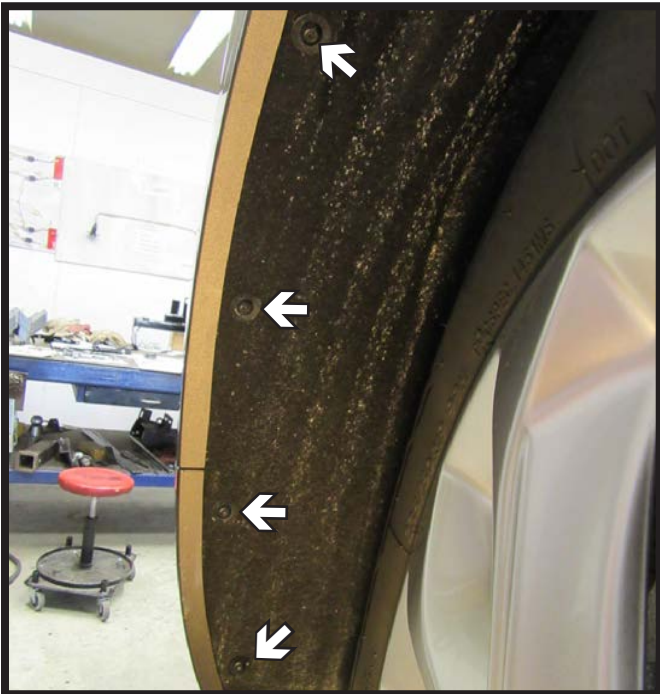

3. Using a T15 Torx socket, remove the four (4) screws from the wheel well liner. Do this on both sides of the vehicle.



4. Pull back the wheel well liner. Using a 10MM socket remove the bolt (gray arrow). Then release the clips from the fender flare (left, white arrow). Pull straight up on the flare to release the bottom and then out away from the vehicle. Do this on both sides of the vehicle.

BX1518
2016-18 Buick Envision (Includes ACC)
Installation Instructions

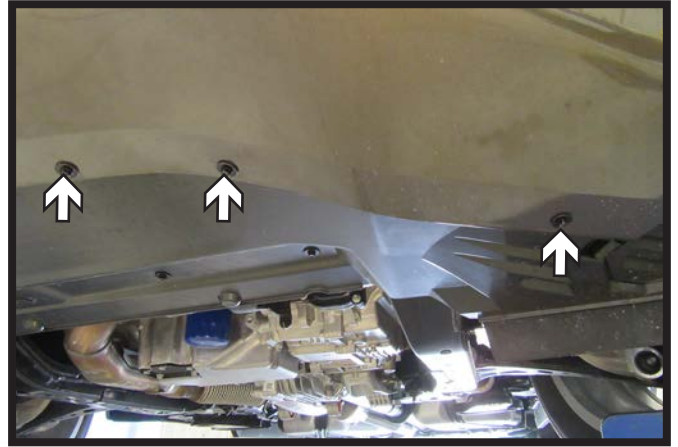
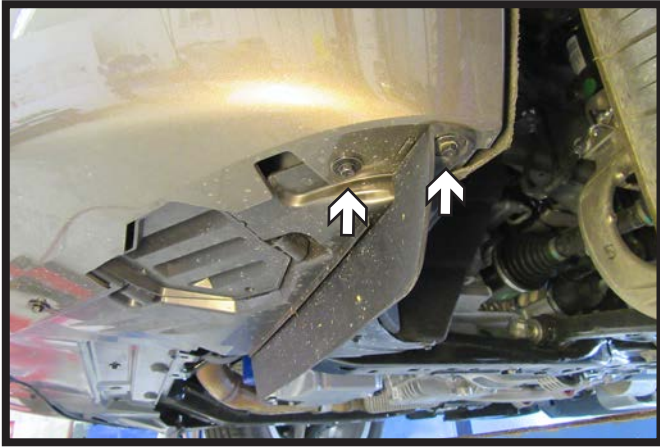

5. Using a 7MM socket, remove the ten (10) screws from the underside of the fascia. There are five (5) on each side.

Pull the corners of the fascia away from the vehicle disconnecting any electrical connections and set the fascia aside.



6. Using a 25 Torx socket, remove the four (4) screws from the lower grille and set it aside. It will not be reinstalled.

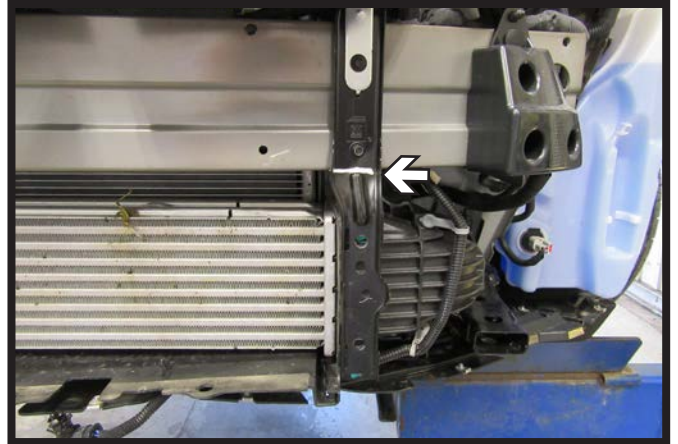

7. Using a reciprocating saw, trim the bracket flush with the bottom side of the bumper. Do this on both sides of the vehicle.

BX1518
2016-18 Buick Envision (Includes ACC)
Installation Instructions

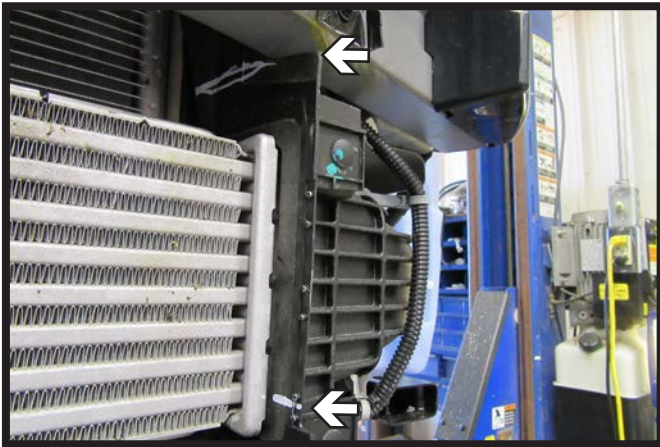

8. Trim the plastic shielding off flush under the bumper and across the bottom as shown. Do this on both sides of the vehicle,

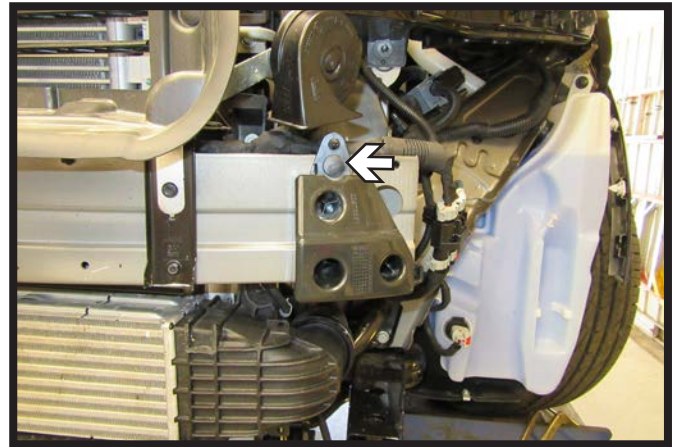

9. Remove the push pin from plastic reinforcement on the bumper face and set aside. Do this on both sides of the vehicle.



10. Using a reciprocating saw, trim the end of the bumper flush with the outside of the frame. Do this on both sides of the vehicle.

BX1518
2016-18 Buick Envision (Includes ACC)
Installation Instructions



11. Flush the baseplate with the top and front lips of the frame (gray). Level and clamp into position.

Using a 3/8" drill bit, drill the bottom holes on each side of the baseplate thru the frame. Install the 3/8" hardware and fully tighten the bolts.

Once the first bolts are fully tightened, go back and drill the a remaining holes on each side of the baseplate thru the frame. Install the remaining 3/8" hardware and fully tighten all bolts.

** Use Loctite® Red on all bolt threads and tighten all bolts to the appropriate torque.

13. **Optional Breakaway:** Bolt the breakaway to the baseplate bracket with the supplied 1/4" hardware.



12. Attach the permanent baseplate safety cables to the provided convenience link on the baseplate. The photo above shows the recommended installation of the cables to frame of vehicle. Additional options may interfere with suggested mounting; in this case, secure the cables to a solid piece of the frame as described in the General Information sheet. Be sure the safety cables do not rub against any hoses or moving parts. Do this on **BOTH** sides of the vehicle.



14. On the backside of the fascia, trim the lower tab back flush with the lip. Do this on both sides of the fascia.

BX1518
2016-18 Buick Envision (Includes ACC)
Installation Instructions



15. Hold the fascia as close to its original position, mark and trim the fascia around the convenience links and attachment tabs. Reinstall the fascia and fascia cover.



General Information

1. **It is the owner's responsibility to inspect all towing equipment for cracked welds, missing or worn parts and loose bolts before each towing trip.** Be sure to use Loctite® Red on all bolts and tighten to the recommended specifications.
2. **It is the owner's responsibility to hook up all towing equipment per manufacturer's instructions/ recommendations.**
3. Remove the attachment tabs when not in use (if applicable).

Notice To Baseplate Installer

1. It is YOUR responsibility to watch for:

- Oil cooler and air conditioner lines
- Electrical wires and hoses
- Missing parts or attaching points on the frame

** If the baseplate is improperly installed and is against a wire or hose, it could cause fluid leaks or electrical shorts some time after the actual baseplate installation.

Permanent Baseplate Safety Cable Installation

Permanent baseplate safety cables are strongly recommended when towing a vehicle with a tow bar. The principle function of the permanent baseplate safety cables is to prevent the towed vehicle from breaking loose in the event the connection between the frame of the towed vehicle and the baseplate fails or becomes disconnected. The cables must be connected from the baseplate to the frame rail or cross member of the vehicle's frame. The illustrations below show the possible arrangements recommended by Blue Ox®. Each permanent baseplate safety cable must have an adequate weight rating for the towing system. The weight rating of the two (2) cables together will not qualify.

Do not mount the permanent baseplate safety cables against wires, hoses or brake lines.

These permanent baseplate safety cables should remain installed as long as the baseplate is installed on the vehicle. Permanent baseplate safety cables are to be used in conjunction with, and NOT a replacement for legally required safety cables attaching the towed vehicle to the towing vehicle.

Option #1

(Baseplates with Convenience Link Tabs)

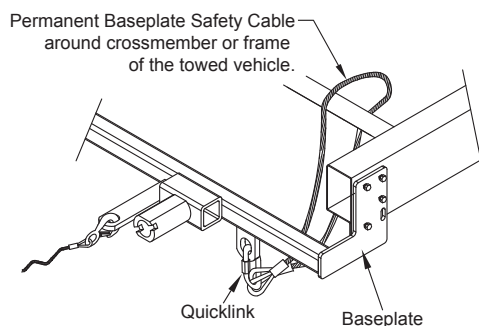

Option #2

(Baseplates with out Convenience Link Tabs)

