



BX1115

1999-2003 Jeep Grand Cherokee Installation Instructions

Attachment Tab Height: 17"

Attachment Tab Width: 20"

Please read BOTH these Installation Instructions and the General Information sheet prior to installing or operating this equipment.

1. Blue Ox® towing products and accessories are intended to be installed by Blue Ox® Dealers who are familiar with our products and have the equipment and knowledge necessary to do "it work".
2. Many Blue Ox® baseplates are designed to use existing holes and hardware to mount the baseplate to the towed vehicle. Even though bolts are there, do not assume they are adequate for baseplate mounting. Always use the hardware supplied in the hardware kit and existing hardware as specified in the installation instructions.

Bolt Torque Specifications		
Torque in Foot-Pounds for Inch Bolts		
Bolt Size	Grade 5	Grade 8
1/4"	10	14
5/16"	19	29
3/8"	33	47
7/16"	54	78
1/2"	78	119
5/8"	154	230
3/4"	257	380

Bolt Torque Specifications		
Torque in Foot-Pounds for Metric Bolts		
Bolt Size	Grade 8.8	Grade 10.9
6MM	6	8
8MM	16	22
10MM	31	40
12MM	54	70
14MM	89	117
16MM	161	230
18MM	222	318

Reference your vehicle owner's manual for manufacturer's towing specifications.

WARNING

Failure to read and follow these instructions could result in separation of the towed vehicle from the tow bar, causing property damage, loss of towed vehicle, personal injury or death.

BX1115
1999-2003 Jeep Grand Cherokee
Installation Instructions

Instruction Notes: The fascia is removed and reinstalled for the baseplate installation. Some drilling and trimming is required.

Place all components that are removed on a flat, sturdy surface. All items will be reinstalled unless otherwise noted after the baseplate is installed.

The dimensional variations between otherwise identical vehicles can be considerable. While the baseplate was designed for easy installation, it may be necessary to tailor the baseplate slightly to compensate for vehicle manufacturer's tolerances.

The BX8869 Tail Light Wiring Kit is recommended for this vehicle.

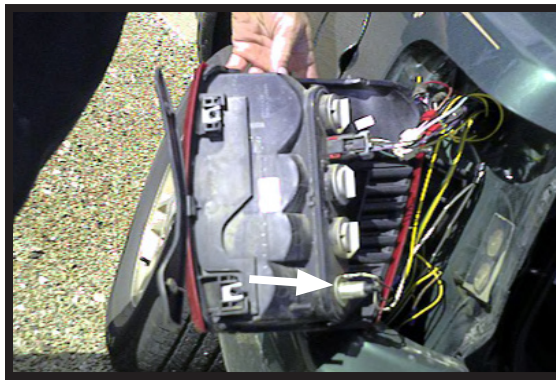

Drill a hole according to the tail
light wiring kit instructions.

NOTICE

- Handling of some cosmetic parts when installing this product may require the use of protective covers, rags, specialty tools, etc. to prevent damage.
- When using power drills be aware of the dangers of torque and drill bit length.
- When using a reciprocating saw be aware of objects behind the cutting surface.
- Use a good quality paint to spray cut edges of frame to prevent rusting.
- Be sure that **ALL** electrical connections are plugged in and accessories are functioning properly before reinstalling the fascia.
- The baseplate is computer tested to your vehicle's GVWR, exceeding this weight will void the manufacturer's warranty.
- Be sure to use a sufficient amount of Loctite® Red on all bolt threads before tightening. Tighten all bolts according to the torque chart provided unless specified.
- Dealer or installer be certain the user receives these instruction sheets.
- If the baseplate is in an accident, it must be replaced. **DO NOT** use it again! An accident can cause unseen damage and using it again could result in more damage or serious injury. **DO NOT** use the baseplate if it is damaged or missing parts.

BX1115

1999-2003 Jeep Grand Cherokee

Installation Instructions

Tools Required

Phillips Screwdriver
 Torque Wrench
 Rivet Gun
 Loctite® RED
 16MM Wrench
 17MM Wrench
 18MM Wrench
 3/4" Wrench

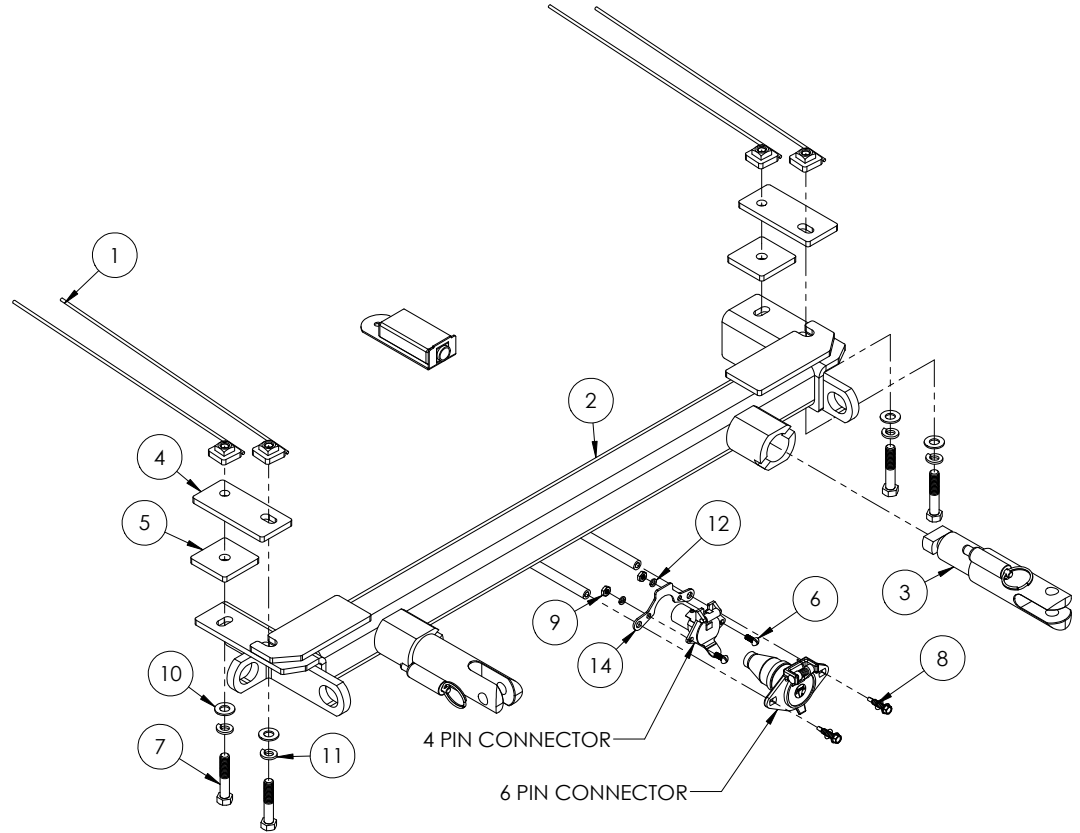

Parts List

Ref. No.	Qty.	Part #	Description
1	4	61-5208	Weldment, 3/8" Nutplate, with Wire
2	1	61-5295	Weldment, Baseplate, BX1115
3	2	62-3468	Removable Tabs, SF/SB
4	2	102-5597	Weldment, Side Plate Support
5	2	102-5598	Rear Spacer
6	2	201-0192	#10-32 x 1/2" Slotted Screw
7	4	201-0444	3/8-16 x 2" Hex Bolt, Grd. 5
8	2	201-0979	#12-14 x 1" Self Drilling Screw, ZP
9	2	202-0047	#10 Hex Nut
10	4	203-0003	3/8" Flat Washer
11	4	203-0010	3/8" Lock Washer
12	2	203-0054	#10 Lock Washer
13	6	229-0536	6.3MM Plastic Rivet (Not Shown)
14	1	299-0685	4-Way Bracket
	2	226-0046	Baseplate Safety Cable, 36" CL III (Not Shown)
	2	229-0359	Quicklink 3/8, ZP (Not Shown)
	2	290-0437	Receiver, Cap Plug (Blk) (Not Shown)

Important:

Use only genuine factory replacement parts on your baseplate. Do **NOT** substitute homemade or non-typical parts. If a bolt is lost or in need of replacement, for your safety and the preservation of your baseplate, be sure to use a replacement bolt of the same grade (In most cases it will be Grade 5, please reference the parts list above). Replacement parts may be ordered through your nearest Blue Ox® Dealer or Distributor. Failing to follow and/or altering these installation instructions in either installation or required equipment will void the manufacturer's warranty. Towing behind a non-motorized vehicle will void the warranty.

BX1115
1999-2003 Jeep Grand Cherokee
Installation Instructions

Installation Instructions:

1. Remove the three plastic rivets fastening the fender well molding to the bumper molding. Pull back the plastic molding to the bumper molding and remove the hex head bolts connecting the quarter panels and the bumper molding.
2. Remove the pushpins from the bottom of the bumper molding. Also remove the Phillips screws on the face and top of the chrome grille (four on the top and three on the face of the grille). Pull forward to remove the bumper. Set the bumper and the bolts aside to be reinstalled later.
3. The outside holes for the baseplate will line up to existing holes in the frame. Place 1/4" support inside the frame. Start a 3/8" bolt and nut washers for the forward holes. Be sure to apply LOCTITE Red.
4. Now place the 2" square spacer between the frame and the baseplate for the rear holes. Use the 3/8" hardware same as step 4. Once all bolts have been started torque each one according to the Torque Specification Chart in the General Instructions Sheet.
5. Replace the bumper molding. Enclosed in the bolt bag are plastic rivets to replace the ones that were removed in the first steps.
6. Install the tow bar and safety cables according to the instructions included in their packages. Do not substitute other devices if the tow bar pin and clip are lost.



General Information

1. It is the owner's responsibility to inspect all towing equipment for cracked welds, missing or worn parts and loose bolts before each towing trip. Be sure to use Loctite® Red on all bolts and tighten to the recommended specifications.
2. It is the owner's responsibility to hook up all towing equipment per manufacturer's instructions/recommendations.
3. Remove the attachment tabs when not in use (if applicable).

Notice To Baseplate Installer

1. It is YOUR responsibility to watch for:

- Oil cooler and air conditioner lines
- Electrical wires and hoses
- Missing parts or attaching points on the frame

** If the baseplate is improperly installed and is against a wire or hose, it could cause fluid leaks or electrical shorts some time after the actual baseplate installation.

Permanent Baseplate Safety Cable Installation

Permanent baseplate safety cables are strongly recommended when towing a vehicle with a tow bar. The principle function of the permanent baseplate safety cables is to prevent the towed vehicle from breaking loose in the event the connection between the frame of the towed vehicle and the baseplate fails or becomes disconnected. The cables must be connected from the baseplate to the frame rail or cross member of the vehicle's frame. The illustrations below show the possible arrangements recommended by Blue Ox®. Each permanent baseplate safety cable must have an adequate weight rating for the towing system. The weight rating of the two (2) cables together will not qualify.

Do not mount the permanent baseplate safety cables against wires, hoses or brake lines.

These permanent baseplate safety cables should remain installed as long as the baseplate is installed on the vehicle. Permanent baseplate safety cables are to be used in conjunction with, and NOT a replacement for legally required safety cables attaching the towed vehicle to the towing vehicle.

Option #1

(Baseplates with Convenience Link Tabs)

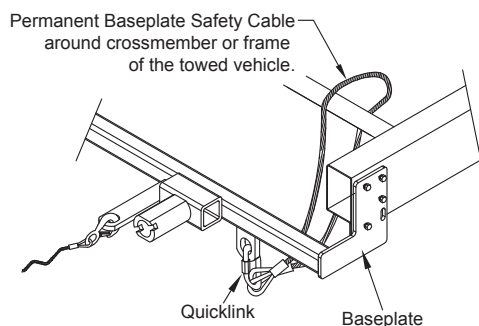

Option #2

(Baseplates with out Convenience Link Tabs)

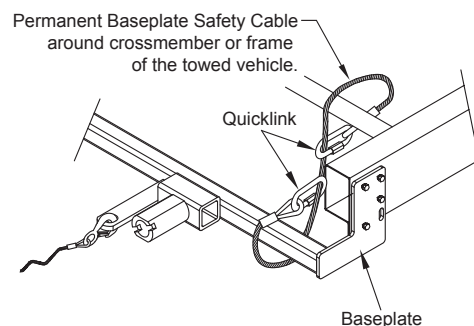

Rely only on high-grade trailer hitches and towing on our virtual shelves.