



BLOX Racing [Subfare Hard Collar Kit](#)
PN: BXSS-20602

APPLICATIONS

- 1992-1995 HONDA CIVIC
- 1993-1997 HONDA DEL SOL
- 1994-2001 ACURA INTEGRA

BEFORE INSTALLING PRODUCT, PLEASE READ INSTALLATION GUIDE FIRST. IF YOU HAVE ANY QUESTIONS OR CONCERNS, PLEASE REFERENCE THE VEHICLE'S FACTORY SERVICE MANUAL OR CONTACT AN EXPERIENCED MECHANIC OR TECHNICIAN.

IMPORTANT NOTES

- **DURING INSTALLATION, DO NOT USE IMPACT TOOLS. ONLY USE HAND TOOLS.**
- **RE-TORQUE MOUNTING BOLTS AFTER THE 1ST 500 MILES OR AFTER EACH TRACK RACING EVENTS.**

REQUIRED TOOLS

- Lug, Socket and Box Wrenches
- Torque wrench
- Jack and jack stands (or access to lift)

ASSEMBLY

1. Using an automotive lift or hydraulic jack, raise vehicle and remove tires.
2. Disconnect the link join on the steering column shaft. Make sure to mark the position of the shaft vs. the linkage to properly align the two during reinstallation



(Installation continued on next page)



BLOX Racing Subframe Hard Collar Kit PN: BXSS-20601

3. Loosen the bolts on the subframe. **DO NOT REMOVE THE BOLTS.** Drop the subframe 8mm from the chassis of the vehicle.

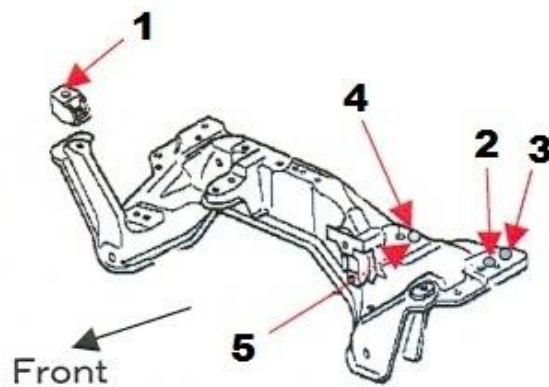

4. Please match the imprinted part numbers on each collar to the appropriate position and orientation shown in the diagram.

5. Install collar EG1 in between the body and subframe with part number and logo facing toward ground.

6. Install collar EG2 to the front outer position with part number facing up, and EG3 to the rear outer position with part number and logo facing towards ground.

(Installation continued on next page)



BLOX Racing Subframe Hard Collar Kit PN: BXSS-20601

7. Install collar EG4 in between the body and subframe with part number and logo facing towards ground.

8. Install collar EG5 in between the subframe and bolt flange with part number and logo facing up

9. **TORQUE ALL BOLTS EVENLY TO THE CORRECT FACTORY SPECS ENSURING PROPER AND LEVEL/EVEN INSTALLATION.**

