

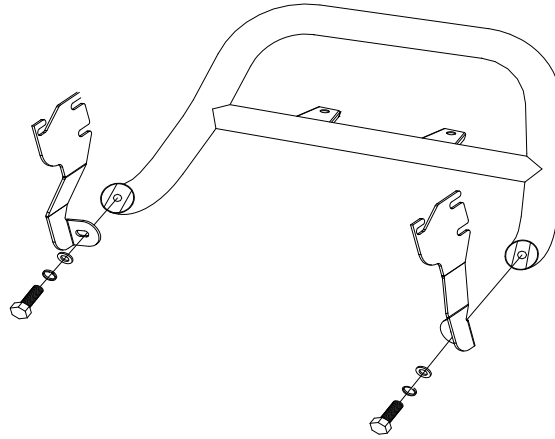

INSTALLATION INSTRUCTIONS

PART#: B20

A BAR BRACKET FOR 1997-01 DODGE DAKOTA\ 1998-01 DODGE DUDRAGO



QTY	PARTS KIT CONTENTS DESCRIPTION	TOOLS REQUIRED
1	SAFARI BAR ASSEMBLY (PURCHASED SEPARATELY)	19MM SOCKET
1	MOUNT BRACKET-PASSENGER SIDE	17MM SOCHET
1	MOUNT BRACKET-DRIVER SIDE	18MM SOCKET
2	M12×50 LG. HEX HEAD BOLTS	RATCHET
2	Φ12FLAT WASHERS	TORQUE WRENCH
2	Φ12 MEDIUM SPRING WAHSERS	
2		

STEP1. Remove the contents from the box and check for any damage. Verify all parts against parts list.

STEP2. Read and understand instructions completely before beginning installation.

STEP3. Remove plastic trim that retain cover under and behind front bumper. Remove cover.

STEP4. Loosen five bolts retaining each bumper.

STEP5. Slip passenger and driver brackets between frame and triangular form of bumper mount. Hand tighten mounting bolts. See Figure 1.

STEP6. Remove factory license plate bracket. Reinstall license plate without bracket using factory fasteners. Attach license plate by aligning bottom two plate boles with the two upper holes in bumper.

STEP7. Mount Safari Bar using M12 fasteners. Hand tighten.

STEP8. Center and level Safari Bar. Torque fasteners as follows: M12 fasteners to 65FT.LBS.

Bumper Mount fasteners to 60

FT.LBS.

STEP9. Replace cover and trim clips.

A BAR BRACKET FOR 1997-01 DODGE DAKOTA\ 1998-01 DODGE DUDRAGO

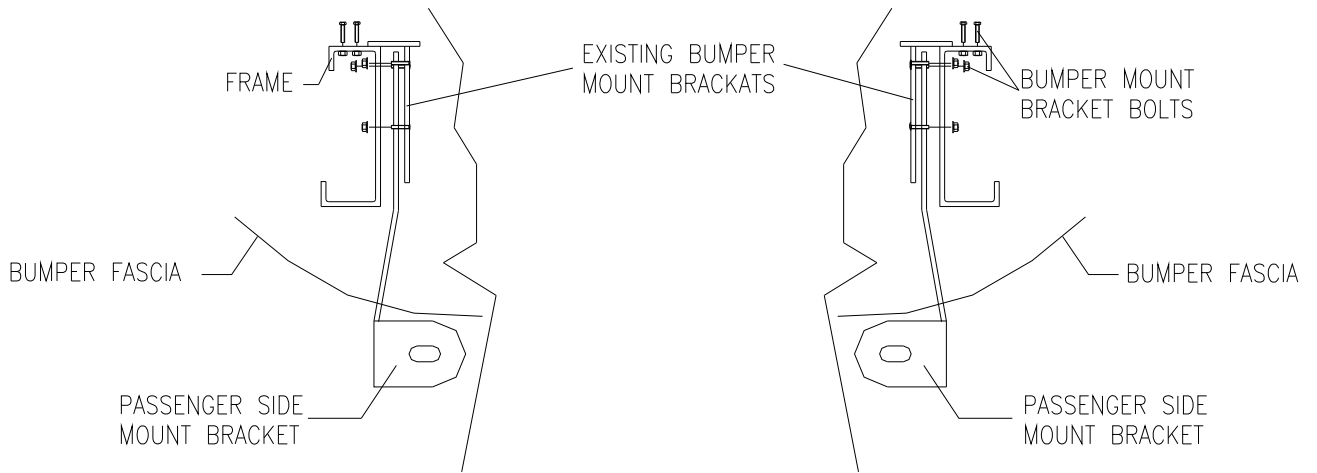

FIGURE 1 FRONT VIEW

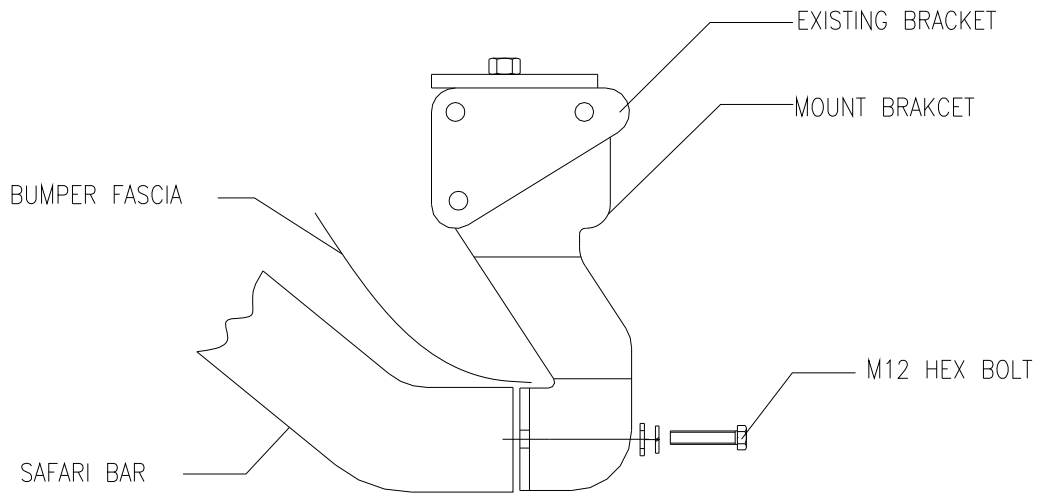

FIGURE 2 DRIVER SIDE