

# BLACK+ DECKER™

## CORDLESS HAND VACS

### INSTRUCTION MANUAL

CATALOG NUMBERS

HHVJ315BMF

HHVJ320BMF

HHVJ320BMFS

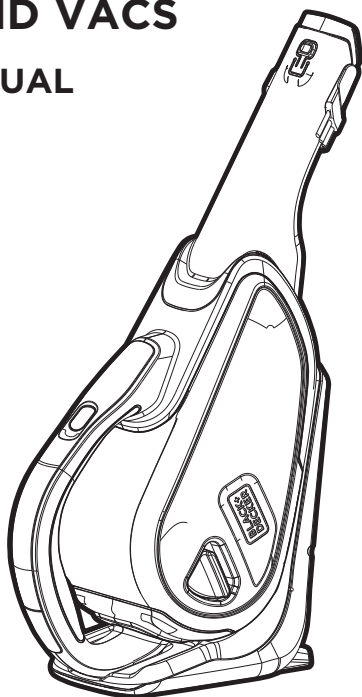

Thank you for choosing BLACK+DECKER!

**PLEASE READ BEFORE RETURNING THIS PRODUCT FOR ANY REASON.**

**SAVE THIS MANUAL FOR FUTURE REFERENCE.**

## SAFETY GUIDELINES - DEFINITIONS

It is important for you to read and understand this manual. The information it contains relates to protecting **YOUR SAFETY and PREVENTING PROBLEMS**. The symbols below are used to help you recognize this information.

**⚠ DANGER:** Indicates an imminently hazardous situation which, if not avoided, will result in death or serious injury.

**⚠ WARNING:** Indicates a potentially hazardous situation which, if not avoided, could result in death or serious injury.

**⚠ CAUTION:** Indicates a potentially hazardous situation which, if not avoided, may result in minor or moderate injury.

**NOTICE:** Used without the safety alert symbol indicates potentially hazardous situation which, if not avoided, may result in property damage.

## IMPORTANT SAFETY INSTRUCTIONS

When using an electrical appliances, basic precautions should always be followed, including the following:

### READ ALL INSTRUCTIONS BEFORE USING THIS APPLIANCE.

**⚠ WARNING:** Read all safety warnings and all instructions. Failure to follow the warnings and instructions listed below may result in electric shock, fire and/or serious injury.

**⚠ WARNING:** Some household dust contains chemicals known to the State of California to cause cancer, birth defects or other reproductive harm such as asbestos and lead in lead based paint.

**⚠ WARNING:** To reduce the risk of fire, electrical shock or injury:

- ⚠ WARNING:** To reduce the risk of electric shock – Do not use outdoors or on wet surfaces.
- Do not allow to be used as a toy. Close attention is necessary when used by or near children.
- Use only as described in this manual. Use only manufacturer's recommended attachments.
- Do not use with damaged cord or plug. If appliance is not working as it should, has been dropped, damaged, left outdoors, or dropped into water, return it to a service center.
- Do not pull or carry by cord, use cord as a handle, close a door on cord, or pull cord around sharp edges or corners. Do not run appliance over cord. Keep cord away from heated surfaces.
- Do not unplug by pulling on cord. To unplug, grasp the plug, not the cord.
- Do not handle charger, including charger plug, and charger terminals with wet hands.
- Do not put any object into openings. Do not use with any opening blocked; keep free of dust, lint, hair, and anything that may reduce air flow.
- Keep hair, loose clothing, fingers, and all parts of body away from openings and moving parts.
- Use extra care when cleaning on stairs.
- Do not use to pick up flammable or combustible liquids, such as gasoline, or use in areas where they may be present.
- Do not pick up anything that is burning or smoking, such as cigarettes, matches, or hot ashes.
- Do not use without dust bag and/or filters in place.
- Do not charge the unit outdoors.
- Use only the charger supplied by the manufacturer to recharge.
- Do not incinerate the appliance even if it is severely damaged. The batteries can explode in a fire.
- This appliance is intended for household use only and not for commercial or industrial use.
- Shock Hazard. To protect against risk of electrical shock, do not put unit or charging base in water or other liquid.
- Do not allow the cord to hang over the edge of a table or counter or touch hot surfaces. The unit should be placed or mounted away from sinks and hot surfaces.
- Plug the charger directly into an electrical outlet.
- Use the charger only in a standard electrical outlet (120V/60Hz).
- Unplug the charger from outlet before any routine cleaning or maintenance.
- This product includes rechargeable nickel cadmium batteries. Do not incinerate batteries as they will explode at high temperatures.
- Leaks from battery cells can occur under extreme conditions. If the liquid, which is a 20-35% solution of potassium hydroxide, gets on the skin (1) wash quickly with soap and water or (2) neutralize with a mild acid such as lemon juice or vinegar. If the liquid gets into the eyes, flush them immediately with clean

water for a minimum of 10 minutes. Seek medical attention.

- Do not look into the air vents when the unit is switched on, as sometimes there is a possibility of small debris being discharged from the air vents, especially after cleaning / replacement of the filters as debris inside the unit can be disturbed.

## ADDITIONAL SAFETY WARNINGS

- a) **Prevent unintentional starting. Ensure the switch is in the off-position before connecting to battery pack, picking up or carrying the appliance.** Carrying the appliance with your finger on the switch or energizing appliance that have the switch on invites accidents.
- b) **Recharge only with the charger specified by the manufacturer.** A charger that is suitable for one type of battery pack may create a risk of fire when used with another battery pack.
- c) **Do not use a battery pack or appliance that is damaged or modified.** Damaged or modified batteries may exhibit unpredictable behavior resulting in fire, explosion or risk of injury.
- d) **Do not expose a battery pack or appliance to fire or excessive temperature.** Exposure to fire or temperature above 266°F (130°C) may cause explosion.
- e) **Have servicing performed by a qualified repair person using only identical replacement parts.** This will ensure that the safety of the product is maintained.

**⚠ WARNING:** Do not attempt to modify or repair the appliance

## FUNCTIONAL DESCRIPTION

1. On/off power button
2. Handle
3. Nozzle
4. Extendable crevice tool
5. Crevice tool release button
6. LED BATTERYSENSE (SMARTTECH vacuums only)
7. LED POWERBOOST indicator
8. Dust bowl
9. Dust bowl release button
10. Flip-up brush
11. FILTERSENSE LED (SMARTTECH vacuums only)
12. Charging base

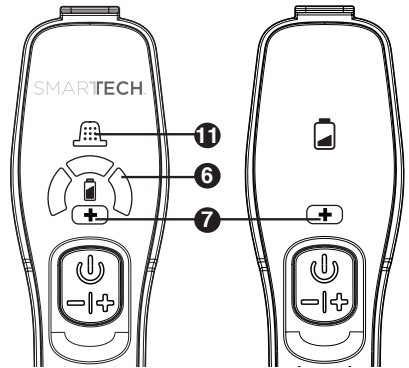
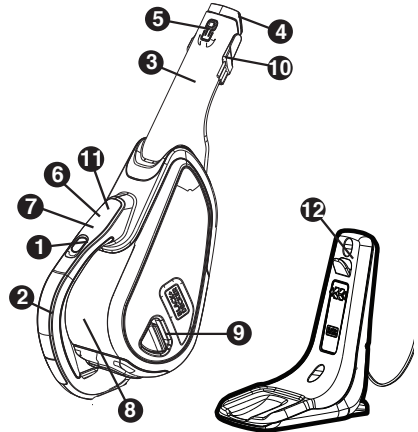

## SAVE THESE INSTRUCTIONS

### Symbols

- The label on your tool may include the following symbols. The symbols and their definitions are as follows:  
V..... volts  
A..... amperes  
Hz..... hertz  
W..... watts  
min ..... minutes  
~ or AC..... alternating current  
=== or DC .. direct current  
n<sub>o</sub> ..... no load speed  
Ⓜ ..... Class I Construction (grounded)  
⊕ ..... earthing terminal  
⚠ ..... safety alert symbol  
Ⓜ ..... Class II Construction (double insulated)  
.../min or rpm... revolutions or reciprocation per minute

## Wall Mounting

The product can be attached to a wall to provide a convenient storage and charging point for the appliance. When mounting to a wall, make sure the mounting method is suitable for the wall type and is appropriate to the weight of the appliance.

- Mark the location of the charger base (12) screw holes on the wall (within reach of an electrical outlet for charging the vacuum while it is on the charging base).

- Fix the charging base to the wall using appropriate screws and plugs for the type of wall, and weight of the appliance.
- Hang the appliance by placing the opening of the vacuum base over the hooks in the charging base.

## Charging the battery

**⚠ WARNING:** For use only with the supplied charger.

- Before first use, the battery must be charged for at least 5 hours.
- Place the appliance on the charging base (11) whenever it is not in use as shown in **Figure A**.

**⚠ WARNING:** Before charging, be sure to empty all contents and dry thoroughly if needed to avoid damage to your appliance.

- Make sure the appliance is switched off. The battery will not be charged when the on/off switch (1) is in the on position.

**NOTE:** While charging, the charger may become warm. This is normal and does not indicate a problem. The appliance can be left connected to the charger indefinitely.

**⚠ WARNING:** Do not charge the battery at ambient temperatures below 50 °F or above 104 °F.

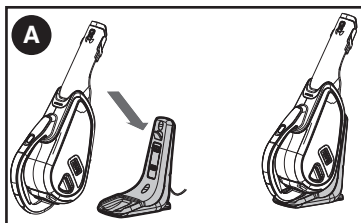

LED Patterns	
	Charging
	Battery Fault
	Charger Fault
	Battery Hot

## Switching on and off - Figure B

- To switch the appliance on, depress the on/off button (1). The battery indicator LED will illuminate and vacuum will begin in the low-speed mode.
- Depress the button a second time to engage the POWERBOOST mode. The green LED will also illuminate, indicating the vacuum is in the higher-speed mode.
- To switch the appliance off, depress the button a third time.

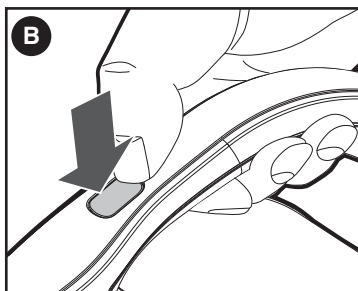

## POWERBOOST mode

The green LED will illuminate when the appliance is in POWERBOOST mode. The vacuum will operate at a higher suction level to pick up debris that requires more power.

## Filter sensor (HHVJ320BMFS ONLY)

Whenever a filter is blocked and needs cleaning, the red LED in the handle will illuminate. Clean dust from filter (See “Cleaning the Dust Bowl and Filter” section).

## Nozzle / Accessories

- A crevice tool (4) is built into the nozzle (3). Extend the crevice tool as shown in **Figure C**, until it clicks in place.
- To shorten the crevice tool, depress the crevice tool release button (5) as shown in **Figure D** and slide the crevice tool into the nozzle.

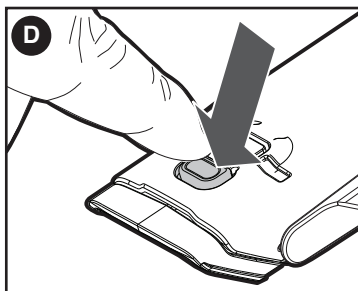
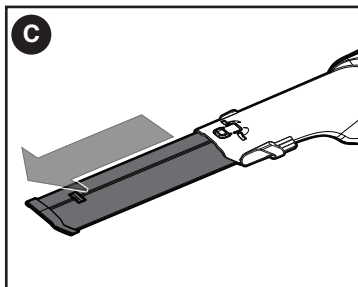

- A brush accessory is built into the nozzle and can be flipped upwards for use as shown in **Figure E**.

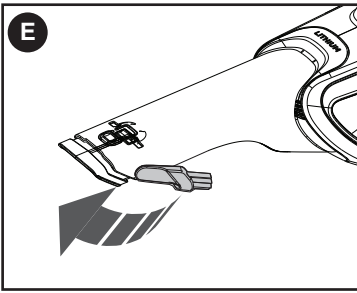

## Dry pick up

- For everyday spills of dry material.
- Do not fill the dust bowl (8) beyond the end of the intake chute.

## Optimizing the suction force

In order to keep the suction force optimised, the filters must be cleared regularly during use.

## EMPTYING AND CLEANING THE PRODUCT

### Removing the dust bowl and filters - Figures F & G

**⚠ WARNING:** The filters are reusable and should be cleaned regularly.

- Press the dust bowl release button (9) as shown in the **insert of Figure F**, then pull the dust bowl (8) straight off as shown in **Figure F**.

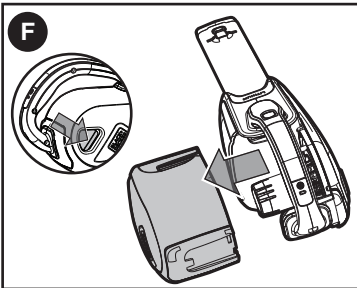

- While holding the dust bowl over a bin or sink, pull out the filter (12) to empty the contents as shown in **Figure G**.

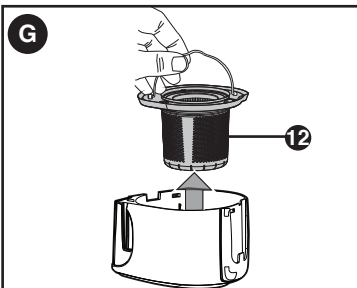

- To replace the dust bowl, push it back onto the appliance until it clicks firmly into place.

**⚠ WARNING:** Never use the appliance without the filters. Optimum dust collection will only be achieved with clean filters.

### Cleaning the Dust Bowl and Filter

- The dust bowl and filter can be washed in warm soapy water.
- Make sure the filter and the dust bowl are dry before re-fitting.

### For a more thorough cleaning

- Remove the dust bowl and filter assembly as described above.
- To separate the plastic filter (13) from the cloth filter (14), twist the plastic filter in a counterclockwise direction and lift it off of the cloth filter as shown in **Figure H**.
- Shake or lightly brush any loose dust off both filters.

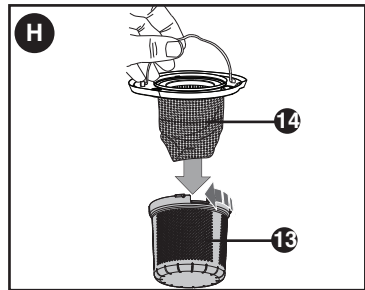

- The dust bowls and filters can be washed in warm soapy water. Allow to dry before placing back into the vac.
- To replace the filters, slide the outer plastic filter over the cloth filter.
- Align the wings of the plastic filter with the slots in the cloth filter and twist in a clockwise direction.
- Place filters back into the bowl pressing firmly to ensure a secure fit.
- To replace dust bowl, place it back onto the handle until it "clicks" firmly into position.

**IMPORTANT:** Maximum dust collection will only be obtained with a clean filter and an empty dust bowl. If dust begins to fall back out of the product after it is switched off, this indicates that the bowl is full and requires emptying.

- Wash the filters regularly using warm, soapy water and ensure that they are completely dry before using again. The cleaner the filter is, the better the product will perform.
- It is very important that the filter is correctly in position before use.

## Scented filter\*

BEFORE FIRST USE - remove bag from the scented pre-filter. Reassemble per instructions above.

When the vacuum is turned on, the plastic scented filter will emit an aroma to freshen the air.

### **WARNING:**

- Causes mild skin irritation
- Toxic to aquatic life
- Harmful to aquatic life with long lasting effects.
- Dispose of contents/ containers to an approved waste disposal plant.

**NOTE:** When the plastic scented filter no longer lets off the aroma, it can be an indication that the filter needs to be replaced. See below for information on replacement filters.

*\*HHVJ320BMFS vacuums are supplied with a scented filter, though any vacuum covered in this manual can accept a scented filter.*

## Replacing the filters

The filters should be replaced every 6 to 9 months and whenever worn or damaged. Replacement filters are available from your BLACK+DECKER dealer.

Catalog numbers:

- Scented plastic filter: VSPF10xx\*\*
- Cloth filter: VBF10

*\*\*XX is a placeholder for the two-digit number that indicates the plastic scented filter's specific scent.*

## MAINTENANCE

Use only mild soap and damp cloth to clean the vac. Never let any liquid get inside the vac; never immerse any part of the vac into a liquid.

** WARNING:** Make sure the vacuum is completely dry before using it.

**IMPORTANT:** To assure product SAFETY and RELIABILITY, repairs, maintenance and adjustment (other than those listed in this manual) should be performed by authorized service centers or other qualified service organizations, always using identical replacement parts.

## The RBRC® Seal

The RBRC® (Rechargeable Battery Recycling Corporation) Seal on the lithium-ion batteries (or battery packs) indicates that the costs to recycle these batteries (or battery packs) at the end of their useful life have already been paid by

BLACK+DECKER. In some areas, it is illegal to place spent lithium-ion batteries in the trash or municipal solid waste stream and the Call 2 Recycle® program provides an environmentally conscious alternative. Call 2 Recycle, Inc., in cooperation with BLACK+DECKER and other battery users, has established the program in the United States and Canada to facilitate the collection of spent lithium-ion batteries. Help protect our environment and conserve natural resources by returning the spent nickel cadmium, nickel metal hydride or lithium-ion batteries to an authorized BLACK+DECKER service center or to your local retailer for recycling. You may also contact your local recycling center for information on where to drop off the spent battery. RBRC® is a registered trademark of Call 2 Recycle, Inc.

## Accessories

Recommended accessories for use with your appliance are available from your local dealer or authorized service center.

** WARNING:** The use of any accessory not recommended for use with this appliance could be hazardous.

This Class B digital apparatus complies with Canadian ICES-003.

This device complies with part 15 of the FCC rules. Operation is subject to the following two conditions: (1) This device may not cause harmful interference, and (2) this device must accept any interference received, including interference that may cause undesired operation.

**NOTE:** This equipment has been tested and found to comply with the limits for a Class B digital device, pursuant to Part 15 of the FCC Rules. These limits are designed to provide reasonable protection against harmful interference in a residential installation. This equipment generates, uses and can radiate radio frequency energy and, if not installed and used in accordance with the instructions, may cause harmful interference to radio communications. However, there is no guarantee that interference will not occur in a particular installation.

If this equipment does cause harmful interference to radio or television reception, which can be determined by turning the equipment off and on, the user is encouraged to try to correct the interference by one or more of the following measures:

- Reorient or relocate the receiving antenna.

- Increase the separation between the equipment and receiver.
- Connect the equipment into an outlet on a circuit different from that to which the receiver is connected.
- Consult the dealer or an experienced radio/TV technician for help.

Changes or modifications to this unit not expressly approved by the party responsible for compliance could void the user's authority to operate the equipment. This Class B digital apparatus complies with Canadian ICES-003.