

## Fitting Information Mercedes ML/GL W/X164 Airmatic

### General information:

- Do not store suspension modules below -15 °C or above 50 °C.
- Disassembly and installation are only to be performed by fully qualified and certified personnel at a specialized garage.
- Car manufacturer special tools and equipment is required!
- Depressurized **suspension modules** mustn't be exposed to mechanical pressure.
- Check air pipes and cables – renew if damaged.
- Caution! Damage to the vehicle and the air suspension module can occur if work is carried out in a manner other than that specified in the instructions or in a different sequence.

### Dismantling the rear suspension module



The ignition must remain switched off during the work on the air suspension module.

- Measure the standard vehicle height ①.



①

- There are two large fuses (40A) in the right fuse box (under the hood), remove the front fuse only ②.

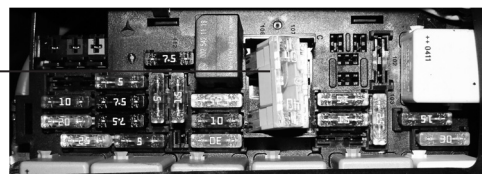

②

- Raise vehicle.



Use a chassis hoist and make certain that the raised vehicle is securely attached to the hoist to prevent the vehicle from slipping, falling, or moving during the installation process.

If you choose to install any BILSTEIN product without the necessary special tools, expertise or chassis hoist, you may subject yourself to the risk of serious bodily injury or death.



- Remove wheel.
- Unscrew pressure line connection on suspension module ③.



③

Air pressure! Loosen slowly and allow air to escape.

- Seal off line with plugs.
- Pull off suspension module from upper holder clip using suitable tools.
- Compress suspension module and remove from the seat of the track control arm.
- Remove suspension module sideways ④.



④

### Installing the rear suspension module

- Do not twist suspension module when installing.
- Upper holder clip must be renewed.



- Unscrew pressure line connection of the new air suspension module ⑤!

Don't remove plastic plug first.



⑤

- Replace used parts of the pressure line connection with new parts. Pay attention to the correct position of the tapered ring (the cone must go with the screw connector).

- Renew upper holder clip ⑥. Tighten clip to setscrew at the floor pan completely.

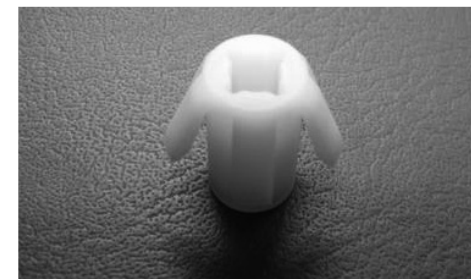

⑥

- Insert the suspension module into the index of the track control arm.

- Put the suspension module on the upper holder clip.

- Fit air pipe to the top of suspension module (torque to 2Nm) ⑦.



⑦

- Insert fuse.
- Start the engine. Operate the raising function of the on-board electronics, and wait for at least 2 minutes (keep the doors closed during the period) ⑧.

⑧



- Check the correct position of suspension module when it is pressurized ⑨.

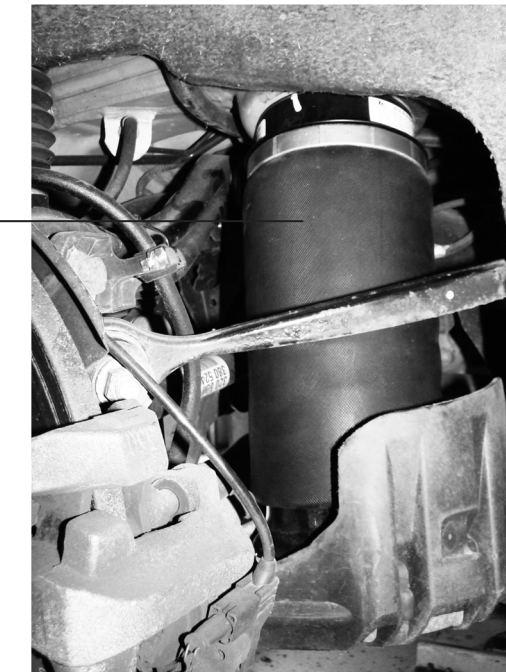

⑨

- Fit wheel.
- Lower the vehicle up to standard vehicle height from the lifting platform.



Never under any circumstances allow the vehicle to be fully lowered from the lifting platform (hoist) with the air suspension depressurized.

- Lower completely when the vehicle raises of its own accord.
- Check air suspension system for leaks.