

E4-WM5-Y040A00

MOUNTING INSTRUCTIONS



Remove

Place vehicle on a chassis hoist, lift it and remove wheels.



The lower control arm must be supported by suitable means!

Remove bottom mount.

Remove top fixing nuts from support bearing. Do not remove center nut at this time! (fig. 1)

Remove complete strut and clamp it in an appropriate strut vise.

Using a suitable spring compressor, compress suspension spring until tension on support bearing is released.

Fit original/ BILSTEIN mounting parts on strut in reverse sequence to removal. Please refer to diagram to identify which parts will be replaced with BILSTEIN supplied components. When thread of piston rod is M10- use nuts (3) from delivered mounting parts.

Install

Assemble BILSTEIN and/ or original mounting parts, as well as the new BILSTEIN spring on the BILSTEIN strut in reverse sequence of removal.



Before releasing the spring, care is to be taken to ensure that the spring rest in the cutouts of top and bottom spring plate! When fitting the shock absorber (17) make sure, that the bores (21) of the spring plate (15) are in line with the fitted sleeve (18).

The correct mounting position of the suspension springs can be determined by the printing on the springs; install them with the print upright.

Fit assembled BILSTEIN strut to the vehicle in reverse sequence of removal.

All rubber- mounted strut/ damper attachments must not be fully tightened until AFTER the suspension system is loaded (wheels on the ground). Other mounting fasteners (for example brackets) must be securely tightened BEFORE load is placed on the suspension system.

- list of torques						
	M8	M 10	M 12	M 14	M 16	Thread
	13	25	45	72	110	Torque Nm
	10	19	34	54	83	Torque ft lb

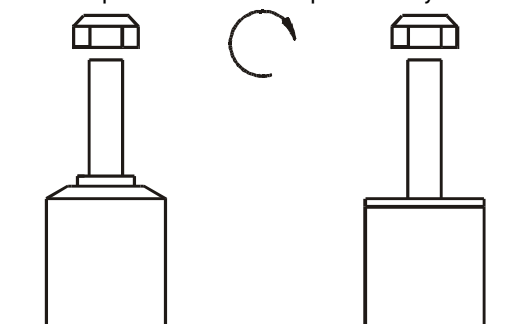

E4-WM5-Y040A00

MOUNTING INSTRUCTIONS



DO NOT USE IMPACT TOOLS FOR LOOSENING OR TIGHTENING FASTENERS, BECAUSE THIS MAY DESTROY THE THREADS. SELF-LOCKING NUTS MUST ONLY BE **USED ONCE!**

1. nut torque 12 ft lb *B
2. plate
3. nut (*B only M10x1,5)
4. plate
5. upper support bearing
6. plate
7. bottom support bearing
8. sleeve *B
9. upper spring plate
10. ring *B
11. rubber pad
12. helical sprin
13. bump stop
14. dust cover
15. bottom spring plate *B
16. Ring *B
17. BILSTEIN- shock absorber
18. fitted sleeve
70 Nm nut torque
17,5 ft lb
19. circlip *B
20. circlip *B
21. bore
22. ends of spring
23. wheel

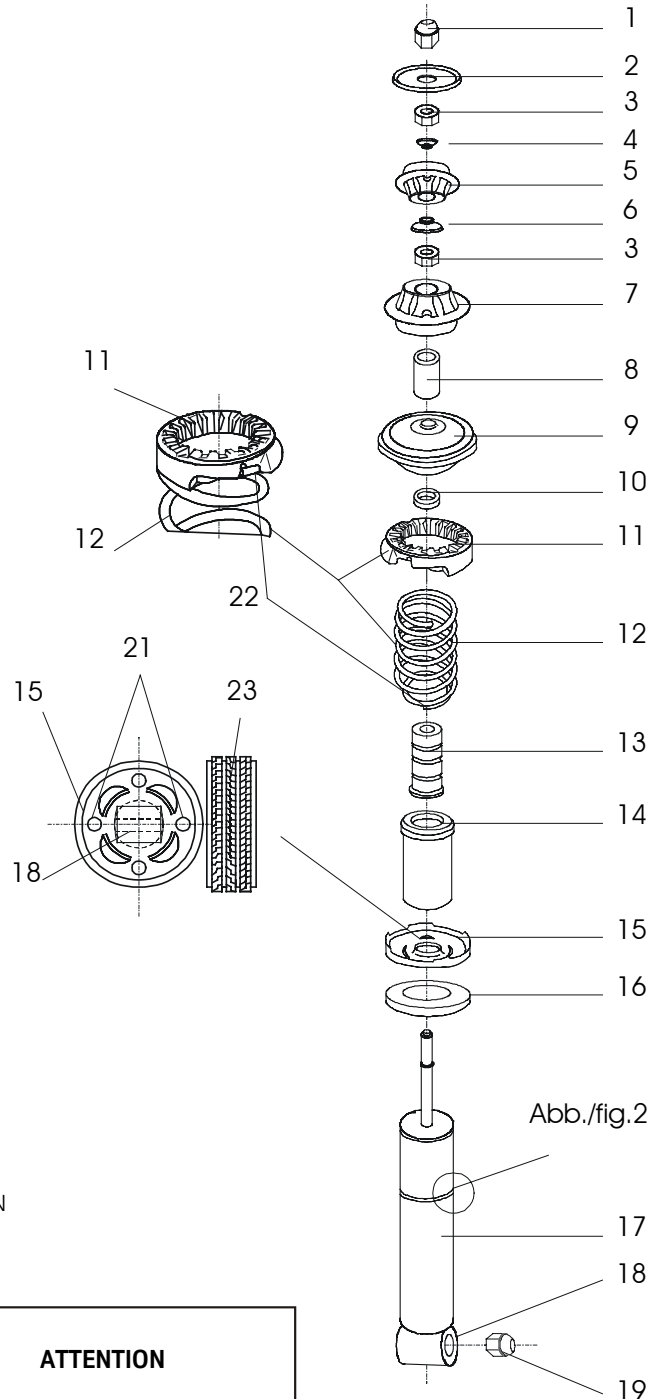

*B = mounting parts delivered by BILSTEIN

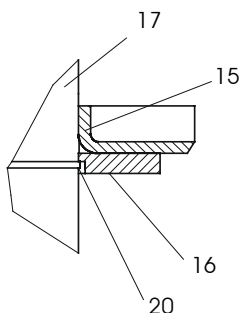

ATTENTION

When fitting the supporting ring (16) care must be taken to ensure that the circlip (20) is seated correctly!