

E4-WM5-Y288A00

MOUNTING INSTRUCTIONS



**ALL DRAWINGS ARE
GENERALIZED!
BRACKETS, ETC. SPECIFIC
TO STRUT ARE NOT SHOWN!**

When fitting the spring plate (1) care must be taken to ensure that the circlip ring (2) is seated correctly!

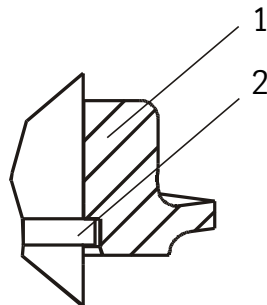

Fitting of plates with chamfer (if exist)

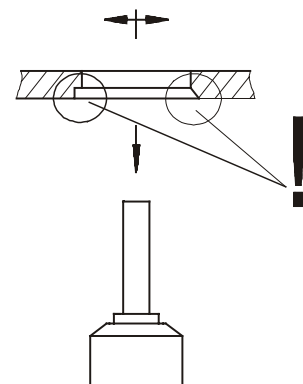

	M 8	M 10	M 12	M 14	M 16	List
						Thread
	13	25	45	72	110	Torque Nm
	10	19	34	54	83	Torque ft lb

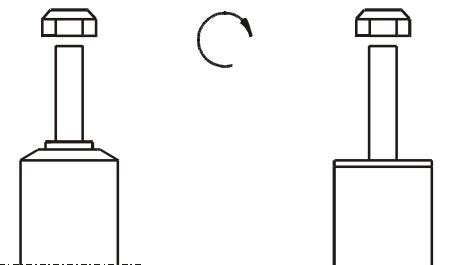

FOR THE TORQUE AND RETORQUE OF NUTS THE USE OF AN IMPACT SCREWDRIVER IS NOT ALLOWED BECAUSE THIS WOULD DESTROY THE WRENCH. SELF-LOCKING NUTS MUST ONLY BE **USED ONCE**



MOUNTING INSTRUCTIONS

Remove

Place vehicle on a chassis hoist, lift it and remove wheels.



The lower control arm must be supported by suitable means!

Remove bottom mount.

Remove top fixing nut from support bearing.
Do not remove center nut at this time!

Remove complete shock absorber and clamp it in an appropriate strut vise.

Using a suitable spring compressor, compress suspension spring until tension on support bearing is released.

Release center nut and remove original mounting parts and coil spring. Please refer to sketch to identify which parts will be replaced with BILSTEIN-supplied components.

Install

Assemble BILSTEIN and/ or original mounting parts, as well as the new BILSTEIN spring, if been used, on the BILSTEIN shock absorber in reverse sequence of removal.



Before releasing the spring, care is to be taken to ensure that the ends of the spring rest in the cutouts of the top and bottom spring plates.

The correct mounting position of the suspension springs can be determined by the printing on the springs; install them with the print upright.

Fit assembled BILSTEIN shock absorber to the vehicle in reverse sequence to removal.

All rubber-mounted **strut/ damper** attachments must not be fully tightened until AFTER the suspension system is loaded (wheels on the ground). Other mounting fasteners (for example brackets) must be securely tightened BEFORE load is placed on the suspension system.

Make sure that the bump stop and dust cover are correctly and properly fastened.

E4-WM5-Y288A00 MOUNTING INSTRUCTIONS

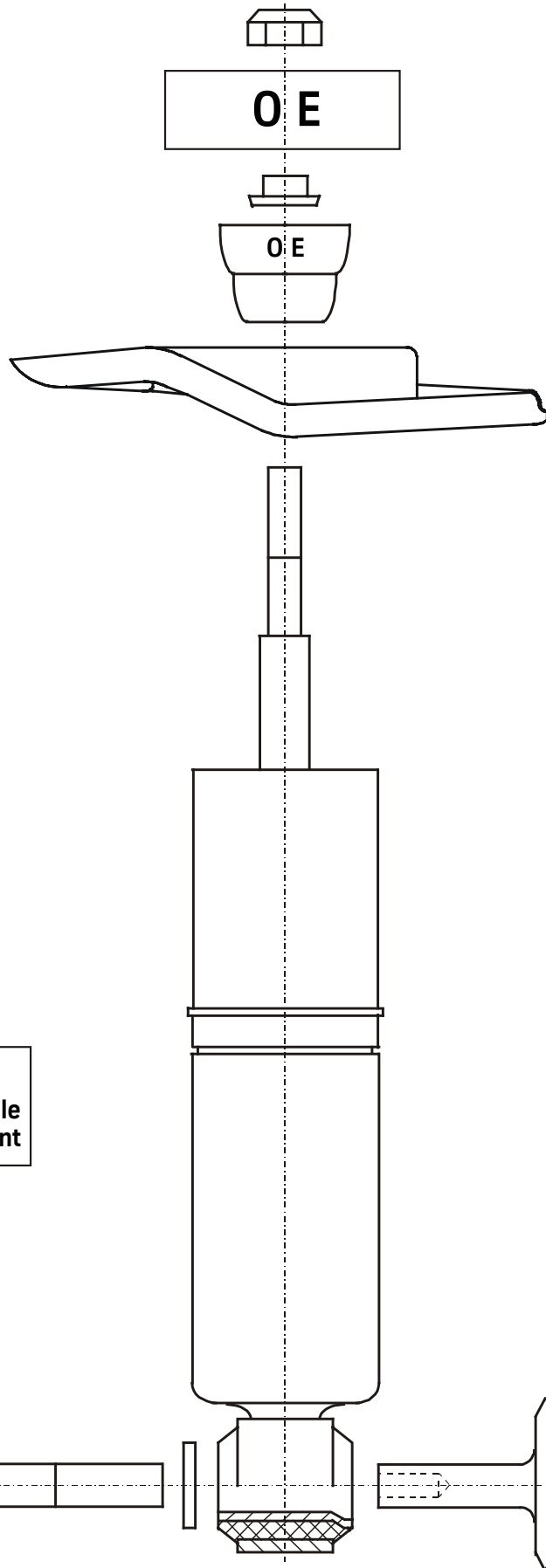

OE =
Original Anbauteile
Original Equipment

E4-WM5-Y288A00 MOUNTING INSTRUCTIONS



fig. 1

Carefully check that the spring will not become loose at fully extended shock absorber length (max. lowering)!

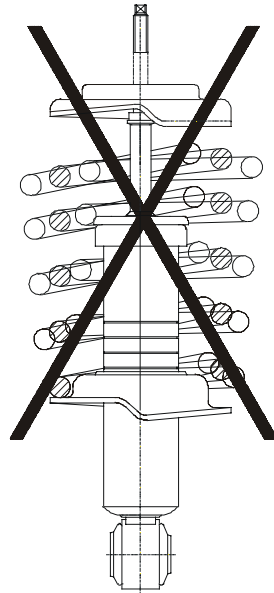

fig. 2

The wheel or other chassis components must not touch spring plate, bracket or bracket hose holder (max. lowering)

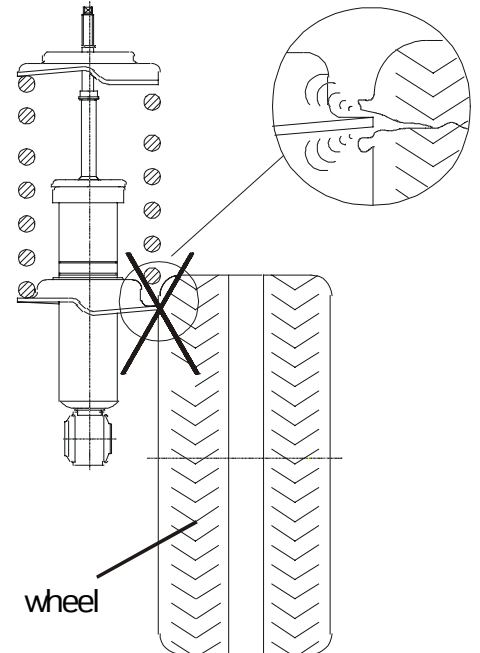

fig. 3

The spring must not be fully compressed when the shock absorber is fully compressed (upper groove)!

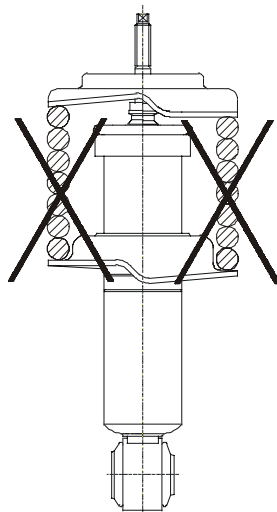

fig.4

Install spring plate in correct direction! Improper installation will cause incorrect ride height and damage the shock absorber!

