



**Contents:**

- **Certificate** (removable) **for:**

**MB C63 AMG (W205/S205) saloon/estate -**

**MB C63 S (W205/S205) saloon/estate -**

**- mounting instruction**



**Before installation please observe  
the following points:**

- Read all information in this manual carefully.  
All suspension components are fitted and removed acc. to the manufacturer's specifications for fitting and removing, if not otherwise required in these instructions.
  
- Check that your vehicle type is listed in the certificate as being specified for this kit.
  
- Check the product for all components before starting installation!
  
- Check that dimensions and fastening points are comparable between the original and BILSTEIN shock absorbers.
  
- Remove the negative battery pole.
  
- Directional references (left, right, front, rear) are always with reference to the driving direction.
  
- The tested vehicles are left- hand drive vehicles.

**After installation please observe  
the following points:**

- The vehicle height must be set by adjusting spring plates on the dampers and secured (see note about height adjustment).
  
- After installing the suspension system, caster and camber must be checked and adjusted according to manufacturer's specifications.  
Check and reset load- dependent brake compensator and ABS system according to manufacturer's specifications.
  
- Check and adjust headlight setting.
  
- Because the vehicle has been lowered, freedom of movement for all wheel- / tire- combinations must be checked.
  
- All rubber- mounted strut/ damper attachments must not be fully tightened until AFTER the suspension system is loaded (wheels on the ground). Other mounting fasteners (for example brackets) must be securely tightened BEFORE load is placed on the suspension system.
  
- Connect the negative battery pole.
  
- All diagrams are generalized and not to scale!  
brackets, etc. specific to strut are not shown!

M8	M 10	M 12	M 14	M 16	Thread
13	25	45	72	110	Torque Nm
10	19	34	54	83	Torque ft lb

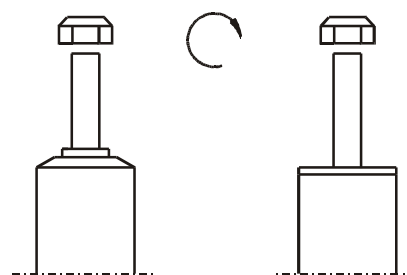

**Do not use impact tools for loosening or tightening fasteners, because this may destroy the threads. Self- locking nuts must only be used once!**

### front axle high adjustment

Fix the spring plate with the rubber balls/pins (1) and set screw (2) by using the auxiliary tool (hex key (3)).

The tightening torque 12+3Nm has to be realized with suitable tooling.

After several adjustments (approx. 5-10 times) the rubber balls/pins should be replaced. In cases of damage or loss of the balls/pins the delivered balls/pins are for replacement.

In case of the replacement balls/pins are used up it is possible to make replacement out of a commercially available O-ring:

cross section: 4,5mm;  
cut length: 5,2mm;  
material: NBR 80

## Removal

Place vehicle on a wheel-free car hoist, lift it and remove wheels.

Vehicles equipped **with xenon headlight** the movable element of sensor for the headlamp levelling controller must be removed before.



**Pay attention that support wires of brake system are strain-free during removal. Stabilization by suitable means is demanded.**

Remove bottom mount.

Remove top fixing nuts from support bearing.  
**Do not remove central nut at this time!**

Remove complete strut and clamp it in an appropriate strut vice.

Using a suitable spring compressor, compress suspension spring until tension on support bearing is free to move.

Release central nut and remove original mounting parts and coil spring. Please refer to diagram to identify which parts will be replaced with BILSTEIN- supplied components.

## Installation

Remove original top cap (4), fit BILSTEIN adjustment sleeve and reassemble cap (4). Assemble BILSTEIN and/ or original mounting parts, as well as the new BILSTEIN spring on the strut in reverse order to removal.



**IMPORTANT! Spring plates must not be adjusted outside the ranges specified in the certificate!**

The correct mounting position of the suspension springs can be determined by the printing on the springs; install them with the print upright.

Fit assembled strut to the vehicle in reverse order to removal.

**OE=** Original Anbauteile  
Original Equipment

**B=** BILSTEIN Lieferumfang  
Delivered by BILSTEIN

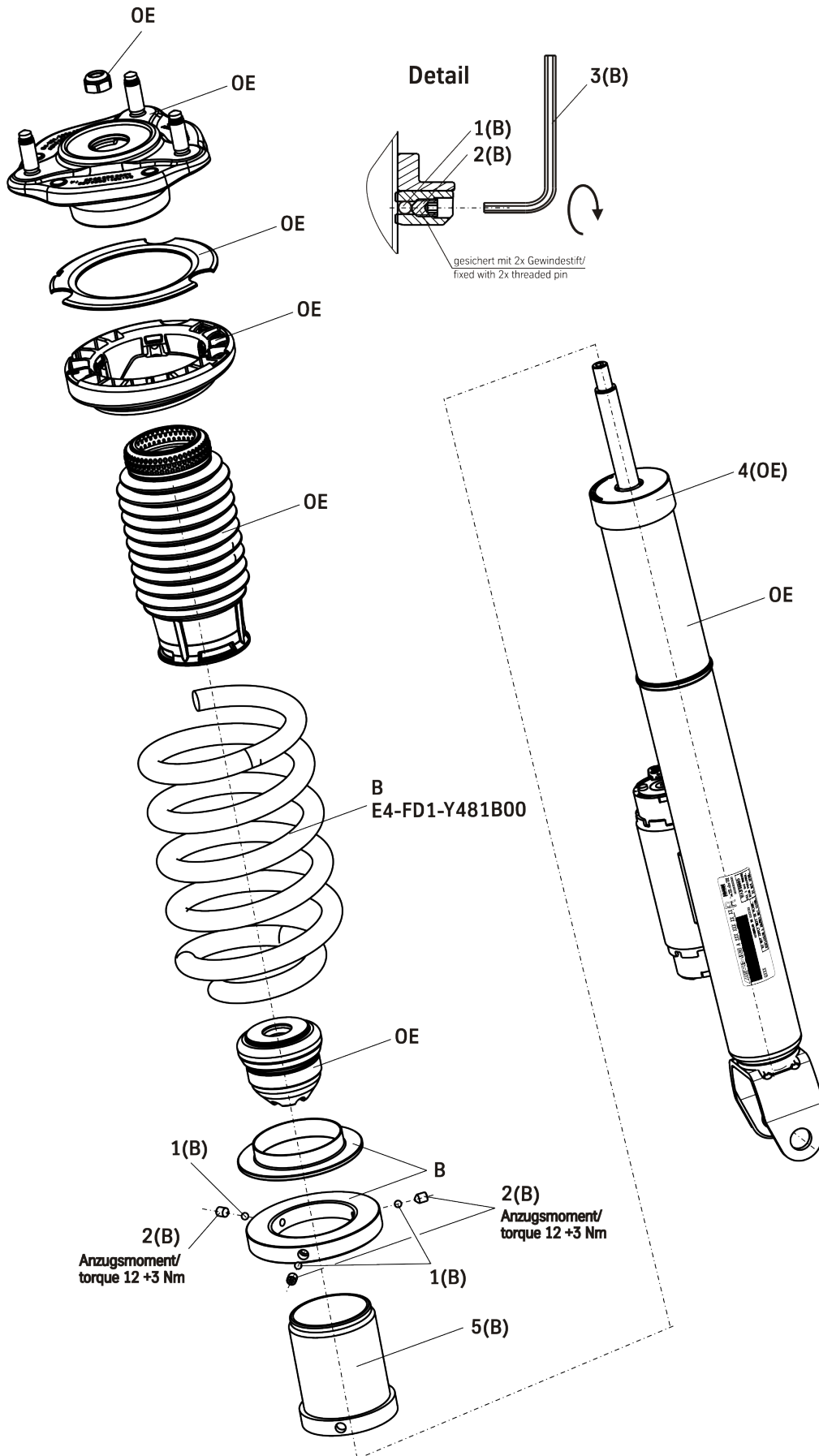

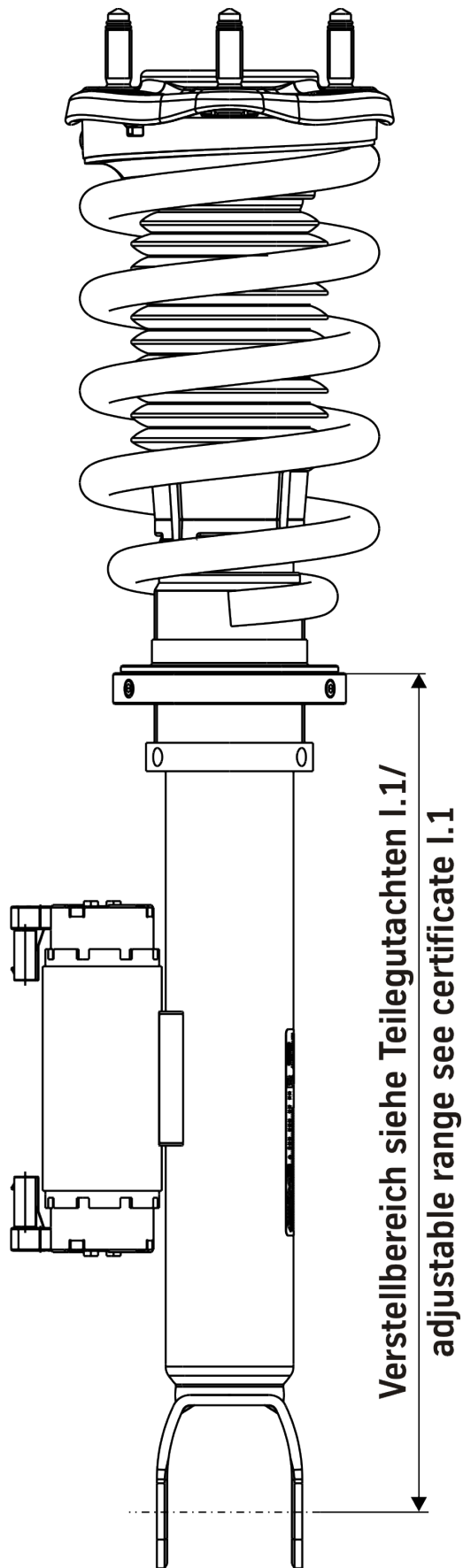

## Removal

Place vehicle on a wheel-free car hoist, lift it and remove wheels.



**Pay attention that support wires of brake system are strain-free during removal. Stabilization by suitable means is demanded.**

Remove top and bottom fixing mount from support bearing.

Remove original shock absorber.

## Installation

Fit BILSTEIN mounting parts according to the following sketches. Remove the original top spring pads and reuse the bottom one.

Fit shock absorber to the vehicle in reverse order to removal.

**OE=** Original Anbauteile  
Original Equipment

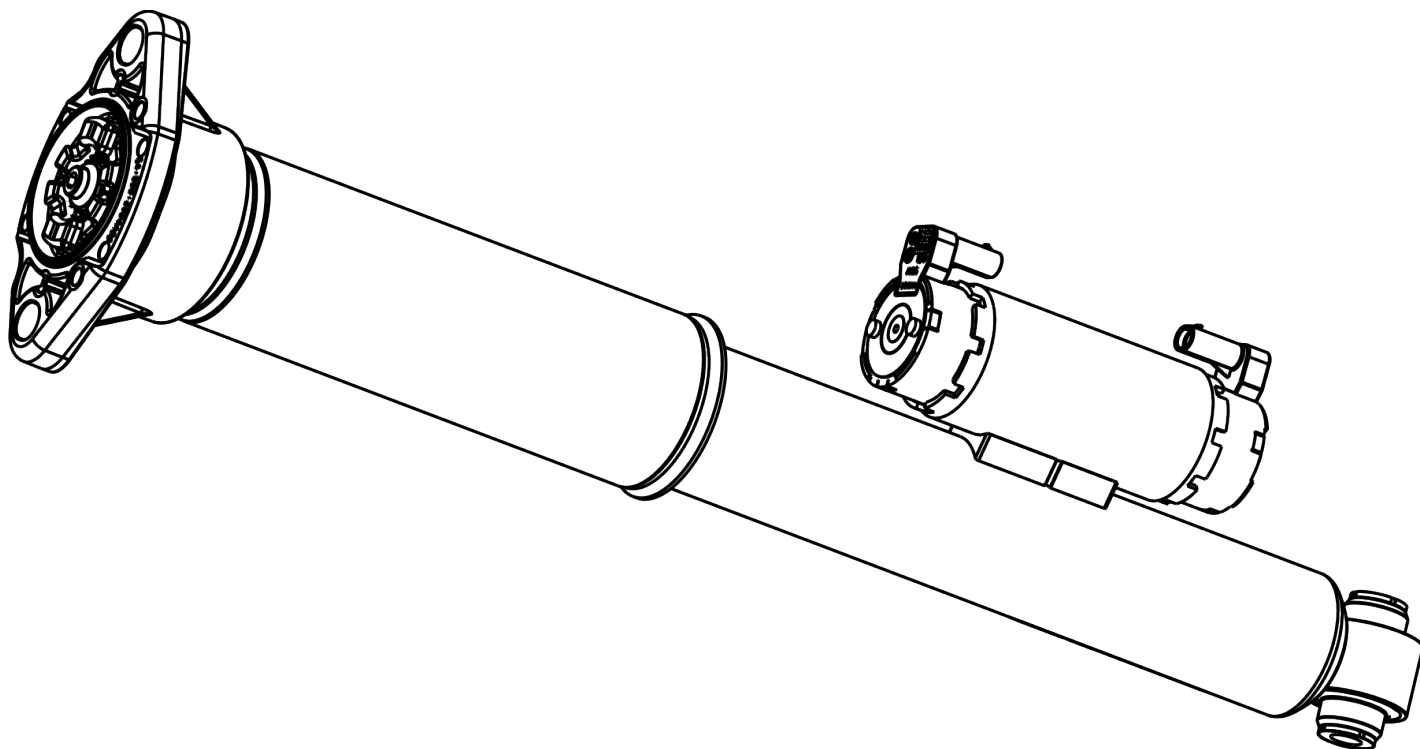

**mounting instruction for rear axle height adjustment**

**OE** = Original Anbauteile  
Original Equipment

**B** = BILSTEIN Lieferumfang  
Delivered by BILSTEIN

