



Contents:

- **certificate** (removable) **for:**
- PORSCHE Macan DampTronic** -
- **mounting instruction**



**Before installation please observe
the following points:**

- Read all information in this manual carefully.
All suspension components are fitted and removed acc. to the manufacturer's specifications for installing and removal, if not otherwise required in these instructions.
- Check that your vehicle type is listed in the certificate as being specified for this kit.
- Check the product for all components before starting installation!
- Check that dimensions and fastening points are comparable between the original and BILSTEIN shock absorbers.
- Directional references (left, right, front, rear) are always with reference to the driving direction.
- Remove the negative battery pole.
- The tested vehicles are left- hand drive vehicles.

**After installation please observe
the following points:**

- Set the vehicle height by adjusting spring plates.
Only use the supplied spanner wrenches.
- All rubber- mounted strut/ damper attachments must not be fully tightened until AFTER the suspension system is loaded (wheels on the ground). Other mounting fasteners (for example brackets) must be securely tightened BEFORE load is placed on the suspension system.
 - Because the vehicle has been lowered, freedom of movement for all wheel-/ tire- combinations must be checked.
 - Connect the negative battery pole.
- After installing the suspension system, caster and camber must be checked and adjusted according to manufacturer's specifications.
 - Check and reset load- dependent brake compensator and ABS system according to manufacturer's specifications.
 - Check and adjust headlight setting.

All diagrams are generalized
and not to scale!
brackets, etc. specific to
strut are not shown!

list of torques

	M 8	M 10	M 12	M 14	M 16	Thread
	13	25	45	72	110	Torque Nm
	10	19	34	54	83	Torque ft lb

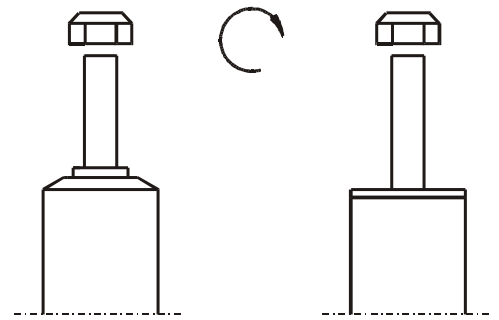

Do not use an impact tool to loosen or tighten fasteners due to possible damage to the product.
Self- locking nuts must only be used once!

Removal

Place vehicle on a wheel- free car hoist, lift it and remove wheels.

Vehicles equipped **with xenon headlight** the movable element of sensor for the headlamp levelling controller must removed before.



Pay attention that support wires of brake system are strain-free during removal. Stabilization by suitable means is demanded.

Remove bottom mounting.

If necessary release brake hose/ brake hose holder/ stabilizer/ ABS- hose and/ or swing- support at strut.

Detach cable connection from strut inside wheel housing.

Remove top fixing nuts from support bearing.

Do not remove central nut at this time!

Remove cable connection from strut. Remove complete strut, strip the bearing block from support bearing and clamp the strut in an appropriate strut vice.

Using a suitable spring compressor, compress suspension spring until support bearing is free to move.

Release centre nut and remove original mounting parts and coil spring. Please refer to diagram to identify which parts will be replaced with BILSTEIN- supplied components.

Installing

Fit original/ BILSTEIN mounting parts on strut cable assignment in reverse order to removal.

The original top spring pad must be reused!

Fit assembled BILSTEIN strut to the vehicle in reverse order to removal.

The cable ends (4) of strut are delivered without fitted plug. The cable must fitted to support bearing first without plug. Then grommet (5) and plug housing (6) can be fitted and connected to the vehicles cable harness. The cable assignment inside plug housing is in random order. The plug must be fixed to the holder (7) of support bearing.

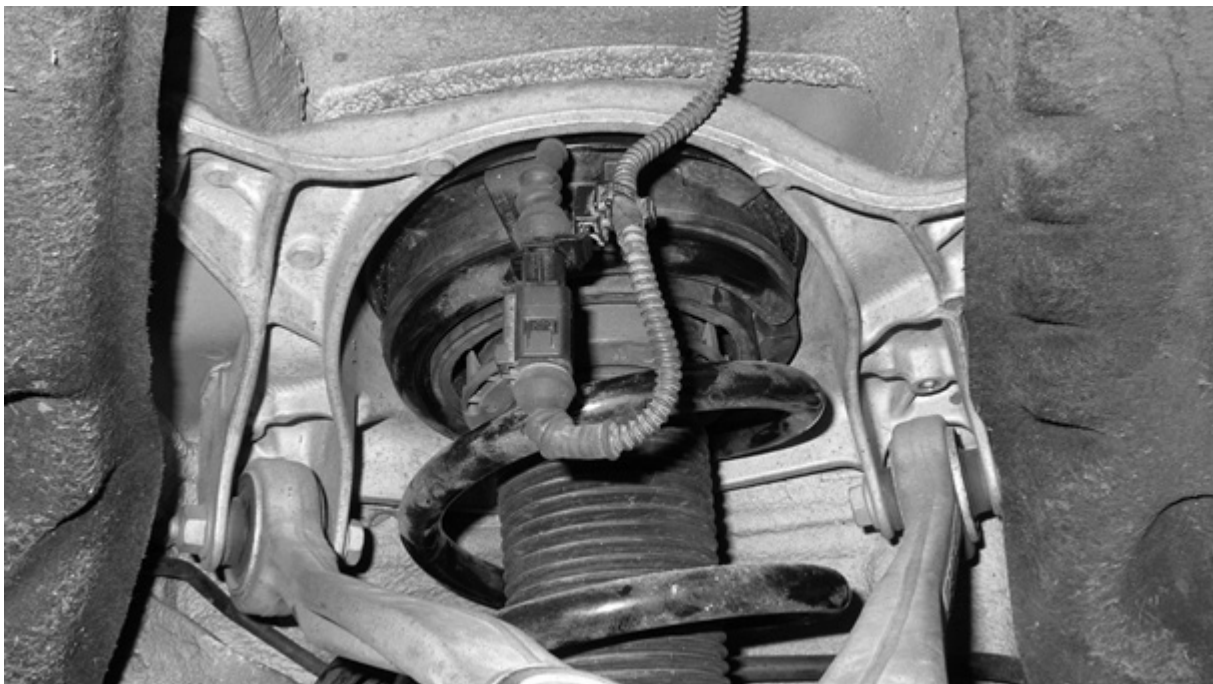

front axle hight adjustment

Install the hight adjustment as it is shown in sketch for front axles. Fix the spring plate with the the rubber pins (1) and set screws (2) by using hex key (3) delivered by BILSTEIN.

Torque 12 +3 Nm

After several adjustments (approx. 5-10 times) the rubber pins should be replaced, otherwise the thread on damper tube might be damaged.

OE= Original Equipment

B= Delivered by BILSTEIN

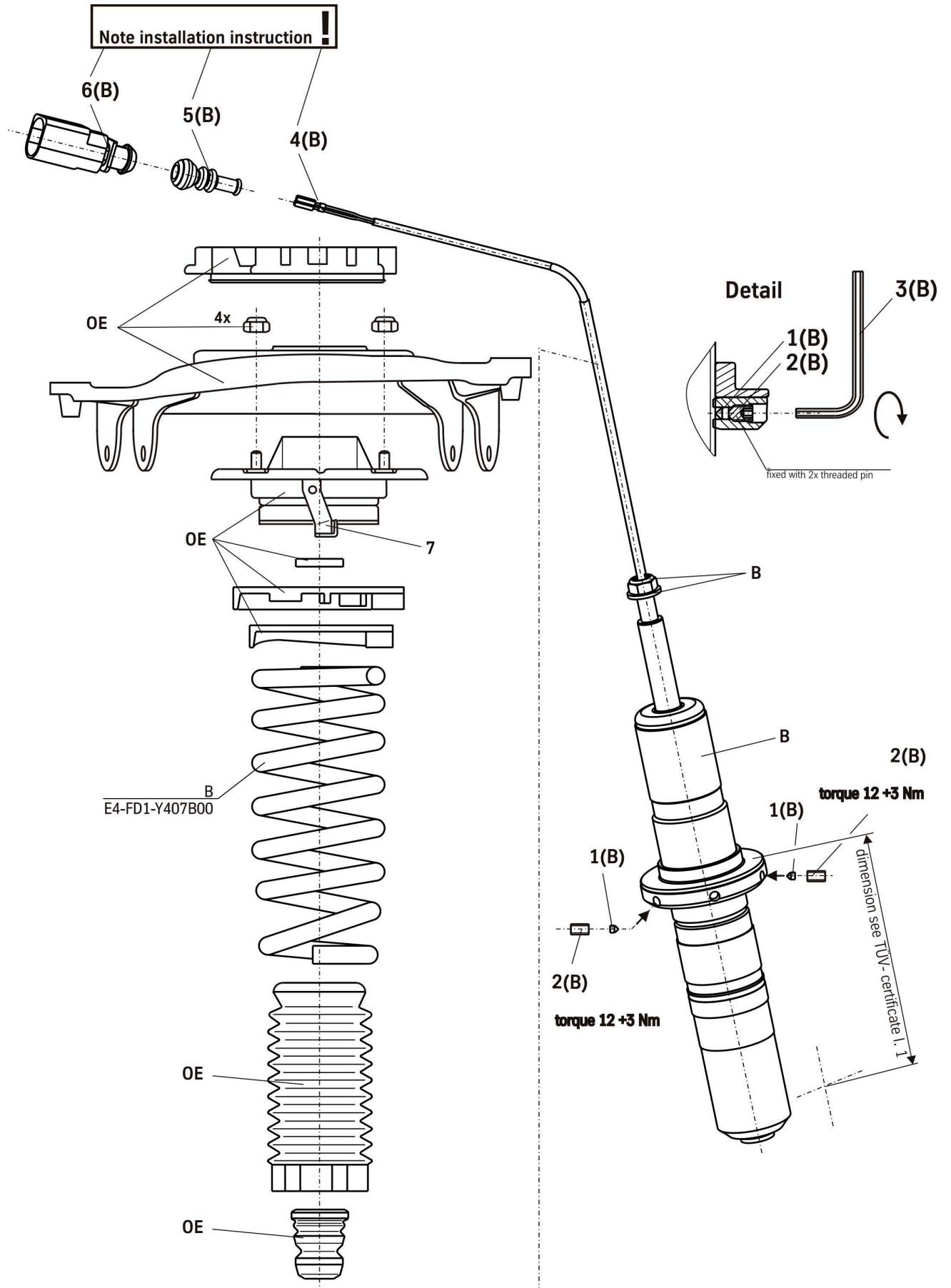



- **certificate** (removable):
PORSCHE Macan DampTronic -

Removal

Place vehicle on a wheel-free car hoist, lift it and remove wheels.



Pay attention that support wires of brake system are strain-free during removal. Stabilization by suitable means is demanded.

Detach cable connection from shock absorber inside wheel housing.

Remove top and bottom fixing mount from support bearing.

Remove shock absorber and original mounting parts.

Installation

Fit BILSTEIN and/ or original mounting parts in BILSTEIN shock absorber in reverse order to removal.

Original dust cover and original bumper must reuse.

Fit BILSTEIN shock absorber to the vehicle in reverse order to removal.

The cable ends (4) of shock absorber are delivered without fitted plug. The cable must fitted to support bearing first without plug. Then OE grommet (5), BILSTEIN grommet (6) and plug housing (7) can be fitted and connected to the vehicles cable harness.

OE= Original Equipment

B= Delivered by BILSTEIN

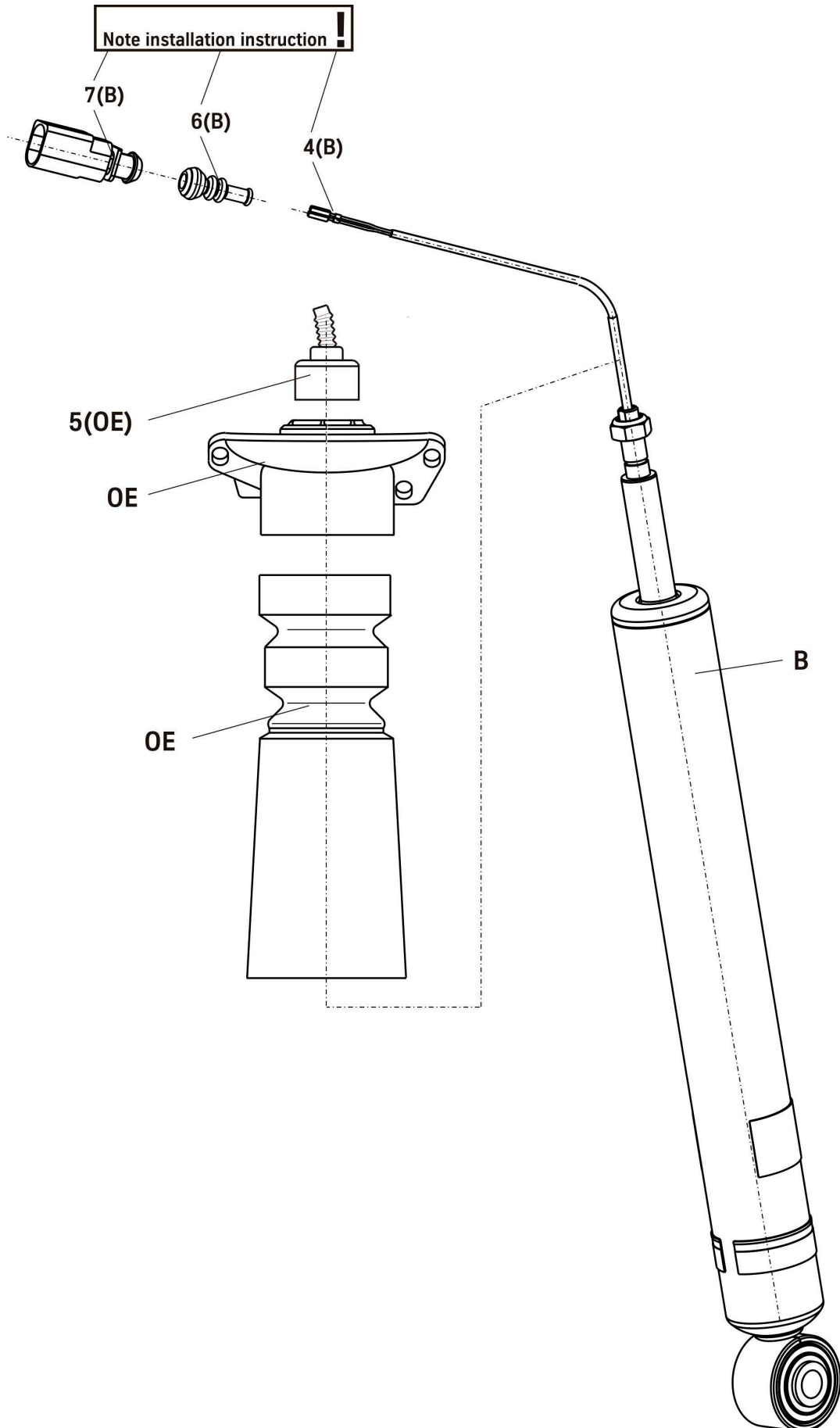

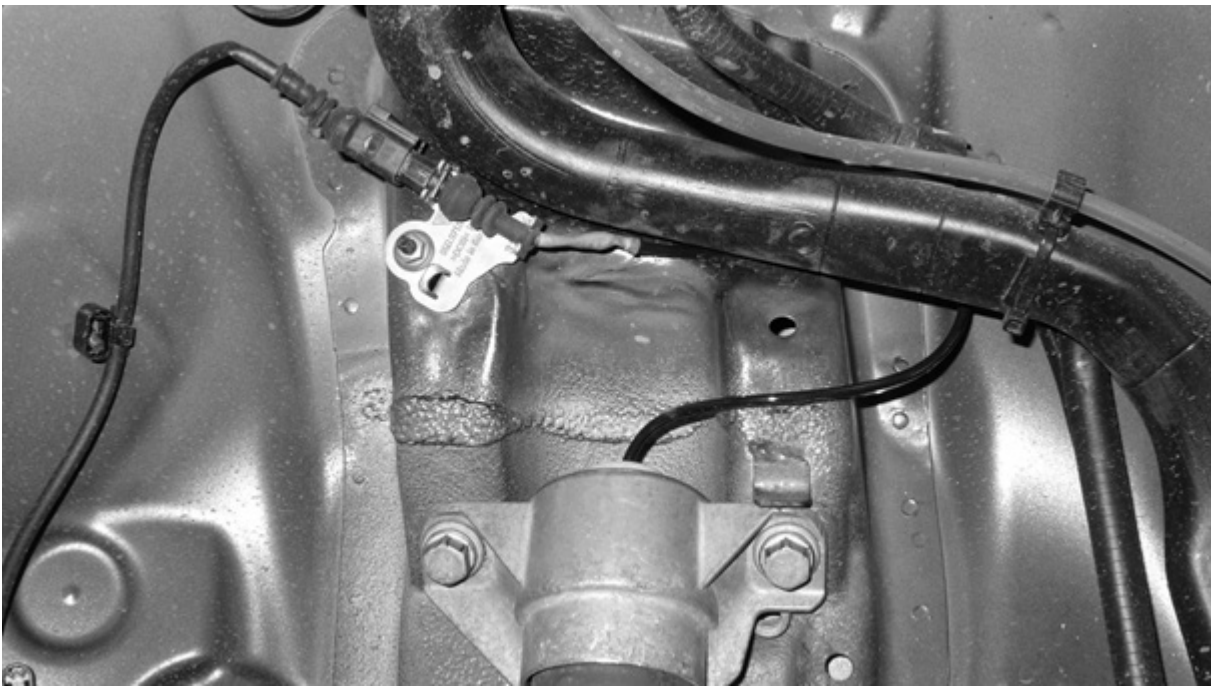

OE= Original Equipment

B= Delivered by BILSTEIN

